

COPIES OF THIS MAP ARE AVAILABLE TO THE PUBLIC AT A NOMINAL COST. ADDRESS: N.C. DEPARTMENT OF TRANSPORTATION, STATE ROAD MAINTENANCE UNIT - MAPPING AND INFORMATION SECTION, 3401 CARL SANDHURST CT., FOLEY, N.C. 27834

REVISED 10/2005 SRG 12/2006 BCH 5/14/07 BCH 5/20/08 BCH 1/13/09 BDG 3/11/09 BDG 1/20/10 BDG 2/2/10 BDG 2/17/10 BDG

CLEVELAND SUP. 2

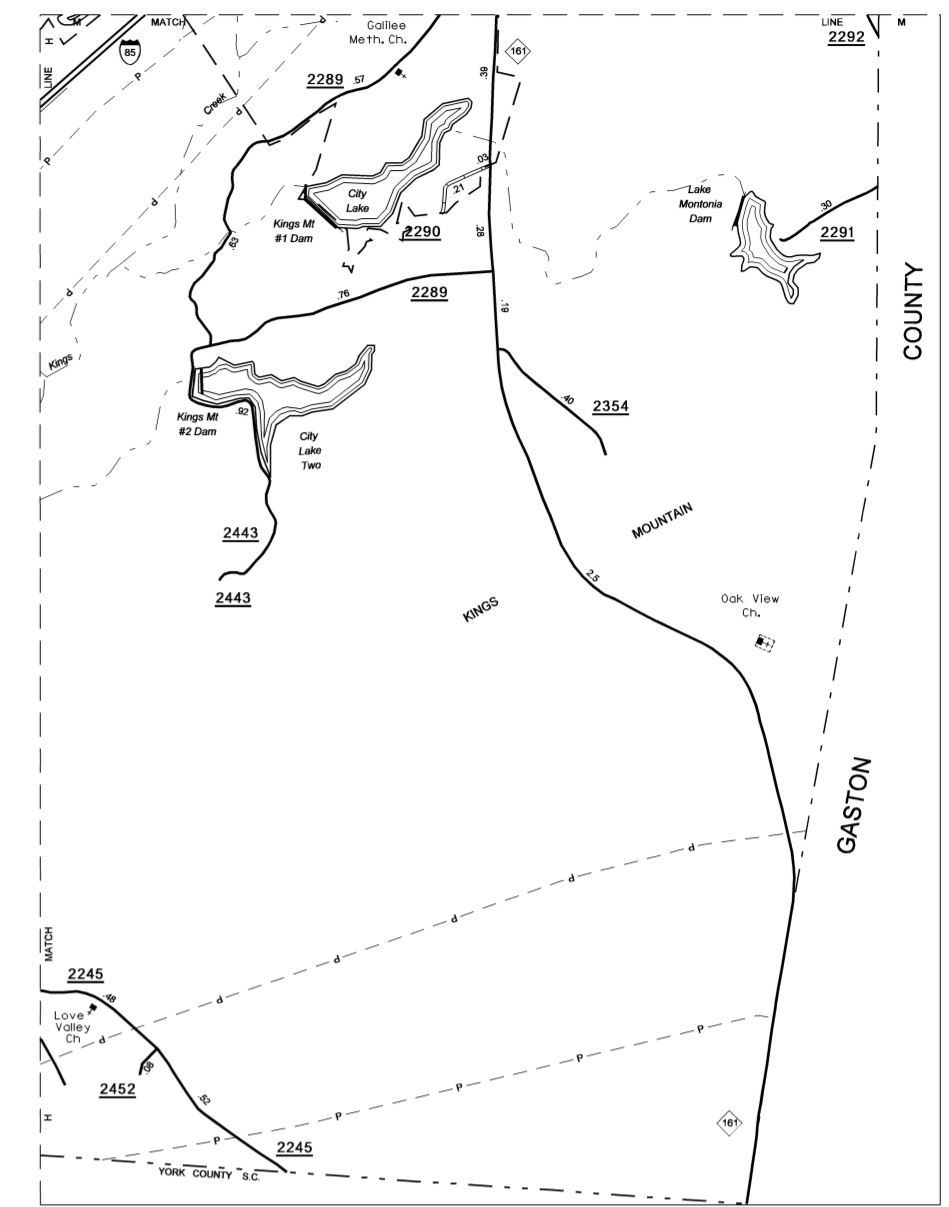
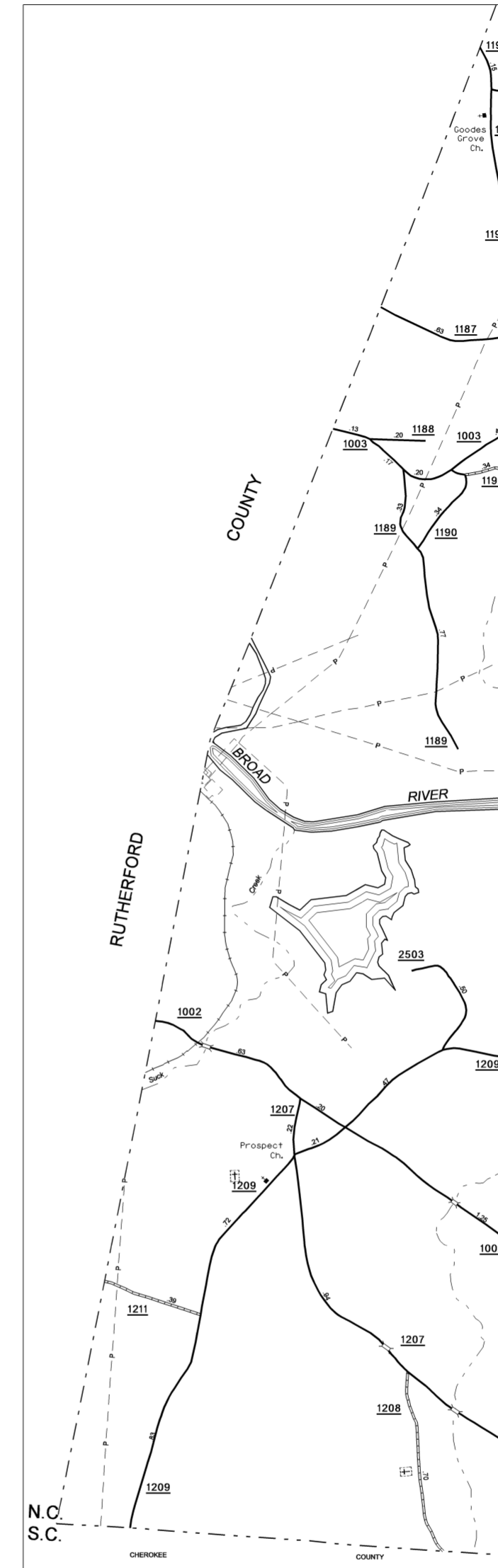

ENLARGED MUNICIPAL AND SUBURBAN AREAS
CLEVELAND COUNTY
 NORTH CAROLINA
 PREPARED BY THE
 NORTH CAROLINA DEPARTMENT OF TRANSPORTATION
 STATE ROAD MAINTENANCE UNIT - MAPPING AND INFORMATION SECTION
 IN COOPERATION WITH THE
 U.S. DEPARTMENT OF TRANSPORTATION
 FEDERAL HIGHWAY ADMINISTRATION

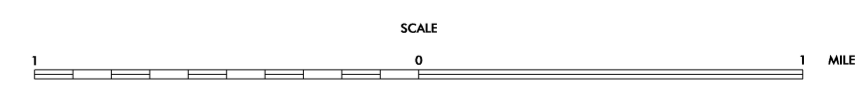
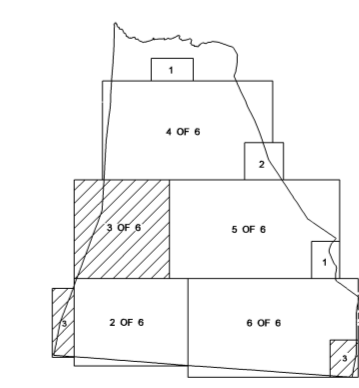

POLYCONIC PROJECTION

SHEET 3 OF 6