

SUP. 1  
 AVERY  
 COPIES OF THIS MAP ARE AVAILABLE  
 TO THE PUBLIC AT A NOMINAL COST.  
 ADDRESS:  
 N.C. DEPARTMENT OF TRANSPORTATION  
 STATE ROAD MAINTENANCE UNIT - MAPPING AND INFORMATION SECTION  
 3401 CARL SANDHURST CT.  
 RALEIGH, N.C. 27610

REVISED  
 2/21/01 JSH  
 1/08/02 JPH  
 12/22/03 JPH  
 10/26/04 JSH  
 09/21/05 JPH  
 6/22/06 BDC  
 5/11/08 BDC  
 4/30/09 BDC

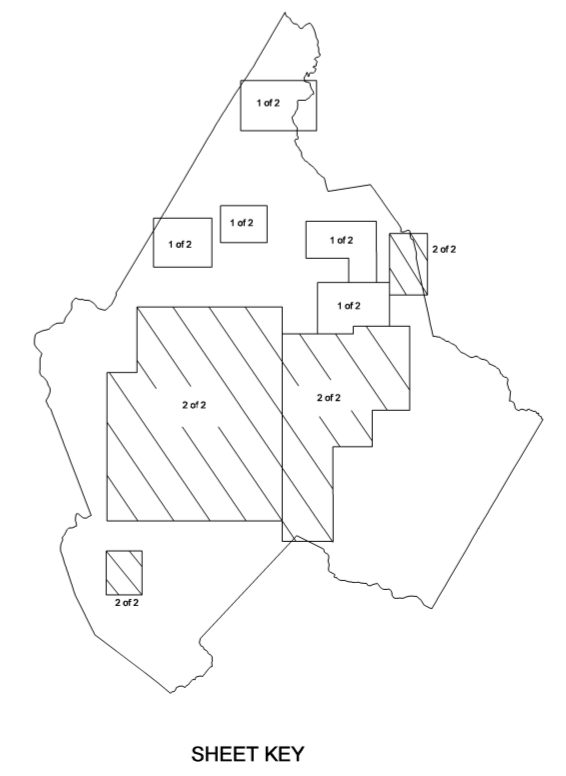
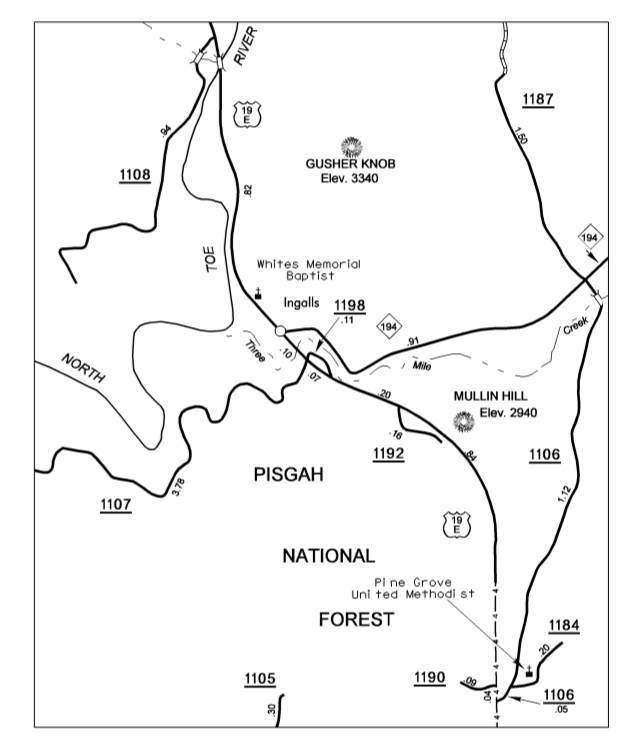
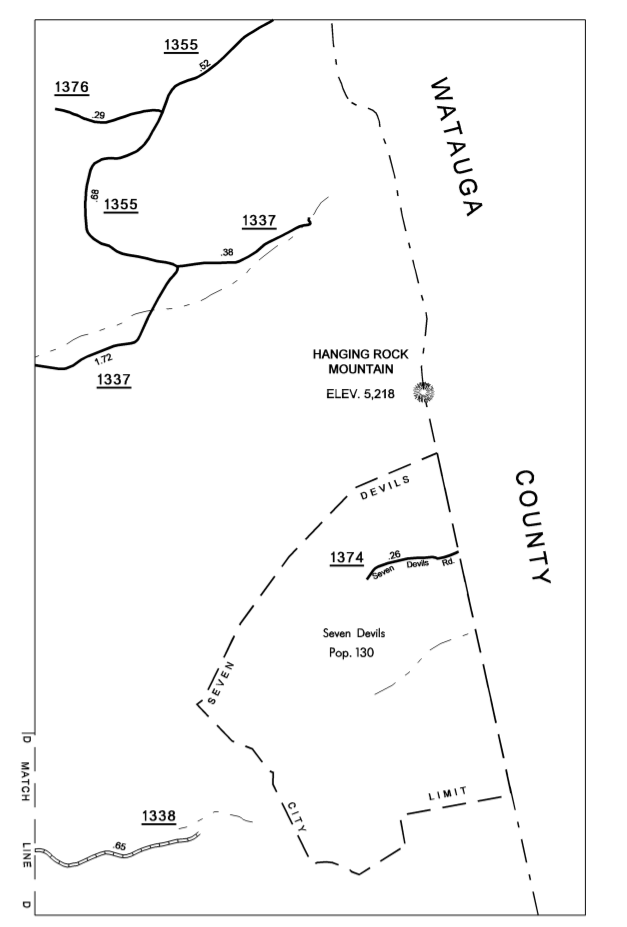
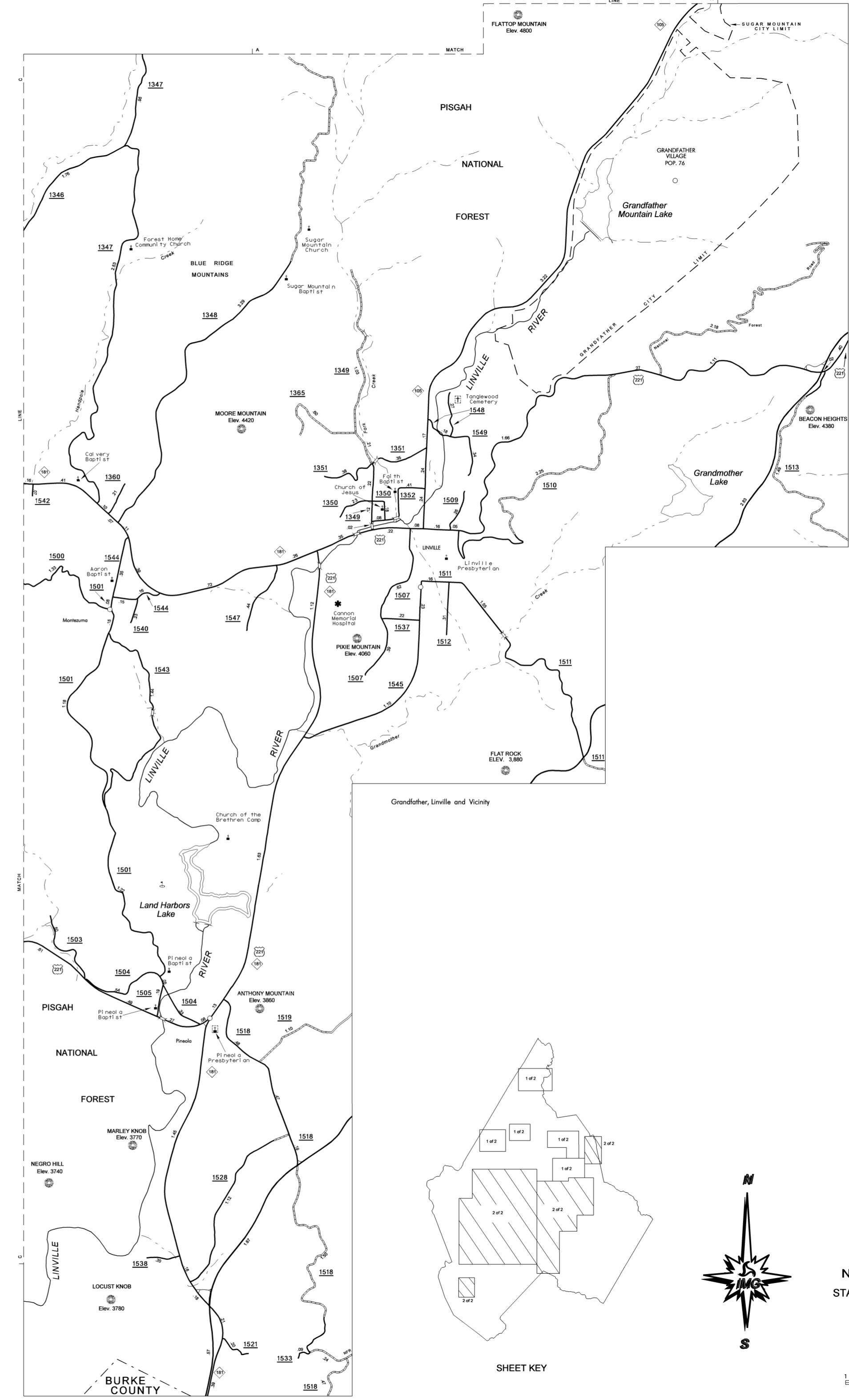

ENLARGED MUNICIPAL AND SUBURBAN AREAS  
**AVERY COUNTY**  
 NORTH CAROLINA  
 PREPARED BY THE  
 NORTH CAROLINA DEPARTMENT OF TRANSPORTATION  
 STATE ROAD MAINTENANCE UNIT - MAPPING AND INFORMATION SECTION  
 IN COOPERATION WITH THE  
 U.S. DEPARTMENT OF TRANSPORTATION  
 FEDERAL HIGHWAY ADMINISTRATION  
 SCALE  
 1 0 1 MILE  
 10,000 FOOT GRID BASED ON NORTH CAROLINA PLANE COORDINATE SYSTEM  
 POLYCONIC PROJECTION