

GUILFORD COUNTY

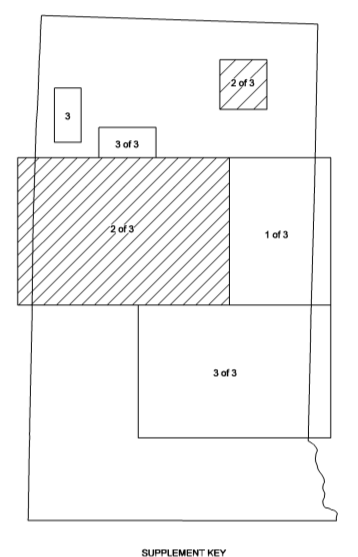

ENLARGED MUNICIPAL AND SUBURBAN AREAS  
**ALAMANCE COUNTY**  
NORTH CAROLINA  
PREPARED BY THE  
NORTH CAROLINA DEPARTMENT OF TRANSPORTATION  
STATE ROAD MAINTENANCE UNIT - MAPPING AND INFORMATION SECTION  
IN COOPERATION WITH THE  
U.S. DEPARTMENT OF TRANSPORTATION  
FEDERAL HIGHWAY ADMINISTRATION  
SCALE

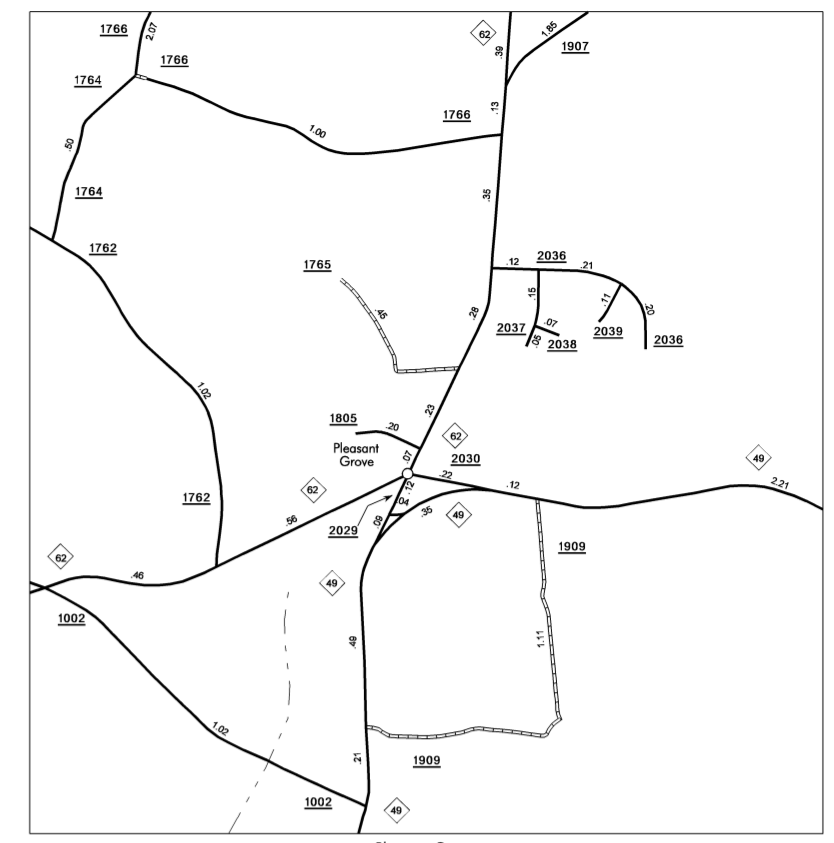

10,000 FOOT GRID BASED ON NORTH CAROLINA PLANE COORDINATE SYSTEM  
POLYCONIC PROJECTION

ALAMANCE  
COPIES OF THIS MAP ARE AVAILABLE TO THE PUBLIC AT A NOMINAL COST  
N.C. DEPARTMENT OF TRANSPORTATION  
3401 CARL SANDERS CT.  
RALEIGH, N.C. 27610  
REVISED  
11/23/09 TRP  
12/20/09 TRP  
5/27/08 TRP  
1/10/09 MG  
10/28/09 MG

Burlington - Gibsonville - Graham vicinity