

Disclaimer: The SRMU's goal is to provide the most accurate information as possible. The magnitude of the data prevents any guarantee of accuracy or completeness. If you find any information that is incorrect, please send your request to the SRMU Section.

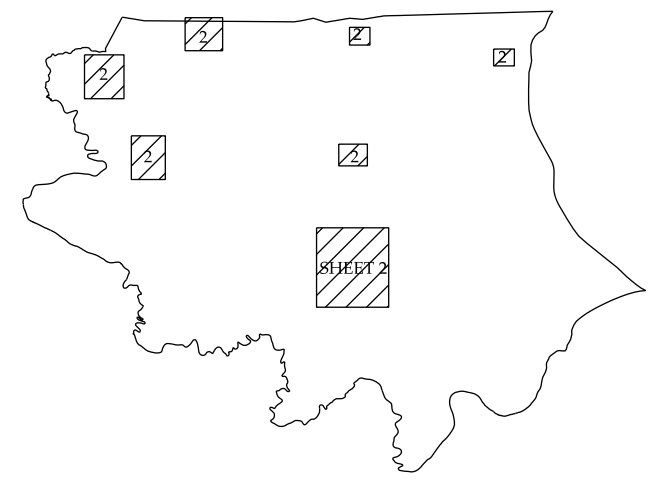

SUPPLEMENT SHEET KEY



WINDSOR

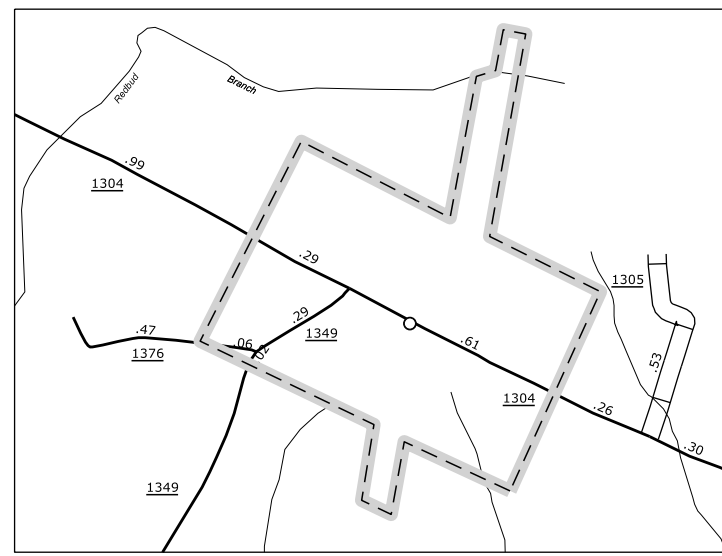

Askewville
Pop. 177

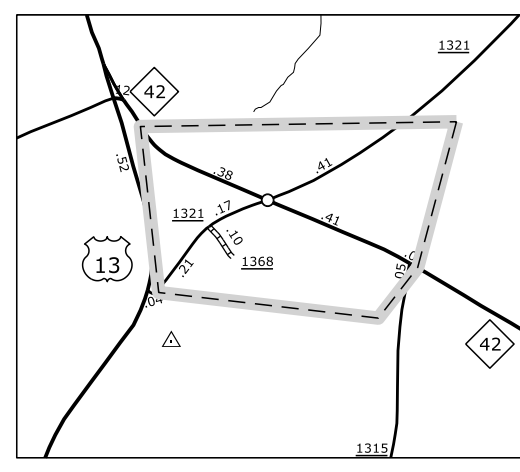

Powellville
POP. 259

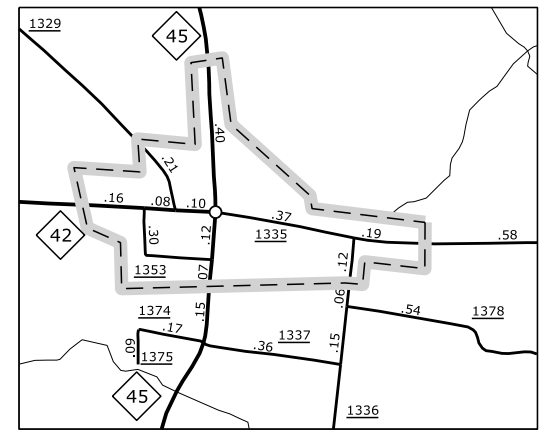

Colrain
Pop. 220

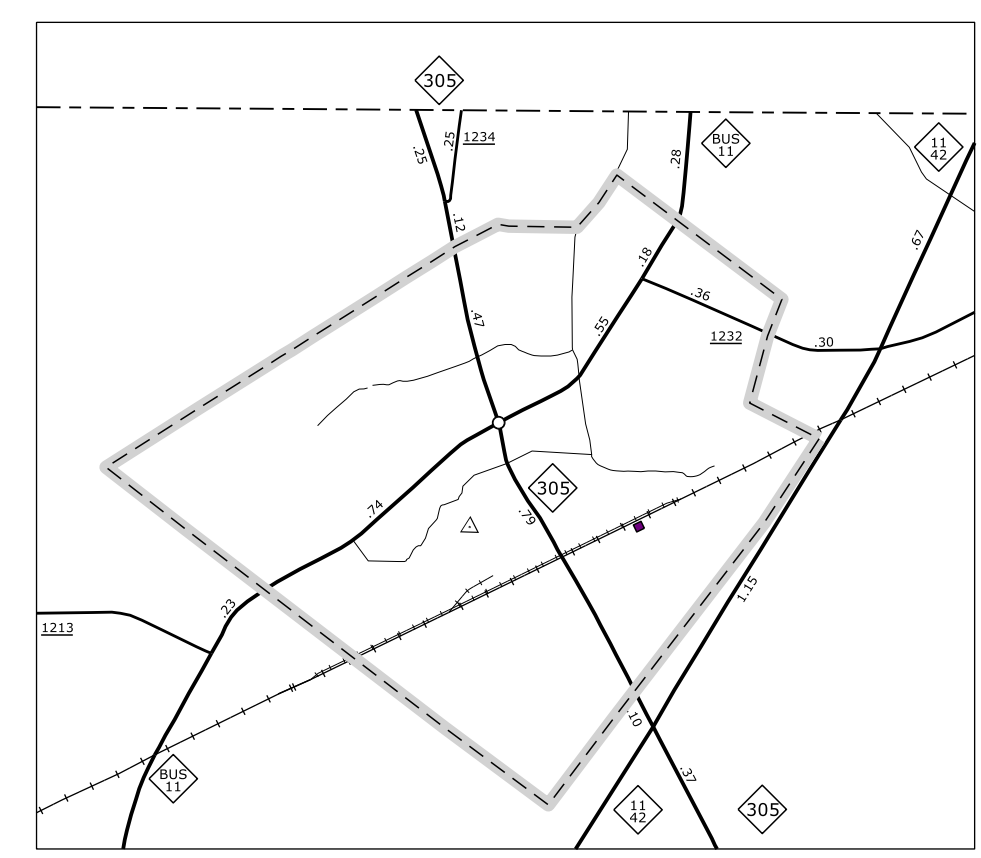

Aulander

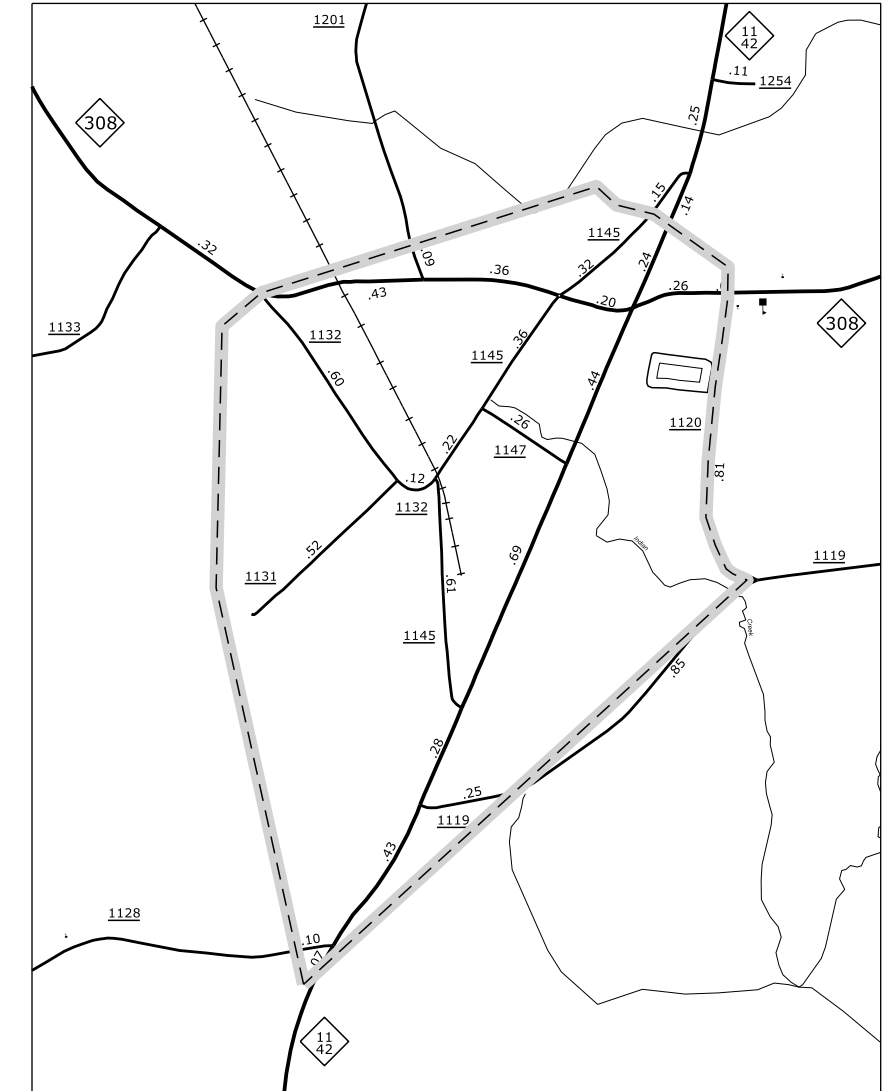

Lewiston Woodville
Pop. 606

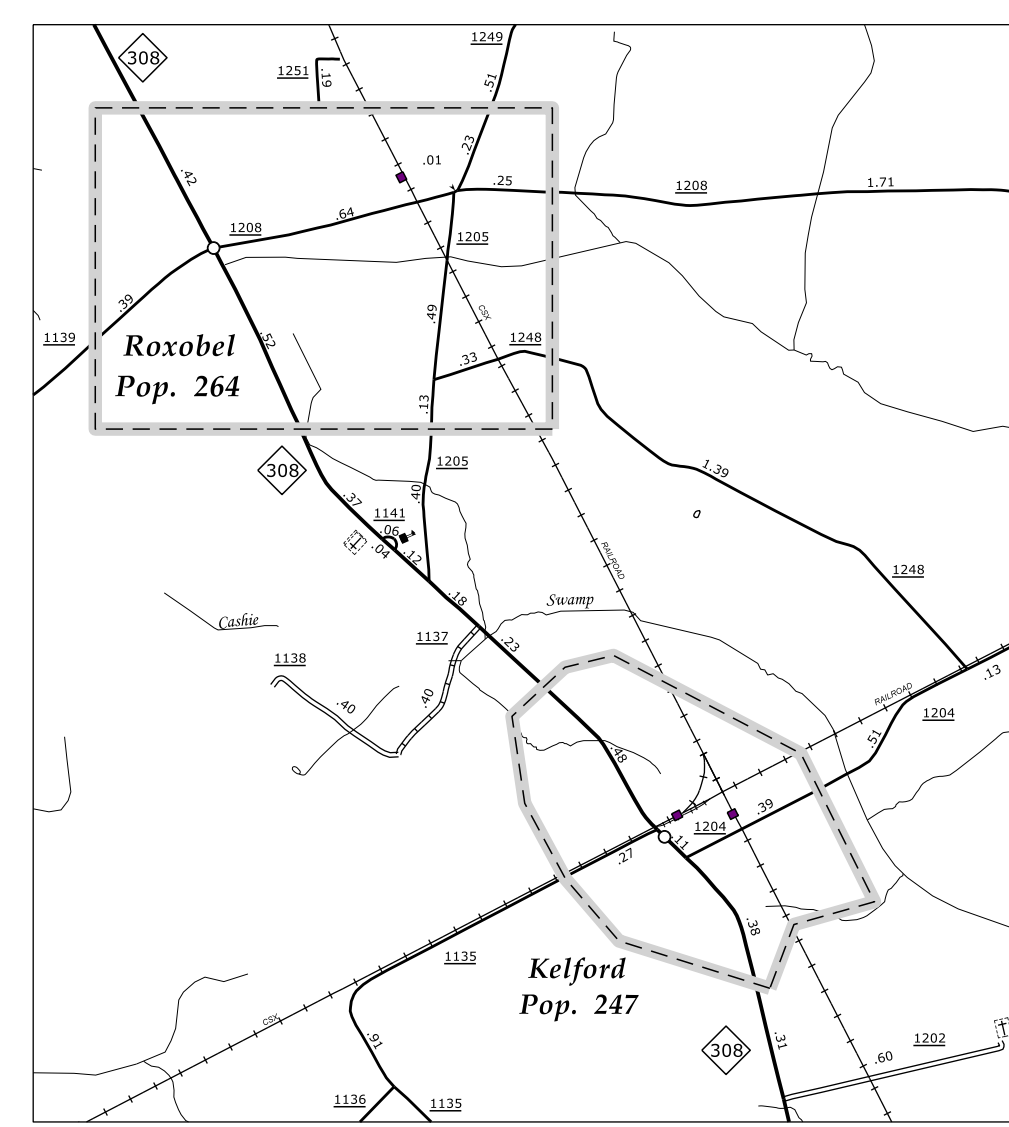

Roxobel and Kelford

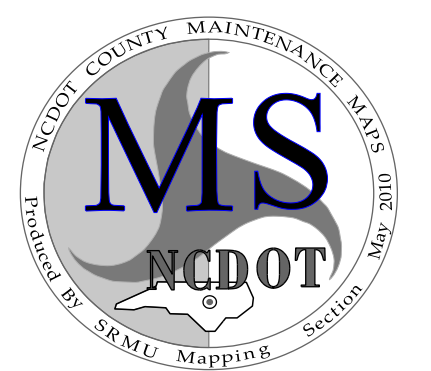
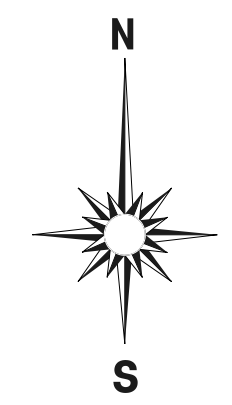

ENLARGED MUNICIPAL AND SUBURBAN AREAS
BERTIE COUNTY
 NORTH CAROLINA
 PREPARED BY THE
 NORTH CAROLINA DEPARTMENT OF TRANSPORTATION
 STATE ROAD MAINTENANCE UNIT - MAPPING SECTION
 IN COOPERATION WITH THE
 U.S. DEPARTMENT OF TRANSPORTATION
 FEDERAL HIGHWAY ADMINISTRATION

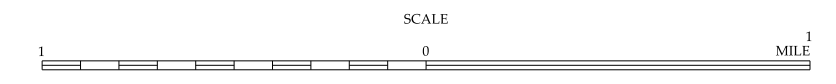

10,000 FOOT GRID BASED ON NORTH CAROLINA PLANE COORDINATE SYSTEM
 POLYCONIC PROJECTION

N.C. DEPARTMENT OF TRANSPORTATION
 STATE ROAD MAINTENANCE UNIT
 3401 CARE SANDBURG CT.
 RALEIGH, N.C. 27610

REVISED
 10/09/08

SUP 1