

Hot Springs

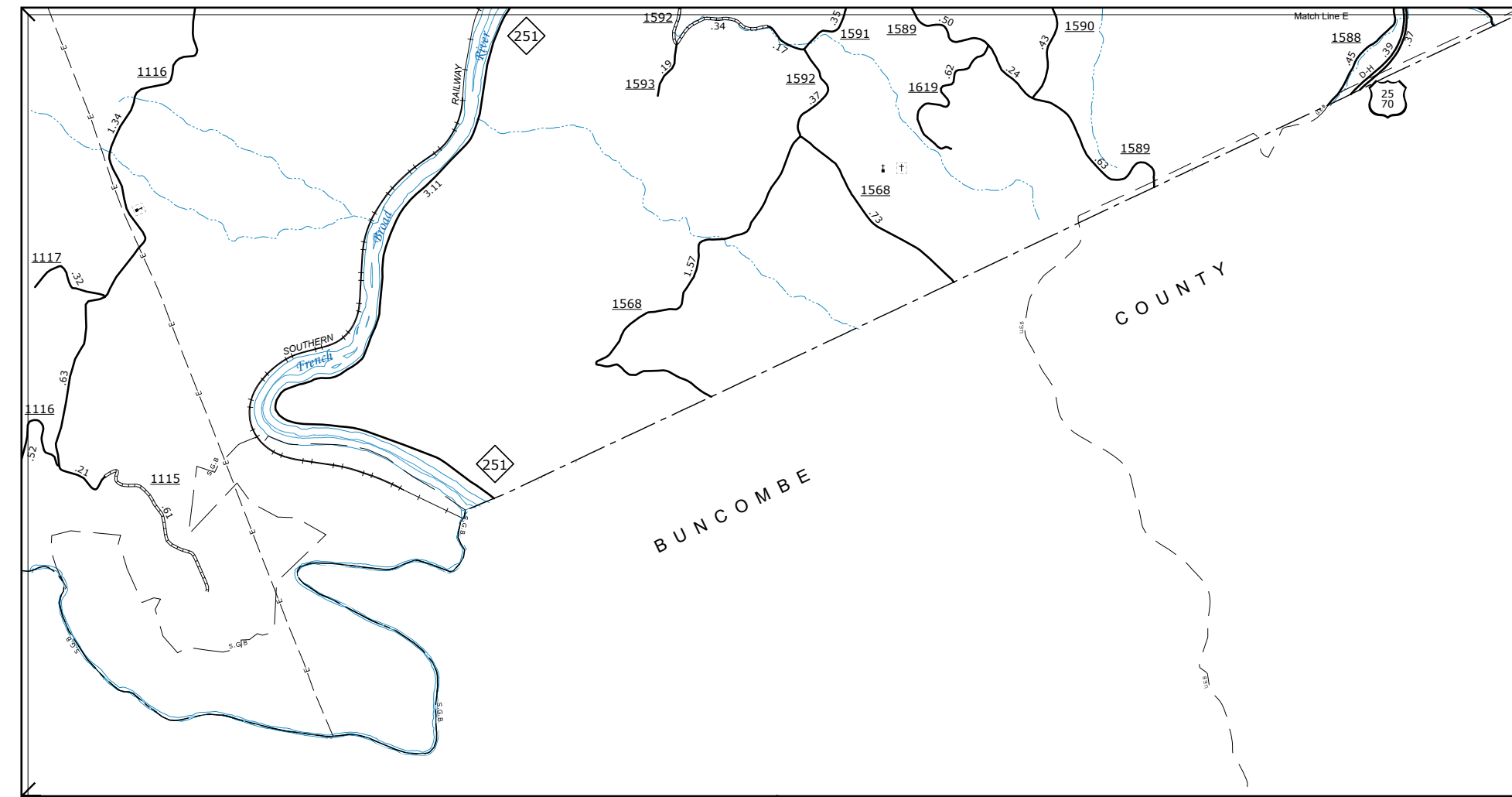

Inset 1

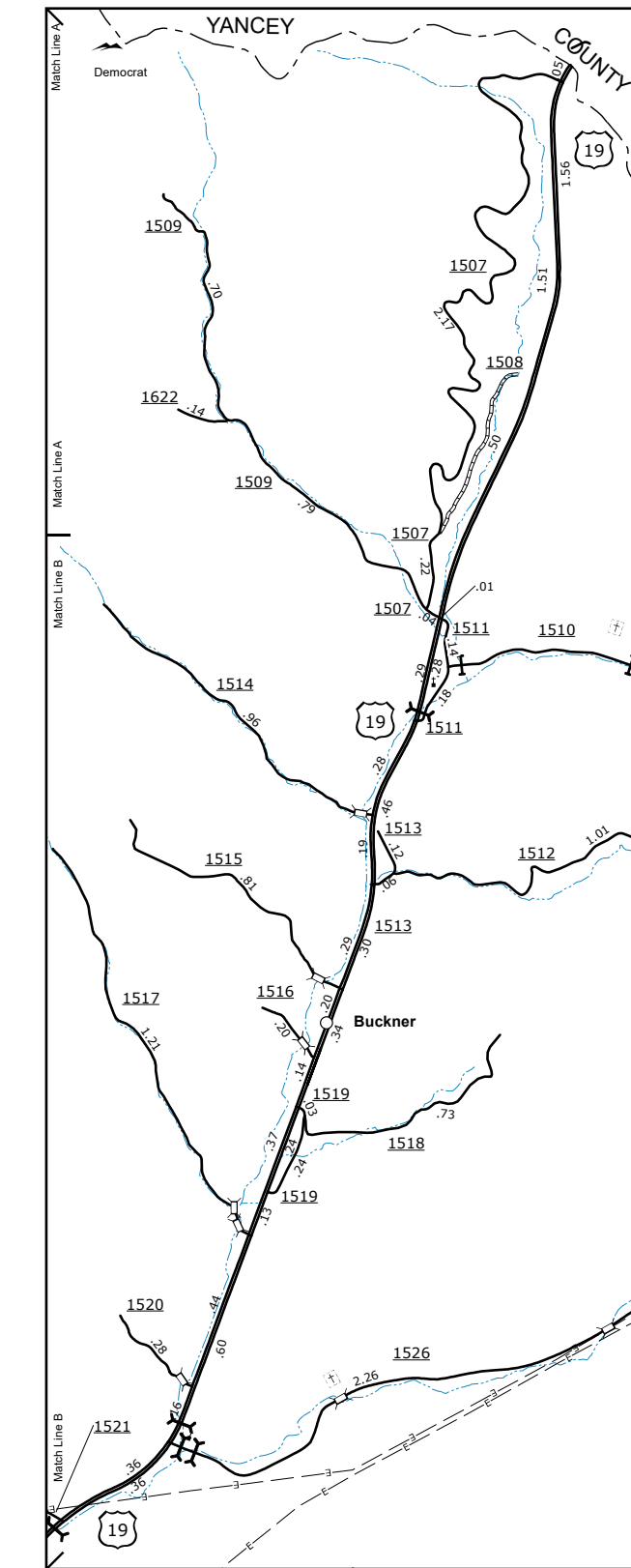

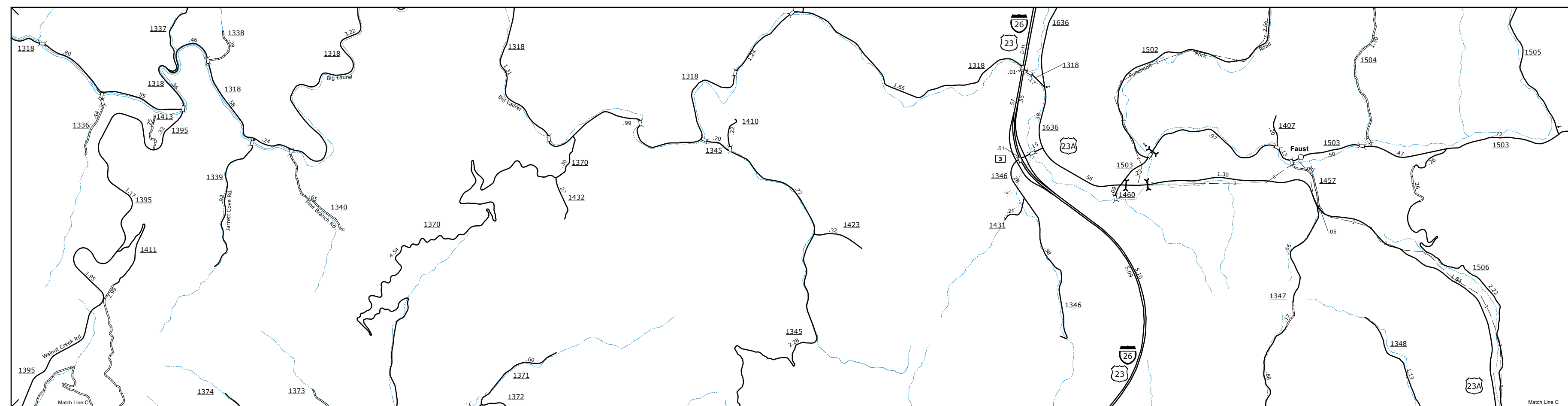

Buckner and Vicinity



Faust and Vicinity

The Mapping Section's goal is to provide the most accurate and current information possible. Map data is compiled from various sources and is subject to change. The data is not intended to be used for legal purposes. The information is provided as a service to the public and is not a warranty. The information is provided as a service to the public and is not a warranty. The information is provided as a service to the public and is not a warranty.

COPIES OF THIS MAP ARE AVAILABLE FOR PURCHASE AT A PUBLIC AT NOMINAL COST. ADDRESS: N.C. DEPARTMENT OF TRANSPORTATION, MSAU-MAPPING SECTION, 4801 BERNI, CD, RALEIGH, NC 27609

ENLARGED MUNICIPAL AND SUBURBAN AREAS
MADISON COUNTY
NORTH CAROLINA
 PREPARED BY THE
 NORTH CAROLINA DEPARTMENT OF TRANSPORTATION
 OPERATIONS PROGRAM MANAGEMENT UNIT - MAPPING SECTION
 IN COOPERATION WITH THE
 U.S. DEPARTMENT OF TRANSPORTATION
 FEDERAL HIGHWAY ADMINISTRATION
 SCALE

 10,000 FOOT GRID BASED ON NORTH CAROLINA PLANE COORDINATE SYSTEM
 LAMBERT CONFORMAL CONIC PROJECTION