

COPIES OF THIS MAP ARE AVAILABLE
 FROM THE NORTH CAROLINA DEPARTMENT OF TRANSPORTATION
 ADDRESS: 4609 BERNI, LENOIR, NC 28756
 TEL: 704/328-2200
 FAX: 704/328-2201
 WWW.NCDEPARTMENTOFTRANSPORTATION.COM

The Mapping Section's goal is to provide the most accurate and current information possible. Map data is compiled from various sources including aerial photography, ground surveys, and other data. The accuracy of the map is dependent on the accuracy of the data. The Mapping Section is not responsible for errors or omissions on this map. For additional information, visit <http://www.ncdot.gov/infocenter/mapping> and click on Data Providers or contact us by phone at (919) 855-8480.

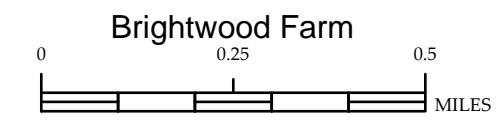

Gibsonville

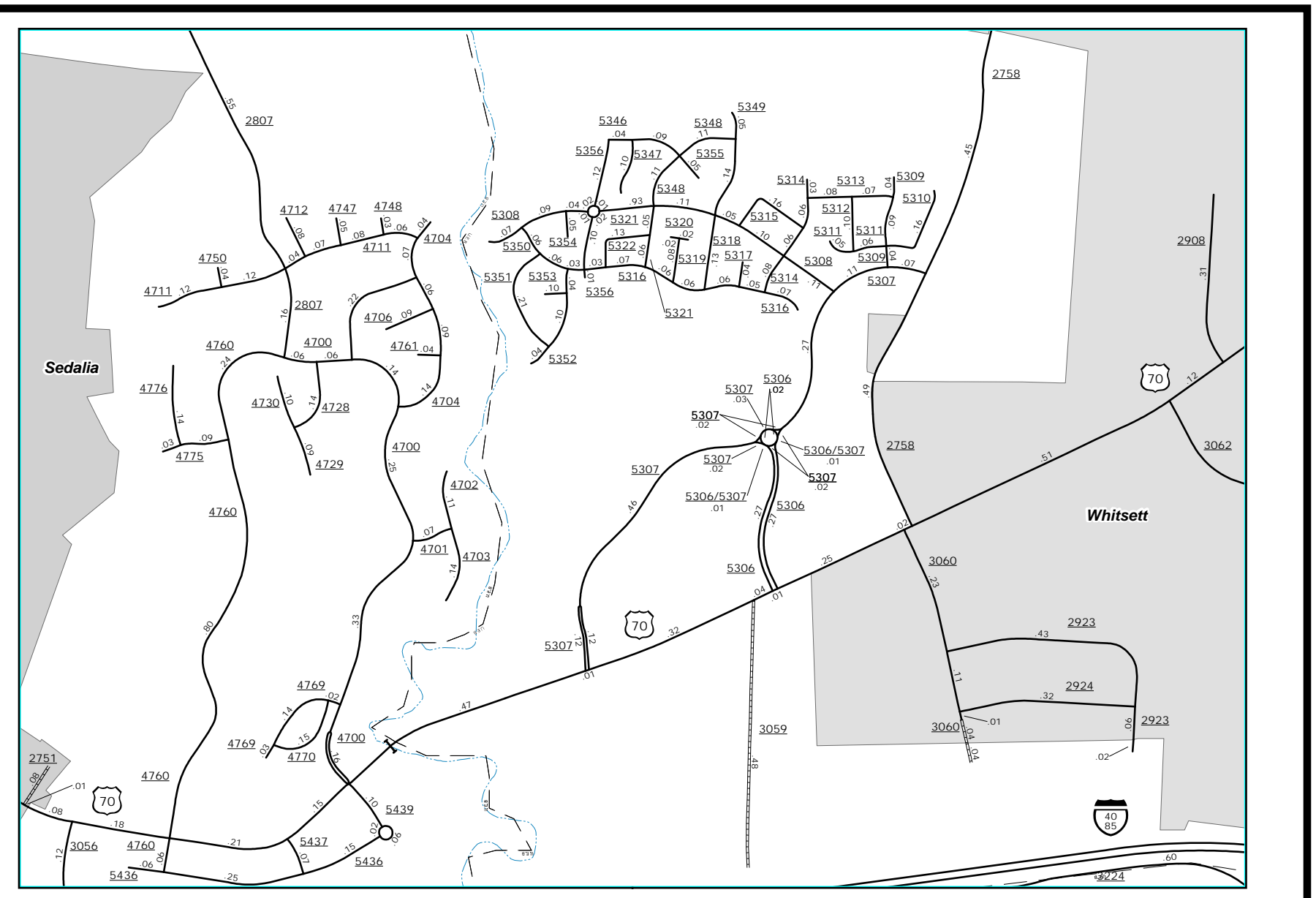
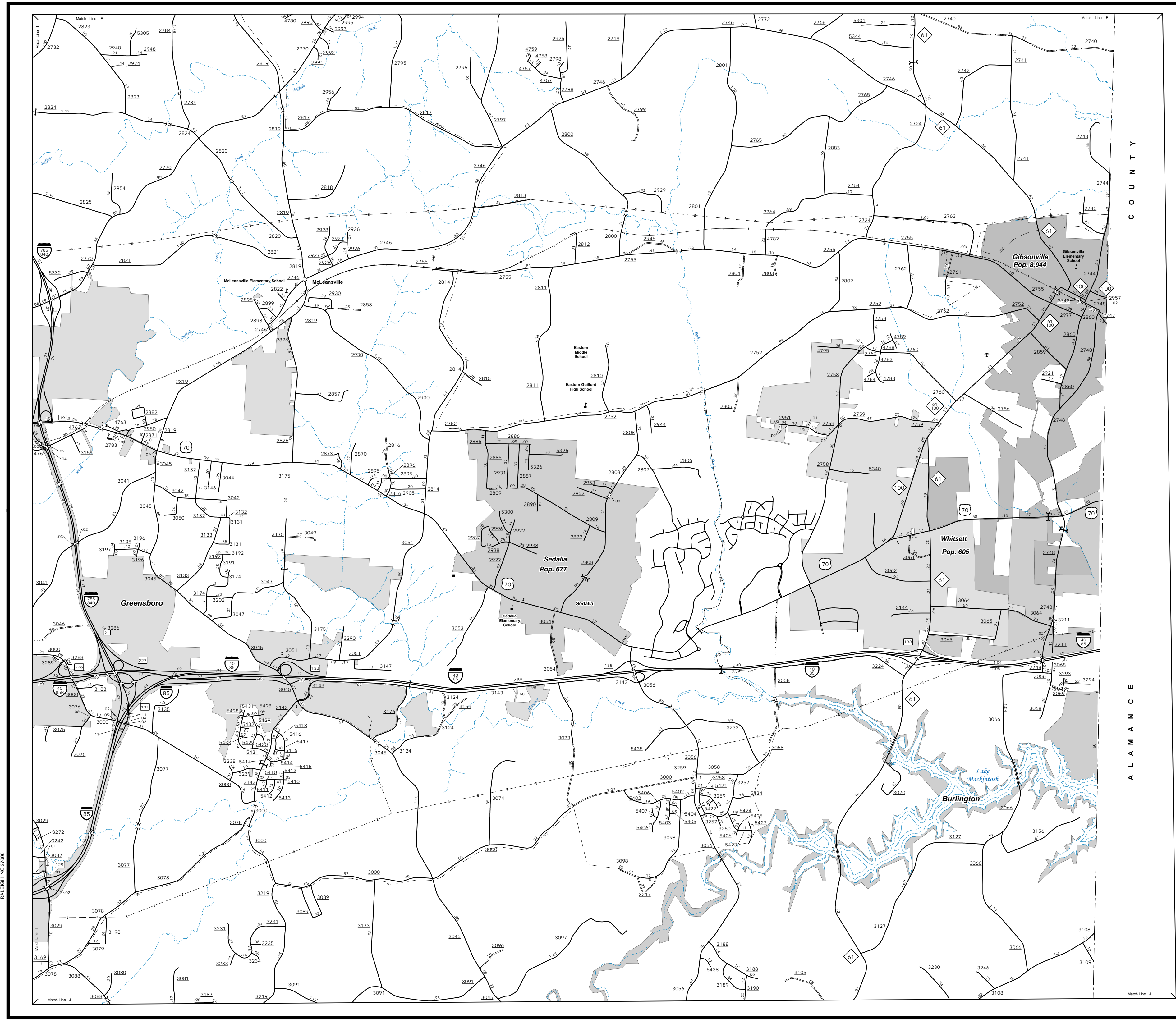

ENLARGED MUNICIPAL AND SUBURBAN AREAS
GUILFORD COUNTY
 NORTH CAROLINA

PREPARED BY THE
 NORTH CAROLINA DEPARTMENT OF TRANSPORTATION
 OPERATIONS PROGRAM MANAGEMENT UNIT - MAPPING SECTION
 IN COOPERATION WITH THE
 U.S. DEPARTMENT OF TRANSPORTATION
 FEDERAL HIGHWAY ADMINISTRATION

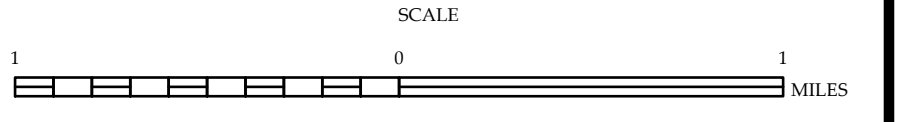

10,000 FOOT GRID BASED ON NORTH CAROLINA PLANE COORDINATE SYSTEM
 LAMBERT CONFORMAL CONIC PROJECTION