

The Mapping Section's goal is to provide the most accurate and current information possible. Map data is gathered from numerous sources with varying dates of publication and map accuracy standards. As a result, the accuracy of the information shown on this map may vary. This map includes state-maintained roads and information on other roads. The information shown on this map was last updated in August 2022. For additional information, visit www.ncdot.gov or contact us at (717) 835-6400.

COPIES OF THIS MAP ARE AVAILABLE TO THE PUBLIC AT NOMINAL COST. ADDRESS: N.C. DEPARTMENT OF TRANSPORTATION, 4800 BERRY RD., SECTION PALESTINE, NC 27958

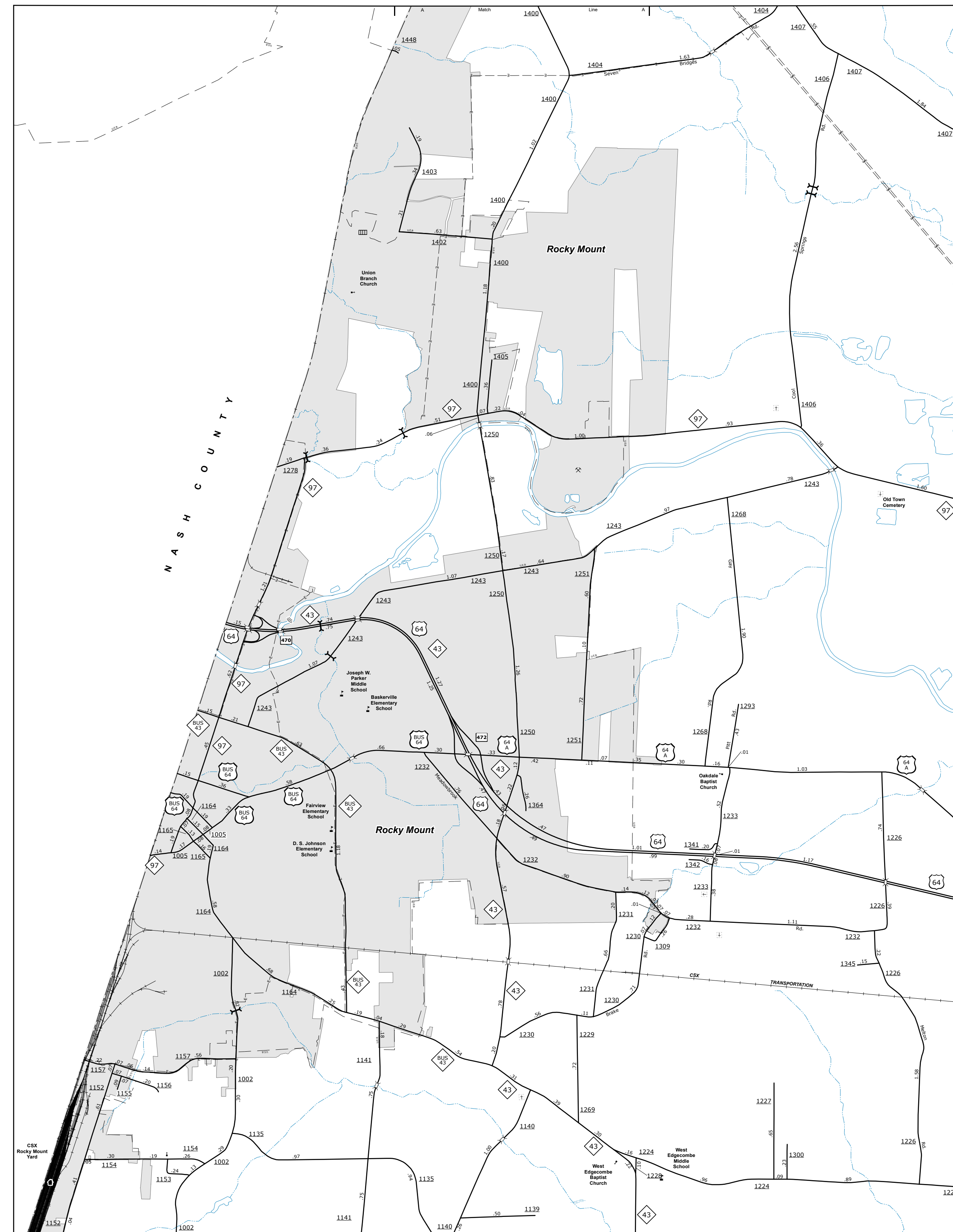

Rocky Mount

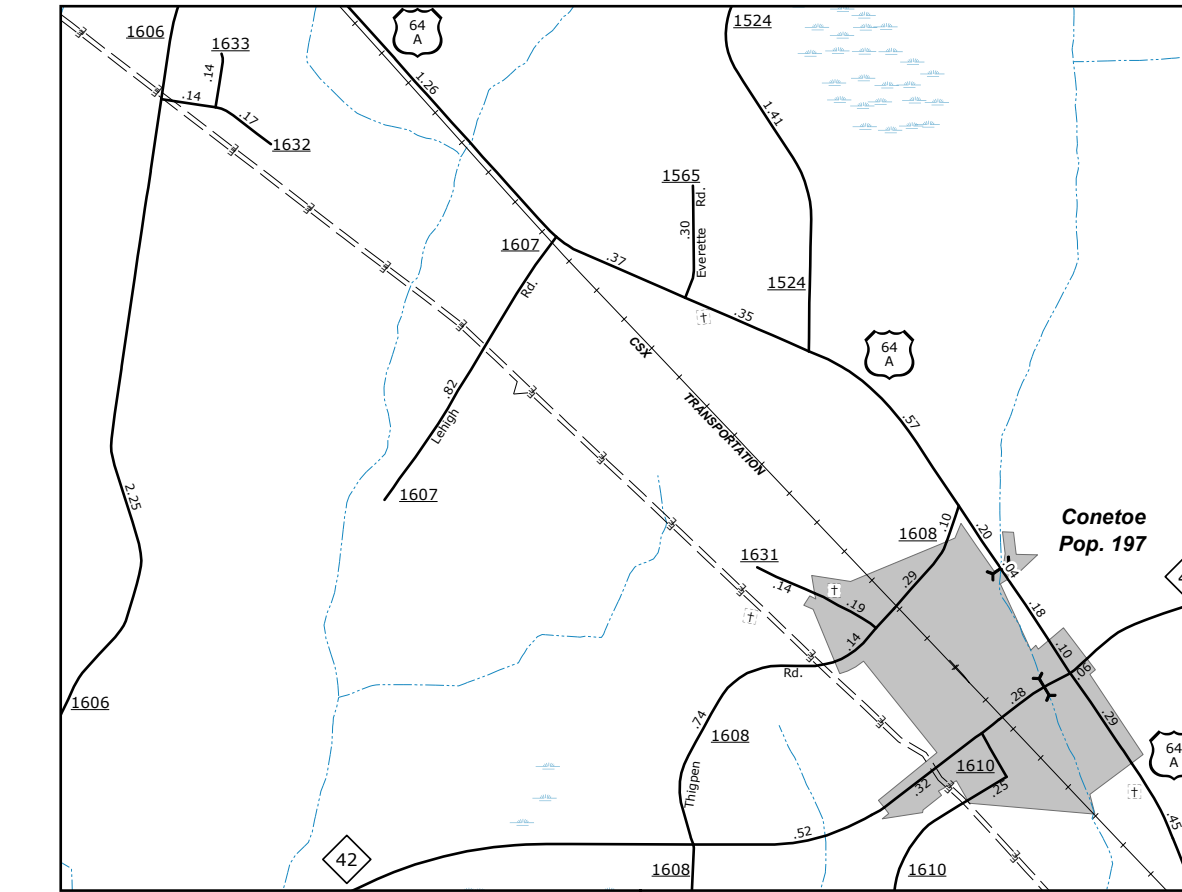

Conetoe

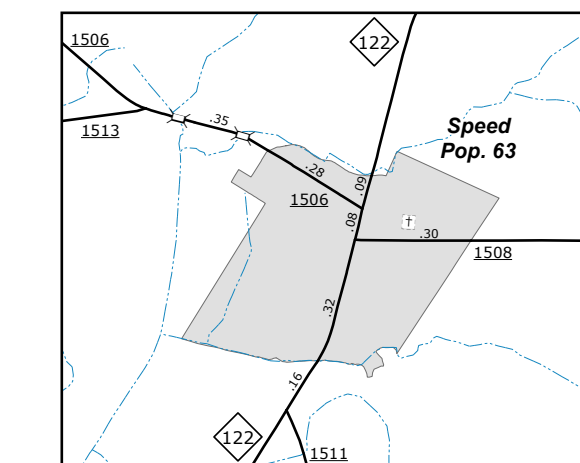

Speed



ENLARGED MUNICIPAL AND SUBURBAN AREAS

**EDGECOMBE COUNTY
NORTH CAROLINA**

PREPARED BY THE
NORTH CAROLINA DEPARTMENT OF TRANSPORTATION
OPERATIONS PROGRAM MANAGEMENT UNIT - MAPPING SECTION
IN COOPERATION WITH THE
U.S. DEPARTMENT OF TRANSPORTATION
FEDERAL HIGHWAY ADMINISTRATION

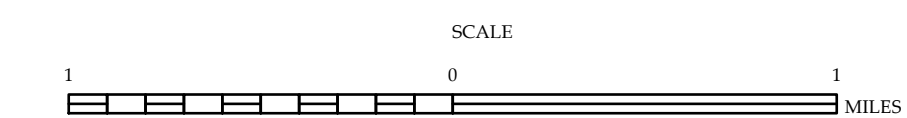

10,000 FOOT GRID BASED ON NORTH CAROLINA PLANE COORDINATE SYSTEM
LAMBERT CONFORMAL CONIC PROJECTION

SHEET 2 OF 3