

TERMS OF USE: The Mapping Section's goal is to provide the most accurate and current information possible. Map data is compiled from the data provided by users. The North Carolina Department of Transportation does not have liability for any errors in the map data. This information is provided for informational purposes only. For additional map products, visit [www.ncdot.gov/Information/MapProducts.aspx](http://www.ncdot.gov/Information/MapProducts.aspx).

COPYIES OF THIS MAP ARE AVAILABLE TO THE PUBLIC AT THE OFFICE OF THE STATE ARCHIVIST, 100 EAST COLLETT STREET, RALEIGH, NC 27603. CONTACT: 919-733-2100

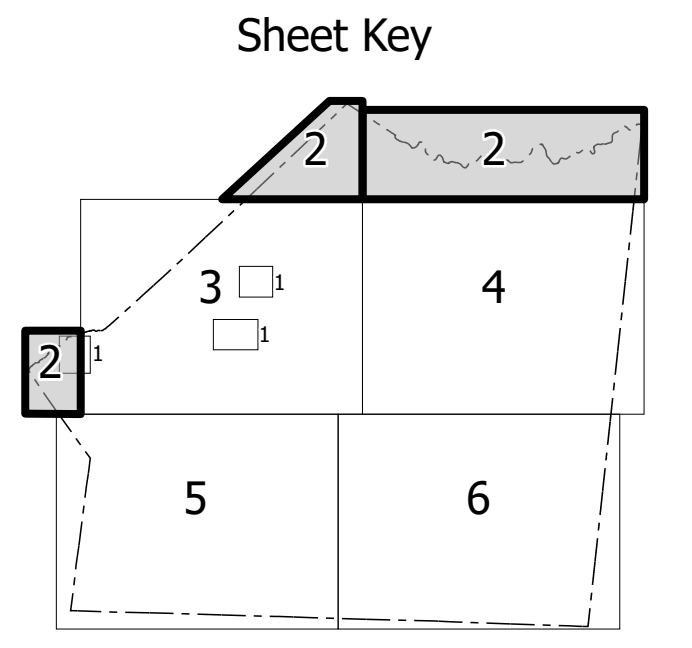

- LEGEND**
- INTERSTATE US NC
  - US Interstate Highway
  - US Numbered Highway
  - US Numbered Bicycle Route
  - Secondary Road Number
  - Utility Lines
  - Railroad Line
  - Railroad Station
  - Point Area
  - State Line
  - County Line
  - Smoothed Urban Boundaries
  - City Limits
  - Ferry Route and Ramp
  - Swamp
  - Community
  - County Seat
  - School
  - College or University
  - Hospital
  - Coast Guard Station
  - Church
  - Police Station
  - Correction or Penal Institution
  - Quarry
  - Shed or Pit
  - Industrial Garage or Plant Yard
  - Highway Dept. or Dist. Office
  - Military Post
  - Wildlife Refuge
  - National State Park Boundary
  - Game Lands Boundary
  - Military Reservation Boundary
  - Indian Reservation Boundary
  - National State Forest Boundary
  - Wildlife Refuge
  - National State Park Boundary
  - Game Lands Boundary
  - Military Reservation Boundary
  - Indian Reservation Boundary

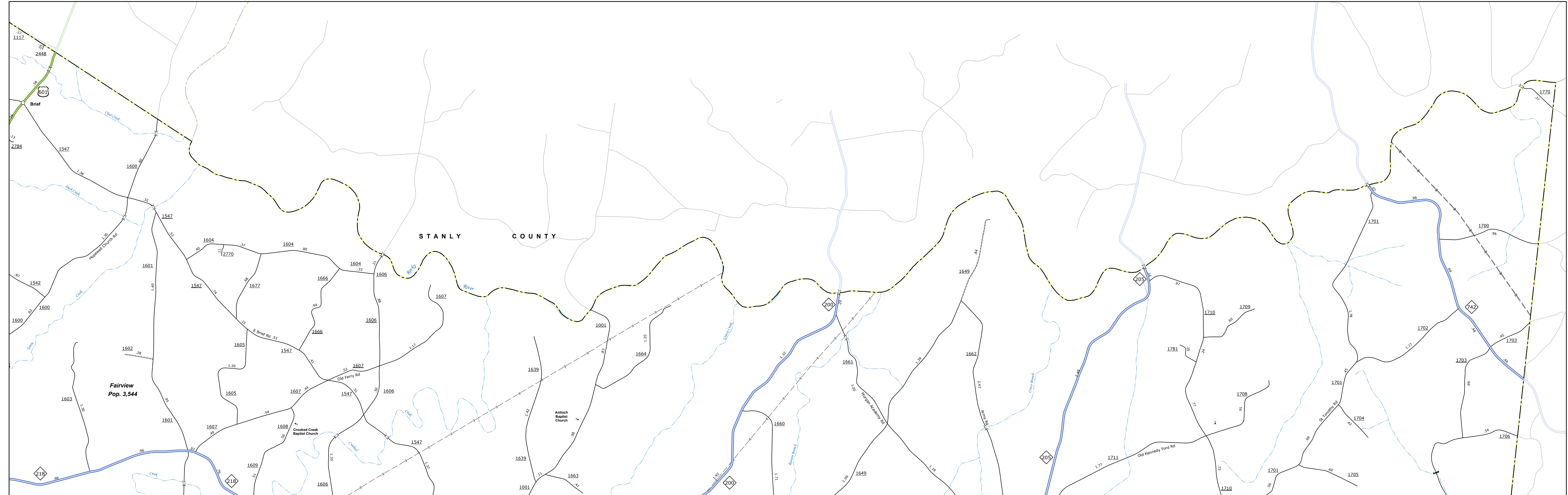
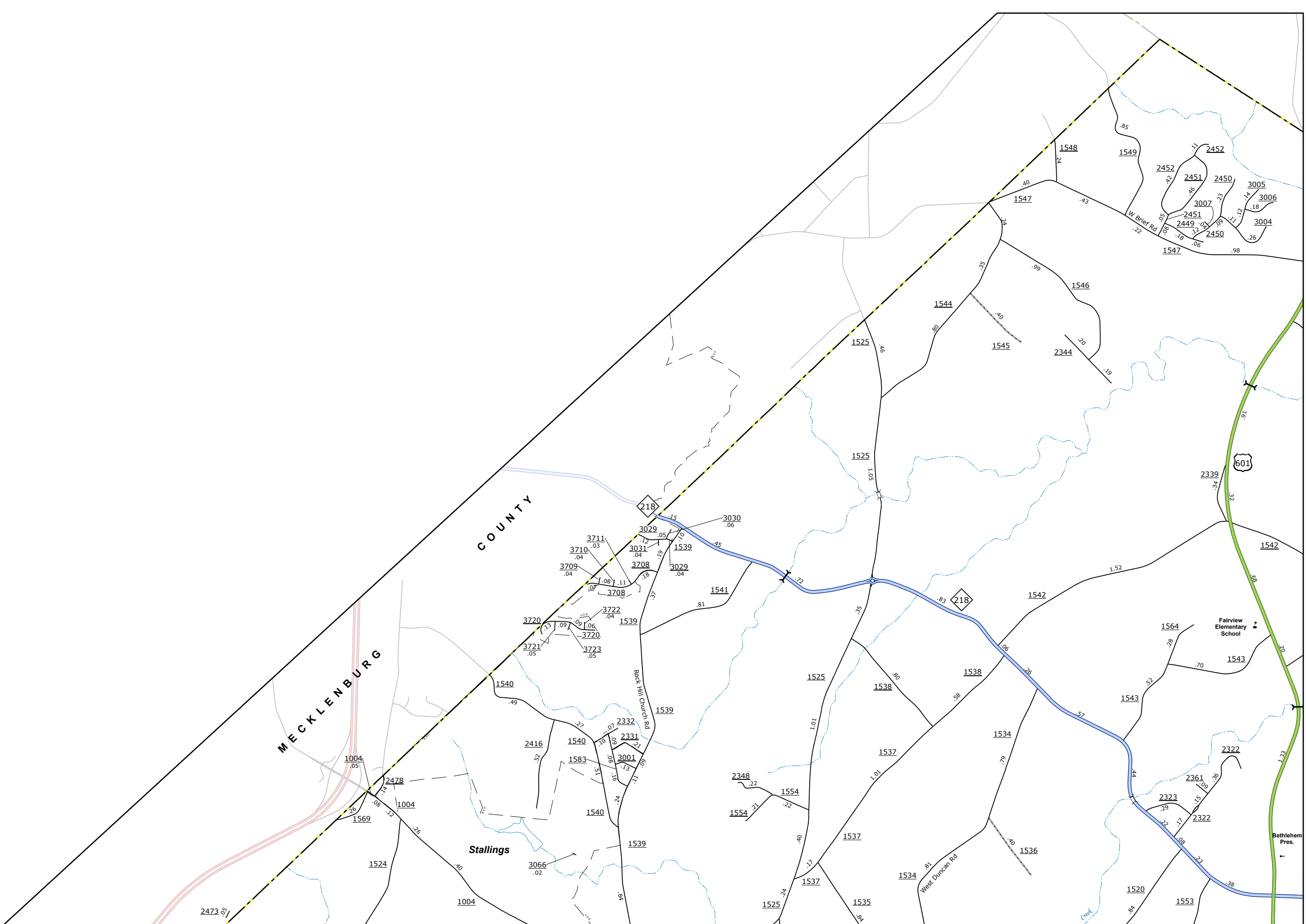
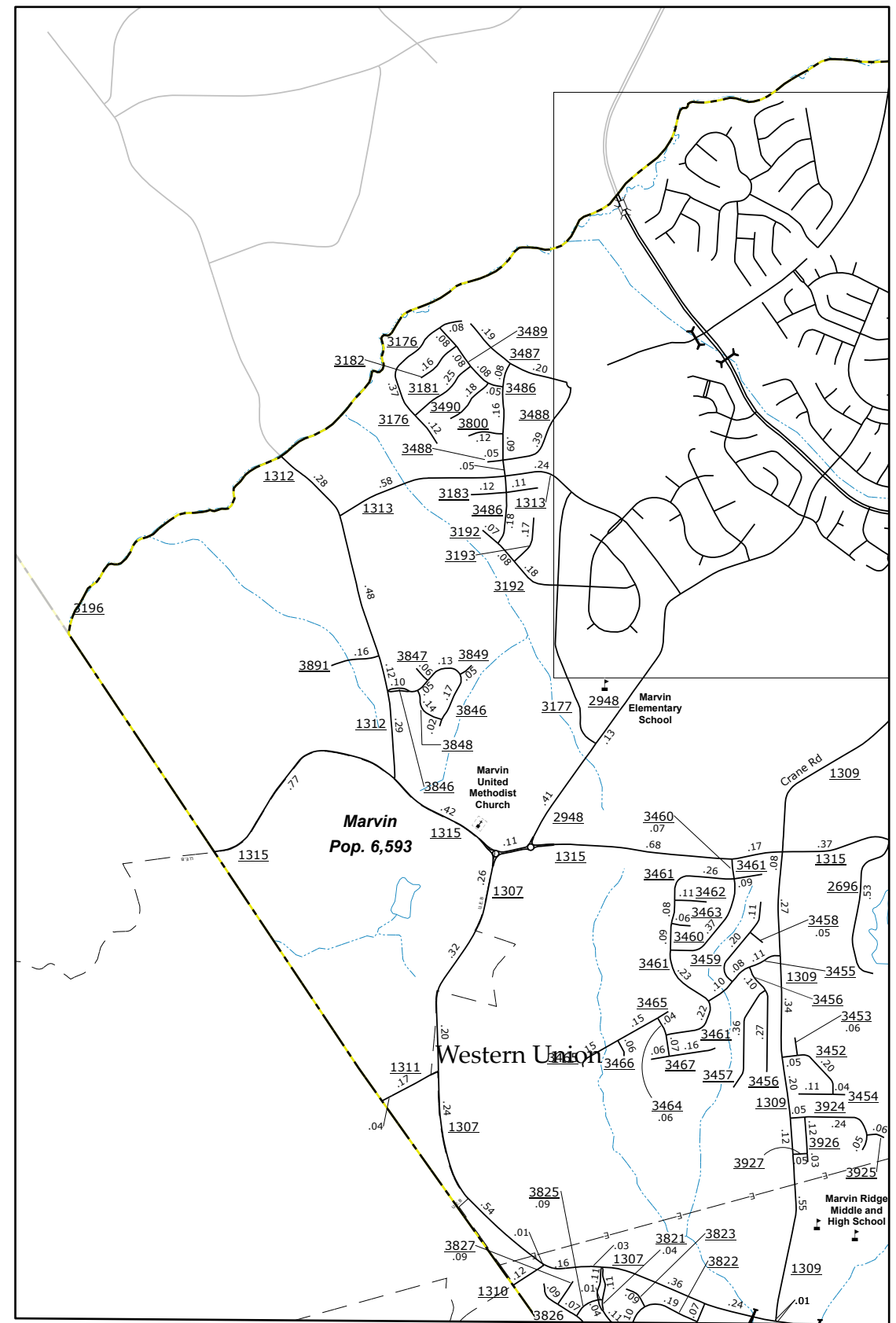

**UNION COUNTY  
NORTH CAROLINA**

PREPARED BY THE  
NORTH CAROLINA DEPARTMENT OF TRANSPORTATION  
OPERATIONS PROGRAM MANAGEMENT UNIT - MAPPING SECTION  
IN COOPERATION WITH THE  
U.S. DEPARTMENT OF TRANSPORTATION  
FEDERAL HIGHWAY ADMINISTRATION

SCALE  
1 0 1  
MILES

NORTH CAROLINA PLANE COORDINATE SYSTEM  
LAMBERT CONFORMAL CONIC PROJECTION