

TERMS OF USE: The Mapping Section's goal is to provide the most accurate and current information possible. Map data is compiled from the data provided by the North Carolina Department of Transportation and the local municipalities. The data is provided "AS IS". The North Carolina Department of Transportation and the local municipalities are not liable for any errors or omissions on this map. This map is a reproduction of the original map and is not a substitute for the original map. For a digital copy of this map or additional view products, visit <http://dotnc.com/transportation/Mapping/Products/Maps>.

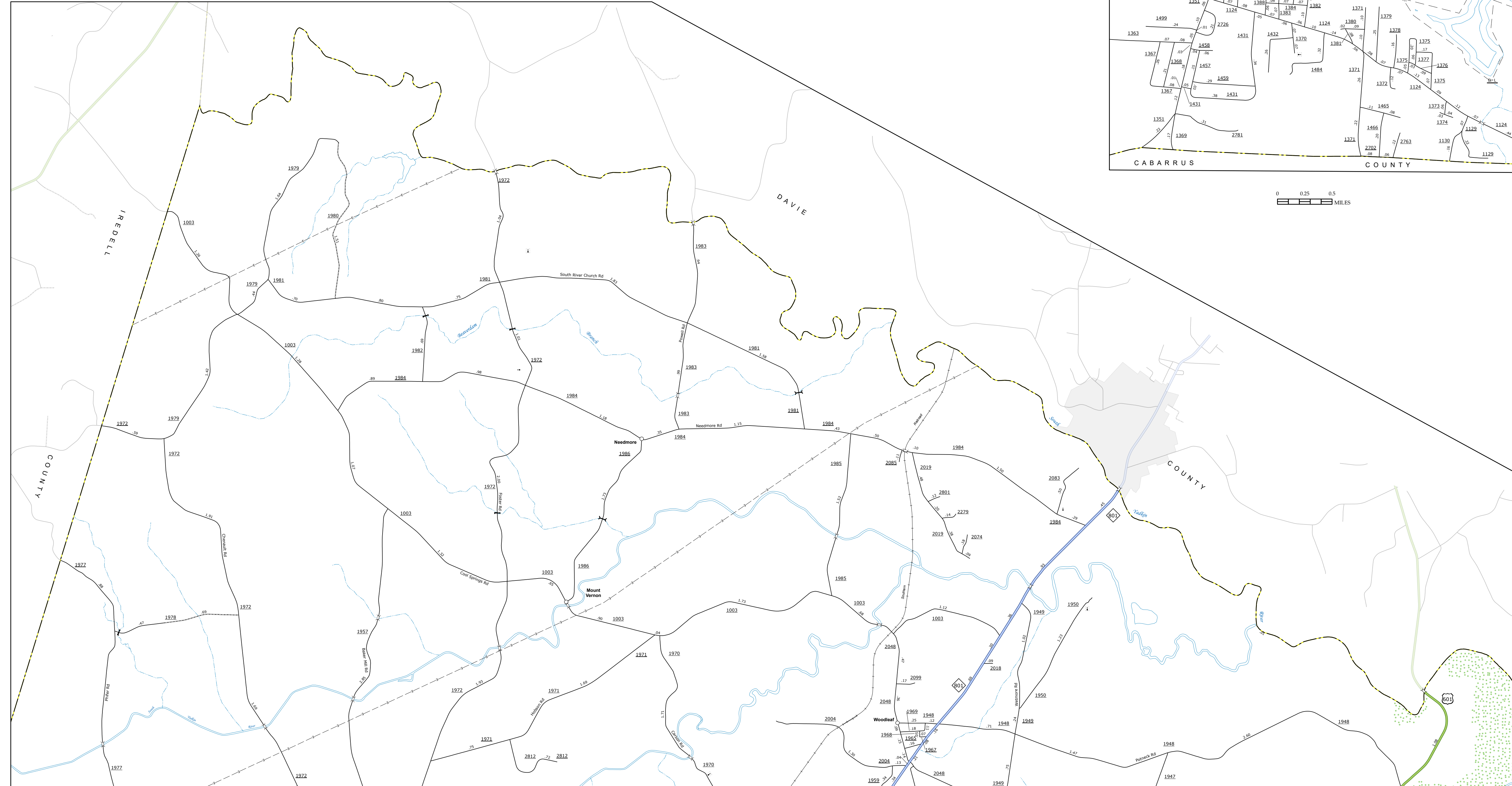

- LEGEND
INTERSTATE US NC
RUEE BRIDGE PASSAGE
UNPAVED ROAD
PAVED ROAD
ROAD TYPE

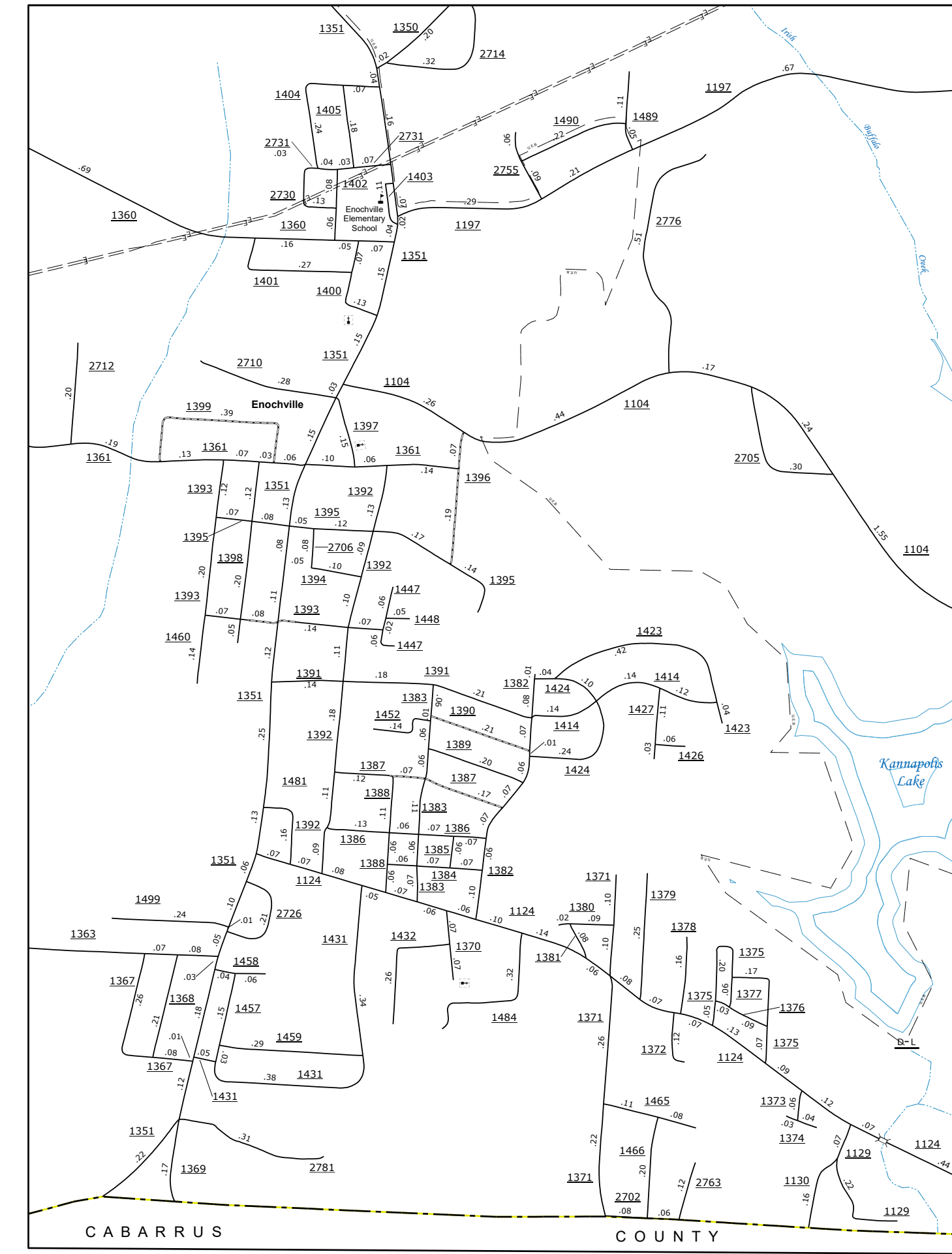
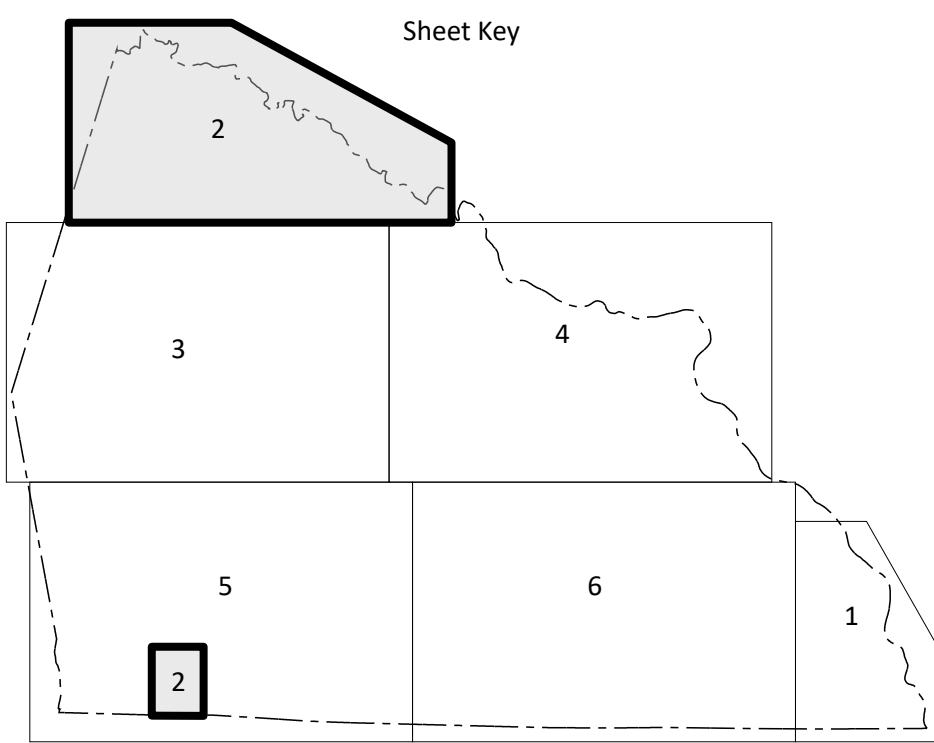
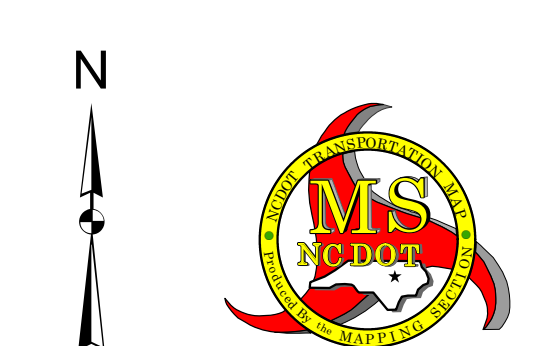
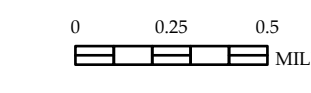

ROWAN COUNTY NORTH CAROLINA

PREPARED BY THE NORTH CAROLINA DEPARTMENT OF TRANSPORTATION OPERATIONS PROGRAM MANAGEMENT UNIT - MAPPING SECTION IN COOPERATION WITH THE U.S. DEPARTMENT OF TRANSPORTATION FEDERAL HIGHWAY ADMINISTRATION

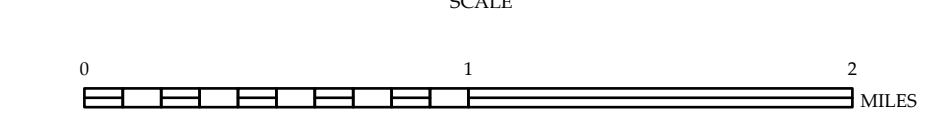

NORTH CAROLINA PLANE COORDINATE SYSTEM LAMBERT CONFORMAL CONIC PROJECTION

COPIES OF THIS MAP ARE AVAILABLE TO THE PUBLIC AT THE FOLLOWING CONTACT INFORMATION: STATE OF NORTH CAROLINA DEPARTMENT OF TRANSPORTATION 800 N. WILKIE AVENUE WILKIE, NC 27694-9298 704.471.4200