

TERMS OF USE: The Mapping Section's goal is to provide the most accurate and current information possible. Map data is compiled from the data provided by users. The North Carolina Department of Transportation does not bear any responsibility for any errors in the map data. This map is for informational purposes only. For original copies of this map or additional map products, visit www.ncdot.gov.

COPYIES OF THIS MAP ARE AVAILABLE TO THE PUBLIC. CONTACT US TO OBTAIN A COPY. www.ncdot.gov

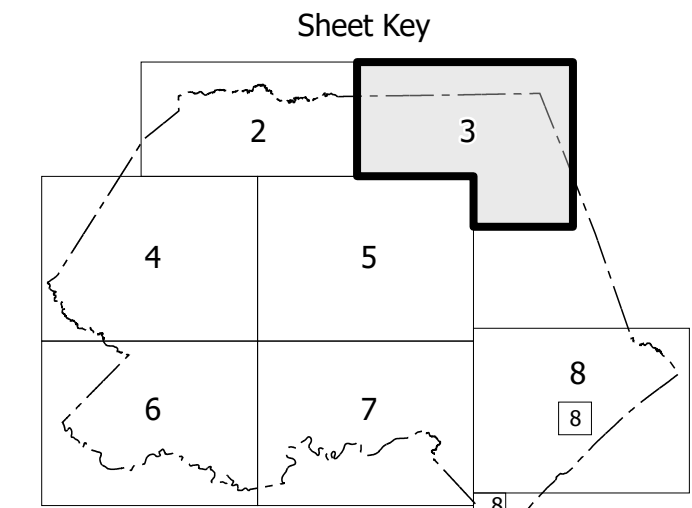

- LEGEND**
- INTERSTATE US NC
 - Divided Hwy
 - Undivided Hwy
 - HEAVY TRUCK PARKWAY
 - UNPAVED SHOULDER ROAD
 - HARD SURF REPAVED ROAD
 - WOOLY STAR ROAD
 - PROVISIONALLY DRAWN ROAD
 - PREDICTED ROAD
 - INTERESTED DISTANCE
 - STANDARD ROAD BRIDGE
 - RAILROAD BRIDGE
 - DRAWN SPAN OF BRIDGE
 - PEDESTRIAN BRIDGE
 - PEDESTRIAN WALKWAY
 - PEDESTRIAN UNDERPASS
 - VEHICLE UNDERPASS
 - CULVERT
 - TUNNEL
 - PIVOT
 - PIVOT
 - INTERSTATE HIGHWAY
 - US NUMBERED HIGHWAY
 - NC NUMBERED HIGHWAY
 - US NUMBERED BI-CYCLE ROUTE
 - NC NUMBERED BI-CYCLE ROUTE
 - INTERSTATE INTERCHANGE NUMBER
 - SECONDARY ROAD NUMBER
 - UTILITY LINE
 - RAILROAD LINE
 - RAILROAD STATION
 - POST OFFICE
 - SHEET LINE
 - COUNTY LINE
 - SMOOTHED URBAN BOUNDARIES
 - CITY LIMITS
 - FERRY ROUTE AND RAMP
 - SANDWICH CREEK OR STREAM
 - WIDE RIVER OR BEAK
 - RESERVOIR, POND OR LAKE W/ ISLAND
 - DAM OR DAM WITH LOCK
 - WATERFALL
 - SWAMP
 - COMMUNITY
 - COUNTY SEAT
 - SCHOOL
 - COLLEGE OR UNIVERSITY
 - HOSPITAL
 - COAST GUARD STATION
 - CHURCH
 - CENTER WITH CEMETERY
 - CEMETERY
 - PARK STATION
 - CORRECTION OR PENAL INSTITUTION
 - QUARRY
 - SEWER OR PIT
 - INDUSTRIAL GARAGE OR MAINT YARD
 - HIGHWAY DEP. OR DIST. OFFICE
 - MILITARY POST
 - WATER TOWER
 - FARMHOUSE
 - HISTORICAL SITE
 - POINTS OF INTEREST
 - POST OFFICE
 - STATE FOREST
 - LIGHTHOUSE
 - MOUNTAIN SUMMIT
 - DISCONTINUED GAP
 - OVERLOOK
 - REST AREA
 - VISITOR CENTER AREA
 - WELCOME CENTER AREA
 - AIRPORT
 - MILITARY AIRPORT
 - NATIONAL STATE FOREST BOUNDARY
 - WILDLIFE REFUGE
 - NATIONAL STATE PARK BOUNDARY
 - GAME LANDS BOUNDARY
 - MILITARY RESERVATION BOUNDARY
 - INDIAN RESERVATION BOUNDARY

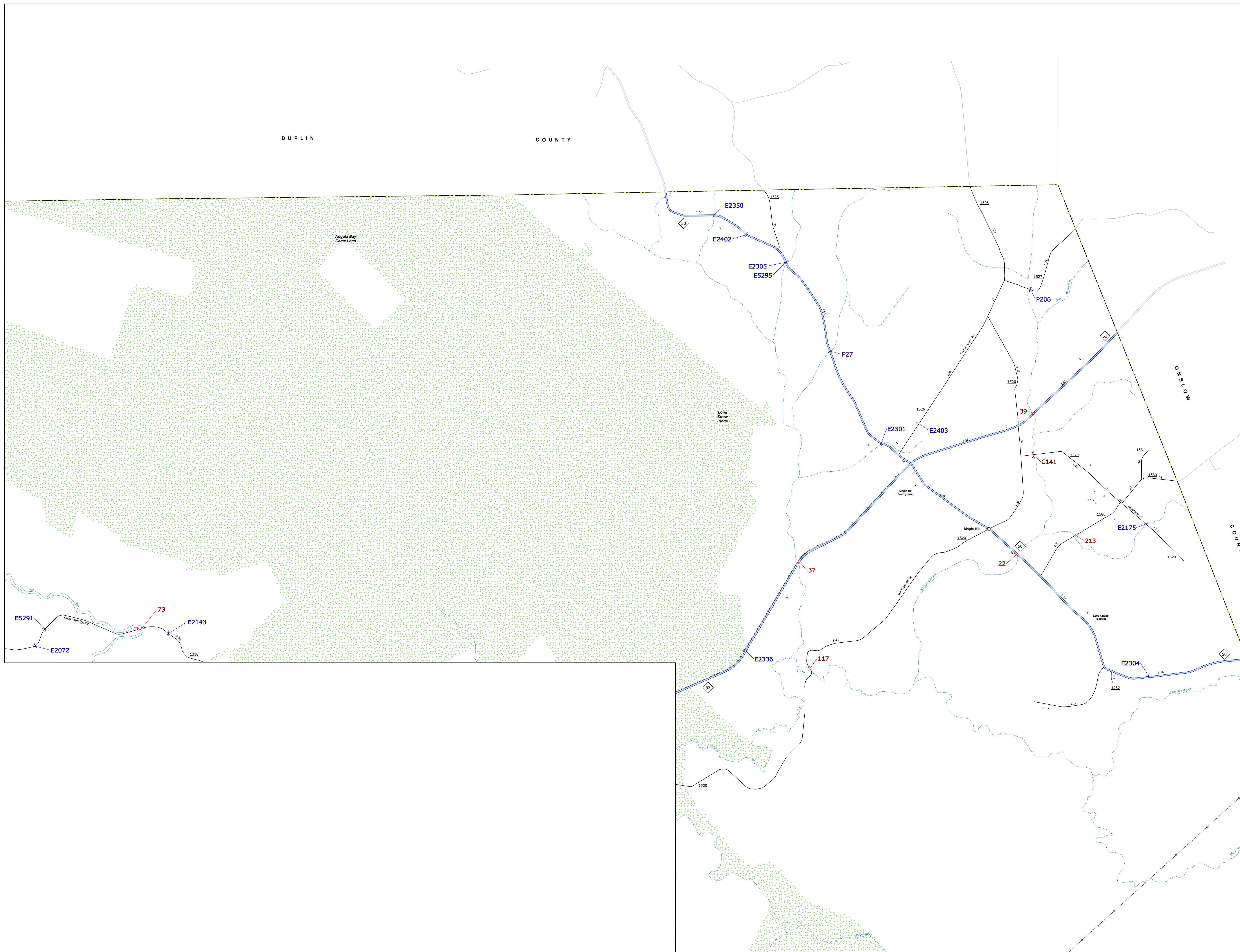
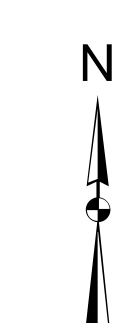

**PENDER COUNTY
NORTH CAROLINA**

PREPARED BY THE
NORTH CAROLINA DEPARTMENT OF TRANSPORTATION
OPERATIONS PROGRAM MANAGEMENT UNIT - MAPPING SECTION
IN COOPERATION WITH THE
U.S. DEPARTMENT OF TRANSPORTATION
FEDERAL HIGHWAY ADMINISTRATION

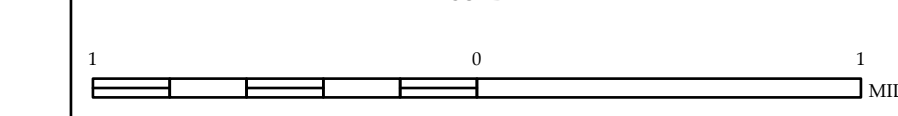

NORTH CAROLINA PLANE COORDINATE SYSTEM
LAMBERT CONFORMAL CONIC PROJECTION