

TERMS OF USE: The Mapping Section's goal is to provide the most accurate and current information possible. Map data is compiled from the data provided to us by the North Carolina Department of Transportation and is not to be used for any purpose other than that for which it was provided. For original copies of this map or additional map products, visit <http://www.ncdot.gov/MapProducts>.

COPIES OF THIS MAP ARE AVAILABLE TO THE PUBLIC AT THE OFFICE OF THE COUNTY ENGINEER, 100 NORTH MAIN STREET, BELGRADE, NC 27812.

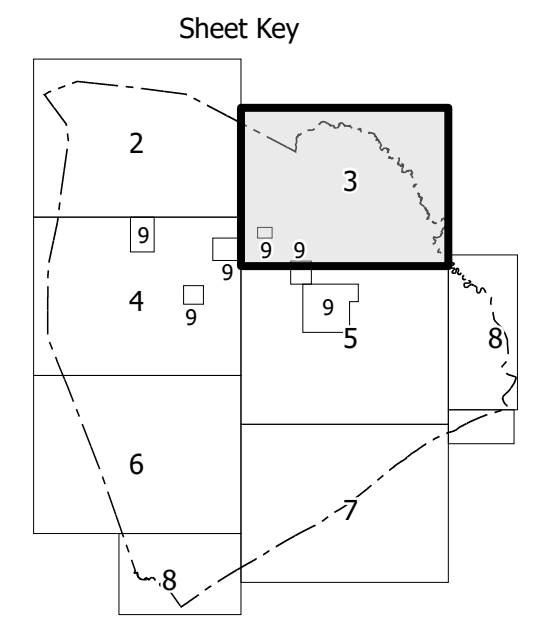

- LEGEND**
- INTERSTATE US NC
 - Divided Hwy
 - Undivided Hwy
 - HULE RIDGE PARKWAY
 - COMBINED SURFACED ROAD
 - HARD SURFACED ROAD
 - NON-SYSTEM ROAD
 - PROFESSIONALLY SURFACED ROAD
 - PROJECT TITLE LOCATION
 - INTERSECTION BRIDGE
 - STANDARD ROAD BRIDGE
 - RAILROAD BRIDGE
 - TRUSS SPAN BRIDGE
 - PIER TRUSS BRIDGE
 - PIER TRUSS UNDERPASS
 - TRUSS UNDERPASS
 - TUNNEL
 - RAILROAD
 - RAILROAD
 - INTERSTATE HIGHWAY
 - U.S. NUMBERED HIGHWAY
 - U.S. NUMBERED HIGHWAY
 - U.S. NUMBERED BI-CYCLE ROUTE
 - N.C. NUMBERED BI-CYCLE ROUTE
 - INTERSTATE INTERCHANGE NUMBER
 - SECONDARY ROAD NUMBER
 - UTILITY LINES
 - RAILROAD LINE
 - RAILROAD STATION
 - POST AREA
 - STATE LINE
 - COUNTY LINE
 - UNINCORPORATED TOWN BOUNDARIES
 - CITY LIMITS
 - FERRY ROUTE AND RAMP
 - CREEK OR STREAM
 - WIDE RIVER OR CREEK
 - RESERVOIR, POND OR LAKE W/ ISLAND
 - DAM OR DAM WITH LOCK
 - WATERFALL
 - SHADE
 - COMBENEY
 - COUNTY SEAT
 - CITY
 - COLLEGE OR UNIVERSITY
 - HOSPITAL
 - COAST GUARD STATION
 - CHURCH
 - CHURCH WITH CEMETERY
 - CEMETERY
 - POSSIBLE STATION
 - CORRECTION OR PENAL INSTITUTION
 - GRAND
 - REST OR PTE
 - HIGHWAY GARAGE OR MAINT. YARD
 - HIGHWAY DIV. OR DIST. OFFICE
 - MILITARY POST
 - TRUCK STATION
 - FARMGROUNDS
 - RESERVOIR SITE
 - POINTS OF INTEREST
 - POST OFFICE
 - STATE FOREST
 - HOBBY
 - MOUNTAIN SUMMIT
 - MOUNTAIN GAP
 - OVERLOOK
 - REST AREA
 - UNIMPROVED REST AREA
 - WELCOME TO REST AREA
 - AIRPORT
 - MILITARY AIRPORT
 - NATIONAL STATE FOREST BOUNDARY
 - WILDLIFE REFUGE
 - NATIONAL STATE PARK BOUNDARY
 - GAME LANDS BOUNDARY
 - MILITARY RESERVATION BOUNDARY
 - DISARM RESERVATION BOUNDARY

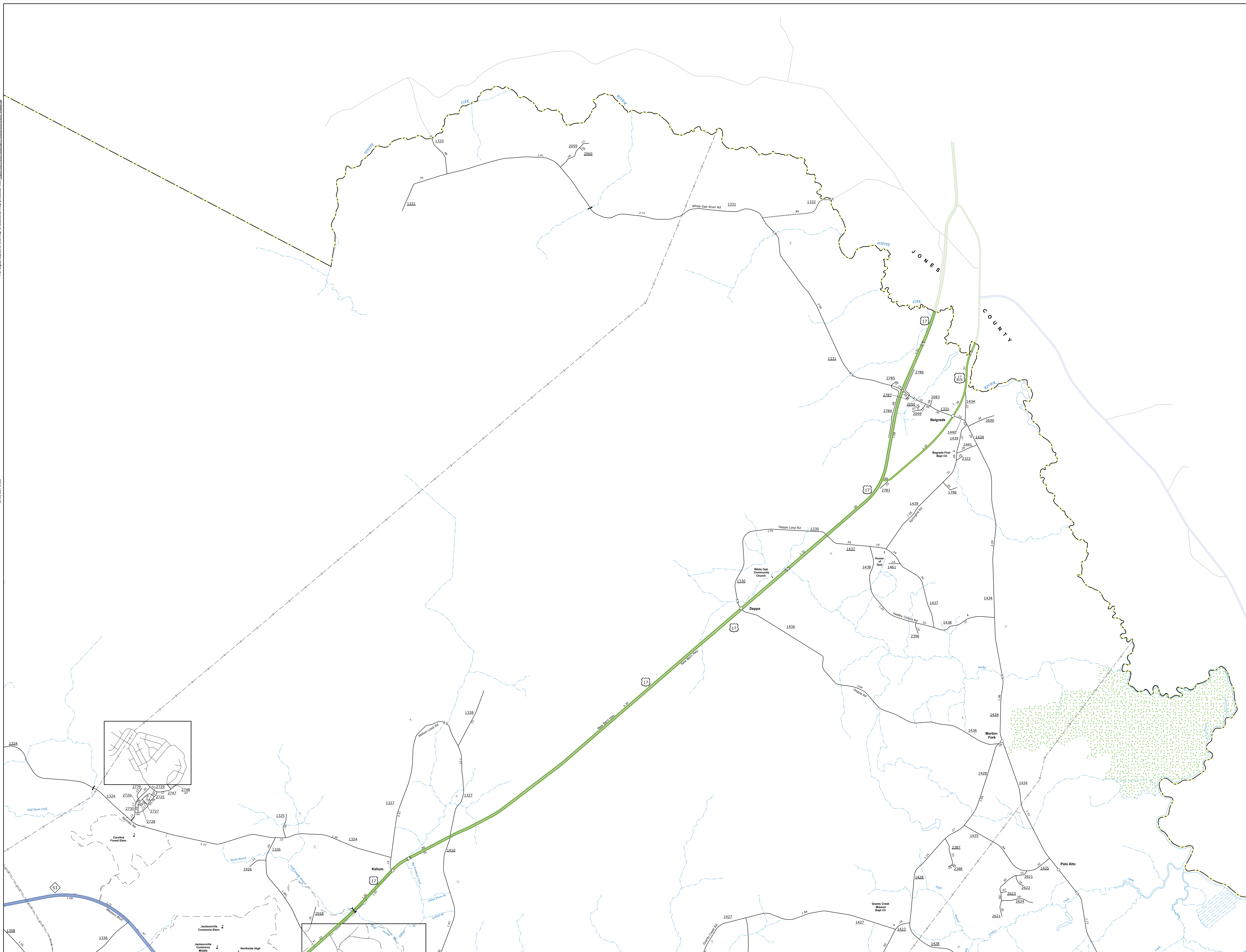

**ON SLOW COUNTY
NORTH CAROLINA**

PREPARED BY THE
NORTH CAROLINA DEPARTMENT OF TRANSPORTATION
OPERATIONS PROGRAM MANAGEMENT UNIT - MAPPING SECTION
IN COOPERATION WITH THE
U.S. DEPARTMENT OF TRANSPORTATION
FEDERAL HIGHWAY ADMINISTRATION

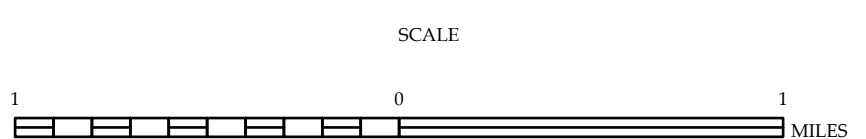

NORTH CAROLINA PLANE COORDINATE SYSTEM
LAMBERT CONFORMAL CONIC PROJECTION