

- LEGEND**
- INTERSTATE US NC (with symbols for Interstate, US, and NC)
  - Divided Hwy
  - Unimproved Road
  - Blue Ridge Parkway
  - UNIMPROVED GRADUATED ROAD
  - RAILROAD TRACK ROAD
  - NO-SYSTEM ROAD
  - PROPOSED (DASHED LINE)
  - PROTECTIVE ROAD
  - STANDARD ROAD BRIDGE
  - RAILROAD BRIDGE
  - IRON SPAN BRIDGE
  - PIEDMONT BRIDGE
  - PIEDMONT UNDERPASS
  - VERMILION UNDERPASS
  - TUNNEL
  - CULVERT
  - PO
  - INTERSTATE HIGHWAY (with shield symbol)
  - U.S. NUMBERED HIGHWAY (with shield symbol)
  - N.C. NUMBERED HIGHWAY (with shield symbol)
  - U.S. NUMBERED BI-CYCLE ROUTE
  - N.C. NUMBERED BI-CYCLE ROUTE
  - INTERSTATE INTERCHANGE NUMBER
  - SECURITY ROAD NUMBER
  - UTILITY LINES (with symbols for Gas, Electric, Water, Sewer)
  - RAILROAD LINE
  - RAILROAD STATION
  - INSULT AREA
  - STATE LINE
  - CITY LIMITS
  - SANITARIAN BOUNDARIES
  - CITY LIMITS
  - FERROUS PIPE AND ROAD
  - NARROW CREEK OR STREAM
  - WIDE RIVER OR CREEK
  - BEACHWALK, POND OR LAKE W/ ISLAND
  - DAM OR DAM WITH LOCK
  - WATERFALL
  - SWAMP
  - COMMUNITY
  - COUNTY SEAL
  - SCHOOL
  - CITY OF UNIVERSITY
  - HOSPITAL
  - CONFERENCE CENTER
  - CHURCH
  - CHURCH WITH CEMETERY
  - CEMETERY
  - POWER STATION
  - CORRECT INSTITUTIONS
  - QUARRY
  - MINE OR PIT
  - HIGHWAY GARAGE OR MAINT. YARD
  - HIGHWAY STOP OR REST OFFICE
  - MILITARY POST
  - WEIGH STATION
  - FARMHOUSE
  - HISTORICAL SITE
  - POST OFFICE
  - POST OFFICE
  - STATE FOREST
  - LIGHTHOUSE
  - MOUNTAIN SHALERT
  - MOUNTAIN GAP
  - OVERLOOK
  - REST AREA
  - VISITOR CENTER AREA
  - WELCOME CENTER AREA
  - AIRPORT
  - MILITARY AIRPORT
  - NATIONAL STATE FOREST BOUNDARY
  - WILDLIFE REFUGE
  - NATIONAL STATE PARK BOUNDARY
  - NATIONAL SEASIDE RECREATION AREA
  - GAME LANDS BOUNDARY
  - MILITARY RECREATION BOUNDARY
  - INDIAN RECREATION BOUNDARY

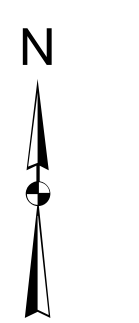

**UNION COUNTY**  
**NORTH CAROLINA**

PREPARED BY THE  
NORTH CAROLINA DEPARTMENT OF TRANSPORTATION  
OPERATIONS PROGRAM MANAGEMENT UNIT - MAPPING SECTION  
IN COOPERATION WITH THE  
U.S. DEPARTMENT OF TRANSPORTATION  
FEDERAL HIGHWAY ADMINISTRATION

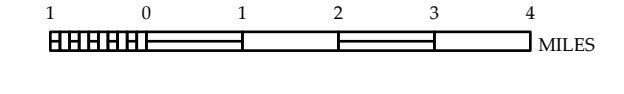

NORTH CAROLINA PLANE COORDINATE SYSTEM  
LAMBERT CONFORMAL CONIC PROJECTION

COPIES OF THIS MAP ARE AVAILABLE  
TO THE PUBLIC AT NOMINAL COST.  
mappingsupport@ncdot.gov  
https://connect.ncdot.gov/resources/  
State-Mapping/Pages/Ordering-Maps.aspx  
(919) 834-6480

The Mapping Section's goal is to provide the most accurate and current information possible. Map data is compiled from numerous sources with varying dates of publication and map accuracy standards. As a result, the accuracy, currency and completeness of the data provided will vary. This map includes state-maintained roads and important non-system roads.  
The information shown on this map was last updated in April 2024. For additional information, visit <http://www.ncdot.gov/stt/mapping.aspx> and click on Data Providers or contact us by phone at (919) 835-6480.

TERMS OF USE: The Mapping Section's goal is to provide the most accurate and current information possible. Map data is compiled from the data provided by the North Carolina Department of Transportation and other sources. The user assumes all liability for any errors in the map data. This product is for informational purposes only. For additional map products, visit [www.ncdot.com](http://www.ncdot.com).

COPYIES OF THIS MAP ARE AVAILABLE TO THE PUBLIC. CONTACT US TO OBTAIN INFORMATION ON HOW TO ORDER.

Sheet Key

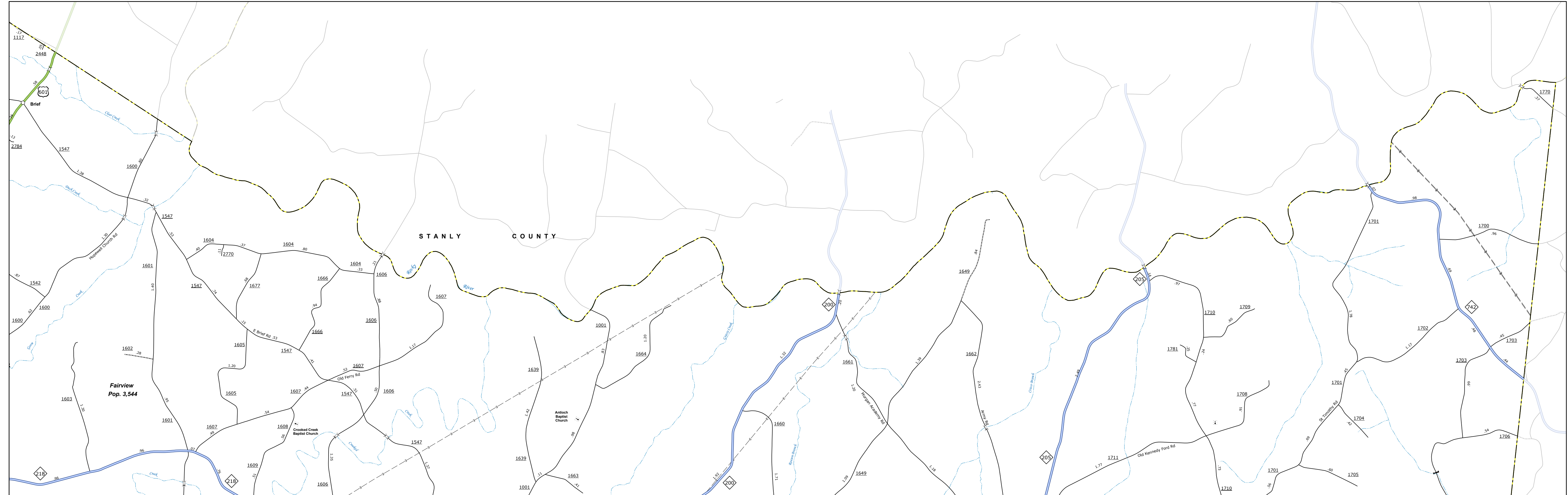
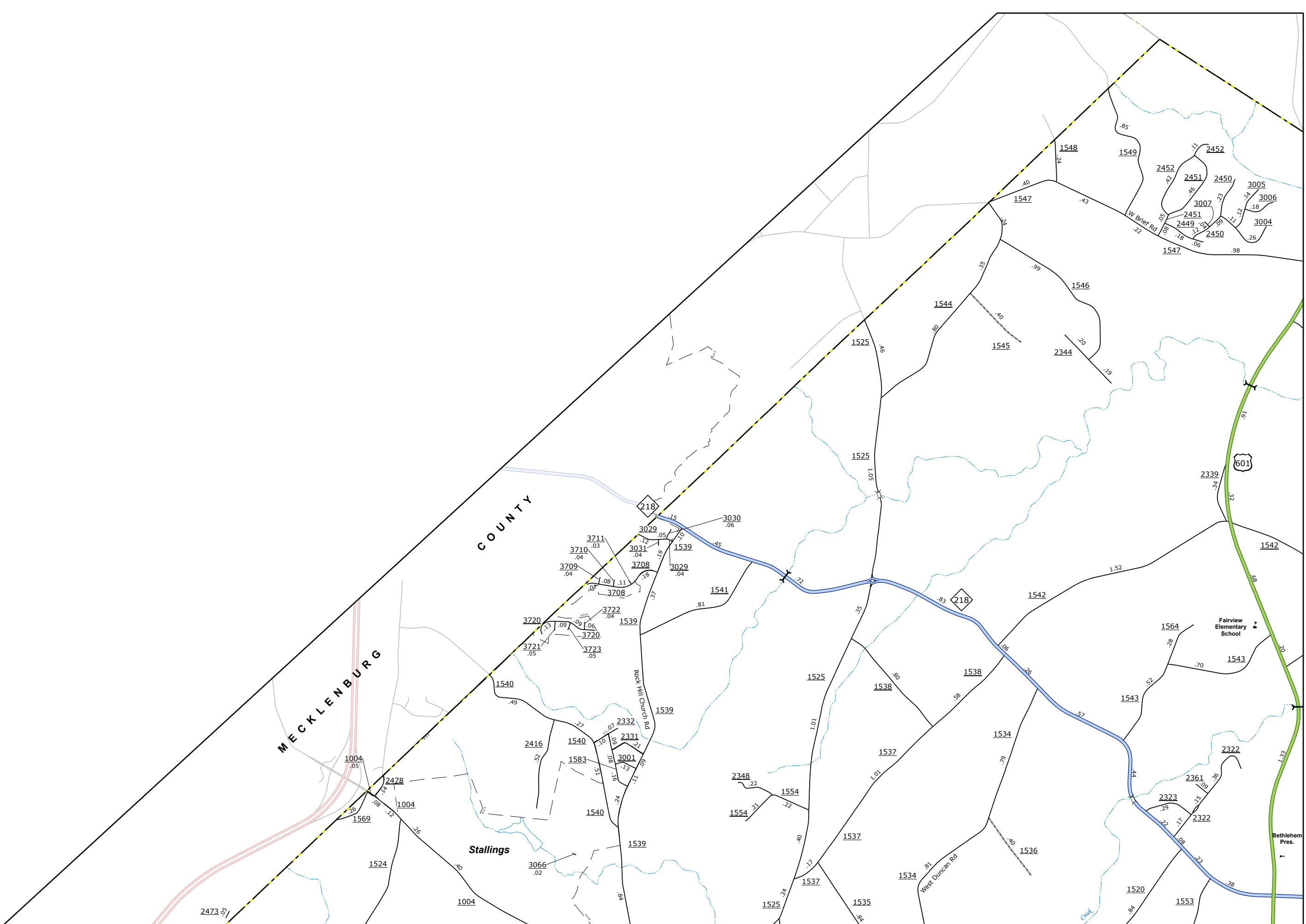
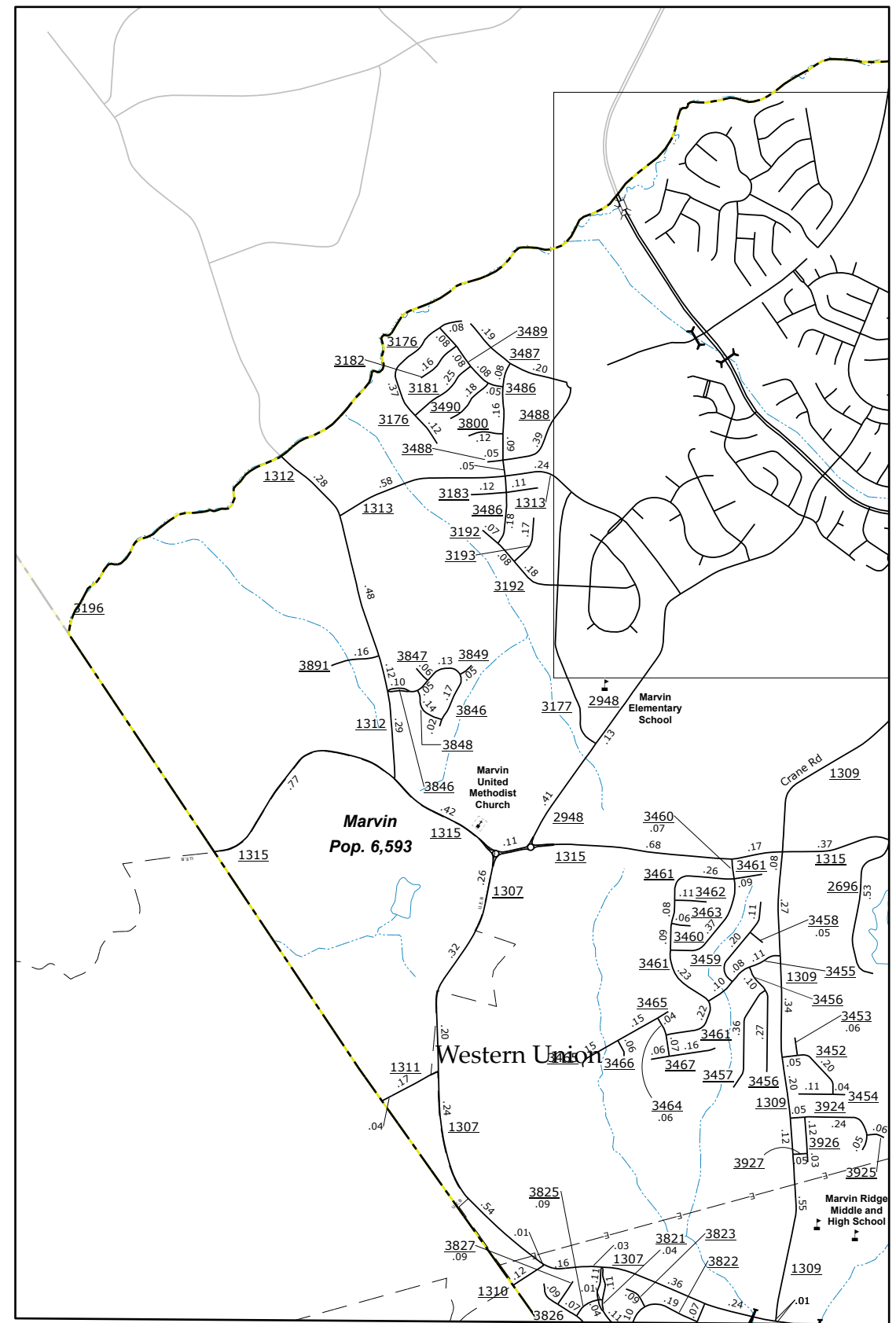
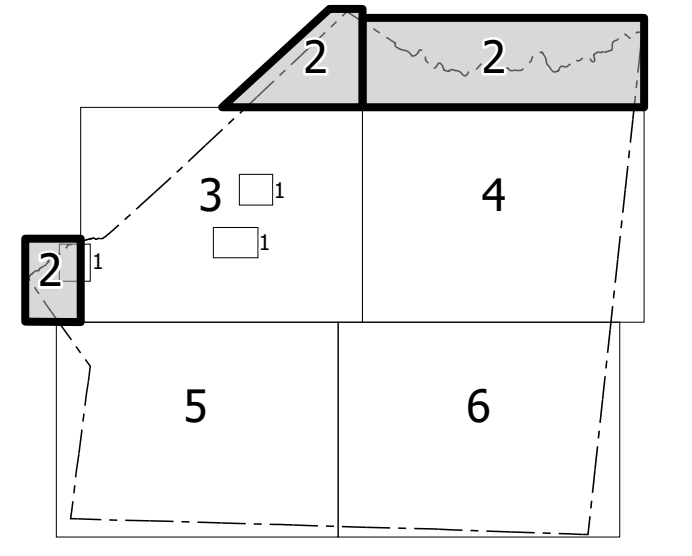

- LEGEND
INTERSTATE US NC
Dotted line
Unilateral Hwy
Unilateral Hwy
HEAVY RAMP PARKWAY
CROSS STREET TO ROAD
ROAD TO ROAD
PROPOSED/ADJACENT ROAD
PROPOSED/ADJACENT ROAD
INTERESTED PROPERTY
STANDARD ROAD BRIDGE
ROADWAY BRIDGE
DRAWN SPAN ON BRIDGE
PEDIESTRIAN BRIDGE
PEDIESTRIAN WALKWAY
PEDIESTRIAN UNDERPASS
VEHICLE LANE UNDERPASS
TUNNEL
CULVERT
PIV
INTERSTATE HIGHWAY
US NUMBERED HIGHWAY
US NUMBERED HIGHWAY
US NUMBERED BIKEWAY ROUTE
US NUMBERED BIKEWAY ROUTE
INTERSTATE INTERCHANGE NUMBER
SECONDARY ROAD NUMBER
RAILROAD CROSSING
RAILROAD LINE
RAILROAD STATION
POST OFFICE
STATE LINE
COUNTY LINE
SMOOTHED URBAN BOUNDARIES
CITY LIMITS
FERRY ROUTE AND RAMP
SHARON CREEK OR STREAM
WIDE RIVER OR LAKE
RESERVATION, POUD OR LAKE W/ ISLAND
DAM OR DAM WITH LOCK
WATERFALL
SWAMP
COMMUNITY
COUNTY SEAT
SCHOOL
COLLEGE OR UNIVERSITY
HOSPITAL
COAST GUARD STATION
CHURCH
CHURCH WITH CHURCHERY
PARK STATION
CORRECTION OR PENAL INSTITUTION
QUARRY
SHELTER OR PIT
INDUSTRIAL GARAGE OR SALES YARD
HIGHWAY DEPT. OR DIST. OFFICE
MILITARY POST
WRECK STATION
FARROWING
HISTORICAL SITE
POINTS OF INTEREST
POST OFFICE
STATE FOREST
LIGHTHOUSE
MOUNTAIN SUMMIT
MOUNTAIN GAP
OVERLOOK
REST AREA
VISITOR CENTER AREA
WILCOGE CENTER AREA
AIRPORT
MILITARY AIRPORT
NATIONAL STATE FOREST BOUNDARY
WILDLIFE REFUGE
NATIONAL STATE PARK BOUNDARY
GAME LANDS BOUNDARY
MILITARY RESERVATION BOUNDARY
INDIAN RESERVATION BOUNDARY

NORTH CAROLINA DEPARTMENT OF TRANSPORTATION OPERATIONS PROGRAM MANAGEMENT UNIT - MAPPING SECTION IN COOPERATION WITH THE U.S. DEPARTMENT OF TRANSPORTATION FEDERAL HIGHWAY ADMINISTRATION
SCALE 1 0 1 MILES
UNION COUNTY NORTH CAROLINA
NORTH CAROLINA PLANE COORDINATE SYSTEM LAMBERT CONFORMAL CONIC PROJECTION







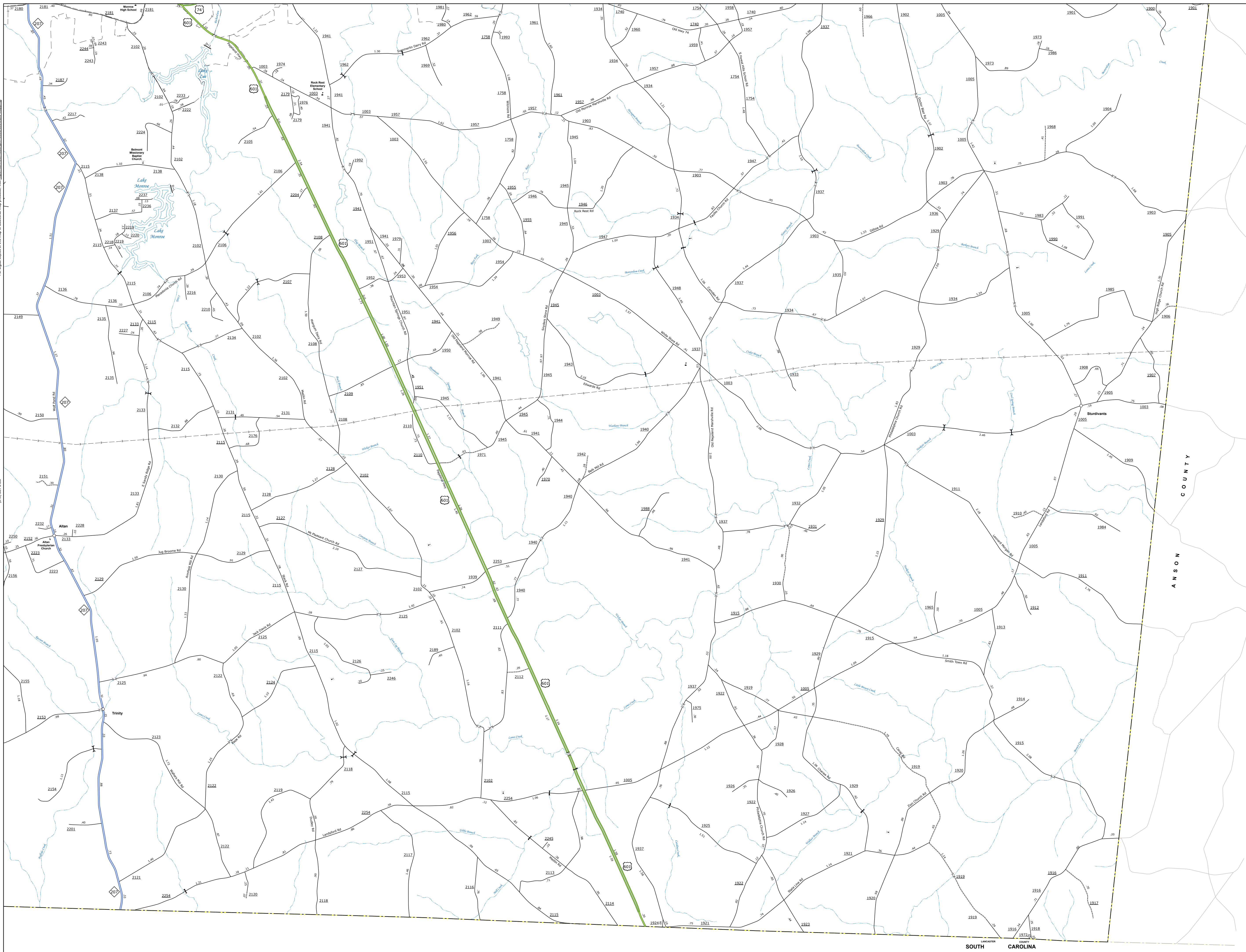

TERMS OF USE: The Mapping Section's goal is to provide the most accurate and current information possible. Map data is compiled from the data provided by the North Carolina Department of Transportation and the National Center for Geographic Information Science. The data is provided as is. The North Carolina Department of Transportation and the National Center for Geographic Information Science are not responsible for any errors in the map data. This map is for informational purposes only. For additional map products, visit [www.ncdot.gov](http://www.ncdot.gov) or call 1-800-368-6868.

COPYIES OF THIS MAP ARE AVAILABLE TO THE PUBLIC AT THE OFFICE OF THE STATE ARCHIVIST, 100 SOUTH COLLETT STREET, RALEIGH, NC 27603. (919) 733-7100

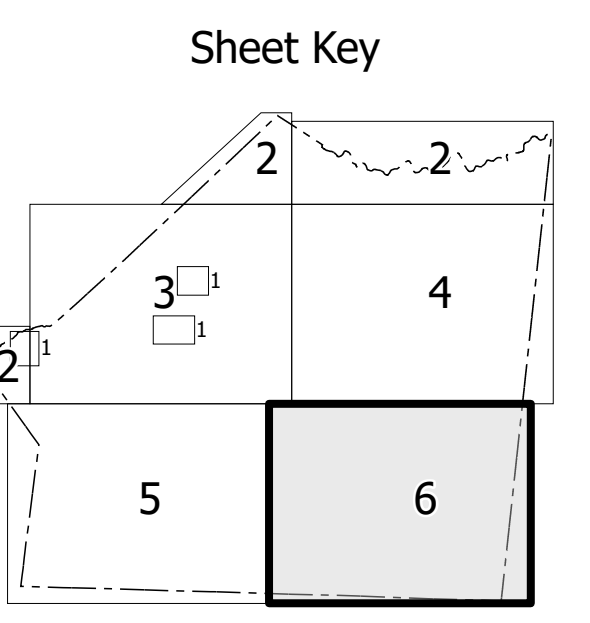

- LEGEND**
- INTERSTATE US NC
  - US 101
  - US 74
  - US 67
  - US 42
  - US 21
  - US 15
  - US 10
  - US 5
  - US 1
  - US 0
  - US -1
  - US -2
  - US -3
  - US -4
  - US -5
  - US -6
  - US -7
  - US -8
  - US -9
  - US -10
  - US -11
  - US -12
  - US -13
  - US -14
  - US -15
  - US -16
  - US -17
  - US -18
  - US -19
  - US -20
  - US -21
  - US -22
  - US -23
  - US -24
  - US -25
  - US -26
  - US -27
  - US -28
  - US -29
  - US -30
  - US -31
  - US -32
  - US -33
  - US -34
  - US -35
  - US -36
  - US -37
  - US -38
  - US -39
  - US -40
  - US -41
  - US -42
  - US -43
  - US -44
  - US -45
  - US -46
  - US -47
  - US -48
  - US -49
  - US -50
  - US -51
  - US -52
  - US -53
  - US -54
  - US -55
  - US -56
  - US -57
  - US -58
  - US -59
  - US -60
  - US -61
  - US -62
  - US -63
  - US -64
  - US -65
  - US -66
  - US -67
  - US -68
  - US -69
  - US -70
  - US -71
  - US -72
  - US -73
  - US -74
  - US -75
  - US -76
  - US -77
  - US -78
  - US -79
  - US -80
  - US -81
  - US -82
  - US -83
  - US -84
  - US -85
  - US -86
  - US -87
  - US -88
  - US -89
  - US -90
  - US -91
  - US -92
  - US -93
  - US -94
  - US -95
  - US -96
  - US -97
  - US -98
  - US -99
  - US -100

N

**UNION COUNTY  
NORTH CAROLINA**

PREPARED BY THE  
NORTH CAROLINA DEPARTMENT OF TRANSPORTATION  
OPERATIONS PROGRAM MANAGEMENT UNIT - MAPPING SECTION  
IN COOPERATION WITH THE  
U.S. DEPARTMENT OF TRANSPORTATION  
FEDERAL HIGHWAY ADMINISTRATION

SCALE

NORTH CAROLINA PLANE COORDINATE SYSTEM  
LAMBERT CONFORMAL CONIC PROJECTION