

Sheet Key

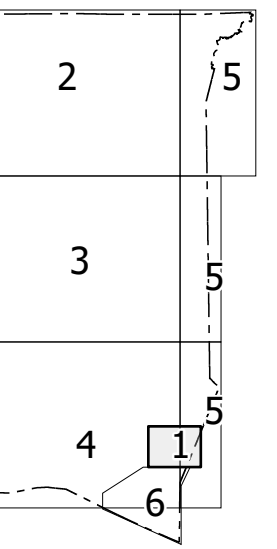

LEGEND

- INTERSTATE US NC
- Divided Hwy
- Undivided Hwy
- BLUE RIDGE PARKWAY
- UNPAVED UNCLASSIFIED ROAD
- HIGHWAY RIGHT-OF-WAY
- NO-SYSTEM ROAD
- PROPOSED/PLANNED ROAD
- PROTECTED/LOCK-UP ROAD
- INTERESTED/CONTRACT
- STANDARD ROAD BRIDGE
- RAILROAD BRIDGE
- IRON-SPAN OVERBRIDGE
- PEDESTRIAN BRIDGE
- PEDESTRIAN UNDERPASS
- VEHICULAR UNDERPASS
- TUNNEL
- CULVERT
- PYI
- INTERSTATE HIGHWAY
- U.S. NUMBERED HIGHWAY
- N.C. NUMBERED HIGHWAY
- U.S. NUMBERED BI-CYCLE ROUTE
- N.C. NUMBERED BI-CYCLE ROUTE
- INTERSTATE INTERCHANGE NUMBER
- SECONDARY ROAD NUMBER
- W.A.D. (WATERWAY) DRAINAGE
- UTILITY LINES
- RAILROAD LINE
- RAILROAD STATION
- INLET AREA
- STATE LINE
- COUNTY LINE
- CITY LIMITS
- WATERWAY
- FERRY ROUTE
- NARROW RIVER OR STREAM
- WIDE RIVER OR CREEK
- BEACH, POINT OR LAKE W/ ISLAND
- DAM OR DAM WITH LOCK
- WATERFALL
- SWAMP
- COMMUNITY, TOWN OR CITY CENTER
- COUNTY SEAT
- SCHOOL
- COLLEGE OR UNIVERSITY
- HOSPITAL
- COAST GUARD STATION
- CHURCH
- CHURCH WITH CEMETERY
- CEMETERY
- PAPER STATION
- CORRECTION OR PENAL INSTITUTION
- QUARRY
- MINE OR PIT
- HIGHWAY GARAGE OR MAINT. YARD
- HIGHWAY ID. OR DIST. OFFICE
- MILL OR FERRY
- WEIGH STATION
- FABRICATIONS
- HISTORICAL SITE
- POINTS OF INTEREST
- STATE FOREST
- LIGHTHOUSE
- MONUMENT/SHRINE
- OVERLOOK
- REST AREA
- VISITOR CENTER AREA
- WELCOMING CENTER AREA
- AIRPORT
- MILITARY AIRPORT
- HELIPAD
- NATIONAL STATE FOREST BOUNDARY
- WILDLIFE REFUGE
- NATIONAL STATE PARK BOUNDARY
- GAME LANDS BOUNDARY
- MILITARY RESERVATION BOUNDARY
- INDIAN RESERVATION BOUNDARY

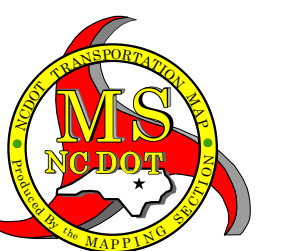

**GRANVILLE COUNTY
NORTH CAROLINA**

PREPARED BY THE
NORTH CAROLINA DEPARTMENT OF TRANSPORTATION
OPERATIONS PROGRAM MANAGEMENT UNIT - MAPPING SECTION
IN COOPERATION WITH THE
U.S. DEPARTMENT OF TRANSPORTATION
FEDERAL HIGHWAY ADMINISTRATION

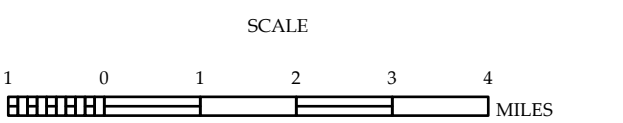

NORTH CAROLINA PLANE COORDINATE SYSTEM
LAMBERT CONFORMAL CONIC PROJECTION

COPIES OF THIS MAP ARE AVAILABLE TO THE PUBLIC AT NOMINAL COST. CONTACT US TO ORDER: maps@ncdot.gov or <https://connect.ncdot.gov/resources/State-Mapping/Pages/Ordering-Maps.aspx> (919) 854-9490

TERMS OF USE: The Mapping Section's goal is to provide the most accurate and current information possible. Map data is compiled from numerous sources with varying dates of publication and map accuracy standards. As a result, the accuracy, currency, and completeness of the data provided will vary. The North Carolina Department of Transportation shall not be held liable for any errors in the map data. The map cannot be construed to be a legal document. The information shown on this map was last updated in April 2024. For digital copies of this map or additional map products, visit <https://connect.ncdot.gov/resources/State-Mapping>

TERMS OF USE: The Mapping Section's goal is to provide the most accurate and current information possible. Map data is compiled from various sources with varying degrees of accuracy and is subject to change. Users are advised to verify critical information and to use the map as a reference only. The information shown on this map was last updated on April 2024.

COPIES OF THIS MAP ARE AVAILABLE TO THE PUBLIC AT NO CHARGE. CONTACT US TO ORDER: 919.733.4545 OR VISIT OUR WEBSITE: www.ncdot.gov

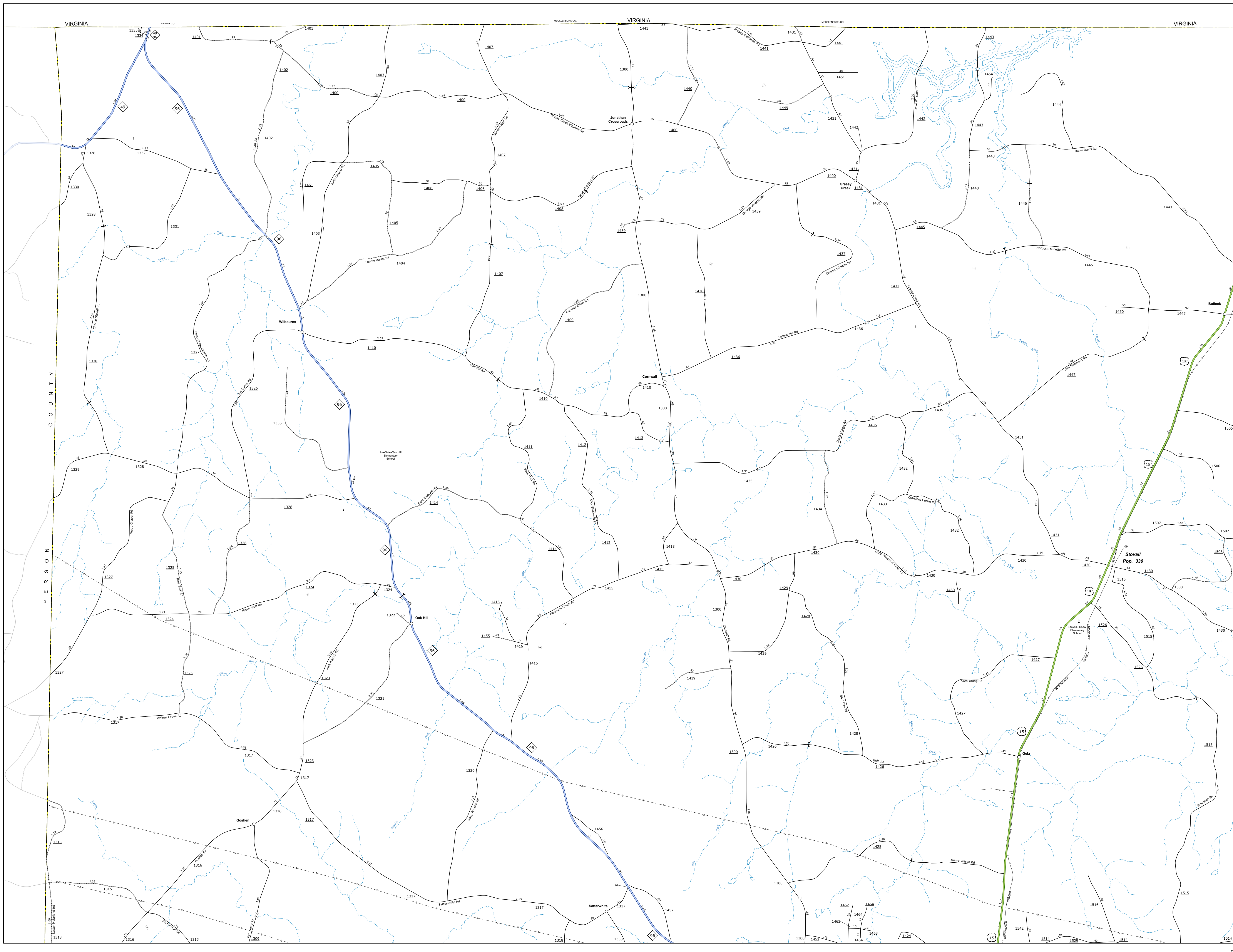

Sheet Key

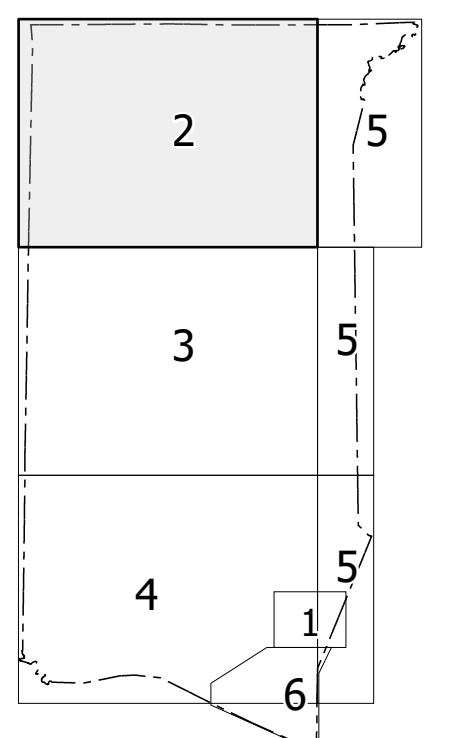

- LEGEND**
- INTERSTATE US NC
 - US 15
 - US 96
 - US 151
 - US 152
 - US 153
 - US 154
 - US 155
 - US 156
 - US 157
 - US 158
 - US 159
 - US 160
 - US 161
 - US 162
 - US 163
 - US 164
 - US 165
 - US 166
 - US 167
 - US 168
 - US 169
 - US 170
 - US 171
 - US 172
 - US 173
 - US 174
 - US 175
 - US 176
 - US 177
 - US 178
 - US 179
 - US 180
 - US 181
 - US 182
 - US 183
 - US 184
 - US 185
 - US 186
 - US 187
 - US 188
 - US 189
 - US 190
 - US 191
 - US 192
 - US 193
 - US 194
 - US 195
 - US 196
 - US 197
 - US 198
 - US 199
 - US 200
 - US 201
 - US 202
 - US 203
 - US 204
 - US 205
 - US 206
 - US 207
 - US 208
 - US 209
 - US 210
 - US 211
 - US 212
 - US 213
 - US 214
 - US 215
 - US 216
 - US 217
 - US 218
 - US 219
 - US 220
 - US 221
 - US 222
 - US 223
 - US 224
 - US 225
 - US 226
 - US 227
 - US 228
 - US 229
 - US 230
 - US 231
 - US 232
 - US 233
 - US 234
 - US 235
 - US 236
 - US 237
 - US 238
 - US 239
 - US 240
 - US 241
 - US 242
 - US 243
 - US 244
 - US 245
 - US 246
 - US 247
 - US 248
 - US 249
 - US 250
 - US 251
 - US 252
 - US 253
 - US 254
 - US 255
 - US 256
 - US 257
 - US 258
 - US 259
 - US 260
 - US 261
 - US 262
 - US 263
 - US 264
 - US 265
 - US 266
 - US 267
 - US 268
 - US 269
 - US 270
 - US 271
 - US 272
 - US 273
 - US 274
 - US 275
 - US 276
 - US 277
 - US 278
 - US 279
 - US 280
 - US 281
 - US 282
 - US 283
 - US 284
 - US 285
 - US 286
 - US 287
 - US 288
 - US 289
 - US 290
 - US 291
 - US 292
 - US 293
 - US 294
 - US 295
 - US 296
 - US 297
 - US 298
 - US 299
 - US 300
 - US 301
 - US 302
 - US 303
 - US 304
 - US 305
 - US 306
 - US 307
 - US 308
 - US 309
 - US 310
 - US 311
 - US 312
 - US 313
 - US 314
 - US 315
 - US 316
 - US 317
 - US 318
 - US 319
 - US 320
 - US 321
 - US 322
 - US 323
 - US 324
 - US 325
 - US 326
 - US 327
 - US 328
 - US 329
 - US 330
 - US 331
 - US 332
 - US 333
 - US 334
 - US 335
 - US 336
 - US 337
 - US 338
 - US 339
 - US 340
 - US 341
 - US 342
 - US 343
 - US 344
 - US 345
 - US 346
 - US 347
 - US 348
 - US 349
 - US 350
 - US 351
 - US 352
 - US 353
 - US 354
 - US 355
 - US 356
 - US 357
 - US 358
 - US 359
 - US 360
 - US 361
 - US 362
 - US 363
 - US 364
 - US 365
 - US 366
 - US 367
 - US 368
 - US 369
 - US 370
 - US 371
 - US 372
 - US 373
 - US 374
 - US 375
 - US 376
 - US 377
 - US 378
 - US 379
 - US 380
 - US 381
 - US 382
 - US 383
 - US 384
 - US 385
 - US 386
 - US 387
 - US 388
 - US 389
 - US 390
 - US 391
 - US 392
 - US 393
 - US 394
 - US 395
 - US 396
 - US 397
 - US 398
 - US 399
 - US 400
 - US 401
 - US 402
 - US 403
 - US 404
 - US 405
 - US 406
 - US 407
 - US 408
 - US 409
 - US 410
 - US 411
 - US 412
 - US 413
 - US 414
 - US 415
 - US 416
 - US 417
 - US 418
 - US 419
 - US 420
 - US 421
 - US 422
 - US 423
 - US 424
 - US 425
 - US 426
 - US 427
 - US 428
 - US 429
 - US 430
 - US 431
 - US 432
 - US 433
 - US 434
 - US 435
 - US 436
 - US 437
 - US 438
 - US 439
 - US 440
 - US 441
 - US 442
 - US 443
 - US 444
 - US 445
 - US 446
 - US 447
 - US 448
 - US 449
 - US 450
 - US 451
 - US 452
 - US 453
 - US 454
 - US 455
 - US 456
 - US 457
 - US 458
 - US 459
 - US 460
 - US 461
 - US 462
 - US 463
 - US 464
 - US 465
 - US 466
 - US 467
 - US 468
 - US 469
 - US 470
 - US 471
 - US 472
 - US 473
 - US 474
 - US 475
 - US 476
 - US 477
 - US 478
 - US 479
 - US 480
 - US 481
 - US 482
 - US 483
 - US 484
 - US 485
 - US 486
 - US 487
 - US 488
 - US 489
 - US 490
 - US 491
 - US 492
 - US 493
 - US 494
 - US 495
 - US 496
 - US 497
 - US 498
 - US 499
 - US 500
 - US 501
 - US 502
 - US 503
 - US 504
 - US 505
 - US 506
 - US 507
 - US 508
 - US 509
 - US 510
 - US 511
 - US 512
 - US 513
 - US 514
 - US 515
 - US 516
 - US 517
 - US 518
 - US 519
 - US 520
 - US 521
 - US 522
 - US 523
 - US 524
 - US 525
 - US 526
 - US 527
 - US 528
 - US 529
 - US 530
 - US 531
 - US 532
 - US 533
 - US 534
 - US 535
 - US 536
 - US 537
 - US 538
 - US 539
 - US 540
 - US 541
 - US 542
 - US 543
 - US 544
 - US 545
 - US 546
 - US 547
 - US 548
 - US 549
 - US 550
 - US 551
 - US 552
 - US 553
 - US 554
 - US 555
 - US 556
 - US 557
 - US 558
 - US 559
 - US 560
 - US 561
 - US 562
 - US 563
 - US 564
 - US 565
 - US 566
 - US 567
 - US 568
 - US 569
 - US 570
 - US 571
 - US 572
 - US 573
 - US 574
 - US 575
 - US 576
 - US 577
 - US 578
 - US 579
 - US 580
 - US 581
 - US 582
 - US 583
 - US 584
 - US 585
 - US 586
 - US 587
 - US 588
 - US 589
 - US 590
 - US 591
 - US 592
 - US 593
 - US 594
 - US 595
 - US 596
 - US 597
 - US 598
 - US 599
 - US 600
 - US 601
 - US 602
 - US 603
 - US 604
 - US 605
 - US 606
 - US 607
 - US 608
 - US 609
 - US 610
 - US 611
 - US 612
 - US 613
 - US 614
 - US 615
 - US 616
 - US 617
 - US 618
 - US 619
 - US 620
 - US 621
 - US 622
 - US 623
 - US 624
 - US 625
 - US 626
 - US 627
 - US 628
 - US 629
 - US 630
 - US 631
 - US 632
 - US 633
 - US 634
 - US 635
 - US 636
 - US 637
 - US 638
 - US 639
 - US 640
 - US 641
 - US 642
 - US 643
 - US 644
 - US 645
 - US 646
 - US 647
 - US 648
 - US 649
 - US 650
 - US 651
 - US 652
 - US 653
 - US 654
 - US 655
 - US 656
 - US 657
 - US 658
 - US 659
 - US 660
 - US 661
 - US 662
 - US 663
 - US 664
 - US 665
 - US 666
 - US 667
 - US 668
 - US 669
 - US 670
 - US 671
 - US 672
 - US 673
 - US 674
 - US 675
 - US 676
 - US 677
 - US 678
 - US 679
 - US 680
 - US 681
 - US 682
 - US 683
 - US 684
 - US 685
 - US 686
 - US 687
 - US 688
 - US 689
 - US 690
 - US 691
 - US 692
 - US 693
 - US 694
 - US 695
 - US 696
 - US 697
 - US 698
 - US 699
 - US 700
 - US 701
 - US 702
 - US 703
 - US 704
 - US 705
 - US 706
 - US 707
 - US 708
 - US 709
 - US 710
 - US 711
 - US 712
 - US 713
 - US 714
 - US 715
 - US 716
 - US 717
 - US 718
 - US 719
 - US 720
 - US 721
 - US 722
 - US 723
 - US 724
 - US 725
 - US 726
 - US 727
 - US 728
 - US 729
 - US 730
 - US 731
 - US 732
 - US 733
 - US 734
 - US 735
 - US 736
 - US 737
 - US 738
 - US 739
 - US 740
 - US 741
 - US 742
 - US 743
 - US 744
 - US 745
 - US 746
 - US 747
 - US 748
 - US 749
 - US 750
 - US 751
 - US 752
 - US 753
 - US 754
 - US 755
 - US 756
 - US 757
 - US 758
 - US 759
 - US 760
 - US 761
 - US 762
 - US 763
 - US 764
 - US 765
 - US 766
 - US 767
 - US 768
 - US 769
 - US 770
 - US 771
 - US 772
 - US 773
 - US 774
 - US 775
 - US 776
 - US 777
 - US 778
 - US 779
 - US 780
 - US 781
 - US 782
 - US 783
 - US 784
 - US 785
 - US 786
 - US 787
 - US 788
 - US 789
 - US 790
 - US 791
 - US 792
 - US 793
 - US 794
 - US 795
 - US 796
 - US 797
 - US 798
 - US 799
 - US 800
 - US 801
 - US 802
 - US 803
 - US 804
 - US 805
 - US 806
 - US 807
 - US 808
 - US 809
 - US 810
 - US 811
 - US 812
 - US 813
 - US 814
 - US 815
 - US 816
 - US 817
 - US 818
 - US 819
 - US 820
 - US 821
 - US 822
 - US 823
 - US 824
 - US 825
 - US 826
 - US 827
 - US 828
 - US 829
 - US 830
 - US 831
 - US 832
 - US 833
 - US 834
 - US 835
 - US 836
 - US 837
 - US 838
 - US 839
 - US 840
 - US 841
 - US 842
 - US 843
 - US 844
 - US 845
 - US 846
 - US 847
 - US 848
 - US 849
 - US 850
 - US 851
 - US 852
 - US 853
 - US 854
 - US 855
 - US 856
 - US 857
 - US 858
 - US 859
 - US 860
 - US 861
 - US 862
 - US 863
 - US 864
 - US 865
 - US 866
 - US 867
 - US 868
 - US 869
 - US 870
 - US 871
 - US 872
 - US 873
 - US 874
 - US 875
 - US 876
 - US 877
 - US 878
 - US 879
 - US 880
 - US 881
 - US 882
 - US 883
 - US 884
 - US 885
 - US 886
 - US 887
 - US 888
 - US 889
 - US 890
 - US 891
 - US 892
 - US 893
 - US 894
 - US 895
 - US 896
 - US 897
 - US 898
 - US 899
 - US 900
 - US 901
 - US 902
 - US 903
 - US 904
 - US 905
 - US 906
 - US 907
 - US 908
 - US 909
 - US 910
 - US 911
 - US 912
 - US 913
 - US 914
 - US 915
 - US 916
 - US 917
 - US 918
 - US 919
 - US 920
 - US 921
 - US 922
 - US 923
 - US 924
 - US 925
 - US 926
 - US 927
 - US 928
 - US 929
 - US 930
 - US 931
 - US 932
 - US 933
 - US 934
 - US 935
 - US 936
 - US 937
 - US 938
 - US 939
 - US 940
 - US 941
 - US 942
 - US 943
 - US 944
 - US 945
 - US 946
 - US 947
 - US 948
 - US 949
 - US 950
 - US 951
 - US 952
 - US 953
 - US 954
 - US 955
 - US 956
 - US 957
 - US 958
 - US 959
 - US 960
 - US 961
 - US 962
 - US 963
 - US 964
 - US 965
 - US 966
 - US 967
 - US 968
 - US 969
 - US 970
 - US 971
 - US 972
 - US 973
 - US 974
 - US 975
 - US 976
 - US 977
 - US 978
 - US 979
 - US 980
 - US 981
 - US 982
 - US 983
 - US 984
 - US 985
 - US 986
 - US 987
 - US 988
 - US 989
 - US 990
 - US 991
 - US 992
 - US 993
 - US 994
 - US 995
 - US 996
 - US 997
 - US 998
 - US 999
 - US 1000

N

GRANVILLE COUNTY
NORTH CAROLINA

PREPARED BY THE
NORTH CAROLINA DEPARTMENT OF TRANSPORTATION
OPERATIONS PROGRAM MANAGEMENT UNIT - MAPPING SECTION
IN COOPERATION WITH THE
U.S. DEPARTMENT OF TRANSPORTATION
FEDERAL HIGHWAY ADMINISTRATION

SCALE

1
0
1
MILES

NORTH CAROLINA PLANE COORDINATE SYSTEM
LAMBERT CONFORMAL CONIC PROJECTION

TERMS OF USE: The Mapping Section's goal is to provide the most accurate and current information possible. Map data is compiled from numerous sources with varying degrees of accuracy and may contain errors. The information shown on this map was last updated in April 2024. The user assumes all responsibility for any errors or omissions. The information shown on this map was last updated in April 2024.

COPIES OF THIS MAP ARE AVAILABLE TO THE PUBLIC AT NO CHARGE. CONTACT US TO ORDER: 919.733.4444 OR WWW.NCDEPARTMENTOFTRANSPORTATION.COM

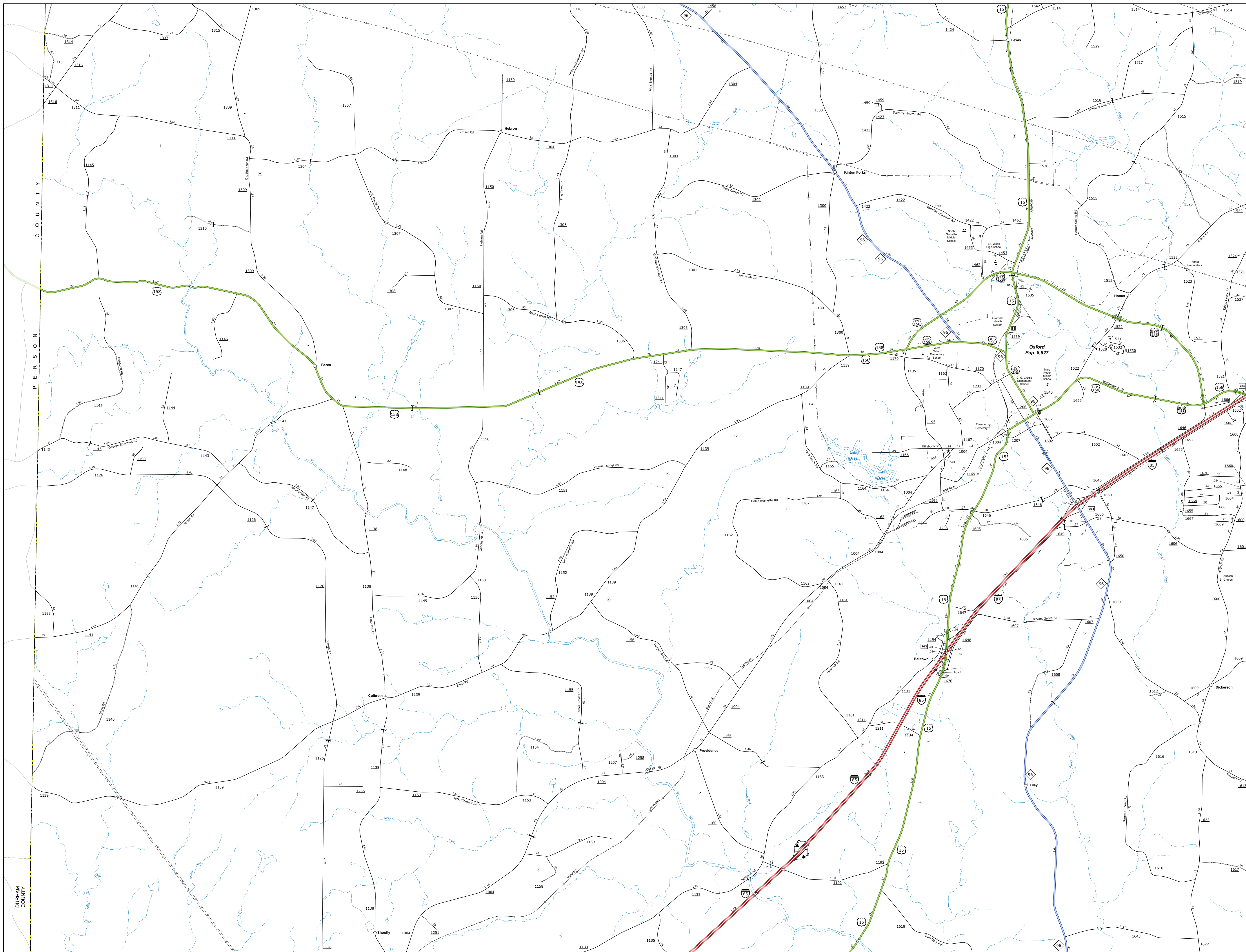

Sheet Key

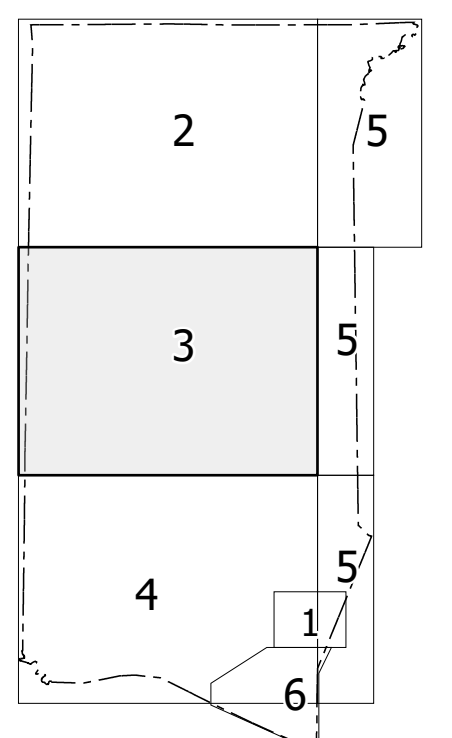

- LEGEND**
- INTERSTATE US NC
 - US 15
 - US 96
 - US 101
 - US 102
 - US 103
 - US 104
 - US 105
 - US 106
 - US 107
 - US 108
 - US 109
 - US 110
 - US 111
 - US 112
 - US 113
 - US 114
 - US 115
 - US 116
 - US 117
 - US 118
 - US 119
 - US 120
 - US 121
 - US 122
 - US 123
 - US 124
 - US 125
 - US 126
 - US 127
 - US 128
 - US 129
 - US 130
 - US 131
 - US 132
 - US 133
 - US 134
 - US 135
 - US 136
 - US 137
 - US 138
 - US 139
 - US 140
 - US 141
 - US 142
 - US 143
 - US 144
 - US 145
 - US 146
 - US 147
 - US 148
 - US 149
 - US 150
 - US 151
 - US 152
 - US 153
 - US 154
 - US 155
 - US 156
 - US 157
 - US 158
 - US 159
 - US 160
 - US 161
 - US 162
 - US 163
 - US 164
 - US 165
 - US 166
 - US 167
 - US 168
 - US 169
 - US 170
 - US 171
 - US 172
 - US 173
 - US 174
 - US 175
 - US 176
 - US 177
 - US 178
 - US 179
 - US 180
 - US 181
 - US 182
 - US 183
 - US 184
 - US 185
 - US 186
 - US 187
 - US 188
 - US 189
 - US 190
 - US 191
 - US 192
 - US 193
 - US 194
 - US 195
 - US 196
 - US 197
 - US 198
 - US 199
 - US 200
 - US 201
 - US 202
 - US 203
 - US 204
 - US 205
 - US 206
 - US 207
 - US 208
 - US 209
 - US 210
 - US 211
 - US 212
 - US 213
 - US 214
 - US 215
 - US 216
 - US 217
 - US 218
 - US 219
 - US 220
 - US 221
 - US 222
 - US 223
 - US 224
 - US 225
 - US 226
 - US 227
 - US 228
 - US 229
 - US 230
 - US 231
 - US 232
 - US 233
 - US 234
 - US 235
 - US 236
 - US 237
 - US 238
 - US 239
 - US 240
 - US 241
 - US 242
 - US 243
 - US 244
 - US 245
 - US 246
 - US 247
 - US 248
 - US 249
 - US 250
 - US 251
 - US 252
 - US 253
 - US 254
 - US 255
 - US 256
 - US 257
 - US 258
 - US 259
 - US 260
 - US 261
 - US 262
 - US 263
 - US 264
 - US 265
 - US 266
 - US 267
 - US 268
 - US 269
 - US 270
 - US 271
 - US 272
 - US 273
 - US 274
 - US 275
 - US 276
 - US 277
 - US 278
 - US 279
 - US 280
 - US 281
 - US 282
 - US 283
 - US 284
 - US 285
 - US 286
 - US 287
 - US 288
 - US 289
 - US 290
 - US 291
 - US 292
 - US 293
 - US 294
 - US 295
 - US 296
 - US 297
 - US 298
 - US 299
 - US 300
 - US 301
 - US 302
 - US 303
 - US 304
 - US 305
 - US 306
 - US 307
 - US 308
 - US 309
 - US 310
 - US 311
 - US 312
 - US 313
 - US 314
 - US 315
 - US 316
 - US 317
 - US 318
 - US 319
 - US 320
 - US 321
 - US 322
 - US 323
 - US 324
 - US 325
 - US 326
 - US 327
 - US 328
 - US 329
 - US 330
 - US 331
 - US 332
 - US 333
 - US 334
 - US 335
 - US 336
 - US 337
 - US 338
 - US 339
 - US 340
 - US 341
 - US 342
 - US 343
 - US 344
 - US 345
 - US 346
 - US 347
 - US 348
 - US 349
 - US 350
 - US 351
 - US 352
 - US 353
 - US 354
 - US 355
 - US 356
 - US 357
 - US 358
 - US 359
 - US 360
 - US 361
 - US 362
 - US 363
 - US 364
 - US 365
 - US 366
 - US 367
 - US 368
 - US 369
 - US 370
 - US 371
 - US 372
 - US 373
 - US 374
 - US 375
 - US 376
 - US 377
 - US 378
 - US 379
 - US 380
 - US 381
 - US 382
 - US 383
 - US 384
 - US 385
 - US 386
 - US 387
 - US 388
 - US 389
 - US 390
 - US 391
 - US 392
 - US 393
 - US 394
 - US 395
 - US 396
 - US 397
 - US 398
 - US 399
 - US 400
 - US 401
 - US 402
 - US 403
 - US 404
 - US 405
 - US 406
 - US 407
 - US 408
 - US 409
 - US 410
 - US 411
 - US 412
 - US 413
 - US 414
 - US 415
 - US 416
 - US 417
 - US 418
 - US 419
 - US 420
 - US 421
 - US 422
 - US 423
 - US 424
 - US 425
 - US 426
 - US 427
 - US 428
 - US 429
 - US 430
 - US 431
 - US 432
 - US 433
 - US 434
 - US 435
 - US 436
 - US 437
 - US 438
 - US 439
 - US 440
 - US 441
 - US 442
 - US 443
 - US 444
 - US 445
 - US 446
 - US 447
 - US 448
 - US 449
 - US 450
 - US 451
 - US 452
 - US 453
 - US 454
 - US 455
 - US 456
 - US 457
 - US 458
 - US 459
 - US 460
 - US 461
 - US 462
 - US 463
 - US 464
 - US 465
 - US 466
 - US 467
 - US 468
 - US 469
 - US 470
 - US 471
 - US 472
 - US 473
 - US 474
 - US 475
 - US 476
 - US 477
 - US 478
 - US 479
 - US 480
 - US 481
 - US 482
 - US 483
 - US 484
 - US 485
 - US 486
 - US 487
 - US 488
 - US 489
 - US 490
 - US 491
 - US 492
 - US 493
 - US 494
 - US 495
 - US 496
 - US 497
 - US 498
 - US 499
 - US 500
 - US 501
 - US 502
 - US 503
 - US 504
 - US 505
 - US 506
 - US 507
 - US 508
 - US 509
 - US 510
 - US 511
 - US 512
 - US 513
 - US 514
 - US 515
 - US 516
 - US 517
 - US 518
 - US 519
 - US 520
 - US 521
 - US 522
 - US 523
 - US 524
 - US 525
 - US 526
 - US 527
 - US 528
 - US 529
 - US 530
 - US 531
 - US 532
 - US 533
 - US 534
 - US 535
 - US 536
 - US 537
 - US 538
 - US 539
 - US 540
 - US 541
 - US 542
 - US 543
 - US 544
 - US 545
 - US 546
 - US 547
 - US 548
 - US 549
 - US 550
 - US 551
 - US 552
 - US 553
 - US 554
 - US 555
 - US 556
 - US 557
 - US 558
 - US 559
 - US 560
 - US 561
 - US 562
 - US 563
 - US 564
 - US 565
 - US 566
 - US 567
 - US 568
 - US 569
 - US 570
 - US 571
 - US 572
 - US 573
 - US 574
 - US 575
 - US 576
 - US 577
 - US 578
 - US 579
 - US 580
 - US 581
 - US 582
 - US 583
 - US 584
 - US 585
 - US 586
 - US 587
 - US 588
 - US 589
 - US 590
 - US 591
 - US 592
 - US 593
 - US 594
 - US 595
 - US 596
 - US 597
 - US 598
 - US 599
 - US 600
 - US 601
 - US 602
 - US 603
 - US 604
 - US 605
 - US 606
 - US 607
 - US 608
 - US 609
 - US 610
 - US 611
 - US 612
 - US 613
 - US 614
 - US 615
 - US 616
 - US 617
 - US 618
 - US 619
 - US 620
 - US 621
 - US 622
 - US 623
 - US 624
 - US 625
 - US 626
 - US 627
 - US 628
 - US 629
 - US 630
 - US 631
 - US 632
 - US 633
 - US 634
 - US 635
 - US 636
 - US 637
 - US 638
 - US 639
 - US 640
 - US 641
 - US 642
 - US 643
 - US 644
 - US 645
 - US 646
 - US 647
 - US 648
 - US 649
 - US 650
 - US 651
 - US 652
 - US 653
 - US 654
 - US 655
 - US 656
 - US 657
 - US 658
 - US 659
 - US 660
 - US 661
 - US 662
 - US 663
 - US 664
 - US 665
 - US 666
 - US 667
 - US 668
 - US 669
 - US 670
 - US 671
 - US 672
 - US 673
 - US 674
 - US 675
 - US 676
 - US 677
 - US 678
 - US 679
 - US 680
 - US 681
 - US 682
 - US 683
 - US 684
 - US 685
 - US 686
 - US 687
 - US 688
 - US 689
 - US 690
 - US 691
 - US 692
 - US 693
 - US 694
 - US 695
 - US 696
 - US 697
 - US 698
 - US 699
 - US 700
 - US 701
 - US 702
 - US 703
 - US 704
 - US 705
 - US 706
 - US 707
 - US 708
 - US 709
 - US 710
 - US 711
 - US 712
 - US 713
 - US 714
 - US 715
 - US 716
 - US 717
 - US 718
 - US 719
 - US 720
 - US 721
 - US 722
 - US 723
 - US 724
 - US 725
 - US 726
 - US 727
 - US 728
 - US 729
 - US 730
 - US 731
 - US 732
 - US 733
 - US 734
 - US 735
 - US 736
 - US 737
 - US 738
 - US 739
 - US 740
 - US 741
 - US 742
 - US 743
 - US 744
 - US 745
 - US 746
 - US 747
 - US 748
 - US 749
 - US 750
 - US 751
 - US 752
 - US 753
 - US 754
 - US 755
 - US 756
 - US 757
 - US 758
 - US 759
 - US 760
 - US 761
 - US 762
 - US 763
 - US 764
 - US 765
 - US 766
 - US 767
 - US 768
 - US 769
 - US 770
 - US 771
 - US 772
 - US 773
 - US 774
 - US 775
 - US 776
 - US 777
 - US 778
 - US 779
 - US 780
 - US 781
 - US 782
 - US 783
 - US 784
 - US 785
 - US 786
 - US 787
 - US 788
 - US 789
 - US 790
 - US 791
 - US 792
 - US 793
 - US 794
 - US 795
 - US 796
 - US 797
 - US 798
 - US 799
 - US 800
 - US 801
 - US 802
 - US 803
 - US 804
 - US 805
 - US 806
 - US 807
 - US 808
 - US 809
 - US 810
 - US 811
 - US 812
 - US 813
 - US 814
 - US 815
 - US 816
 - US 817
 - US 818
 - US 819
 - US 820
 - US 821
 - US 822
 - US 823
 - US 824
 - US 825
 - US 826
 - US 827
 - US 828
 - US 829
 - US 830
 - US 831
 - US 832
 - US 833
 - US 834
 - US 835
 - US 836
 - US 837
 - US 838
 - US 839
 - US 840
 - US 841
 - US 842
 - US 843
 - US 844
 - US 845
 - US 846
 - US 847
 - US 848
 - US 849
 - US 850
 - US 851
 - US 852
 - US 853
 - US 854
 - US 855
 - US 856
 - US 857
 - US 858
 - US 859
 - US 860
 - US 861
 - US 862
 - US 863
 - US 864
 - US 865
 - US 866
 - US 867
 - US 868
 - US 869
 - US 870
 - US 871
 - US 872
 - US 873
 - US 874
 - US 875
 - US 876
 - US 877
 - US 878
 - US 879
 - US 880
 - US 881
 - US 882
 - US 883
 - US 884
 - US 885
 - US 886
 - US 887
 - US 888
 - US 889
 - US 890
 - US 891
 - US 892
 - US 893
 - US 894
 - US 895
 - US 896
 - US 897
 - US 898
 - US 899
 - US 900
 - US 901
 - US 902
 - US 903
 - US 904
 - US 905
 - US 906
 - US 907
 - US 908
 - US 909
 - US 910
 - US 911
 - US 912
 - US 913
 - US 914
 - US 915
 - US 916
 - US 917
 - US 918
 - US 919
 - US 920
 - US 921
 - US 922
 - US 923
 - US 924
 - US 925
 - US 926
 - US 927
 - US 928
 - US 929
 - US 930
 - US 931
 - US 932
 - US 933
 - US 934
 - US 935
 - US 936
 - US 937
 - US 938
 - US 939
 - US 940
 - US 941
 - US 942
 - US 943
 - US 944
 - US 945
 - US 946
 - US 947
 - US 948
 - US 949
 - US 950
 - US 951
 - US 952
 - US 953
 - US 954
 - US 955
 - US 956
 - US 957
 - US 958
 - US 959
 - US 960
 - US 961
 - US 962
 - US 963
 - US 964
 - US 965
 - US 966
 - US 967
 - US 968
 - US 969
 - US 970
 - US 971
 - US 972
 - US 973
 - US 974
 - US 975
 - US 976
 - US 977
 - US 978
 - US 979
 - US 980
 - US 981
 - US 982
 - US 983
 - US 984
 - US 985
 - US 986
 - US 987
 - US 988
 - US 989
 - US 990
 - US 991
 - US 992
 - US 993
 - US 994
 - US 995
 - US 996
 - US 997
 - US 998
 - US 999
 - US 1000

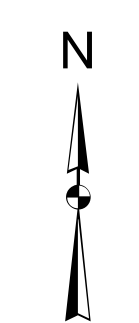

**GRANVILLE COUNTY
NORTH CAROLINA**

PREPARED BY THE
NORTH CAROLINA DEPARTMENT OF TRANSPORTATION
OPERATIONS PROGRAM MANAGEMENT UNIT - MAPPING SECTION
IN COOPERATION WITH THE
U.S. DEPARTMENT OF TRANSPORTATION
FEDERAL HIGHWAY ADMINISTRATION

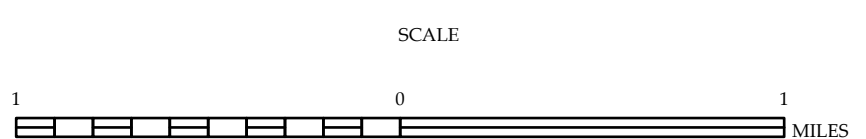

NORTH CAROLINA PLANE COORDINATE SYSTEM
LAMBERT CONFORMAL CONIC PROJECTION

TERMS OF USE: The Mapping Section shall provide the most accurate and current information possible. Map data is compiled from numerous sources with varying degrees of accuracy and reliability. The user assumes all responsibility for the accuracy of the information presented on this map. The information shown on this map was last updated in April 2024.

COPIES OF THIS MAP ARE AVAILABLE TO THE PUBLIC AT A NOMINAL COST. CONTACT US TO ORDER.
 919.857.3333
 https://www.ncdot.gov/InformationSystems/MapData/MapData.aspx

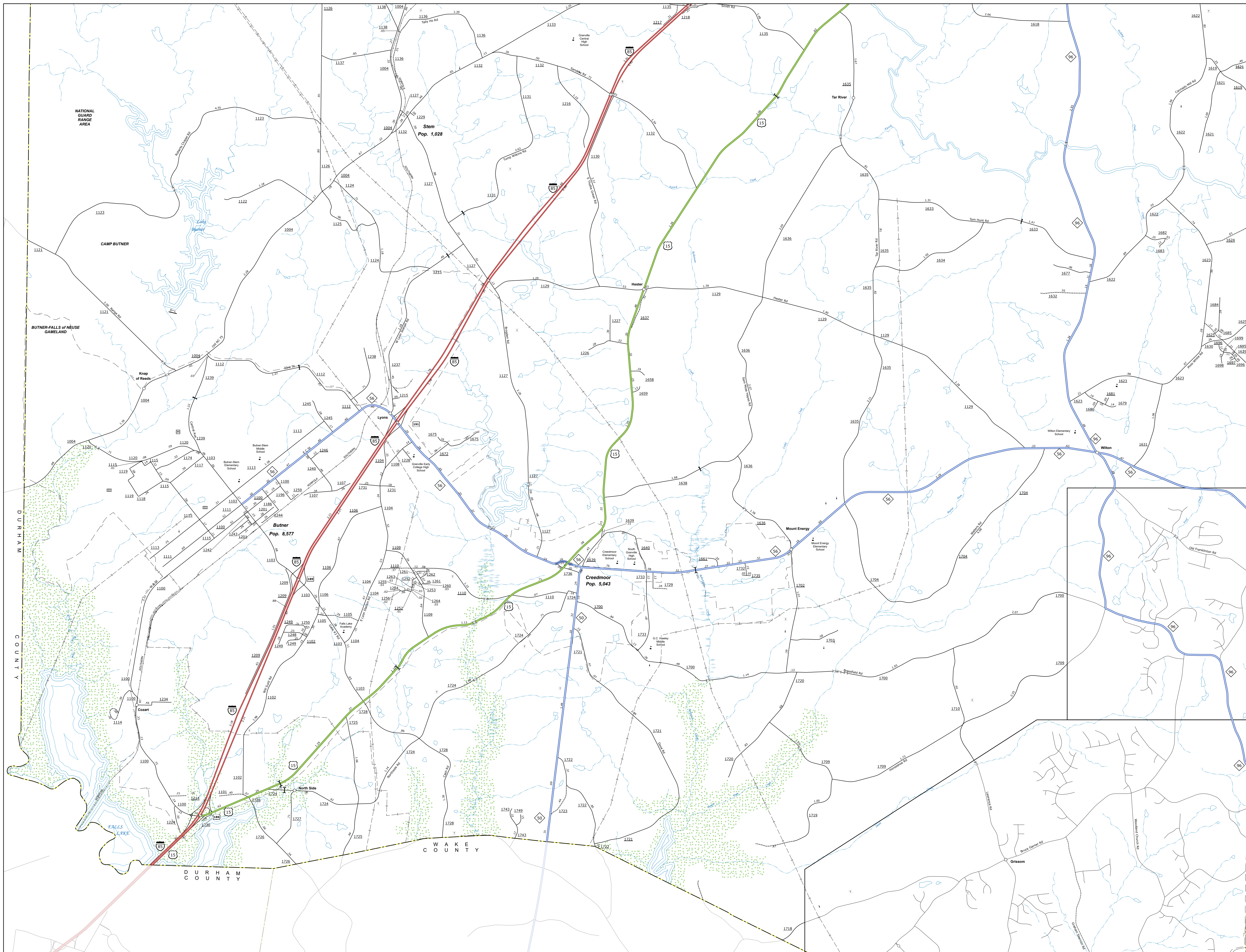

Sheet Key

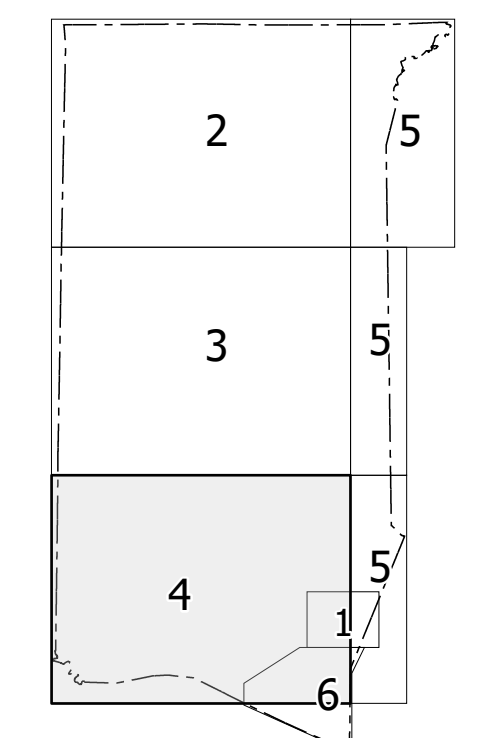

LEGEND

- INTERSTATE US NC
- US NUMBERED HIGHWAY
- US NUMBERED BI-CYCLE ROUTE
- STATE ROAD
- LOCAL ROAD
- UNPAVED ROAD
- PROPOSED ROAD
- PROPOSED BRIDGE
- PROPOSED UNDERPASS
- PROPOSED TUNNEL
- PROPOSED FERRY ROUTE
- PROPOSED RAILROAD
- PROPOSED RAILROAD STATION
- PROPOSED POST OFFICE
- PROPOSED MILITARY POST
- PROPOSED PARK STATION
- PROPOSED CORRECTIONAL OR PENAL INSTITUTION
- PROPOSED QUARRY
- PROPOSED HIGHWAY GARAGE OR MAINT. YARD
- PROPOSED HIGHWAY DIST. OR DIST. OFFICE
- PROPOSED MILITARY AIRPORT
- PROPOSED WILDLIFE REFUGE
- PROPOSED NATIONAL STATE PARK
- PROPOSED GAME LANDS
- PROPOSED MILITARY RESERVATION
- PROPOSED INDIAN RESERVATION

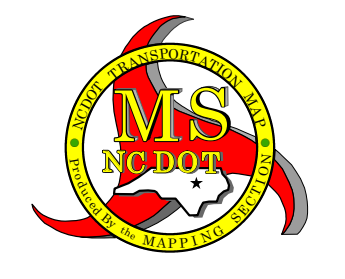
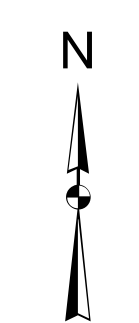

**GRANVILLE COUNTY
NORTH CAROLINA**

PREPARED BY THE
 NORTH CAROLINA DEPARTMENT OF TRANSPORTATION
 OPERATIONS PROGRAM MANAGEMENT UNIT - MAPPING SECTION
 IN COOPERATION WITH THE
 U.S. DEPARTMENT OF TRANSPORTATION
 FEDERAL HIGHWAY ADMINISTRATION

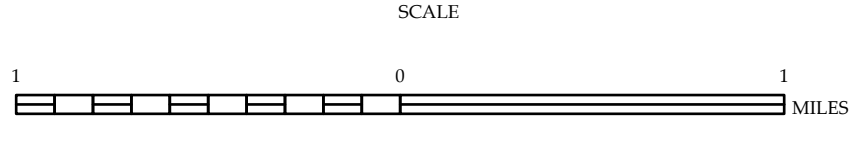

NORTH CAROLINA PLANE COORDINATE SYSTEM
 LAMBERT CONFORMAL CONIC PROJECTION

TERMS OF USE: The MapInfo Sector's goal is to provide the most accurate and current information possible. Map data is compiled from numerous sources with varying degrees of accuracy and may contain errors. As a result, the accuracy, currency and completeness of map content is not guaranteed. This information is provided for informational purposes only. The information shown on this map was last updated in April 2024.

COPIES OF THIS MAP ARE AVAILABLE TO THE PUBLIC AT NO CHARGE. CONTACT US TO OBTAIN: (704) 771-4241

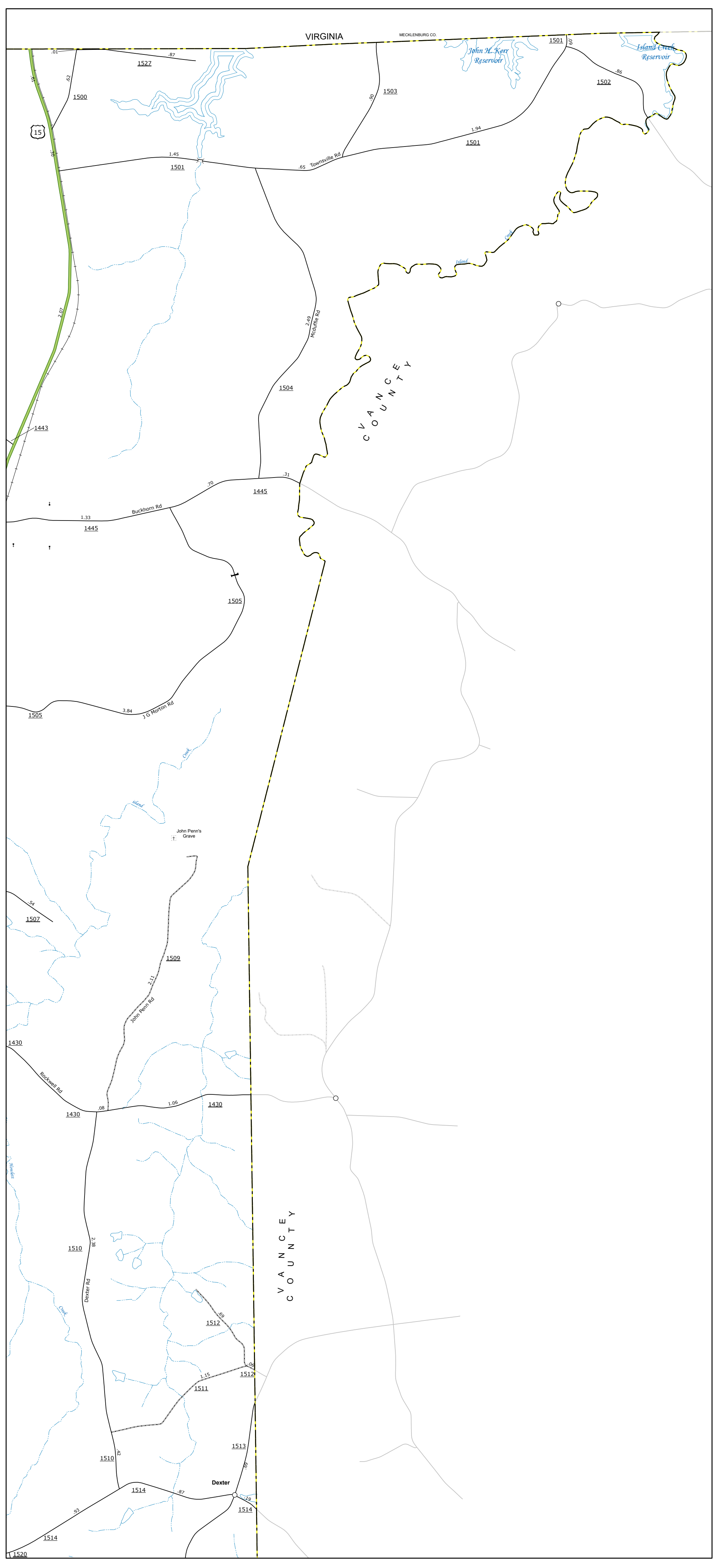

A

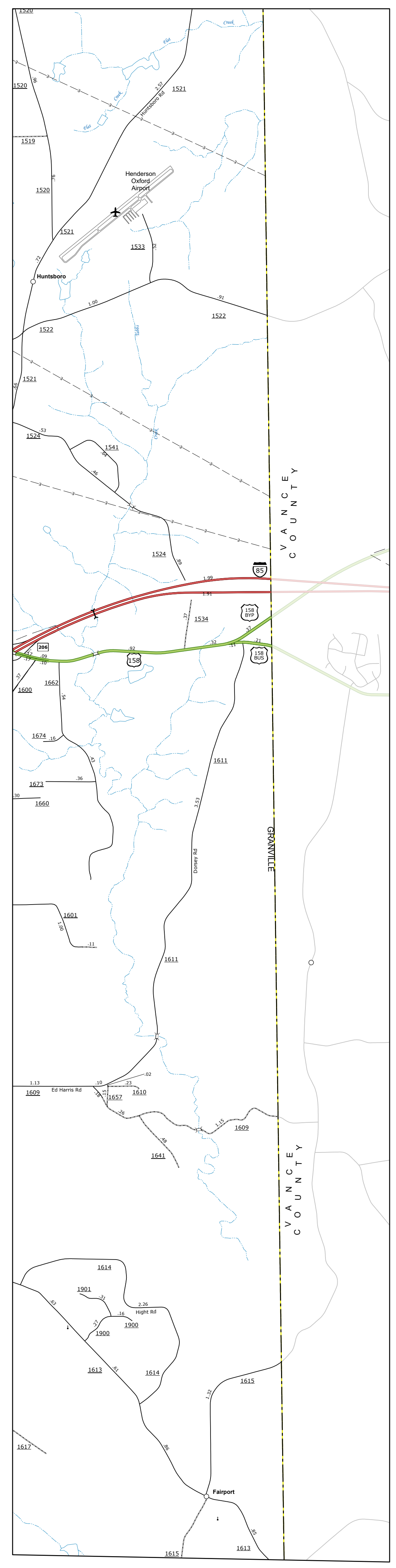

B

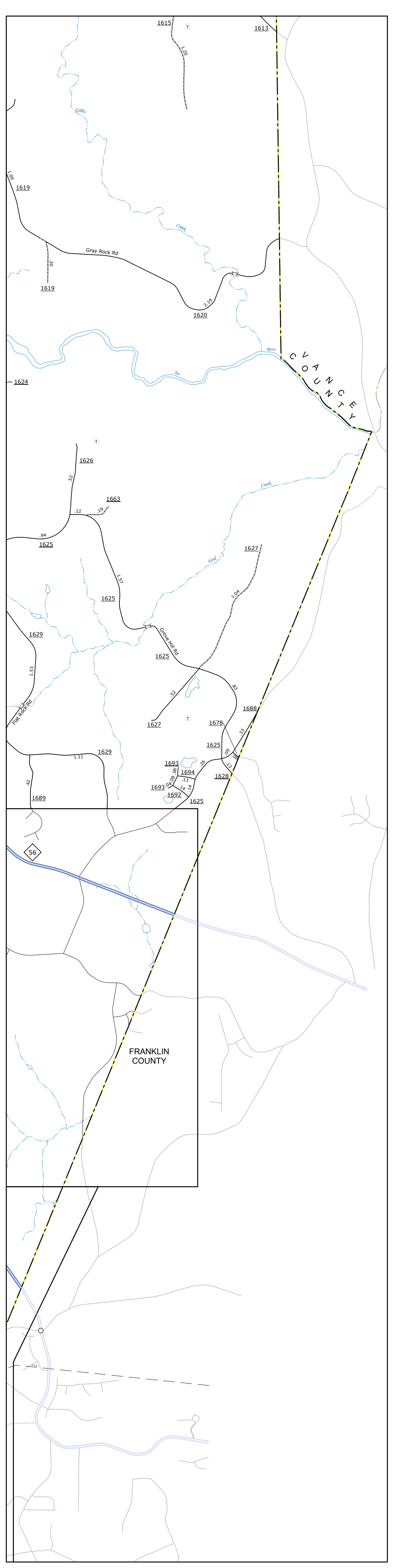

C

Sheet Key

2	A
3	B
4	C

1
6

LEGEND

INTERSTATE	US	NC	Divided Hwy
			Undivided Hwy
			BISS BRIDGE PARKWAY
			UNPAVED UNIMPROVED ROAD
			HARD SURF PAVED ROAD
			ROAD SYSTEM BRIDGE
			PROVISIONALLY DRAWN ROAD
			PREDICTED LOCATION
			INTERSECTION DISTANCE
			STANDARD ROAD BRIDGE
			RAILROAD BRIDGE
			DEAN SPAN ON BRIDGE
			PEDESTRIAN BRIDGE
			PEDESTRIAN WALKWAY
			PEDESTRIAN UNDERPASS
			VEHICULAR UNDERPASS
			TUNNEL
			CULVERT
			POW
			INTERSTATE HIGHWAY
			U.S. NUMBERED HIGHWAY
			N.C. NUMBERED HIGHWAY
			U.S. NUMBERED BI-CYCLE ROUTE
			N.C. NUMBERED BI-CYCLE ROUTE
			INTERSTATE INTERCHANGE NUMBER
			SECONDARY ROAD NUMBER
			UTILITY LINE
			RAILROAD LINE
			RAILROAD STATION
			POST OFFICE
			STATE LINE
			COUNTY LINE
			CITY LIMITS
			TOWN LIMITS
			TRAIL ROUTE
			NARROW CREEK OR STREAM
			WIDE RIVER OR CREEK
			RESERVOIR, POND, OR LAKE
			DAM OR DIAM WITH LOCK
			WATERFALL
			SWAMP
			COMMUNITY, TOWN OR CITY CENTER
			COUNTY SEAT
			SCHOOL
			COLLEGE OR UNIVERSITY
			HOSPITAL
			COURT HOUSE
			CHURCH
			CHURCH WITH CEMETERY
			CEMETERY
			PARK STATION
			CORRECTIONAL INSTITUTION
			QUARRY
			MOTOR BIT
			HIGHWAY GARAGE OR MAINT YARD
			IRREGULAR DIV. OR POST OFFICE
			MILITARY POST
			WEIGH STATION
			PARKING LOT
			HISTORICAL SITE
			POINTS OF INTEREST
			STATE FOREST
			LANDMARK
			MOUNTAIN SUMMIT
			OVERLOOK
			REST AREA
			VISITOR CENTER REST AREA
			WELCOME CENTER REST AREA
			SHELTER
			MILITARY AIRPORT
			HELIPORT
			NATIONAL STATE FOREST BOUNDARY
			WILDLIFE REFUGE
			NATIONAL STATE PARK BOUNDARY
			GAME LANDS BOUNDARY
			MILITARY RESERVATION BOUNDARY
			INDIAN RESERVATION BOUNDARY

N

GRANVILLE COUNTY
NORTH CAROLINA

PREPARED BY THE
NORTH CAROLINA DEPARTMENT OF TRANSPORTATION
OPERATIONS PROGRAM MANAGEMENT UNIT - MAPPING SECTION
IN COOPERATION WITH THE
U.S. DEPARTMENT OF TRANSPORTATION
FEDERAL HIGHWAY ADMINISTRATION

SCALE

0 0.5 1
MILES

NORTH CAROLINA PLANE COORDINATE SYSTEM
LAMBERT CONFORMAL CONIC PROJECTION

DIVISION 5 DISTRICT 2 GRANVILLE COUNTY NORTH CAROLINA FIPS 077

SHEET 5 of 6

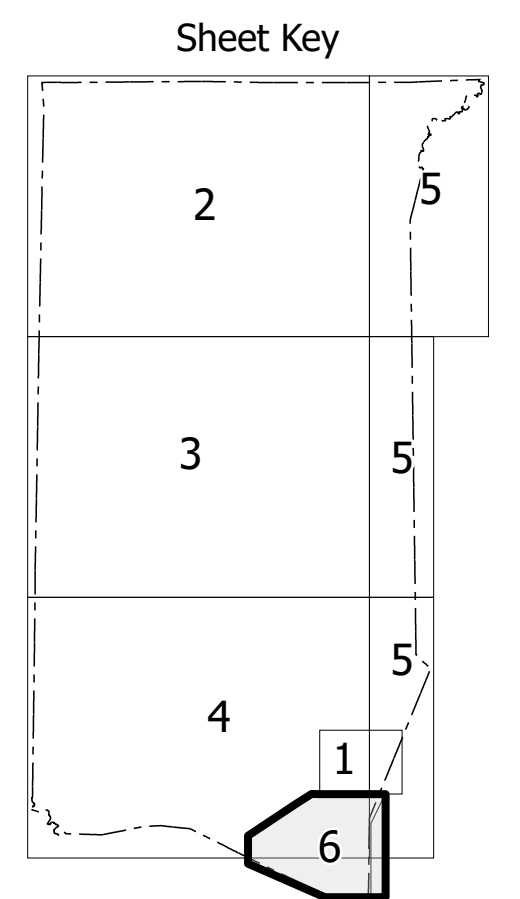
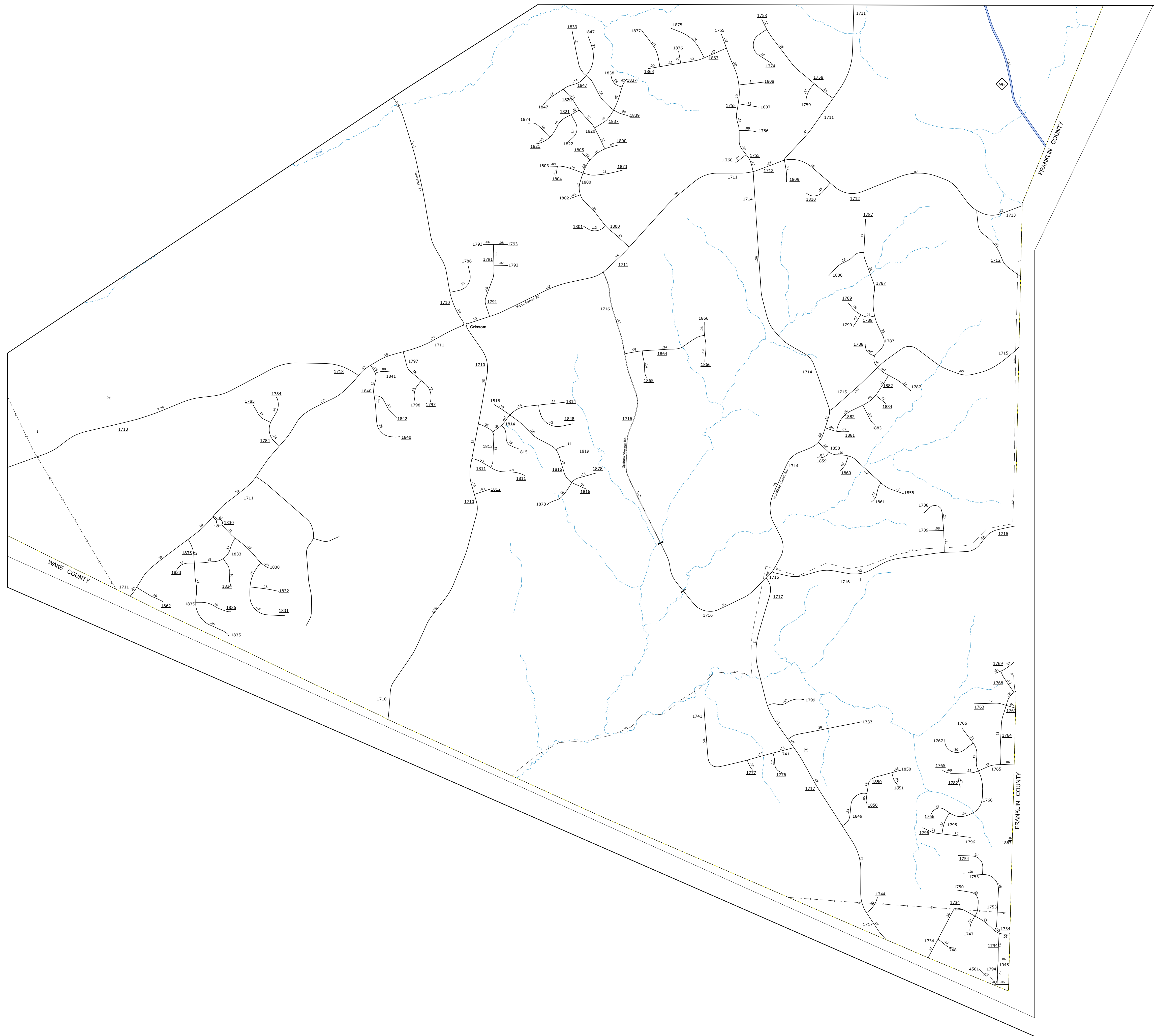

- LEGEND**
- INTERSTATE US NC Divided Hwy Undivided Hwy
 - BLUE RIDGE PARKWAY
 - UNPAVED/DIRTY ROAD
 - HARD SURFACE ROAD
 - NON-SYSTEM ROAD
 - PROVISIONALLY OPEN ROAD
 - PROJECTED LOCATION
 - INTERSECTION INSTANT
 - STANDARD ROAD BRIDGE
 - RAILROAD BRIDGE
 - DRAW SPAN ON BRIDGE
 - PEDESTRIAN BRIDGE
 - PEDESTRIAN WALKWAY
 - PEDESTRIAN UNDERPASS
 - VEHICLE UNDERPASS
 - TUNNEL
 - CULVERT
 - INT
 - INTERSTATE HIGHWAY
 - US NUMBERED HIGHWAY
 - NC NUMBERED HIGHWAY
 - US NUMBERED BICYCLE ROUTE
 - NC NUMBERED BICYCLE ROUTE
 - INTERSTATE INTERCHANGE NUMBER
 - SECONDARY ROAD NUMBER
 - TRAIL
 - UTILITY LINES
 - RAILROAD LINE
 - RAILROAD STATION
 - POST OFFICE
 - STATE LINE
 - COUNTY LINE
 - CITY LIMITS
 - FERRY ROUTE
 - NARROW CREEK OR STREAM
 - WIDE RIVER OR CREEK
 - RESERVOIR, POND OR LAKE W/ ISLAND
 - DAM OR DAM WITH LOCK
 - WATERFALL
 - SWAMP
 - COMMUNITY
 - COUNTY SEAT
 - SCHOOL
 - COLLEGE OR UNIVERSITY
 - FIRE STATION
 - COAST GUARD STATION
 - CHURCH
 - CHURCH WITH CEMETERY
 - CEMETERY
 - PARK STATION
 - CORRECTION OR PENAL INSTITUTION
 - QUARRY
 - HOME OR FT
 - HIGHWAY GARAGE OR MAINT. YARD
 - HIGHWAY INV. OR DIST. OFFICE
 - MILITARY POST
 - WEIGH STATION
 - FABRIQUINIS
 - HISTORICAL SITE
 - POINTS OF INTEREST
 - LIGHTHOUSE
 - MOUNTAIN SUMMIT
 - OVERLOOK
 - REST AREA
 - VISITOR CTR/REST AREA
 - WELCOM CTR/REST AREA
 - AIRPORT
 - MILITARY AIRPORT
 - HELIPORT
 - NATIONAL/STATE FOREST BOUNDARY
 - WILDLIFE REFUGE
 - NATIONAL/STATE PARK BOUNDARY
 - GAME LANDS BOUNDARY
 - MILITARY RESERVATION BOUNDARY
 - INDIAN RESERVATION BOUNDARY

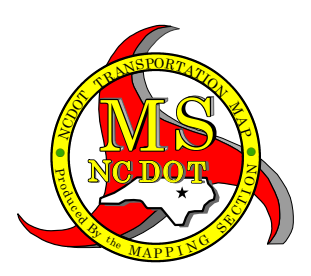
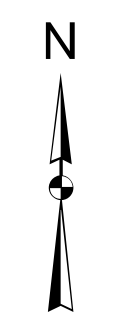

**GRANVILLE COUNTY
NORTH CAROLINA**

PREPARED BY THE
NORTH CAROLINA DEPARTMENT OF TRANSPORTATION
OPERATIONS PROGRAM MANAGEMENT UNIT - MAPPING SECTION
IN COOPERATION WITH THE
U.S. DEPARTMENT OF TRANSPORTATION
FEDERAL HIGHWAY ADMINISTRATION

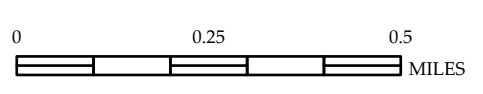

NORTH CAROLINA PLANE COORDINATE SYSTEM
LAMBERT CONFORMAL CONIC PROJECTION

TERMS OF USE: The MapInfo Section's goal is to provide the most accurate and current information possible. Map data is compiled from numerous sources with varying degrees of accuracy and map accuracy standards. As a result, the accuracy, currency, and completeness of map data cannot be guaranteed. This information shown on this map was last updated in April 2024.

COPIES OF THIS MAP ARE AVAILABLE TO THE PUBLIC AT NO CHARGE. CONTACT US TO OBTAIN: (919) 733-4341