

- LEGEND**
- INTERSTATE US NC
 - INTERSTATE HIGHWAY
 - U.S. NUMBERED HIGHWAY
 - N.C. NUMBERED HIGHWAY
 - N.C. NUMBERED BI-CYCLE ROUTE
 - INTERSTATE OVERPASS
 - SECONDARY ROAD NUMBER
 - UTILITY LINES
 - RAILROAD LINES
 - RAILROAD STATION
 - INSULATED AREA
 - STATE LINES
 - COUNTY LINES
 - SMOOTHED BOUNDARIES
 - CITY LIMITS
 - TOWN WITH AND AROUND
 - NARROW CREEK OR STREAM
 - WIDE RIVER OR CREEK
 - RESERVOIR, POND, LAKE, W/ ISLAND
 - DAM OR DAM WITH LOCK
 - WATERFALL
 - SWAMP
 - COMBUNITY
 - COUNTY SEAT
 - SCHOOL
 - COURT OR UNIVERSITY
 - HOSPITAL
 - COURT HOUSE
 - COURT CLERK'S OFFICE
 - CHESS
 - CHESS WITH CEMETERY
 - CEMETERY
 - PARK STATION
 - CORRECTIONAL INSTITUTION
 - QUARRY
 - MINE OR BIT
 - HIGHWAY GARAGE OR MAINT. YARD
 - BRIDGE (ON OR OFF) OFFICE
 - SOLDIERY POST
 - WAREHOUSE
 - FARMHOUSE
 - HISTORICAL SITE
 - POINTE OF INTEREST
 - POST OFFICE
 - FIELD HOUSE
 - LIGHTHOUSE
 - SHOOTING RANGE
 - MOUNTAIN GAP
 - OVERLOOK
 - REST AREA
 - WELCOME CENTER AREA
 - AIRPORT
 - MILITARY AIRPORT
 - NATIONAL STATE FOREST BOUNDARY
 - WILDLIFE REFUGE
 - NATIONAL STATE PARK BOUNDARY
 - GAME LANDS BOUNDARY
 - MILITARY RESERVATION BOUNDARY
 - INDIAN RESERVATION BOUNDARY

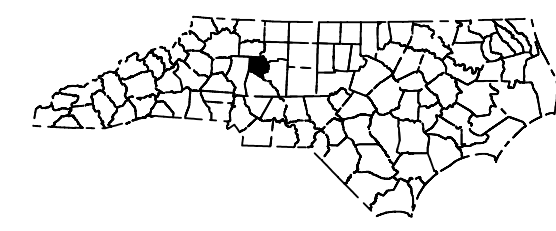

**DAVIE COUNTY
NORTH CAROLINA**

PREPARED BY THE
NORTH CAROLINA DEPARTMENT OF TRANSPORTATION
OPERATIONS PROGRAM MANAGEMENT UNIT - MAPPING SECTION
IN COOPERATION WITH THE
U.S. DEPARTMENT OF TRANSPORTATION
FEDERAL HIGHWAY ADMINISTRATION

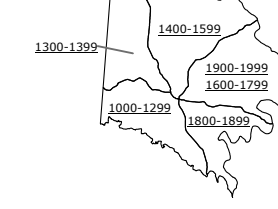
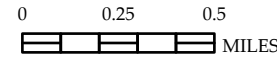
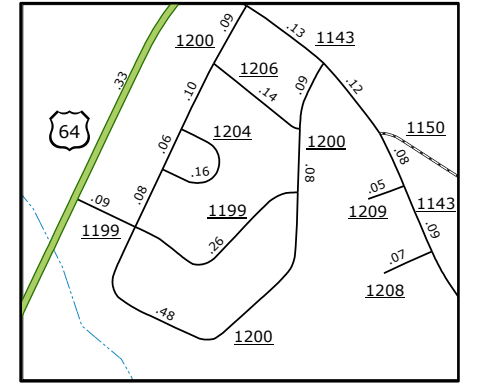
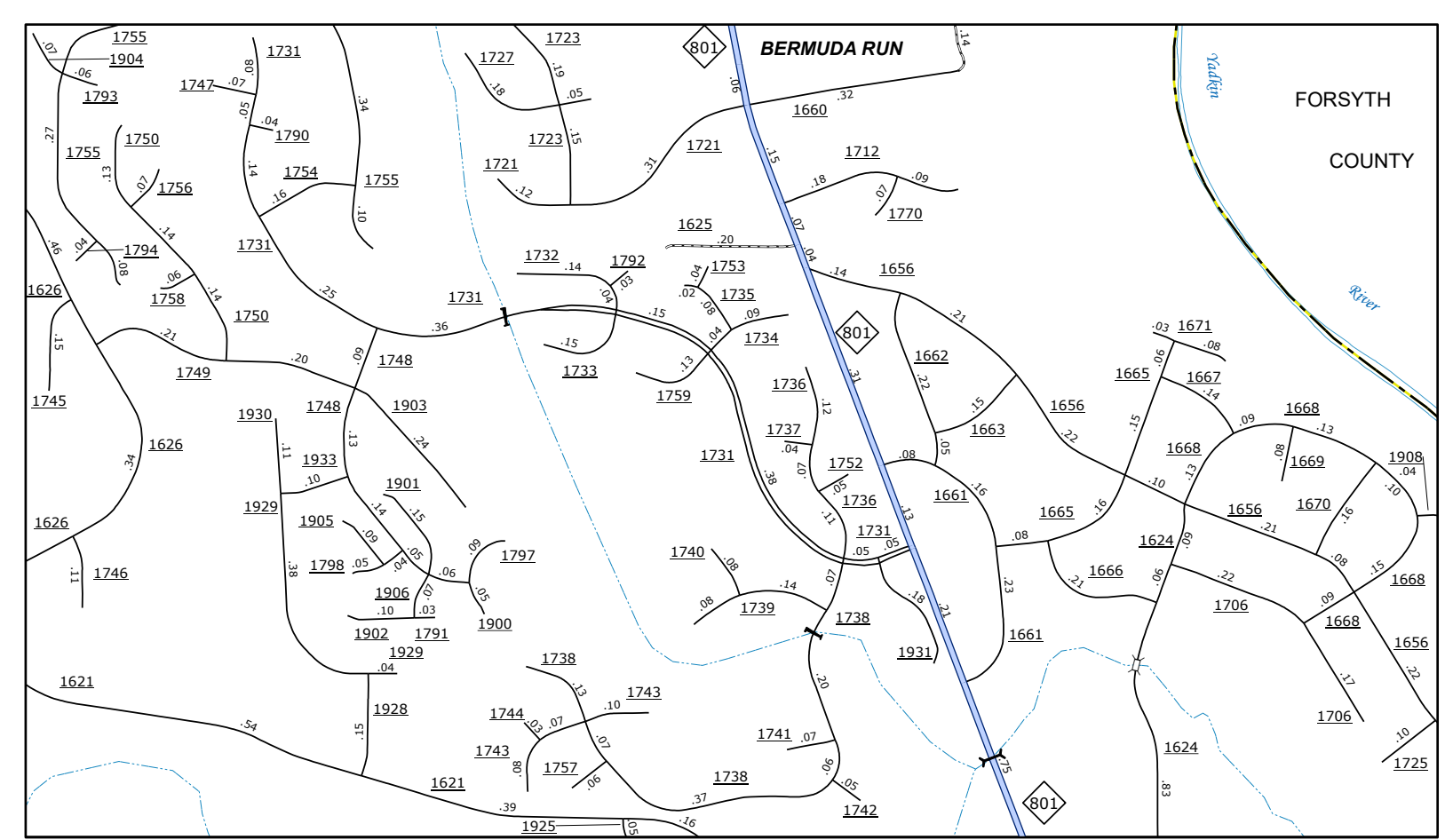
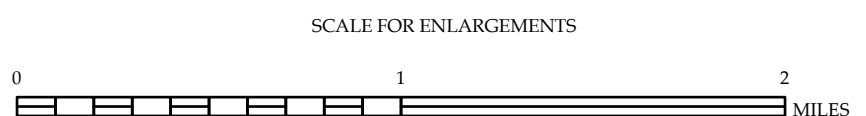
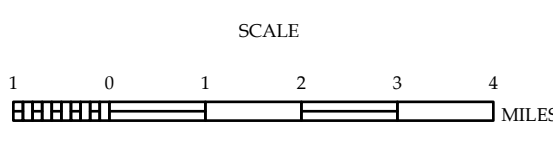

COPIES OF THIS MAP ARE AVAILABLE TO THE PUBLIC AT NOMINAL COST. CONTACT US TO ORDER: maps@ncdot.gov <https://connect.ncdot.gov/resources/StateMapping/Pages/Ordering.aspx> (817) 834-8480

TERMS OF USE: The Mapping Section's goal is to provide the most accurate and current information possible. Map data is compiled from numerous sources with varying dates of publication and map accuracy standards. As a result, the accuracy, currency, and completeness of the data provided will vary. The North Carolina Department of Transportation shall not be held liable for any errors in the map data. This map cannot be construed to be a legal document. The information shown on this map was last updated in March 2024. For digital copies of this map or additional map products, visit <https://connect.ncdot.gov/resources/StateMapping>.

NORTH CAROLINA PLANE COORDINATE SYSTEM
LAMBERT CONFORMAL CONIC PROJECTION

The Planning Section will provide the most accurate and current information possible. Map data is compiled from numerous sources with varying dates of publication and may not reflect the most current information. The accuracy of the information is not guaranteed. For more information, please contact the Planning Section at 919-855-4400.

COPIES OF THIS MAP ARE AVAILABLE TO THE PUBLIC AT NO CHARGE. For more information, please contact the Planning Section at 919-855-4400.

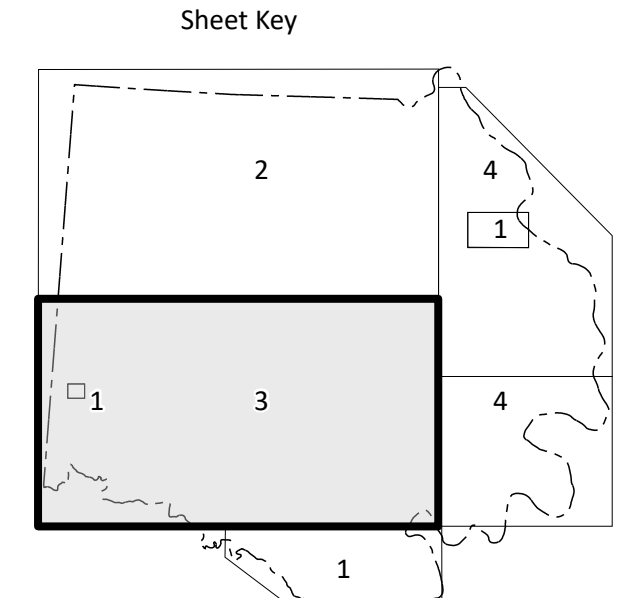
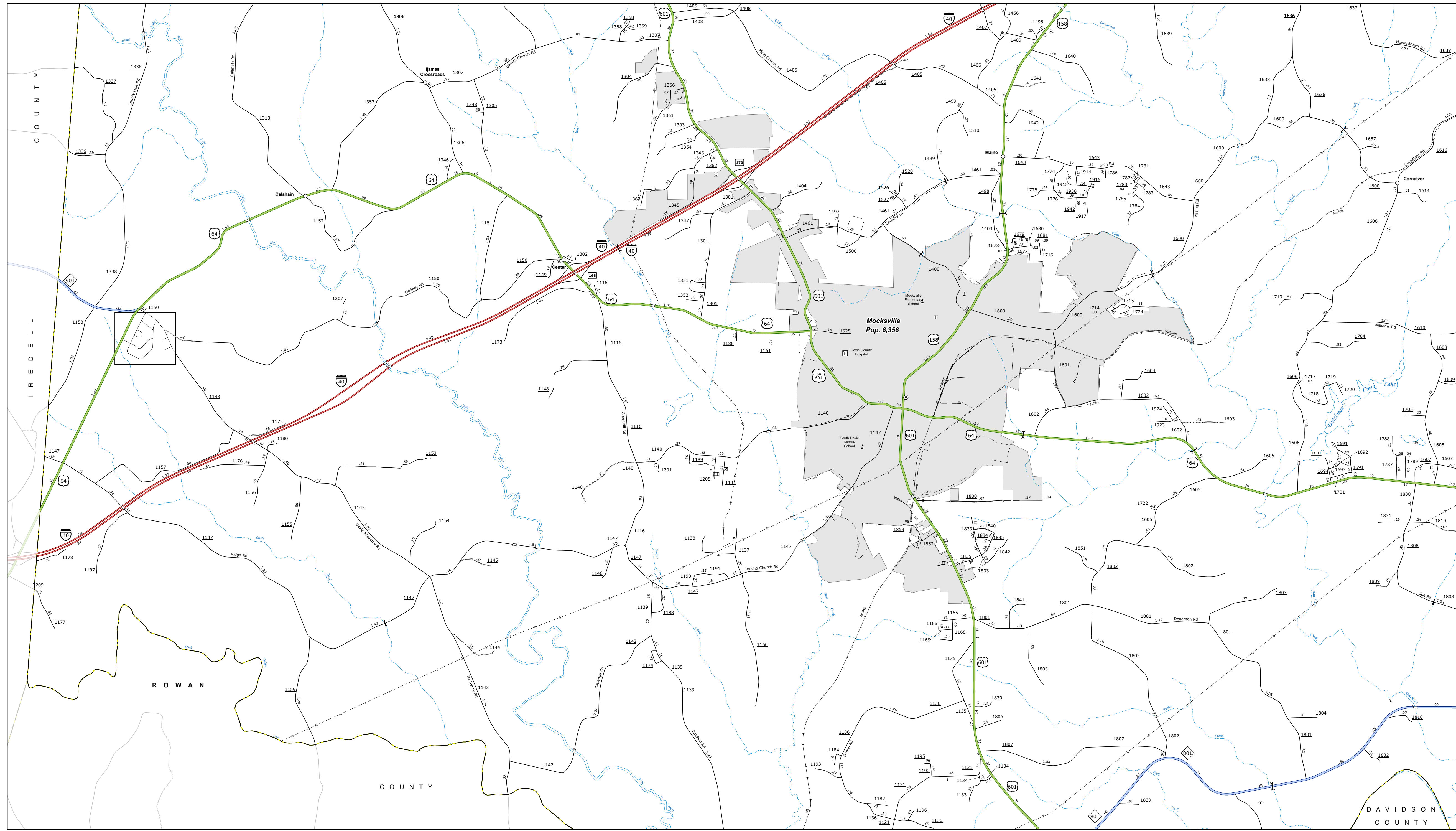

- LEGEND**
- INTERSTATE US NC
 - US 421
 - US 64
 - US 158
 - US 601
 - US 602
 - US 603
 - US 604
 - US 605
 - US 606
 - US 607
 - US 608
 - US 609
 - US 610
 - US 611
 - US 612
 - US 613
 - US 614
 - US 615
 - US 616
 - US 617
 - US 618
 - US 619
 - US 620
 - US 621
 - US 622
 - US 623
 - US 624
 - US 625
 - US 626
 - US 627
 - US 628
 - US 629
 - US 630
 - US 631
 - US 632
 - US 633
 - US 634
 - US 635
 - US 636
 - US 637
 - US 638
 - US 639
 - US 640
 - US 641
 - US 642
 - US 643
 - US 644
 - US 645
 - US 646
 - US 647
 - US 648
 - US 649
 - US 650
 - US 651
 - US 652
 - US 653
 - US 654
 - US 655
 - US 656
 - US 657
 - US 658
 - US 659
 - US 660
 - US 661
 - US 662
 - US 663
 - US 664
 - US 665
 - US 666
 - US 667
 - US 668
 - US 669
 - US 670
 - US 671
 - US 672
 - US 673
 - US 674
 - US 675
 - US 676
 - US 677
 - US 678
 - US 679
 - US 680
 - US 681
 - US 682
 - US 683
 - US 684
 - US 685
 - US 686
 - US 687
 - US 688
 - US 689
 - US 690
 - US 691
 - US 692
 - US 693
 - US 694
 - US 695
 - US 696
 - US 697
 - US 698
 - US 699
 - US 700
 - US 701
 - US 702
 - US 703
 - US 704
 - US 705
 - US 706
 - US 707
 - US 708
 - US 709
 - US 710
 - US 711
 - US 712
 - US 713
 - US 714
 - US 715
 - US 716
 - US 717
 - US 718
 - US 719
 - US 720
 - US 721
 - US 722
 - US 723
 - US 724
 - US 725
 - US 726
 - US 727
 - US 728
 - US 729
 - US 730
 - US 731
 - US 732
 - US 733
 - US 734
 - US 735
 - US 736
 - US 737
 - US 738
 - US 739
 - US 740
 - US 741
 - US 742
 - US 743
 - US 744
 - US 745
 - US 746
 - US 747
 - US 748
 - US 749
 - US 750
 - US 751
 - US 752
 - US 753
 - US 754
 - US 755
 - US 756
 - US 757
 - US 758
 - US 759
 - US 760
 - US 761
 - US 762
 - US 763
 - US 764
 - US 765
 - US 766
 - US 767
 - US 768
 - US 769
 - US 770
 - US 771
 - US 772
 - US 773
 - US 774
 - US 775
 - US 776
 - US 777
 - US 778
 - US 779
 - US 780
 - US 781
 - US 782
 - US 783
 - US 784
 - US 785
 - US 786
 - US 787
 - US 788
 - US 789
 - US 790
 - US 791
 - US 792
 - US 793
 - US 794
 - US 795
 - US 796
 - US 797
 - US 798
 - US 799
 - US 800
 - US 801
 - US 802
 - US 803
 - US 804
 - US 805
 - US 806
 - US 807
 - US 808
 - US 809
 - US 810
 - US 811
 - US 812
 - US 813
 - US 814
 - US 815
 - US 816
 - US 817
 - US 818
 - US 819
 - US 820
 - US 821
 - US 822
 - US 823
 - US 824
 - US 825
 - US 826
 - US 827
 - US 828
 - US 829
 - US 830
 - US 831
 - US 832
 - US 833
 - US 834
 - US 835
 - US 836
 - US 837
 - US 838
 - US 839
 - US 840
 - US 841
 - US 842
 - US 843
 - US 844
 - US 845
 - US 846
 - US 847
 - US 848
 - US 849
 - US 850
 - US 851
 - US 852
 - US 853
 - US 854
 - US 855
 - US 856
 - US 857
 - US 858
 - US 859
 - US 860
 - US 861
 - US 862
 - US 863
 - US 864
 - US 865
 - US 866
 - US 867
 - US 868
 - US 869
 - US 870
 - US 871
 - US 872
 - US 873
 - US 874
 - US 875
 - US 876
 - US 877
 - US 878
 - US 879
 - US 880
 - US 881
 - US 882
 - US 883
 - US 884
 - US 885
 - US 886
 - US 887
 - US 888
 - US 889
 - US 890
 - US 891
 - US 892
 - US 893
 - US 894
 - US 895
 - US 896
 - US 897
 - US 898
 - US 899
 - US 900
 - US 901
 - US 902
 - US 903
 - US 904
 - US 905
 - US 906
 - US 907
 - US 908
 - US 909
 - US 910
 - US 911
 - US 912
 - US 913
 - US 914
 - US 915
 - US 916
 - US 917
 - US 918
 - US 919
 - US 920
 - US 921
 - US 922
 - US 923
 - US 924
 - US 925
 - US 926
 - US 927
 - US 928
 - US 929
 - US 930
 - US 931
 - US 932
 - US 933
 - US 934
 - US 935
 - US 936
 - US 937
 - US 938
 - US 939
 - US 940
 - US 941
 - US 942
 - US 943
 - US 944
 - US 945
 - US 946
 - US 947
 - US 948
 - US 949
 - US 950
 - US 951
 - US 952
 - US 953
 - US 954
 - US 955
 - US 956
 - US 957
 - US 958
 - US 959
 - US 960
 - US 961
 - US 962
 - US 963
 - US 964
 - US 965
 - US 966
 - US 967
 - US 968
 - US 969
 - US 970
 - US 971
 - US 972
 - US 973
 - US 974
 - US 975
 - US 976
 - US 977
 - US 978
 - US 979
 - US 980
 - US 981
 - US 982
 - US 983
 - US 984
 - US 985
 - US 986
 - US 987
 - US 988
 - US 989
 - US 990
 - US 991
 - US 992
 - US 993
 - US 994
 - US 995
 - US 996
 - US 997
 - US 998
 - US 999
 - US 1000

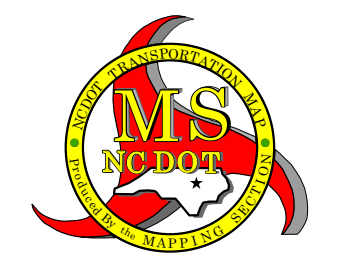
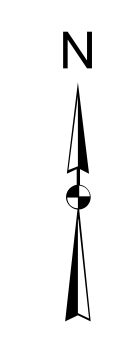

**DAVIE COUNTY
NORTH CAROLINA**

PREPARED BY THE
NORTH CAROLINA DEPARTMENT OF TRANSPORTATION
OPERATIONS PROGRAM MANAGEMENT UNIT - MAPPING SECTION
IN COOPERATION WITH THE
U.S. DEPARTMENT OF TRANSPORTATION
FEDERAL HIGHWAY ADMINISTRATION

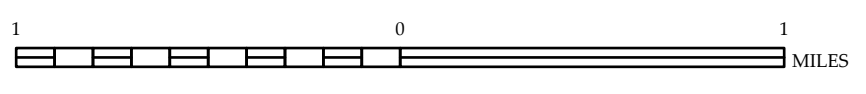

NORTH CAROLINA PLANE COORDINATE SYSTEM
LAMBERT CONFORMAL CONIC PROJECTION

