

LEGEND

- INTERSTATE US NC Divided Hwy Undivided Hwy
- UNPAVED SURFACED ROAD
- NON-SYSTEM ROAD
- PROVISIONALLY DRAWN ROAD
- INTERSECTION DISTANCE
- STANDARD ROAD BRIDGE
- RAILROAD BRIDGE
- DRAW SPAN OR BRIDGE
- PEDESTRIAN BRIDGE
- PEDESTRIAN WALKWAY
- PEDESTRIAN UNDERPASS
- VEHICULAR UNDERPASS
- TUNNEL
- CULVERT
- PIPE
- INTERSTATE HIGHWAY
- U.S. NUMBERED HIGHWAY
- S.C. NUMBERED HIGHWAY
- U.S. NUMBERED BI-CYCLE ROUTE
- S.C. NUMBERED BI-CYCLE ROUTE
- INTERSTATE INTERCHANGE NUMBER
- SECONDARY ROAD NUMBER
- UTILITY LINES
- RAILROAD LINE
- RAILROAD STATION
- INLET AREA
- STATE LINE
- COUNTY LINE
- SMOOTHED URBAN BOUNDARIES
- CITY LIMITS
- PORTY NORTH AND RAMP
- NARROW CREEK OR STREAM
- WIDE RIVER OR CREEK
- RESERVOIR, POND OR LAKE W/ ISLAND
- DAM OR DAM WITH LOCK
- WATERFALL
- SWAMP
- COMMUNITY
- COUNTY SEAT
- SCHOOL
- COLLEGE OR UNIVERSITY
- HOSPITAL
- COAST GUARD STATION
- CHURCH
- CHURCH WITH CEMETERY
- CEMETERY
- PATROL STATION
- CORRECTION OR PENAL INSTITUTION
- QUARRY
- MAINE OR PIT
- HIGHWAY GARAGE OR MAINT. YARD
- HIGHWAY BOY OR DIST. OFFICE
- MILITARY POST
- WEIGH STATION
- FAIRGROUNDS
- HISTORICAL SITE
- POINTS OF INTEREST
- POST OFFICE
- STATE FOREST
- LIGHTHOUSE
- MOUNTAIN SUMMIT
- OVERLOOK
- MOUNTAIN GAP
- REST AREA
- VISITOR CENTER REST AREA
- WELCOME CTR REST AREA
- AIRPORT
- MILITARY AIRPORT
- NATIONAL / STATE FOREST BOUNDARY
- WILDLIFE REFUGE
- NATIONAL / STATE PARK BOUNDARY
- GAME LANDS BOUNDARY
- MILITARY RESERVATION BOUNDARY
- INDIAN RESERVATION BOUNDARY



BUNCOMBE COUNTY
NORTH CAROLINA

PREPARED BY THE
NORTH CAROLINA DEPARTMENT OF TRANSPORTATION
OPERATIONS PROGRAM MANAGEMENT UNIT - MAPPING SECTION
IN COOPERATION WITH THE
U.S. DEPARTMENT OF TRANSPORTATION
FEDERAL HIGHWAY ADMINISTRATION

SCALE

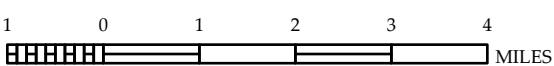

COPIES OF THIS MAP ARE AVAILABLE TO THE
PUBLIC AT NOMINAL COST. CONTACT US TO ORDER:
maps@ncdot.gov
<https://www.ncdot.gov/resources/State-Mapping/Pages/Ordering-Maps.aspx>
(919) 834-8480

TERMS OF USE: The Mapping Section's goal is to provide the most accurate and current information possible. Map data is compiled from numerous sources with varying dates of publication and map accuracy standards. As a result, the accuracy, currency, and completeness of the data provided will vary. The North Carolina Department of Transportation shall not be held liable for any errors in the map data. This map cannot be construed to be a legal document. The information shown on this map was last updated in July 2025.
For digital copies of this map or additional map products, visit <https://buncombe.ncdot.gov/resources/State-Mapping>.

NORTH CAROLINA PLANE COORDINATE SYSTEM
LAMBERT CONFORMAL CONIC PROJECTION

TERMS OF USE: The Mapping Section's goal is to provide the most accurate and current information possible. Map data is compiled from numerous sources with varying dates of publication and may contain errors. As a result, the accuracy, currency and completeness of this information cannot be guaranteed. This information is provided as a public service and is not intended to be used for legal purposes. For additional information or to report errors, please contact the Mapping Section at (919) 844-4444.

COPIES OF THIS MAP ARE AVAILABLE TO THE PUBLIC AT NO CHARGE. TO ORDER, CONTACT THE BUNCOMBE COUNTY MAPS SECTION AT (919) 844-4444.

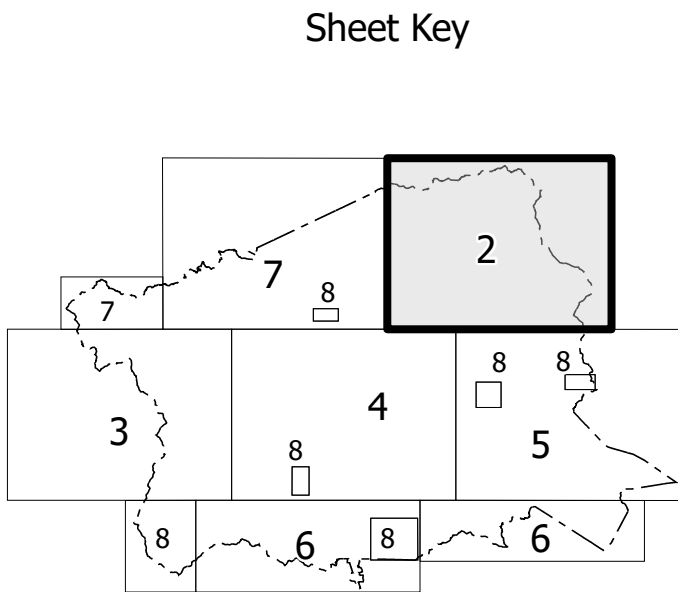
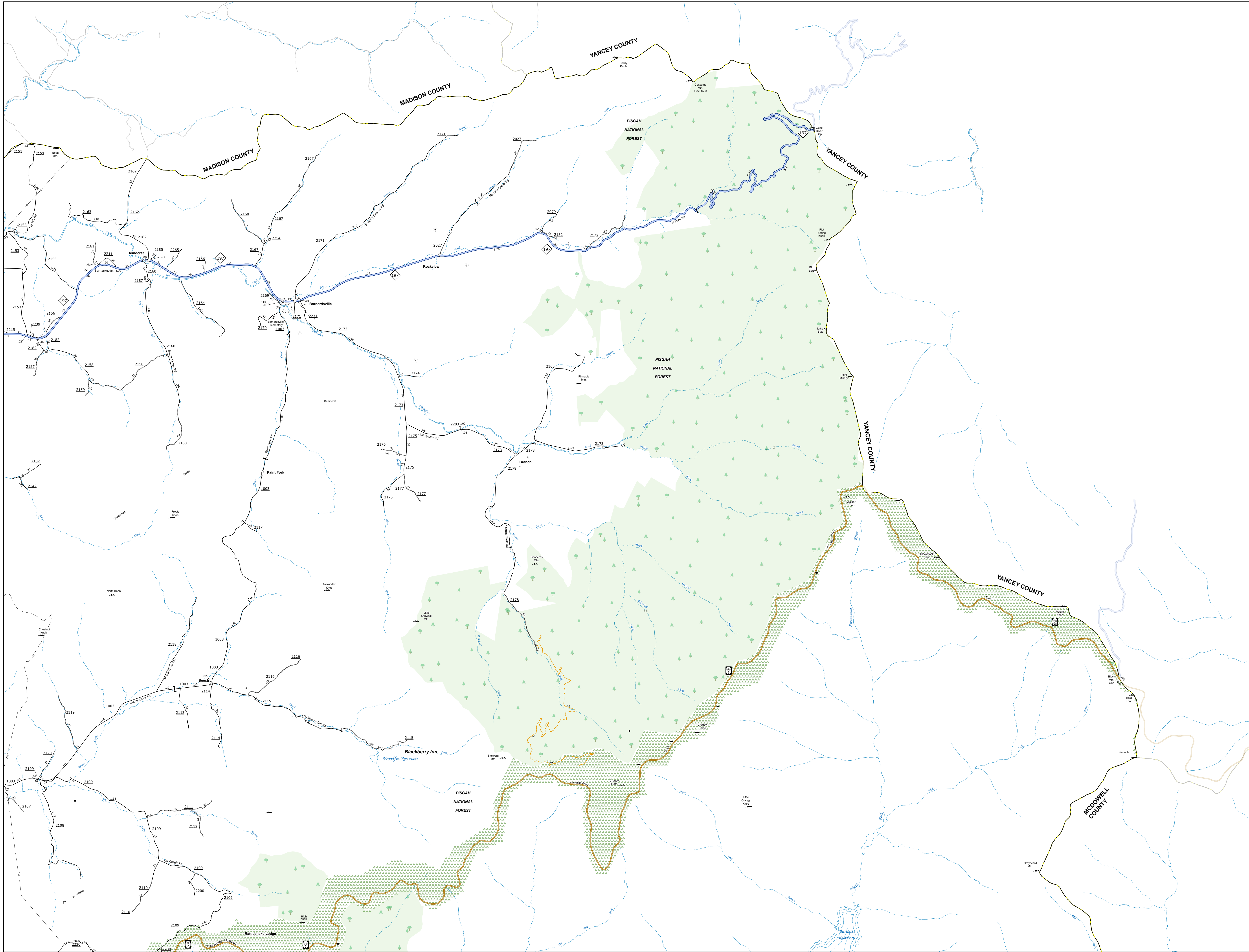

LEGEND

- INTERSTATE: US, NC, Divided Hwy, Undivided Hwy
- BLUE RIDGE PARKWAY
- UNPAVED SURFACED ROAD
- HARD SURFACED ROAD
- NONSURFACED ROAD
- PROVISIONALLY DRAWN ROAD
- PROJECTED ROAD
- INTERSECTION DISTANCE
- STANDARD ROAD BRIDGE
- RAILROAD BRIDGE
- DRAW SPAN ON BRIDGE
- PEDESTRIAN BRIDGE
- PEDESTRIAN WALKWAY
- PEDESTRIAN UNDERPASS
- VEHICLE UNDERPASS
- TUNNEL
- CULVERT
- PYE
- INTERSTATE HIGHWAY
- U.S. NUMBERED HIGHWAY
- N.C. NUMBERED HIGHWAY
- U.S. NUMBERED BI-CYCLE ROUTE
- N.C. NUMBERED BI-CYCLE ROUTE
- INTERSTATE INTERCHANGE NUMBER
- SECONDARY ROAD NUMBER
- UTILITY LINES
- RAILROAD LINE
- RAILROAD STATION
- INSET AREA
- STATE LINE
- COUNTY LINE
- SMOOTHED URBAN BOUNDARIES
- CITY LIMITS
- FERRY ROUTE AND RAMP
- NARROW CREEK OR STREAM
- WIDE RIVER OR CREEK
- RESERVOIR, POND OR LAKE W/ ISLAND
- DAM OR DAM WITH LOCK
- WATERFALL
- SWAMP
- COMMUNITY
- COUNTY SEAT
- SCHOOL
- COLLEGE OR UNIVERSITY
- HOSPITAL
- COAST GUARD STATION
- CHURCH
- CHURCH WITH CEMETERY
- CEMETERY
- PATROL STATION
- CORRECTION OR PENAL INSTITUTION
- QUARRY
- MINE OR PIT
- HIGHWAY GARAGE OR MAINT. YARD
- HIGHWAY DIV. OR DIST. OFFICE
- MILITARY POST
- WATER STATION
- FAIRGROUNDS
- HISTORICAL SITE
- POINT OF INTEREST
- POST OFFICE
- STATE FOREST
- LIGHTHOUSE
- MOUNTAIN SUMMIT
- MOUNTAIN GAP
- OVERLOOK
- REST AREA
- VISITOR CENTER AREA
- WELCOME CENTER AREA
- AIRPORT
- MILITARY AIRPORT
- NATIONAL - STATE FOREST BOUNDARY
- WILDLIFE REFUGE
- NATIONAL - STATE PARK BOUNDARY
- GAME LANDS BOUNDARY
- MILITARY RESERVATION BOUNDARY
- INDIAN RESERVATION BOUNDARY



BUNCOMBE COUNTY
NORTH CAROLINA

PREPARED BY THE
NORTH CAROLINA DEPARTMENT OF TRANSPORTATION
OPERATIONS PROGRAM MANAGEMENT UNIT - MAPPING SECTION
IN COOPERATION WITH THE
U.S. DEPARTMENT OF TRANSPORTATION
FEDERAL HIGHWAY ADMINISTRATION

SCALE

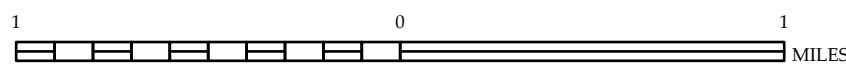

NORTH CAROLINA PLANE COORDINATE SYSTEM
LAMBERT CONFORMAL CONIC PROJECTION

TERMS OF USE: The Mapping Section's goal is to provide the most accurate and current information possible. Map data is compiled from numerous sources with varying dates of publication and may contain inaccuracies. As a result, the accuracy, currency and completeness of this map cannot be guaranteed to be a legal document. The information shown on this map was last updated in July 2025.

COPIES OF THIS MAP ARE AVAILABLE TO THE PUBLIC AT NORMAL COST. CONTACT US TO ORDER: maps@dot.nc.gov or [919 763 4440](tel:9197634440)

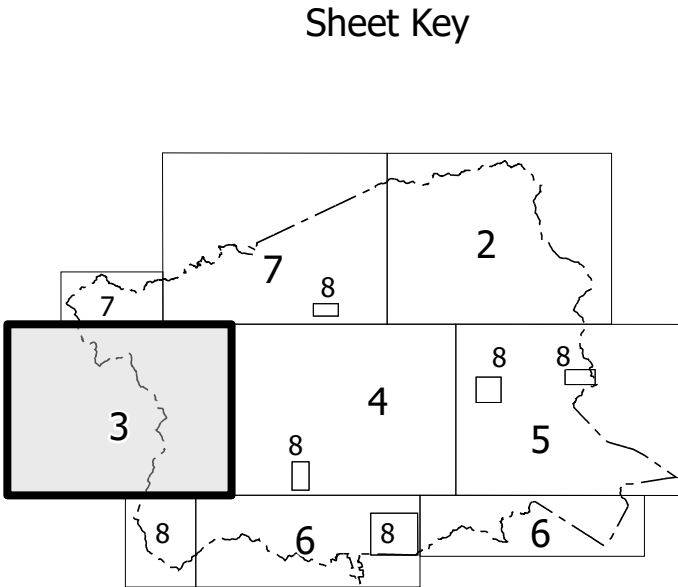

- LEGEND
- INTERSTATE: US (Red line), NC (Blue line), Divided Hwy (Blue line with white center), Undivided Hwy (Blue line)
 - BLUE RIDGE PARKWAY (Blue line with white center)
 - UNPAVED SURFACED ROAD (Dashed line)
 - HARD SURFACED ROAD (Solid line)
 - NON-SURFACED ROAD (Dashed line)
 - PROVISIONALLY DRAWN ROAD (Dashed line)
 - PROJECTED C/D OPEN (Dashed line)
 - INTERSECTION DISTANCE (Numbered line)
 - STANDARD ROAD BRIDGE (Line with cross-ticks)
 - RAILROAD BRIDGE (Line with cross-ticks)
 - DRAW SPAN ON BRIDGE (Line with cross-ticks)
 - PEDESTRIAN BRIDGE (Line with cross-ticks)
 - PEDESTRIAN WALKWAY (Line with cross-ticks)
 - PEDESTRIAN UNDERPASS (Line with cross-ticks)
 - VEHICULAR UNDERPASS (Line with cross-ticks)
 - TUNNEL (Line with cross-ticks)
 - CULVERT (Line with cross-ticks)
 - TYPE (Line with cross-ticks)
 - INTERSTATE HIGHWAY (Red line with shield)
 - U.S. NUMBERED HIGHWAY (Blue line with shield)
 - N.C. NUMBERED HIGHWAY (Blue line with shield)
 - U.S. NUMBERED BICYCLE ROUTE (Blue line with shield)
 - N.C. NUMBERED BICYCLE ROUTE (Blue line with shield)
 - INTERSTATE INTERCHANGE NUMBER (Red line with shield)
 - SECONDARY ROAD NUMBER (Blue line with shield)
 - UTILITY LINES (Dashed line)
 - RAILROAD LINE (Line with cross-ticks)
 - RAILROAD STATION (Line with cross-ticks)
 - INSET AREA (Line with cross-ticks)
 - STATE LINE (Dashed line)
 - COUNTY LINE (Dashed line)
 - SMOOTHED URBAN BOUNDARIES (Dashed line)
 - CITY LIMITS (Dashed line)
 - FERRY ROUTE AND RAMP (Line with cross-ticks)
 - NARROW CREEK OR STREAM (Blue line)
 - WIDE RIVER OR CREEK (Blue line)
 - RESERVOIR, POND OR LAKE W/ ISLAND (Blue line)
 - DAM OR DAM WITH LOCK (Blue line)
 - WATERFALL (Blue line)
 - SWAMP (Blue line)
 - COMMUNITY (Blue line)
 - COUNTY SEAT (Blue line)
 - SCHOOL (Blue line)
 - COLLEGE OR UNIVERSITY (Blue line)
 - HOSPITAL (Blue line)
 - COAST GUARD STATION (Blue line)
 - CHURCH (Blue line)
 - CHURCH WITH CEMETERY (Blue line)
 - CEMETERY (Blue line)
 - PATROL STATION (Blue line)
 - CORRECTIONS OR PENAL INSTITUTION (Blue line)
 - QUARRY (Blue line)
 - MINE OR PIT (Blue line)
 - HIGHWAY GARAGE OR MAINT. YARD (Blue line)
 - HIGHWAY DIV. OR DIST. OFFICE (Blue line)
 - MILITARY POST (Blue line)
 - NIGHT STATION (Blue line)
 - FAIRGROUNDS (Blue line)
 - HISTORICAL SITE (Blue line)
 - POINTS OF INTEREST (Blue line)
 - POST OFFICE (Blue line)
 - STATE FOREST (Blue line)
 - LIGHTHOUSE (Blue line)
 - MOUNTAIN SUMMIT (Blue line)
 - MOUNTAIN GAP (Blue line)
 - OVERLOOK (Blue line)
 - REST AREA (Blue line)
 - VISITOR CENTER AREA (Blue line)
 - WELCOME CENTER AREA (Blue line)
 - AIRPORT (Blue line)
 - MILITARY AIRPORT (Blue line)
 - NATIONAL / STATE FOREST BOUNDARY (Green line)
 - WILDLIFE REFUGE (Green line)
 - NATIONAL / STATE PARK BOUNDARY (Green line)
 - GAME LANDS BOUNDARY (Green line)
 - MILITARY RESERVATION BOUNDARY (Green line)
 - INDIAN RESERVATION BOUNDARY (Green line)



BUNCOMBE COUNTY NORTH CAROLINA

PREPARED BY THE
NORTH CAROLINA DEPARTMENT OF TRANSPORTATION
OPERATIONS PROGRAM MANAGEMENT UNIT - MAPPING SECTION
IN COOPERATION WITH THE
U.S. DEPARTMENT OF TRANSPORTATION
FEDERAL HIGHWAY ADMINISTRATION

SCALE

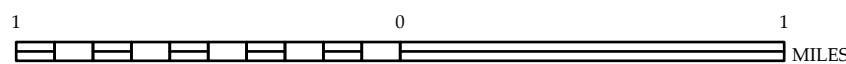

NORTH CAROLINA PLANE COORDINATE SYSTEM
LAMBERT CONFORMAL CONIC PROJECTION

TERMS OF USE: The Mapping Section's goal is to provide the most accurate and current information possible. Map data is compiled from numerous sources with varying dates of publication and may contain errors. As a result, the accuracy, currency and completeness of this map cannot be guaranteed to be a legal document. This information is provided as a service and is not intended to be a legal document. For additional information on this map, please visit <https://www.ncdot.gov/transportation/mapping>.

COPIES OF THIS MAP ARE AVAILABLE TO THE PUBLIC AT NO CHARGE. CONTACT US TO ORDER: maps@ncdot.gov or call 1-800-368-3346.

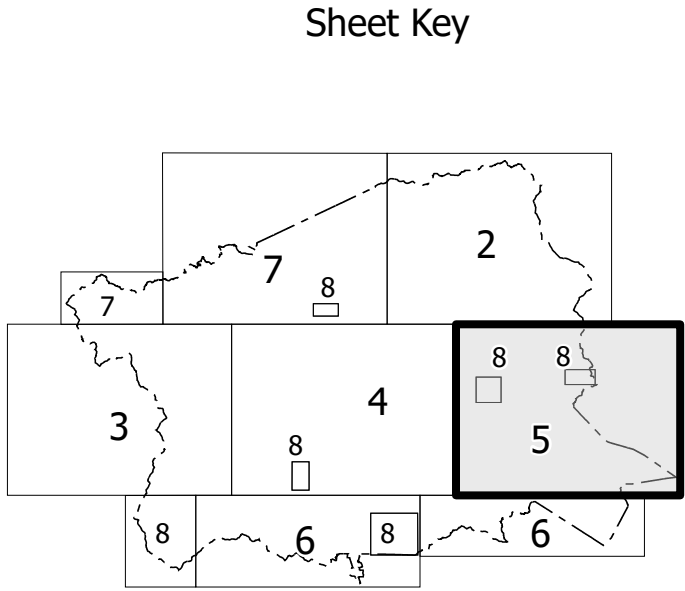
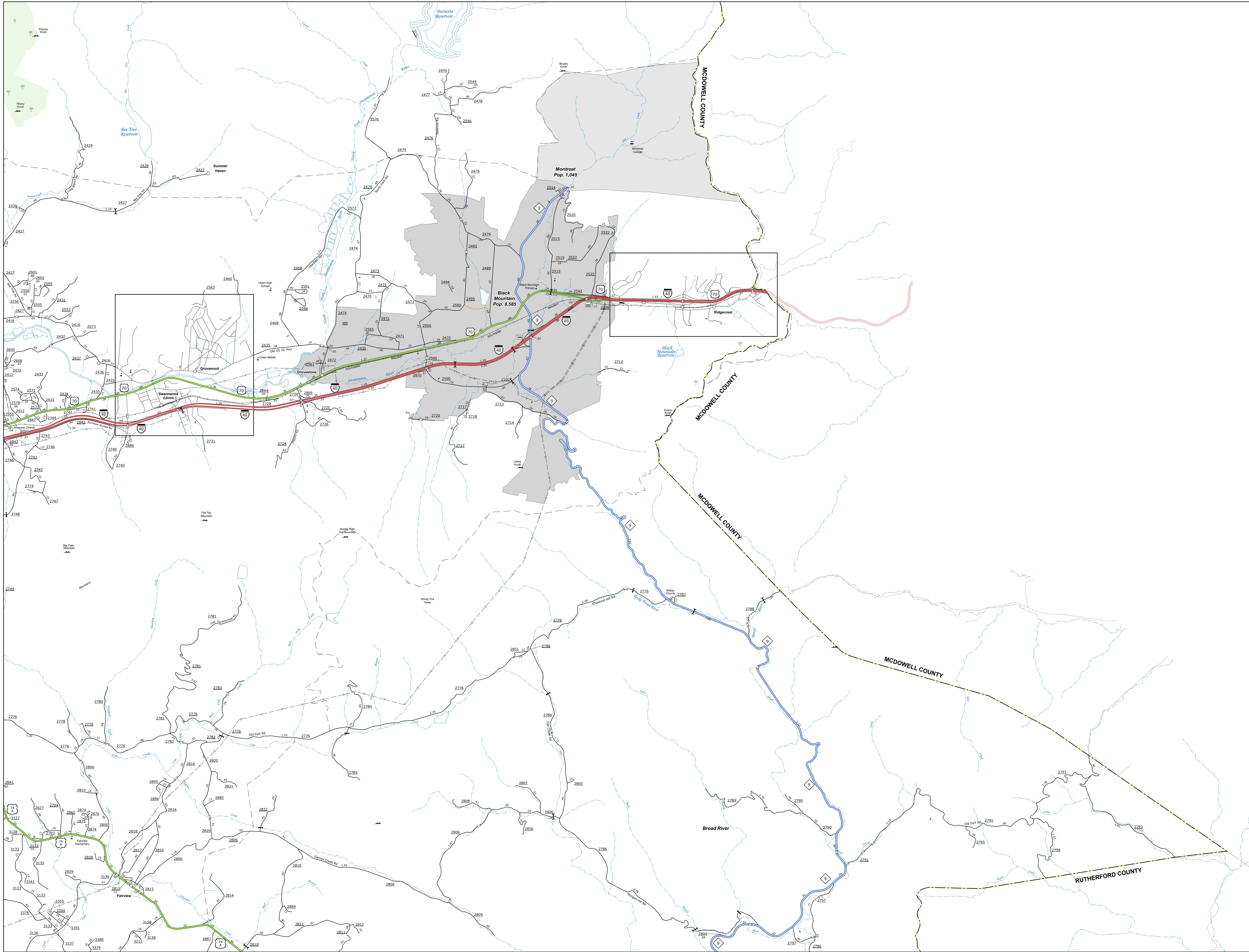

LEGEND

- INTERSTATE: US (Red line), NC (Blue line), Divided Hwy (Blue line with white center), Undivided Hwy (Blue line)
- BLUE RIDGE PARKWAY (Blue line with white center)
- UNPAVED SURFACED ROAD (Dashed line)
- HARD SURFACED ROAD (Solid line)
- NONSURFACED ROAD (Dashed line)
- PROVISIONALLY DRAWN ROAD (Dashed line with 'P' label)
- PROTECTED BICYCLE ROUTE (Blue line with white center)
- INTERSECTION DISTANCE (Numbered line)
- STANDARD ROAD BRIDGE (Line with bridge symbol)
- RAILROAD BRIDGE (Line with bridge symbol)
- DRAW SPAN ON BRIDGE (Line with bridge symbol)
- PEDESTRIAN BRIDGE (Line with bridge symbol)
- PEDESTRIAN WALKWAY (Line with bridge symbol)
- PEDESTRIAN UNDERPASS (Line with bridge symbol)
- VEHICLE/LAN UNDERPASS (Line with bridge symbol)
- TUNNEL (Line with bridge symbol)
- CULVERT (Line with bridge symbol)
- TYPE (Line with bridge symbol)
- INTERSTATE HIGHWAY (Red line with shield)
- U.S. NUMBERED HIGHWAY (Blue line with shield)
- N.C. NUMBERED HIGHWAY (Blue line with shield)
- U.S. NUMBERED BICYCLE ROUTE (Blue line with shield)
- N.C. NUMBERED BICYCLE ROUTE (Blue line with shield)
- INTERSTATE INTERCHANGE NUMBER (Red line with shield)
- SECONDARY ROAD NUMBER (Blue line with shield)
- UTILITY LINES (Dashed line)
- RAILROAD STATION (Line with bridge symbol)
- INSET AREA (Line with bridge symbol)
- STATE LINE (Dashed line)
- COUNTY LINE (Dashed line)
- SMOOTHED URBAN BOUNDARIES (Dashed line)
- CITY LIMITS (Dashed line)
- FERRY ROUTE AND RAMP (Line with bridge symbol)
- NARROW CREEK OR STREAM (Blue line)
- WIDE RIVER OR CREEK (Blue line)
- RESERVOIR, POND OR LAKE W/ ISLAND (Blue line)
- DAM OR DAM WITH LOCK (Blue line)
- WATERFALL (Blue line)
- SWAMP (Blue line)
- COMMUNITY (Blue line)
- COUNTY SEAT (Blue line)
- SCHOOL (Blue line)
- COLLEGE OR UNIVERSITY (Blue line)
- HOSPITAL (Blue line)
- COAST GUARD STATION (Blue line)
- CHURCH (Blue line)
- CHURCH WITH CEMETERY (Blue line)
- CEMETERY (Blue line)
- PATROL STATION (Blue line)
- CORRECTION OR PENAL INSTITUTION (Blue line)
- QUARRY (Blue line)
- MINE OR PIT (Blue line)
- HIGHWAY GARAGE OR MAINT. YARD (Blue line)
- HIGHWAY DIV. OR DIST. OFFICE (Blue line)
- MILITARY POST (Blue line)
- WATER STATION (Blue line)
- FAIRGROUNDS (Blue line)
- HISTORICAL SITE (Blue line)
- POINTS OF INTEREST (Blue line)
- POST OFFICE (Blue line)
- STATE FOREST (Blue line)
- LIGHTHOUSE (Blue line)
- MOUNTAIN SUMMIT (Blue line)
- MOUNTAIN GAP (Blue line)
- OVERLOOK (Blue line)
- REST AREA (Blue line)
- VISITOR CENTER AREA (Blue line)
- WELCOME CENTER AREA (Blue line)
- AIRPORT (Blue line)
- MILITARY AIRPORT (Blue line)
- NATIONAL - STATE FOREST BOUNDARY (Blue line)
- WILDLIFE REFUGE (Blue line)
- NATIONAL - STATE PARK BOUNDARY (Blue line)
- GAME LANDS BOUNDARY (Blue line)
- MILITARY RESERVATION BOUNDARY (Blue line)
- INDIAN RESERVATION BOUNDARY (Blue line)



BUNCOMBE COUNTY
NORTH CAROLINA

PREPARED BY THE
NORTH CAROLINA DEPARTMENT OF TRANSPORTATION
OPERATIONS PROGRAM MANAGEMENT UNIT - MAPPING SECTION
IN COOPERATION WITH THE
U.S. DEPARTMENT OF TRANSPORTATION
FEDERAL HIGHWAY ADMINISTRATION

SCALE

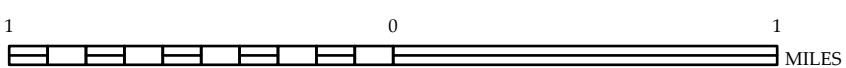

NORTH CAROLINA PLANE COORDINATE SYSTEM
LAMBERT CONFORMAL CONIC PROJECTION

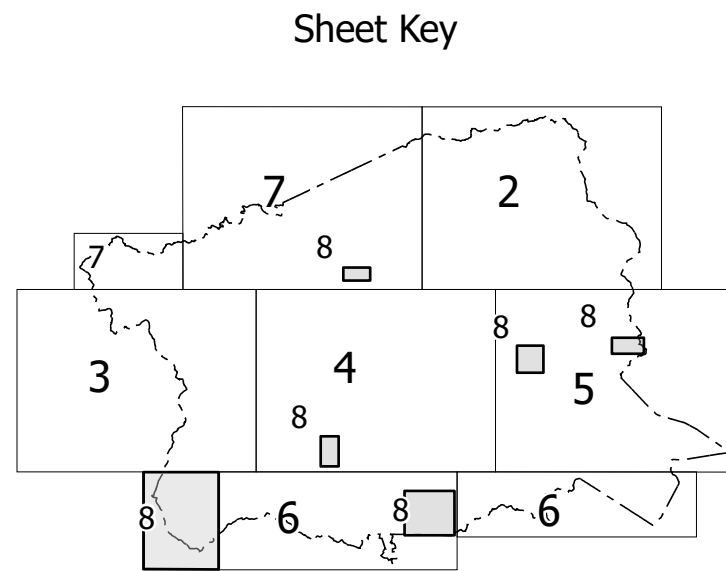
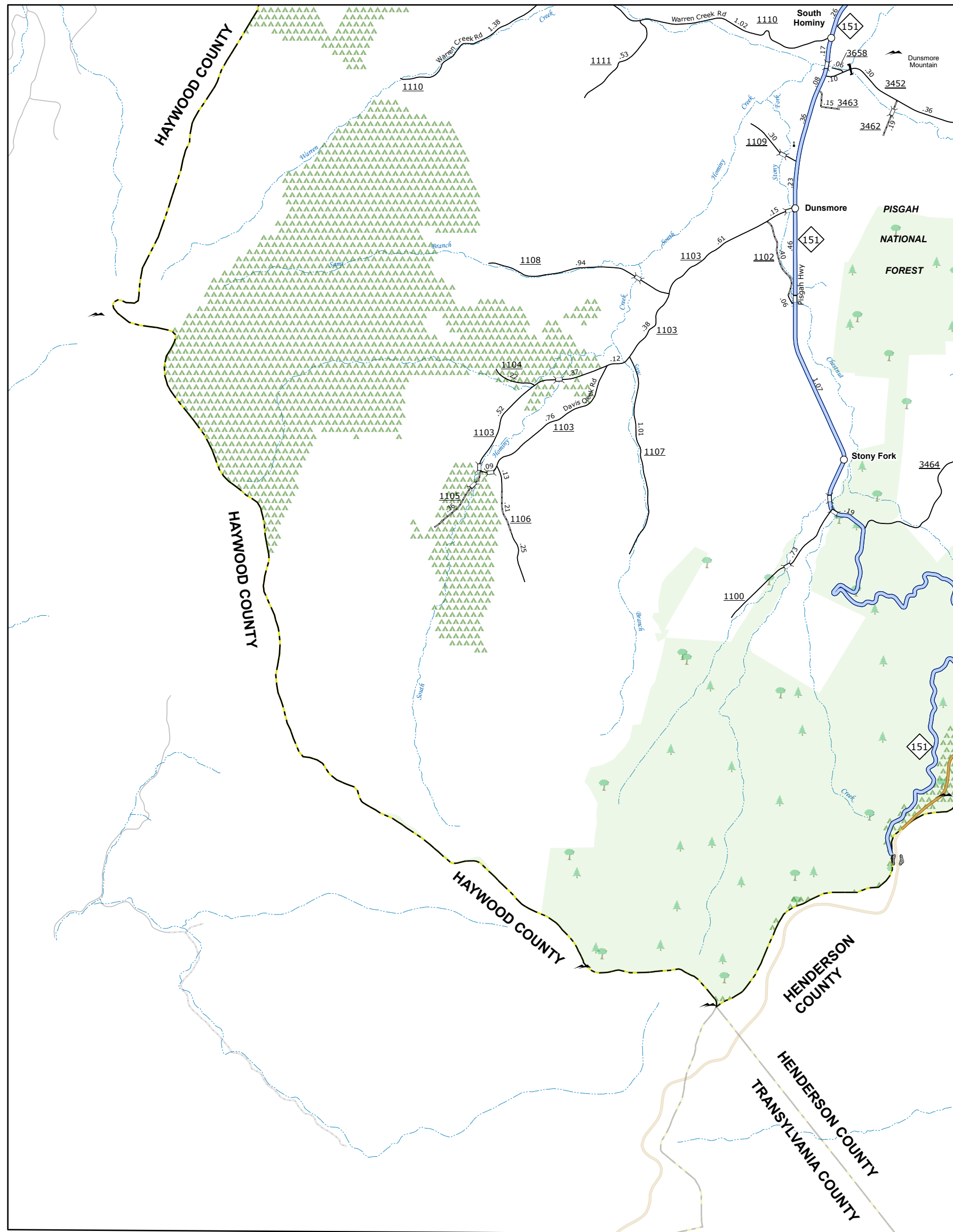
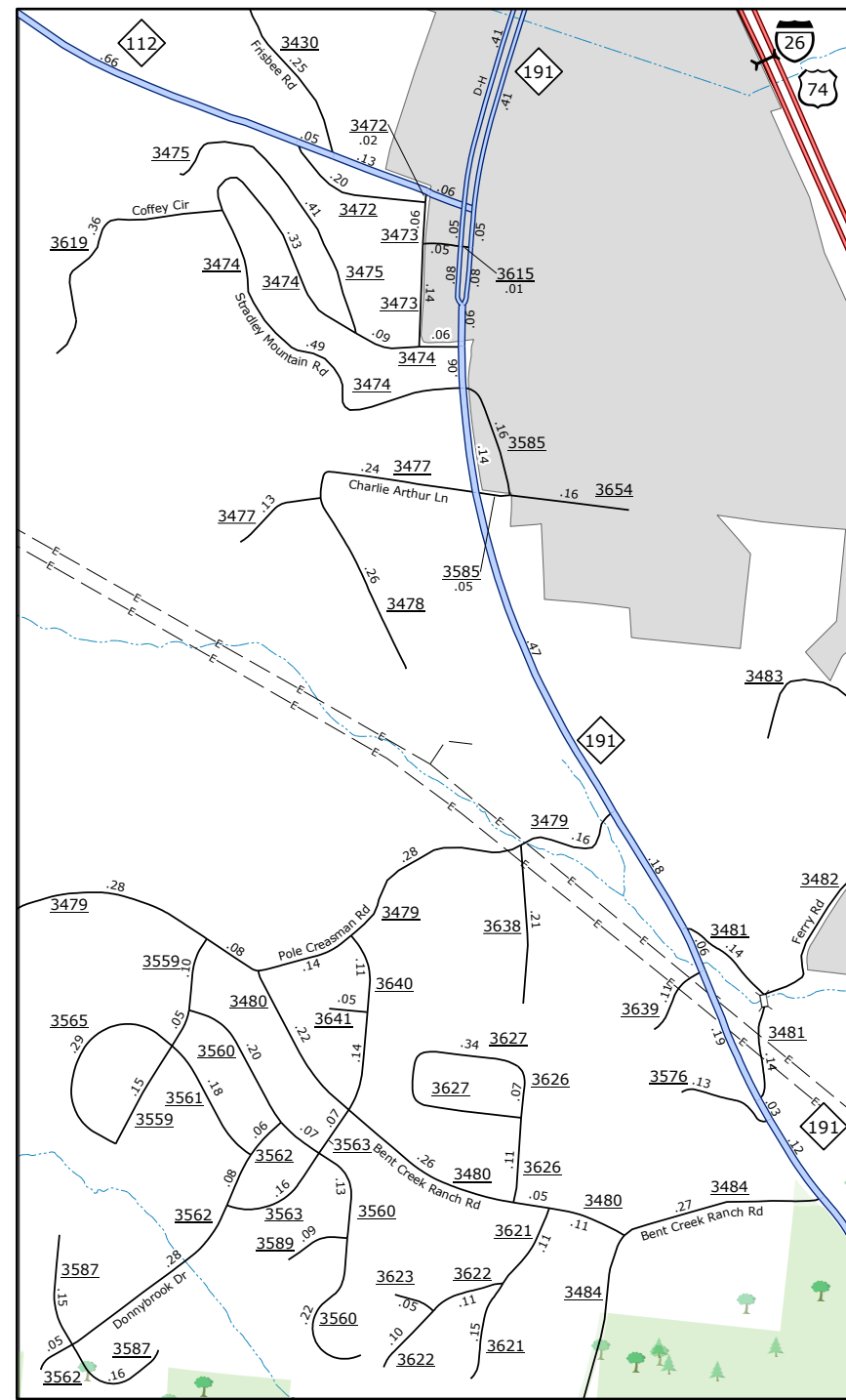
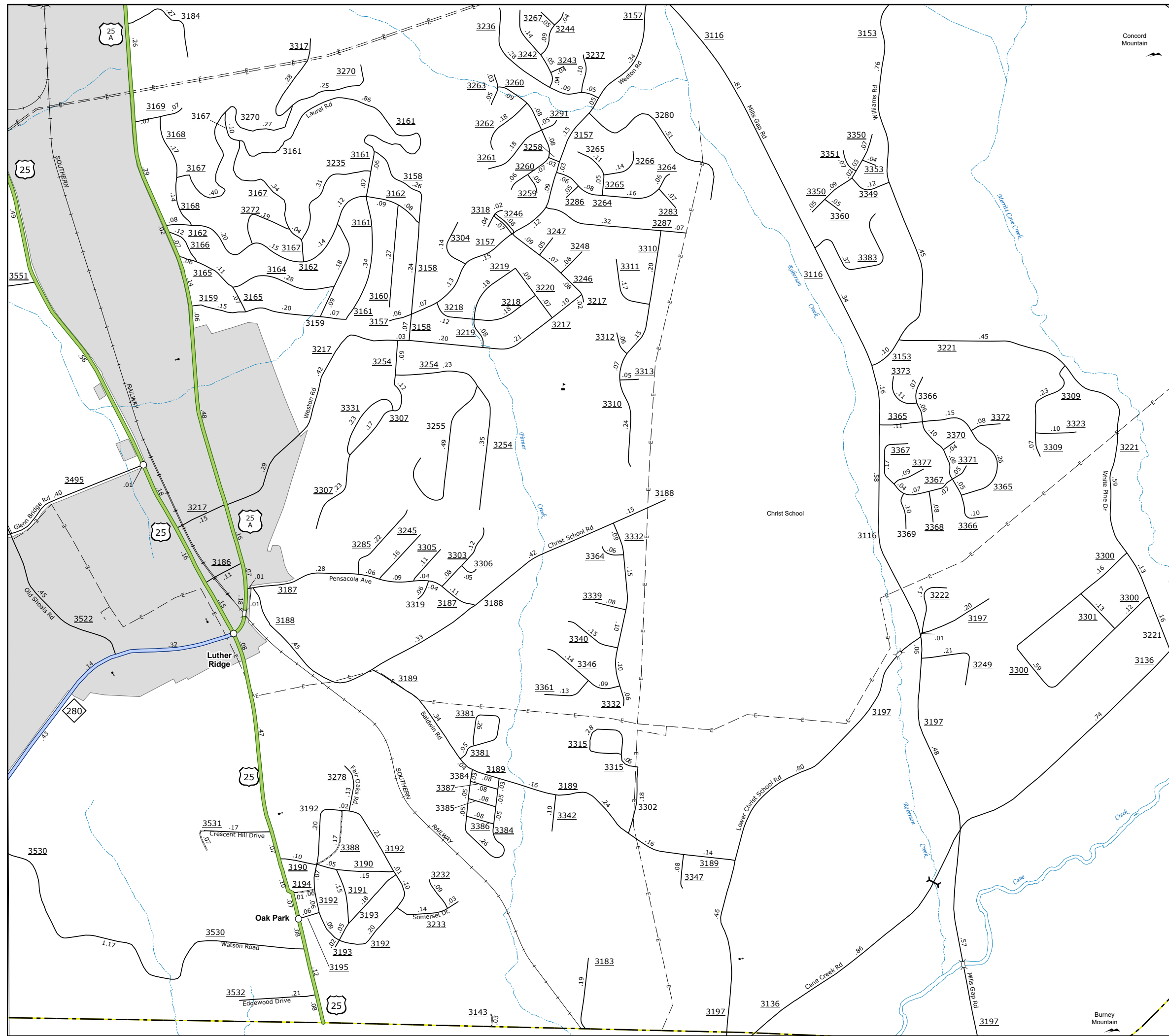

- LEGEND
- INTERSTATE US NC
 - Divided Freeway
 - Undivided Freeway
 - BLVD PARKWAY
 - UNPAVED SURFACE ROAD
 - HARD SURFACE ROAD
 - NON-SYSTEM ROAD
 - PROPOSEDLY BROWN ROAD
 - PROTECTED LOCATION
 - INTERSECTION DISTANCE
 - STANDARD ROAD BRIDGE
 - RAILROAD BRIDGE
 - IRON SIGN ON BRIDGE
 - PEDESTRIAN BRIDGE
 - PEDESTRIAN WALKWAY
 - VEHICLE UNDERPASS
 - TUNNEL
 - CANYON
 - PIPE
 - INTERSTATE HIGHWAY
 - U.S. NUMBERED HIGHWAY
 - N.C. NUMBERED HIGHWAY
 - U.S. NUMBERED BI-CYCLE ROUTE
 - N.C. NUMBERED BI-CYCLE ROUTE
 - INTERSTATE INTERCHANGE NUMBER
 - SECONDARY ROAD NUMBER
 - UTILITY LINES
 - RAILROAD LINE
 - RAILROAD STATION
 - INSIDE AREA
 - STATE LINE
 - COUNTY LINE
 - SMOOTH URBAN BOUNDARIES
 - CITY LIMITS
 - FERRY ROUTE AND KAMP
 - NARROW CREEK OR STREAM
 - WIDE RIVER OR CREEK
 - RESERVOIR, POND OR LAKE W/ ISLAND
 - DAM OR DAM WITH LOCK
 - WATERFALL
 - SWAMP
 - COMMUNITY
 - COUNTY SEAT
 - SCHOOL
 - COLLEGE OR UNIVERSITY
 - HOSPITAL
 - COAST GUARD STATION
 - CHURCH
 - CHURCH WITH CEMETERY
 - CEMETERY
 - PATROL STATION
 - CORRECTION OR PENAL INSTITUTION
 - QUARRY
 - MINE OR PIT
 - HIGHWAY GARAGE OR MAIN YARD
 - HIGHWAY DIV. OR DIST. OFFICE
 - MILITARY POST
 - WEIR STATION
 - FARMS
 - HISTORICAL SITE
 - POINTS OF INTEREST
 - POST OFFICE
 - STATE FOREST
 - LIGHTHOUSE
 - MOUNTAIN SUMMIT
 - MOUNTAIN GAP
 - OVERLOOK
 - REST AREA
 - VISITOR CENTER AREA
 - WELCOME CENTER AREA
 - AIRPORT
 - MILITARY AIRPORT
 - NATIONAL / STATE FOREST BOUNDARY
 - WILDLIFE REFUGE
 - NATIONAL / STATE PARK BOUNDARY
 - GAME LANDS BOUNDARY
 - MILITARY RESERVATION BOUNDARY
 - INDIAN RESERVATION BOUNDARY

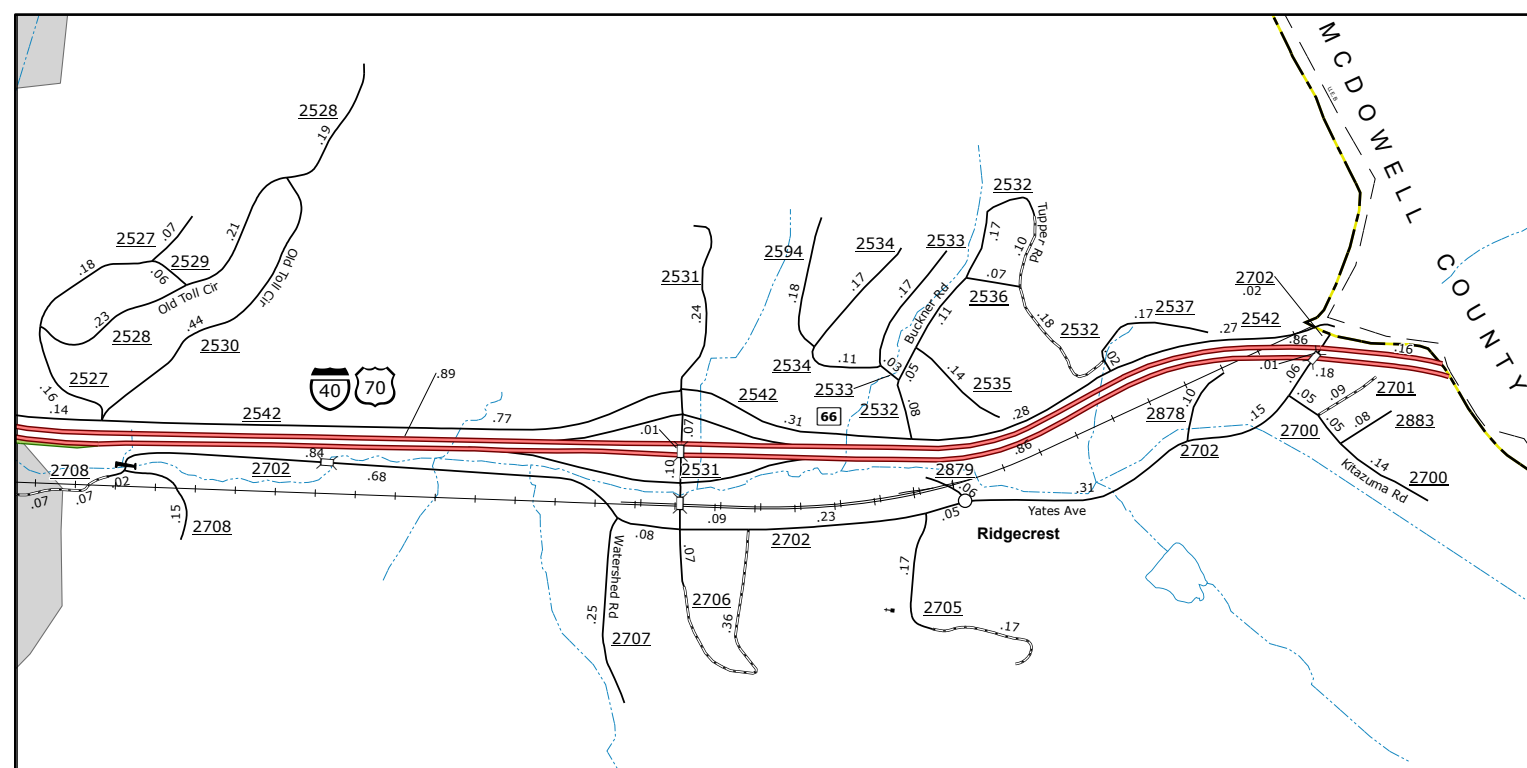
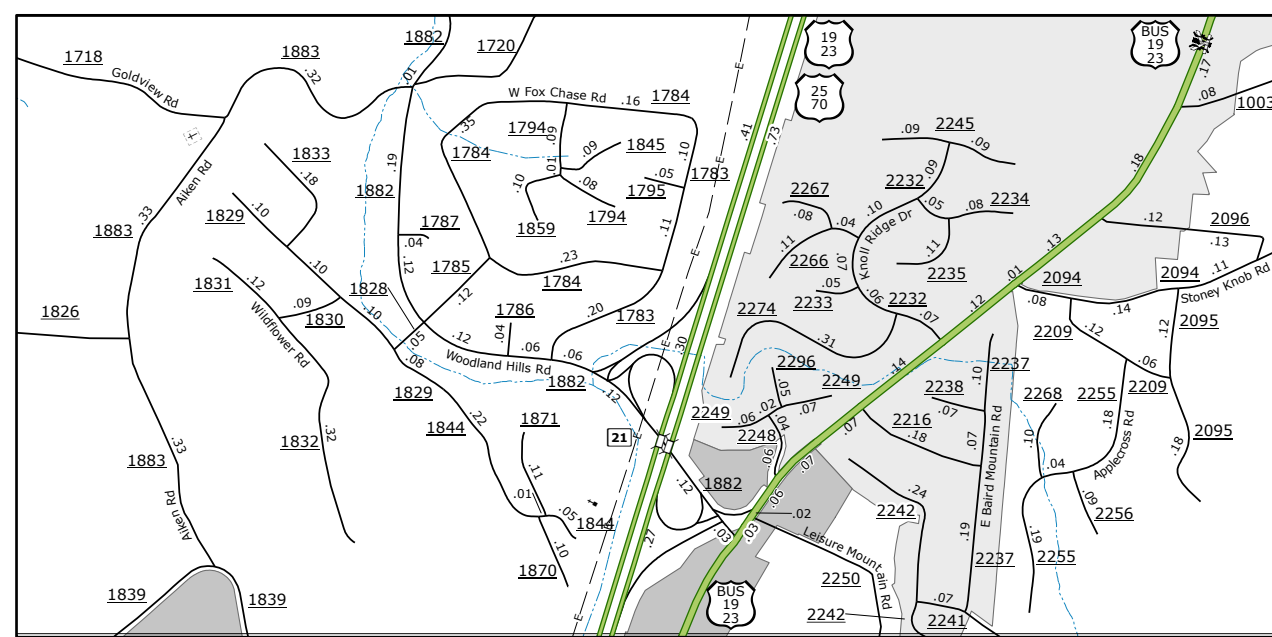
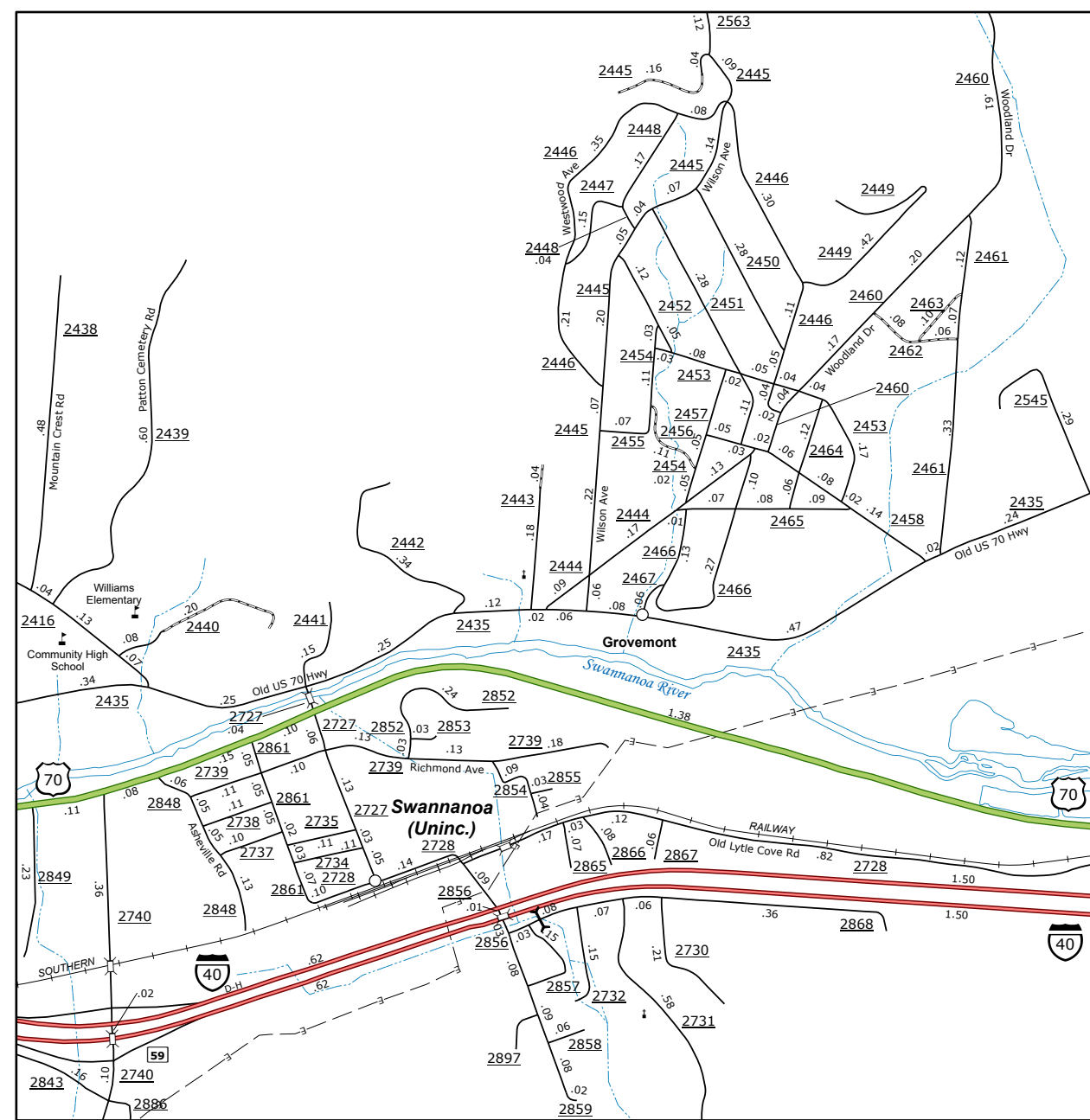

BUNCOMBE COUNTY NORTH CAROLINA

PREPARED BY THE
NORTH CAROLINA DEPARTMENT OF TRANSPORTATION
OPERATIONS PROGRAM MANAGEMENT UNIT - MAPPING SECTION
IN COOPERATION WITH THE
U.S. DEPARTMENT OF TRANSPORTATION
FEDERAL HIGHWAY ADMINISTRATION

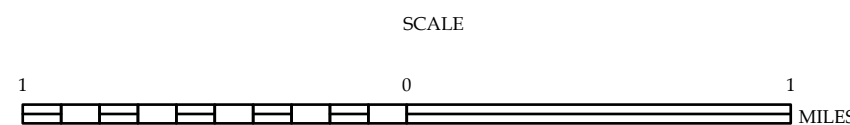

NORTH CAROLINA PLANE COORDINATE SYSTEM
LAMBERT CONFORMAL CONIC PROJECTION

COPIES OF THIS MAP ARE AVAILABLE TO THE
PUBLIC AT NOMINAL COST. CONTACT US TO ORDER:
mapsupport@ncdot.gov
https://www.ncdot.gov/resources/State-Mapping/Pages/Ordering-Maps.aspx
(919) 834-6480

TERMS OF USE: The Mapping Section's goal is to provide the most accurate and current information possible. Map data is compiled from
numerous sources with varying dates of publication and map accuracy standards. As a result, the accuracy, currency, and completeness of
the data provided will vary. The North Carolina Department of Transportation shall not be held liable for any errors in the map data. This
map cannot be construed to be a legal document. The information shown on this map was last updated in July 2025.
For digital copies of this map or additional map products, visit <https://www.ncdot.gov/resources/State-Mapping>.