

COPIES OF THIS MAP ARE AVAILABLE FROM THE PUBLIC AT NOMINAL COST. ADDRESS: N.C. DEPARTMENT OF TRANSPORTATION, MSAU-MAPPING SECTION, 4809 BERRY LANE, RALEIGH, NC 27606  
 The Mapping Section's goal is to provide the most accurate and current information possible. Map data is compiled from various sources including aerial photography, ground surveys, and other data. The accuracy of the information is not guaranteed. The information is provided for informational purposes only. For additional information, visit [www.ncdot.gov/MSAU-MAPPING](http://www.ncdot.gov/MSAU-MAPPING) and click on Data Provider or contact us by phone at (919) 833-8480.

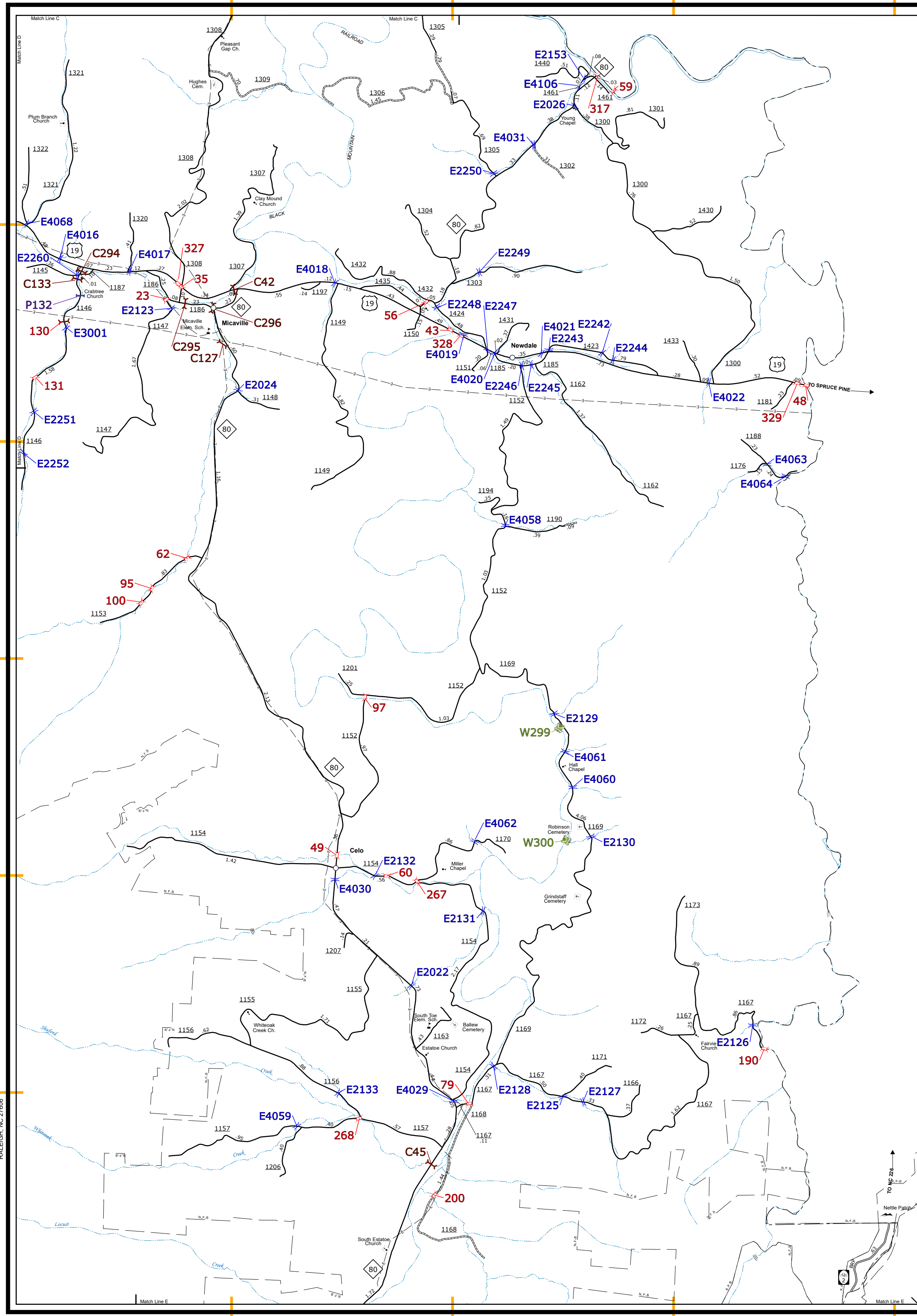

Celo, Newdale, Micaville and Vicinity

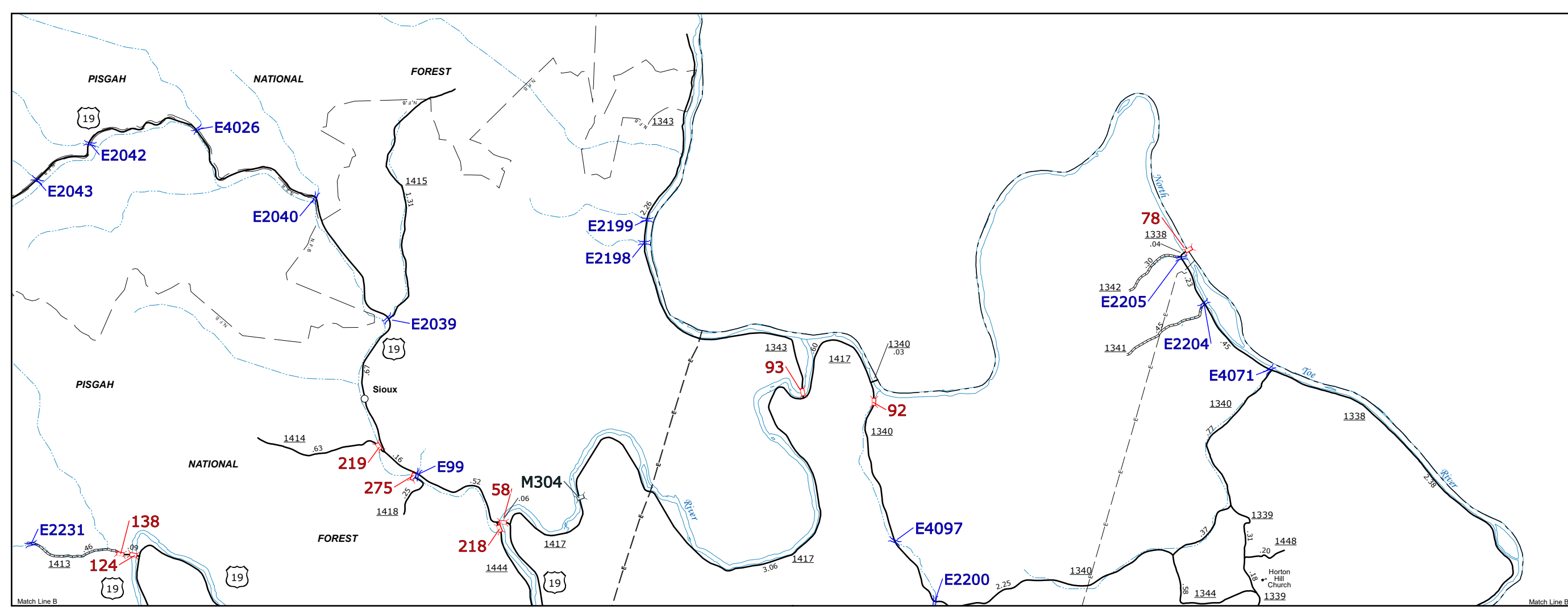

Sioux

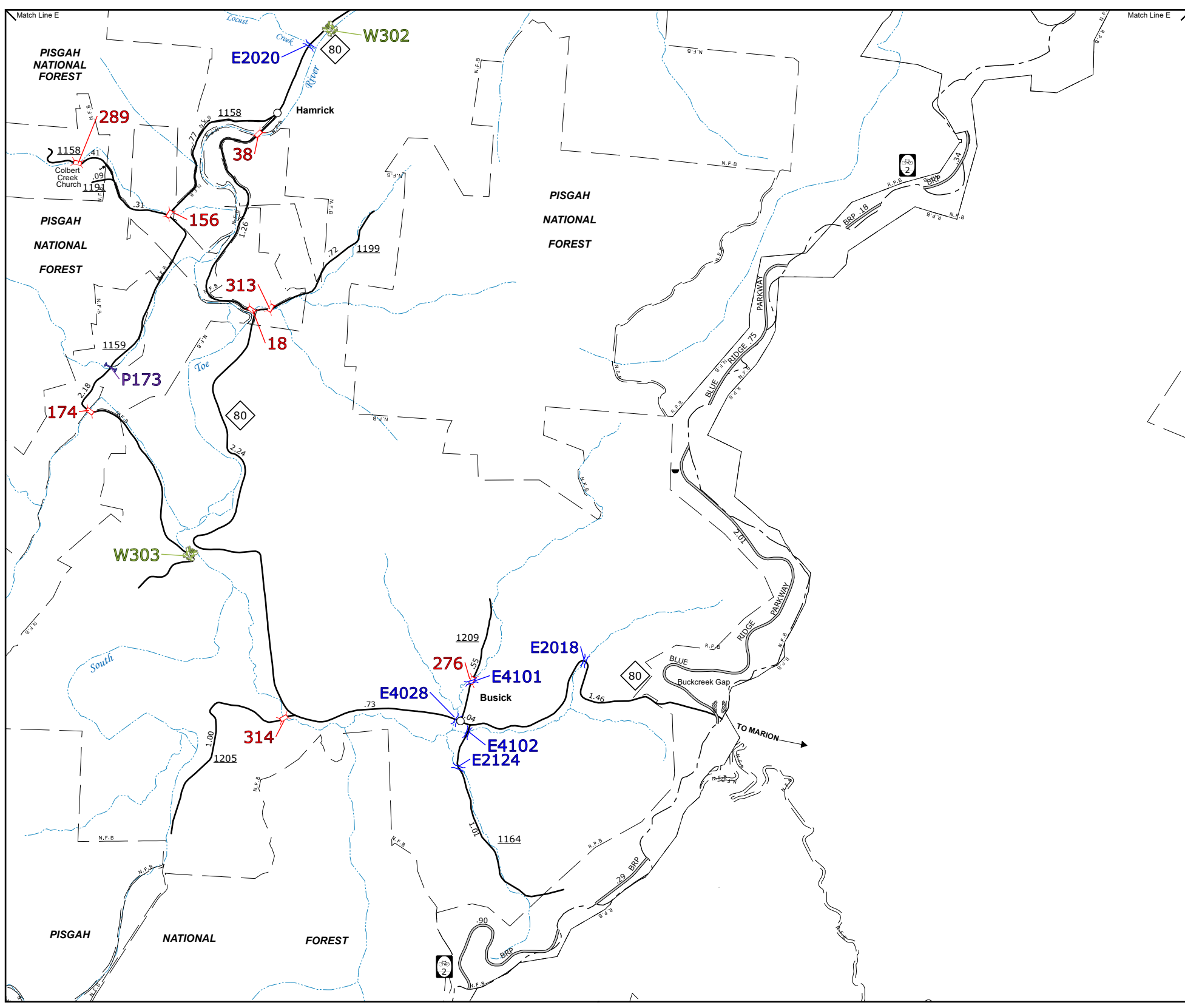

Hamrick & Busick

- BRIDGE
- CITY BRIDGE
- + CITY SIGN
- + CITY CULVERT
- + CITY CULVERT
- + CULVERT
- + DRAW BRIDGE
- + FERRIS WHEEL BRIDGE
- + NON-SIBS PIPE
- + FERRY RAMP
- + FEDERAL BRIDGE
- + NON-SYSTEM MAINT BY NCDOT
- + CASTLEVER SIGN
- + PRIVATE STRUCTURE
- + SLOTTED OVERPASS STRUCTURE
- + PAVEMENT ON PILLS
- + CITY PIPE
- + PIPE
- + RAILROAD BRIDGE
- + OVERHEAD SIGN
- + TUNNEL
- + PEDESTRIAN UNDERPASS
- + VEHICULAR UNDERPASS
- + PEDESTRIAN WALKWAY
- + POLE SIGN

ENLARGED MUNICIPAL AND SUBURBAN AREAS  
**YANCEY COUNTY**  
 NORTH CAROLINA  
**BRIDGE LOCATION MAP**  
 PREPARED BY THE  
 NORTH CAROLINA DEPARTMENT OF TRANSPORTATION  
 OPERATION PROGRAM MANAGEMENT UNIT - MAPPING SECTION  
 IN COOPERATION WITH THE  
 U.S. DEPARTMENT OF TRANSPORTATION  
 FEDERAL HIGHWAY ADMINISTRATION

SCALE

1 0 1 MILES

10,000 FOOT GRID BASED ON NORTH CAROLINA PLANE COORDINATE SYSTEM  
LAMBERT CONFORMAL CONIC PROJECTION

SHEET 2 OF 3