

COPIES OF THIS MAP ARE AVAILABLE
 AT THE SURRY COUNTY OFFICE OF PUBLIC WORKS
 ADDRESS: 1000 W. STATE STREET, SUITE 100
 ELKIN, NC 28641
 PHONE: 813-354-8480
 FAX: 813-354-8480
 WWW.SURRYCOUNTYNC.GOV

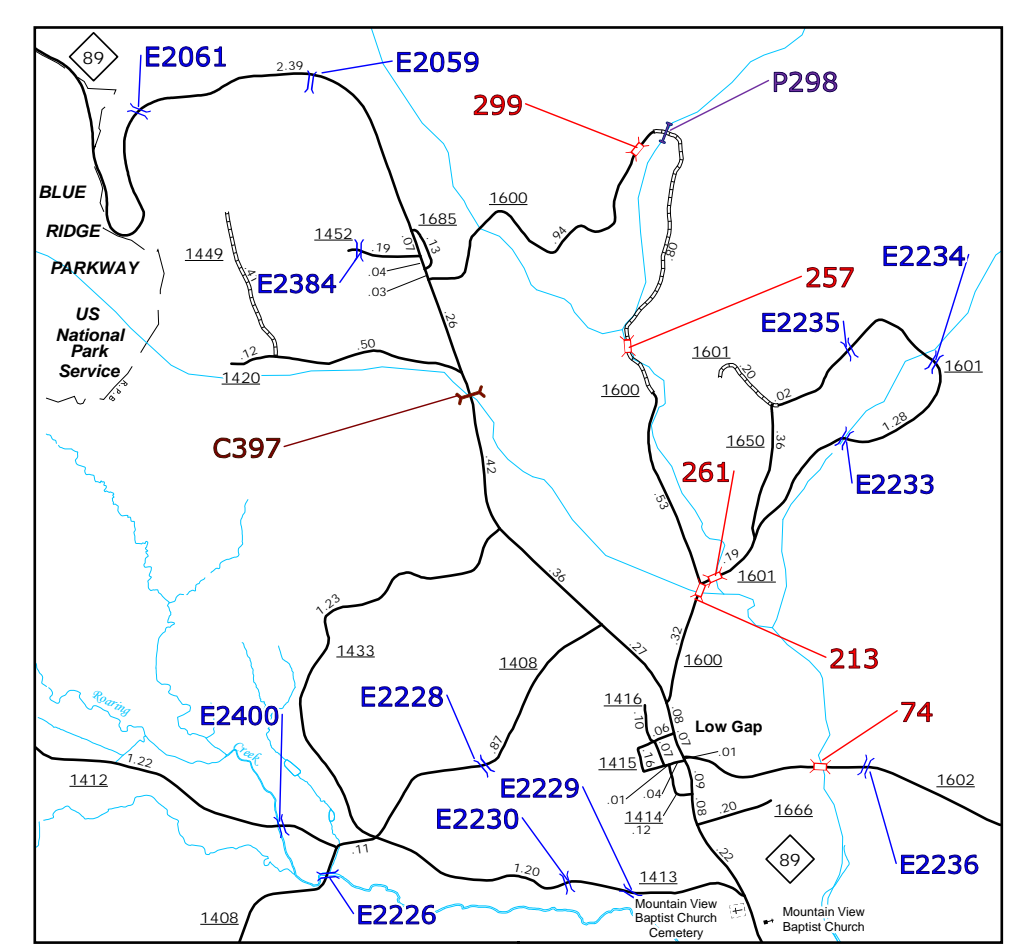
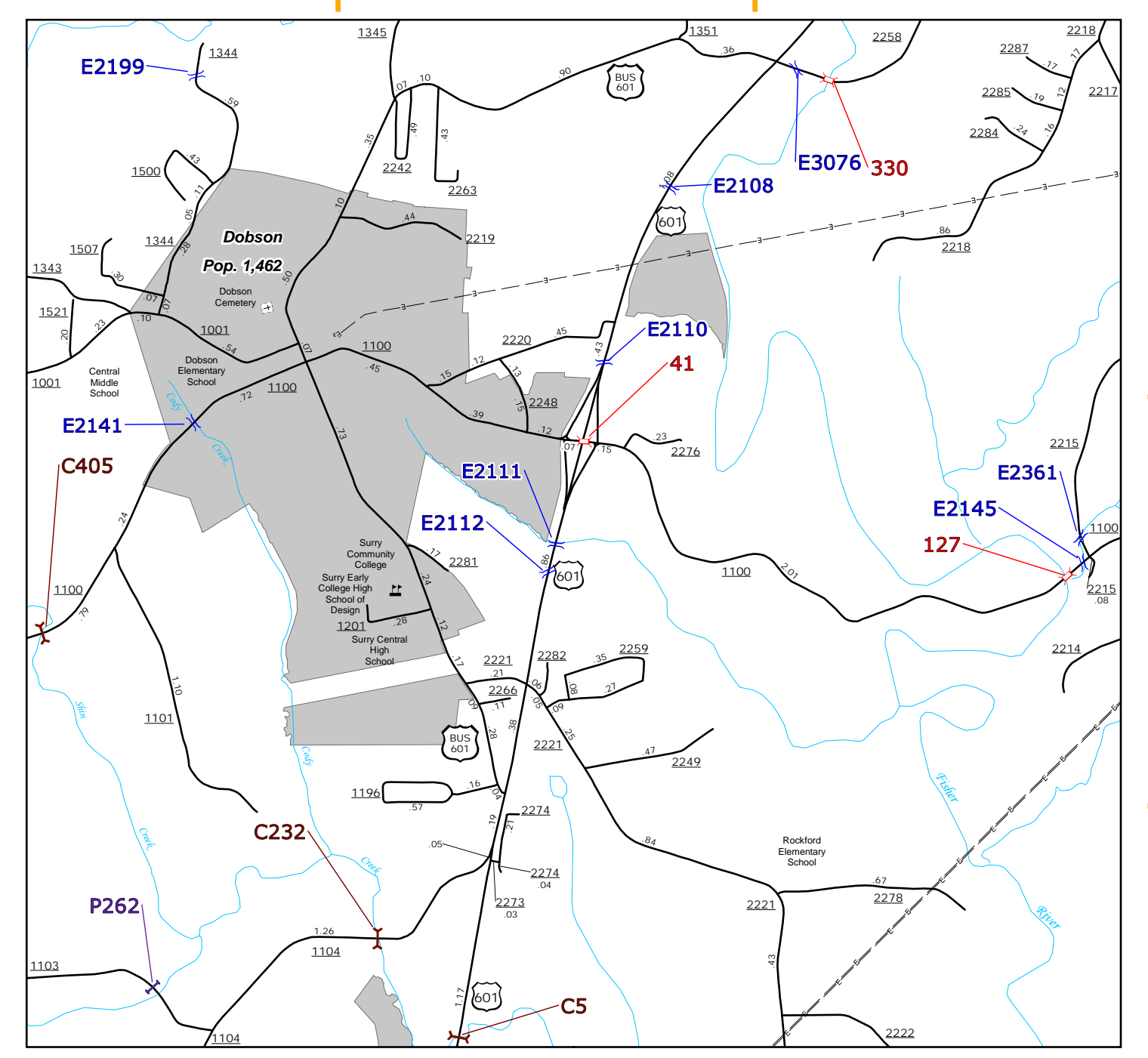
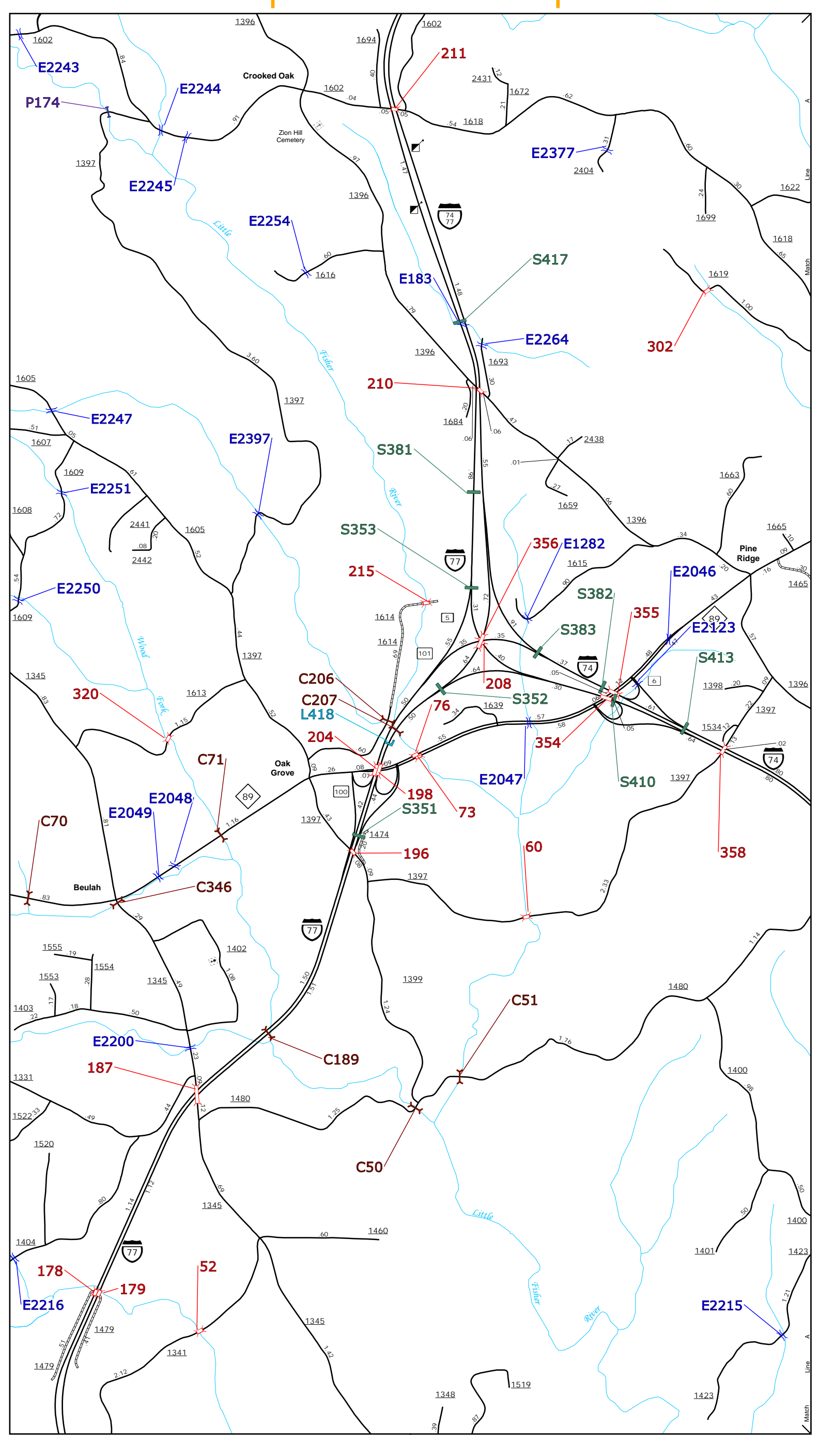
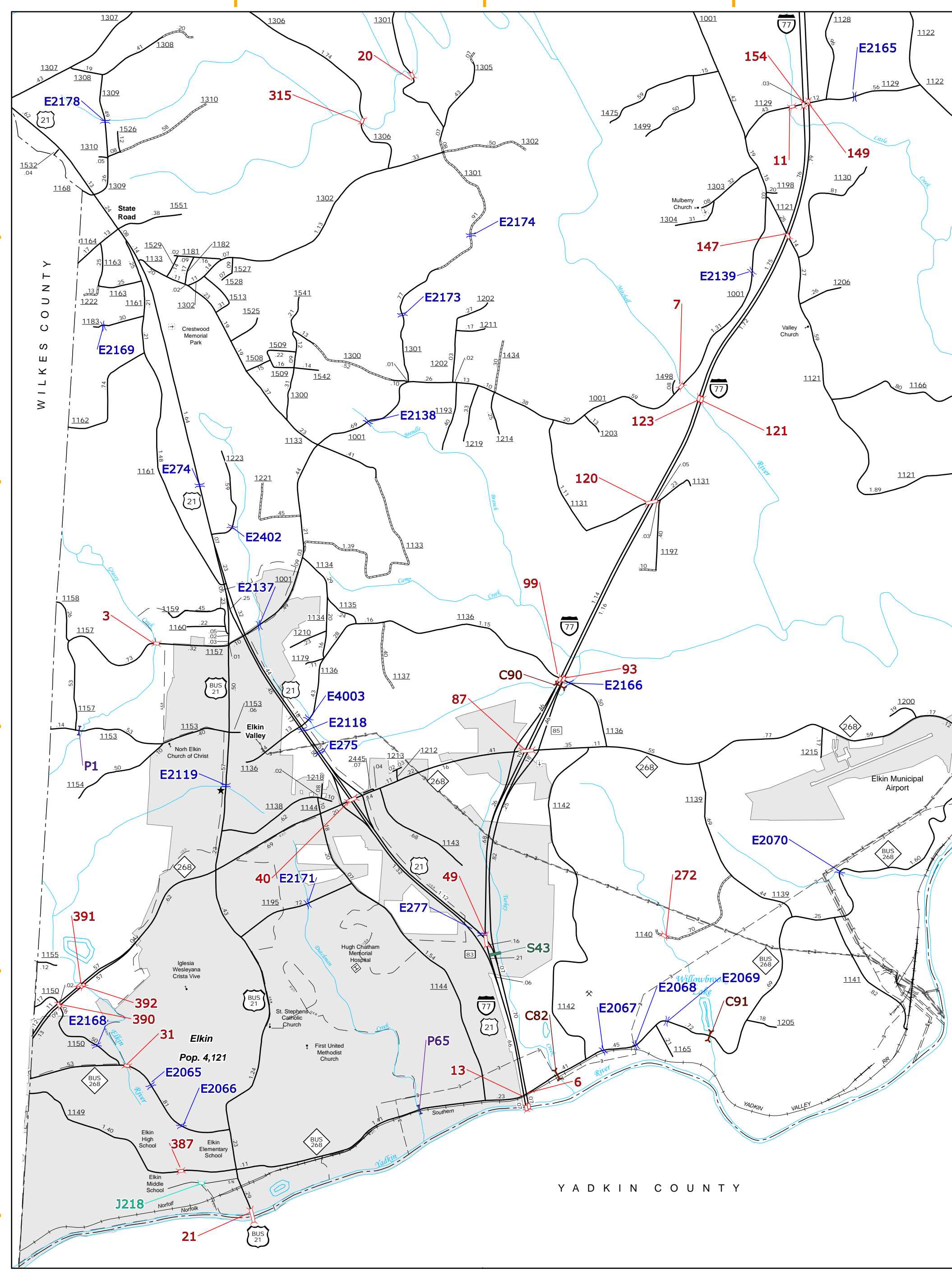

ENLARGED MUNICIPAL AND SUBURBAN AREAS
SURRY COUNTY
NORTH CAROLINA
BRIDGE LOCATION MAP

PREPARED BY THE
 NORTH CAROLINA DEPARTMENT OF TRANSPORTATION
 OPERATIONS PROGRAM MANAGEMENT UNIT - MAPPING SECTION
 IN COOPERATION WITH THE
 U.S. DEPARTMENT OF TRANSPORTATION
 FEDERAL HIGHWAY ADMINISTRATION

SCALE

1 0 1
MILES

10,000 FOOT GRID BASED ON NORTH CAROLINA PLANE COORDINATE SYSTEM
LAMBERT CONFORMAL CONIC PROJECTION

DIVISION 11 DISTRICT 1 SURRY COUNTY NORTH CAROLINA 171

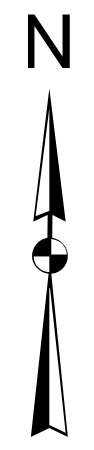

- BRIDGE
- CITY BRIDGE
- CITY SKION
- CITY CULVERT
- CULVERT
- DRAW BRIDGE
- PEDESTRIAN BRIDGE
- NON-NBIS PIPE
- FERRY RAMP
- FEDERAL BRIDGE
- NON-SYSTEM MAINT BY NCDOT
- CANTILEVER SKION
- PRIVATE STRUCTURE
- NCDOT OVERPASS STRUCTURE
- PAVEMENT ON FILES
- CITY PIPE
- PIPE
- RAILROAD BRIDGE
- OVERHEAD SKION
- TUNNEL
- PEDESTRIAN UNDERPASS
- VEHICLE UNDERPASS
- PEDESTRIAN WALKWAY
- T-POLE SKION