

The Mapping Section's goal is to provide the most accurate and current information possible. Map data is compiled from various sources including aerial photography, ground surveys, and other data. The accuracy of the information is not guaranteed. For more information, please visit our website at <http://www.ncdot.gov/transportation/mapping> or contact us by phone at (919) 855-8480.

COPIES OF THIS MAP ARE AVAILABLE AT THE PUBLIC INFORMATION CENTER, N.C. DEPARTMENT OF TRANSPORTATION, 4600 BERRY LANE, RALEIGH, NC 27635.

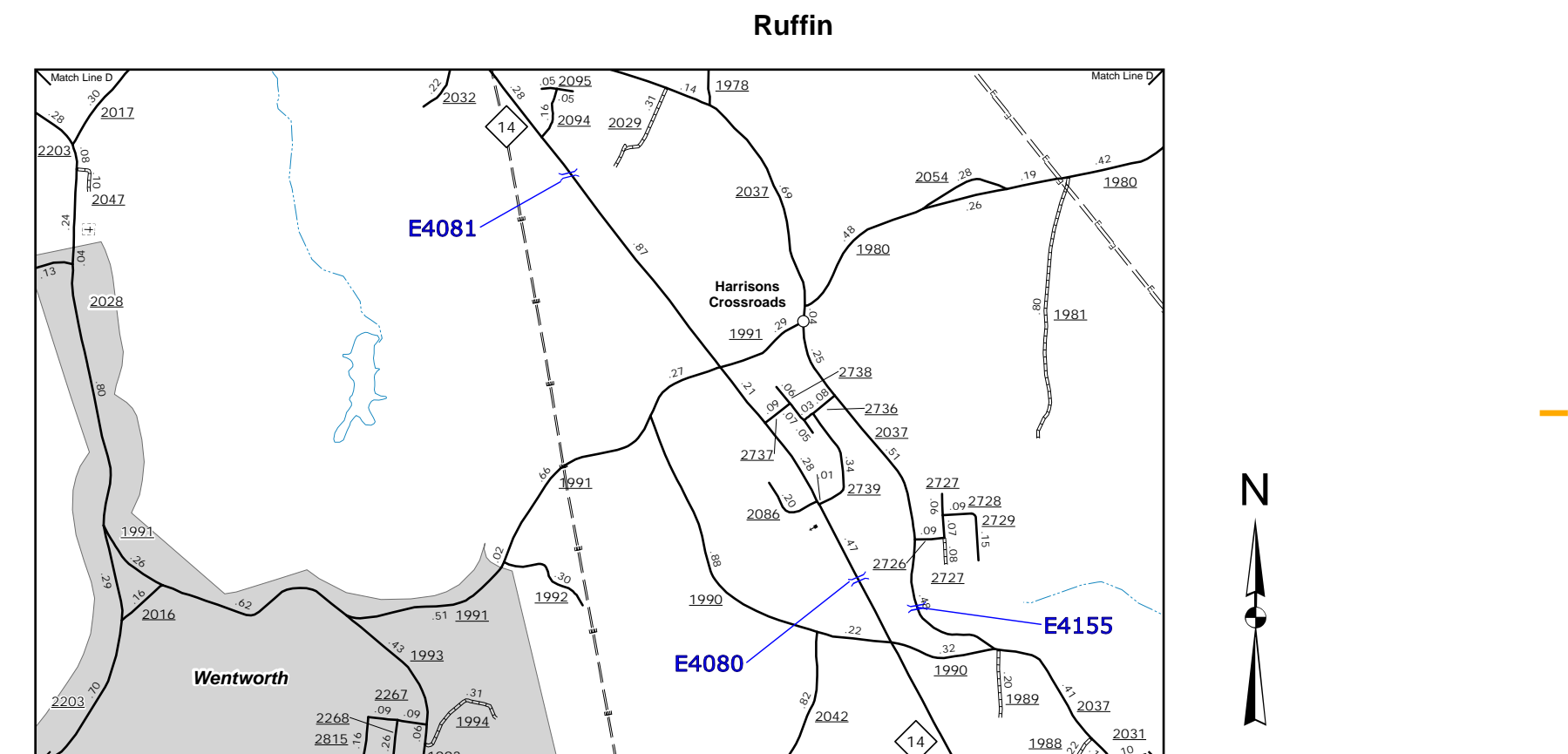
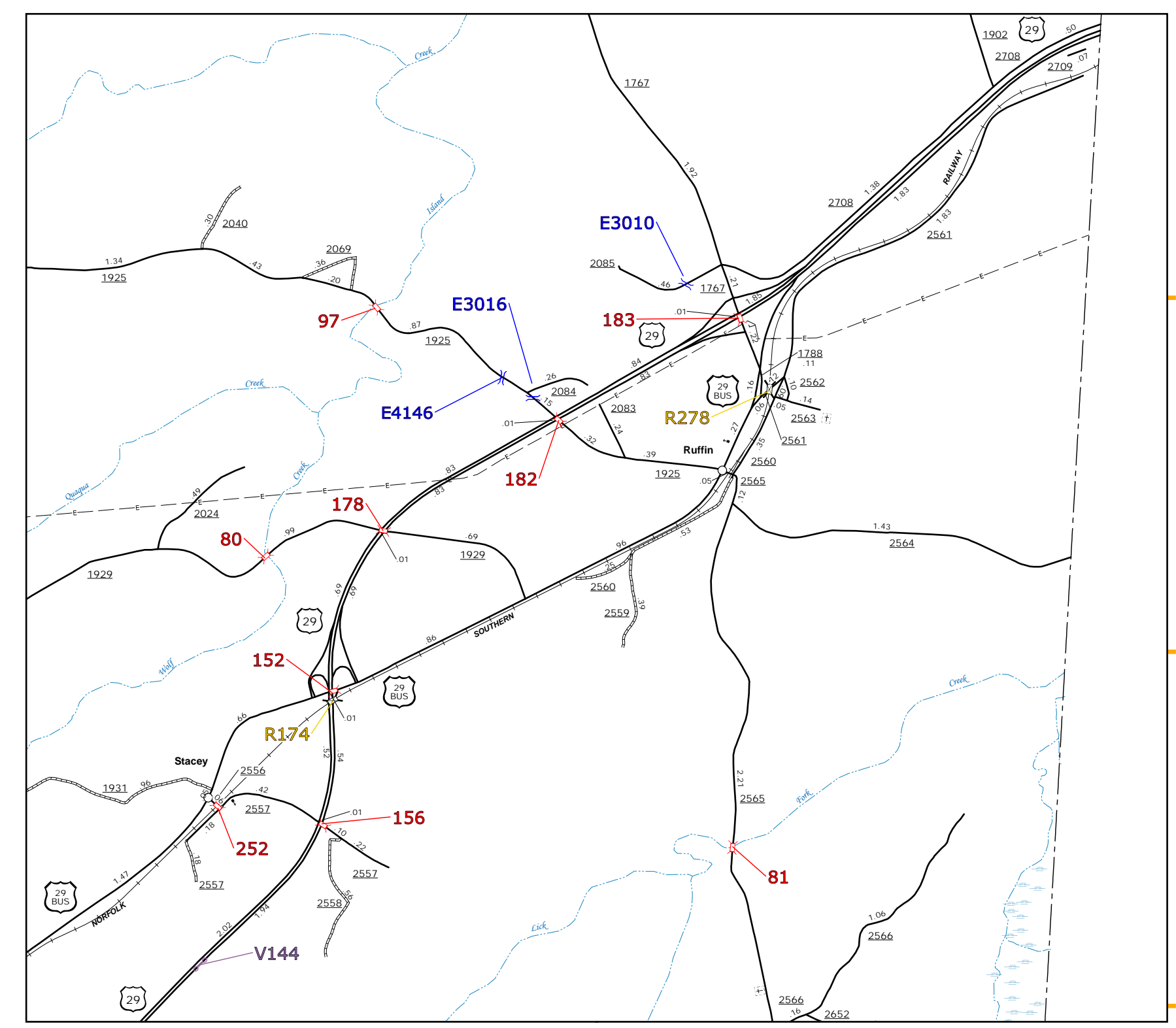

- Harrisons Crossroads**
- BRIDGE
  - CITY BRIDGE
  - CITY SKIN
  - CITY CULVERT
  - CULVERT
  - DRAW BRIDGE
  - PEDESTRIAN BRIDGE
  - NON-NBS PIPE
  - FERRY RAMP
  - FEDERAL BRIDGE
  - NON-SYSTEM MAINT BY NCDOT
  - CANTILEVER SKIN
  - PRIVATE STRUCTURE
  - SKIFF OVERPASS STRUCTURE
  - OVERPASS ON PILES
  - CITY PIPE
  - PIPE
  - RAILROAD BRIDGE
  - OVERHEAD SKIN
  - TUNNEL
  - PEDESTRIAN UNDERPASS
  - VEHICULAR UNDERPASS
  - PEDESTRIAN WALKWAY
  - POLE SIGN

**ENLARGED MUNICIPAL AND SUBURBAN AREAS**  
**ROCKINGHAM COUNTY**  
**NORTH CAROLINA**  
**BRIDGE LOCATION MAP**

PREPARED BY THE  
 NORTH CAROLINA DEPARTMENT OF TRANSPORTATION  
 OPERATIONS PROGRAM MANAGEMENT UNIT - MAPPING SECTION  
 IN COOPERATION WITH THE  
 U.S. DEPARTMENT OF TRANSPORTATION  
 FEDERAL HIGHWAY ADMINISTRATION

SCALE

1 0 1 MILES

10,000 FOOT GRID BASED ON NORTH CAROLINA PLANE COORDINATE SYSTEM  
LAMBERT CONFORMAL CONIC PROJECTION