

The Mapping Section's goal is to provide the most accurate and current information possible. Map data is compiled from various sources, including aerial photography, ground surveys, and other reliable data. The accuracy of the information is dependent on the quality of the data provided. The Mapping Section is not responsible for errors or omissions in this map. For more information, visit our website at www.ncdot.gov/transportation/mapping or contact us by phone at (919) 855-8480.

COPIES OF THIS MAP ARE AVAILABLE TO THE PUBLIC AT NOMINAL COST. ADDRESS: N.C. DEPARTMENT OF TRANSPORTATION, 4609 BERTHOUD ROAD, RALEIGH, NC 27635

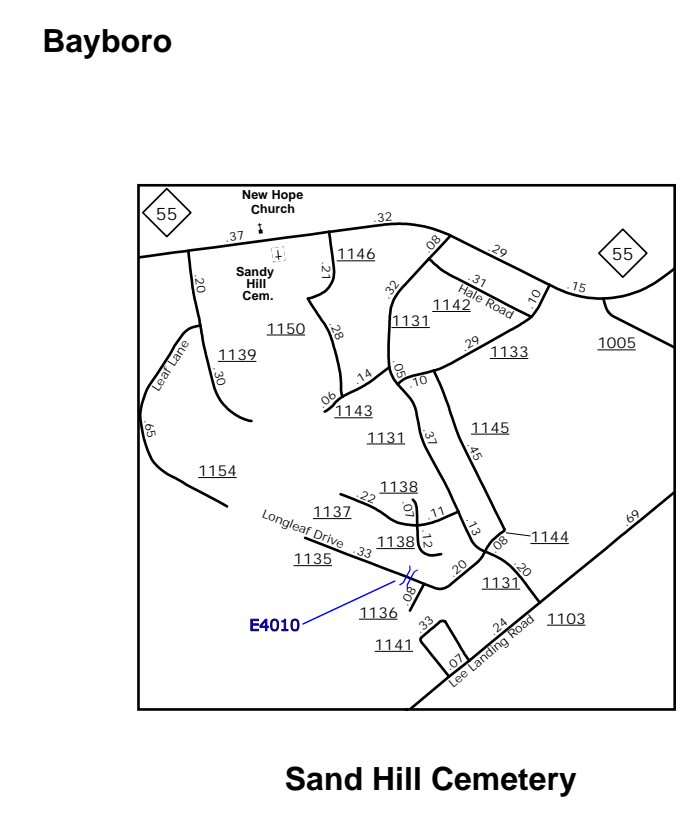
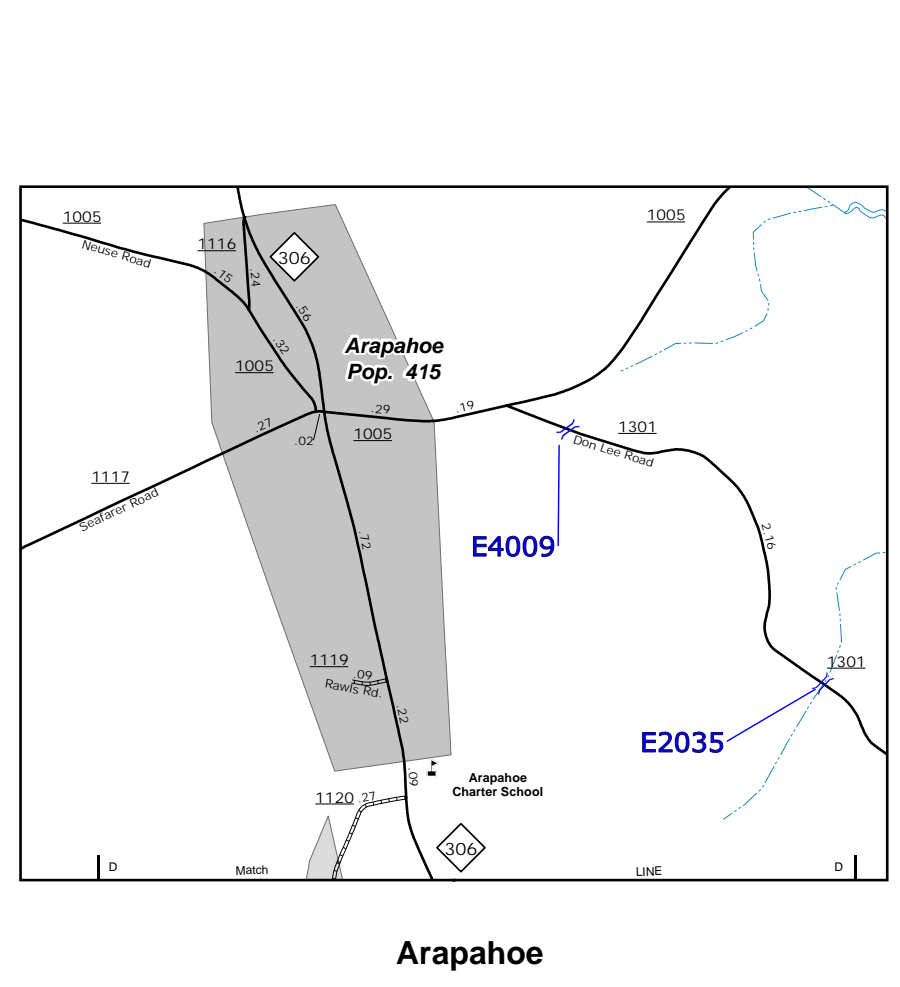
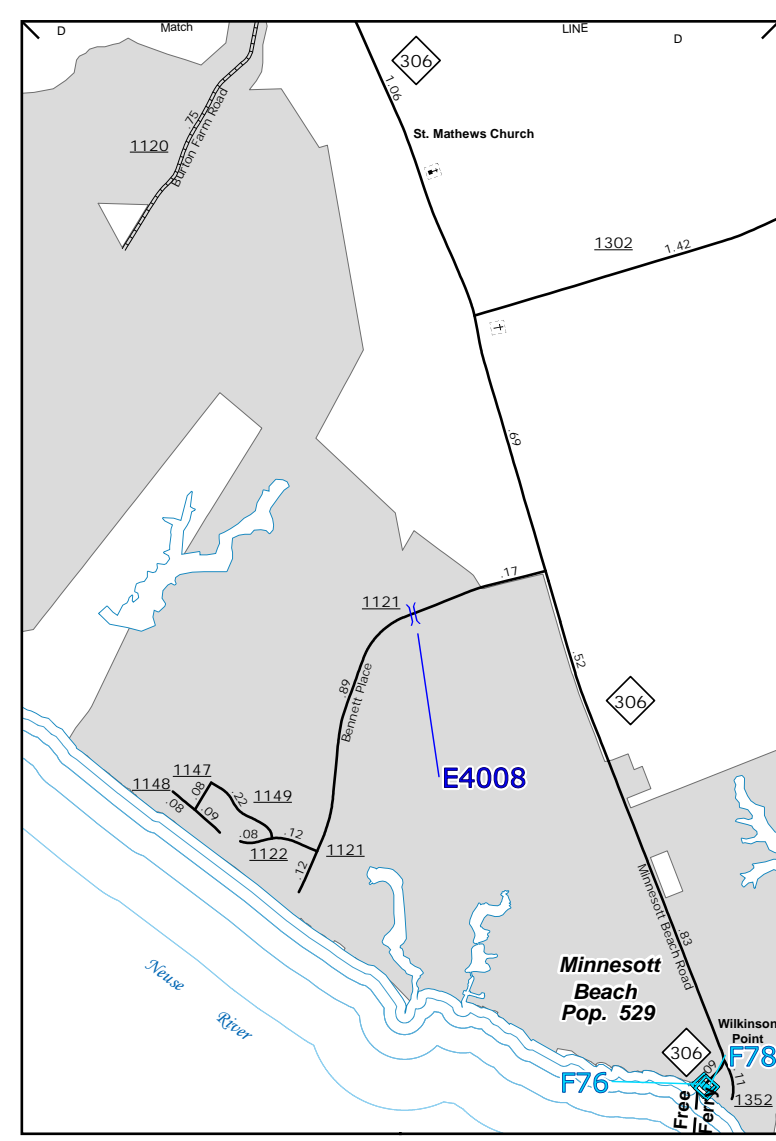
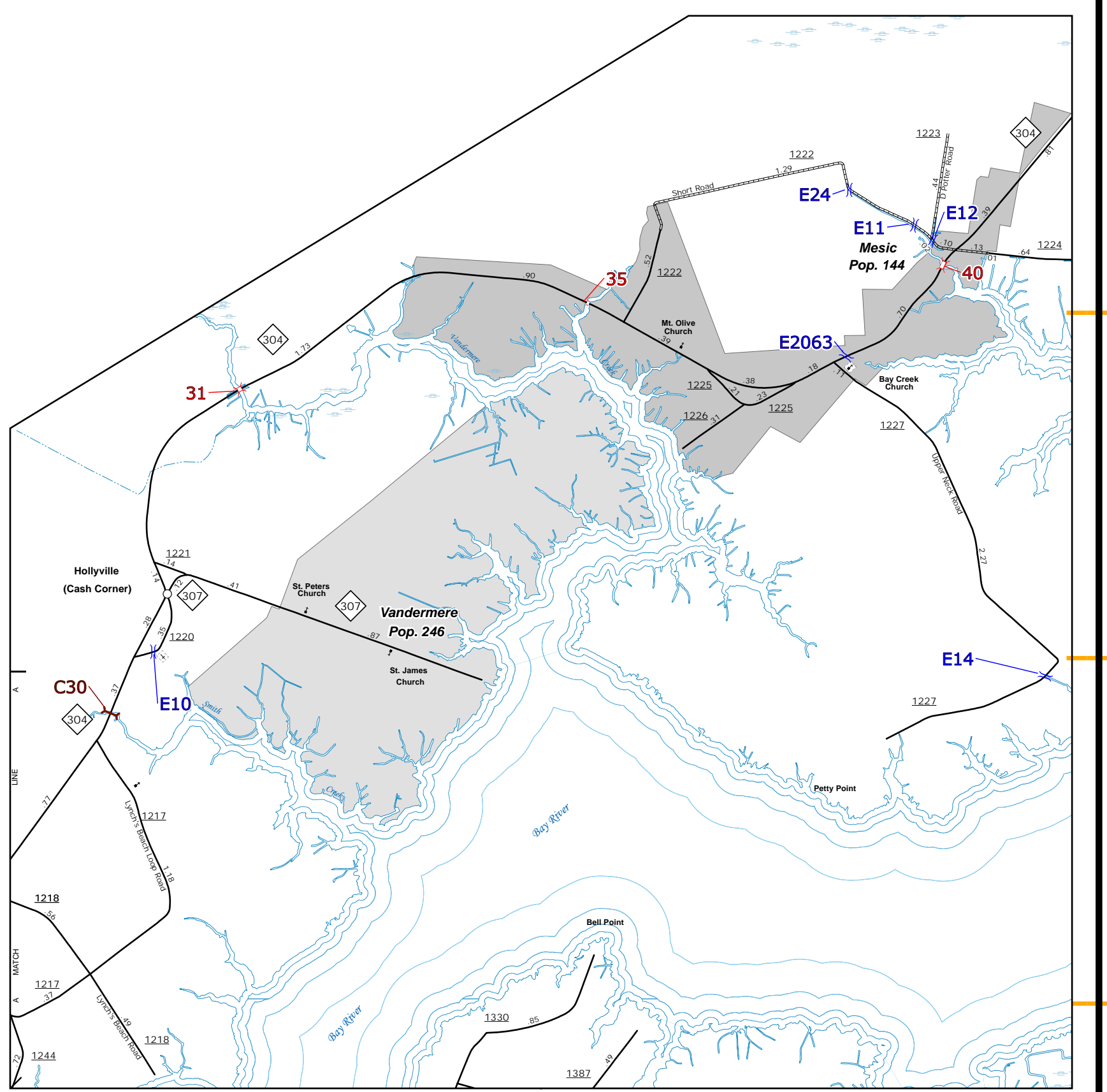
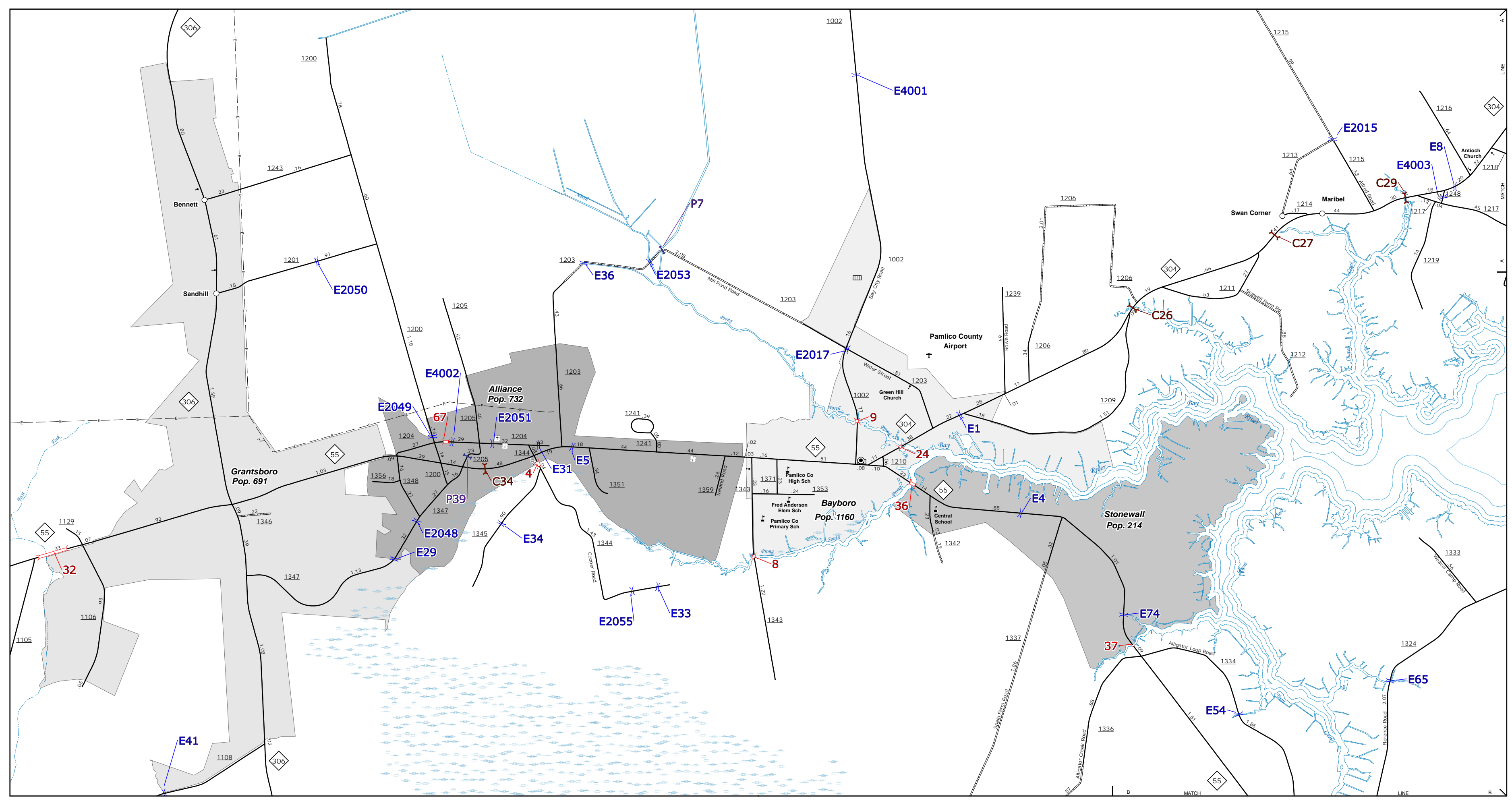

- BRIDGE
- CITY BRIDGE
- CITY SIGN
- CITY CULVERT
- C CULVERT
- DRAW BRIDGE
- D PEDESTRIAN BRIDGE
- E NON-NBIS PIPE
- F FERRY RAMP
- G FEDERAL BRIDGE
- H NON-SYSTEM MAINT BY NCDOT
- L CANTILEVER SIGN
- M PRIVATE STRUCTURE
- N NCDOT OVERPASS STRUCTURE
- O PAVEMENT ON PILES
- P CITY PIPE
- T PIPE
- R RAILROAD BRIDGE
- S OVERHEAD SIGN
- T TUNNEL
- U PEDESTRIAN UNDERPASS
- V VEHICULAR UNDERPASS
- W PEDESTRIAN WALKWAY
- Y POLE SIGN

ENLARGED MUNICIPAL AND SUBURBAN AREAS

PAMLICO COUNTY NORTH CAROLINA BRIDGE LOCATION MAP

PREPARED BY THE
NORTH CAROLINA DEPARTMENT OF TRANSPORTATION
OPERATIONS PROGRAM MANAGEMENT UNIT - MAPPING SECTION
IN COOPERATION WITH THE
U.S. DEPARTMENT OF TRANSPORTATION
FEDERAL HIGHWAY ADMINISTRATION

SCALE
1 0 1
MILES

10,000 FOOT GRID BASED ON NORTH CAROLINA PLANE COORDINATE SYSTEM
LAMBERT CONFORMAL CONIC PROJECTION

SHEET 2 OF 2