

10 11 12 13 14 15 16 17 18 19

A  
B  
C  
D  
E  
F  
G  
H

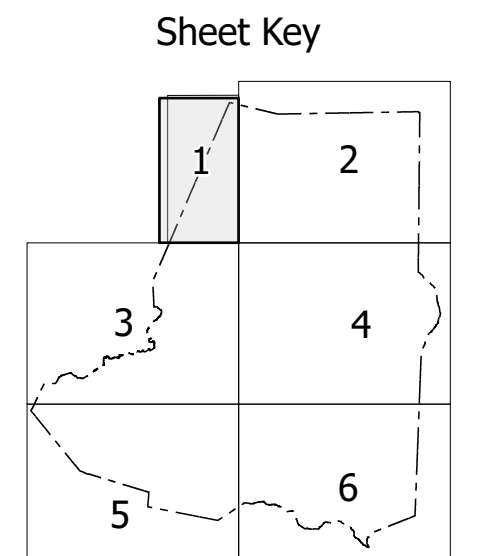

- LEGEND
- |                                 |       |       |               |
|---------------------------------|-------|-------|---------------|
| INTERSTATE                      | ES    | NC    | Divided Hwy   |
| BRIDGE                          | UNDIV | UNDIV | Undivided Hwy |
| BEAR BRIDGE                     |       |       |               |
| RAILROAD                        |       |       |               |
| UNPAVED SURFACED ROAD           |       |       |               |
| ROADS-BUILD ROAD                |       |       |               |
| NON-SYSTEM ROAD                 |       |       |               |
| PROFESSIONAL MAIN ROAD          |       |       |               |
| PROPOSED INTERSECTION           |       |       |               |
| INTERSECTION DISTANCE           |       |       |               |
| INTERSTATE HIGHWAY              |       |       |               |
| U.S. NUMBERED HIGHWAY           |       |       |               |
| U.S. NUMBERED BI-CYCLE ROUTE    |       |       |               |
| U.S. NUMBERED BI-CYCLE ROUTE    |       |       |               |
| STATE ROUTE INTRACHANGE NUMBER  |       |       |               |
| STATE ROUTE NUMBER              |       |       |               |
| UTILITY LINES                   |       |       |               |
| RAILROAD STATION                |       |       |               |
| POST OFFICE                     |       |       |               |
| CITY LINE                       |       |       |               |
| COUNTY LINE                     |       |       |               |
| UNIMPROVED URBAN BOUNDARIES     |       |       |               |
| CITY LIMITS                     |       |       |               |
| FERRY ROUTE AND RAMP            |       |       |               |
| NARROW GREEK OR STREAM          |       |       |               |
| WIDE RIVER OR CREEK             |       |       |               |
| RESERVE AND LAKE W/ ISLAND      |       |       |               |
| DAM OR DAM WITH LOCK            |       |       |               |
| WATERFALL                       |       |       |               |
| SWAMP                           |       |       |               |
| COMMUNITY                       |       |       |               |
| COUNTY SEAT                     |       |       |               |
| SCHOOL                          |       |       |               |
| COLLEGE OR UNIVERSITY           |       |       |               |
| HOSPITAL                        |       |       |               |
| COAST GUARD STATION             |       |       |               |
| CHURCH                          |       |       |               |
| CHURCH WITH CEMETERY            |       |       |               |
| CEMETERY                        |       |       |               |
| PARK STATION                    |       |       |               |
| CORRECTION OR PENAL INSTITUTION |       |       |               |
| SQUARE                          |       |       |               |
| MENS OR WIP                     |       |       |               |
| HIGHWAY GARAGE OR MAINT YARD    |       |       |               |
| HIGHWAY INV OR HIST OFFICE      |       |       |               |
| MILITARY POST                   |       |       |               |
| WEIGH STATION                   |       |       |               |
| FARMHOUSE                       |       |       |               |
| HISTORICAL SITE                 |       |       |               |
| POINTS OF INTEREST              |       |       |               |
| POST OFFICE                     |       |       |               |
| STATE FOREST                    |       |       |               |
| LANDMARK                        |       |       |               |
| MOUNTAIN SUMMIT                 |       |       |               |
| BENTON MAP                      |       |       |               |
| OVERLOOK                        |       |       |               |
| REST AREA                       |       |       |               |
| VIEWING CENTER AREA             |       |       |               |
| WELCOME CENTER AREA             |       |       |               |
| AIRPORT                         |       |       |               |
| MILITARY AIRPORT                |       |       |               |
| NATIONAL STATE FOREST BOUNDARY  |       |       |               |
| WILDLIFE REFUGE                 |       |       |               |
| NATIONAL STATE PARK BOUNDARY    |       |       |               |
| GAME LANDS BOUNDARY             |       |       |               |
| MILITARY RESERVATION BOUNDARY   |       |       |               |
| INDIAN RESERVATION BOUNDARY     |       |       |               |

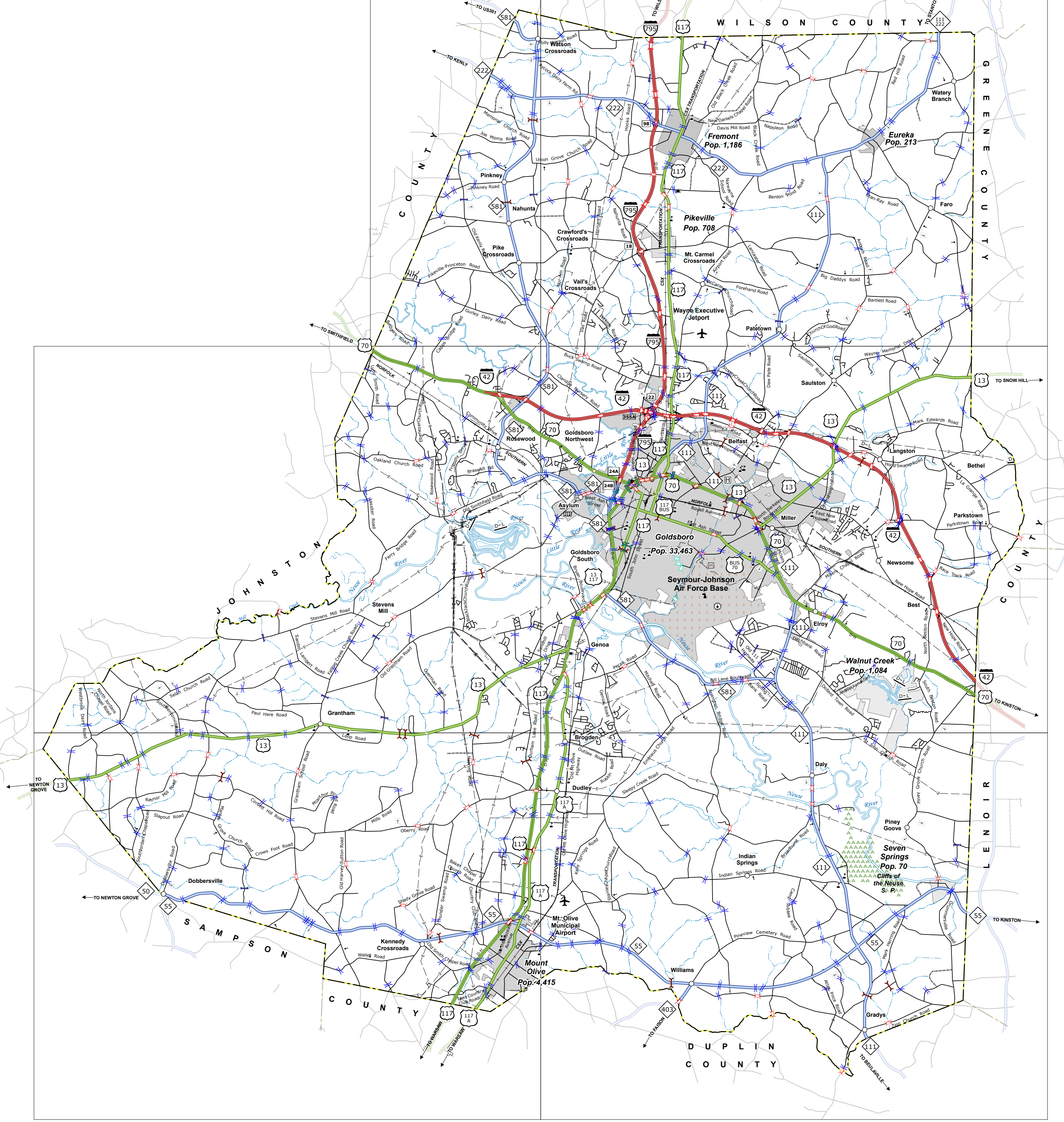
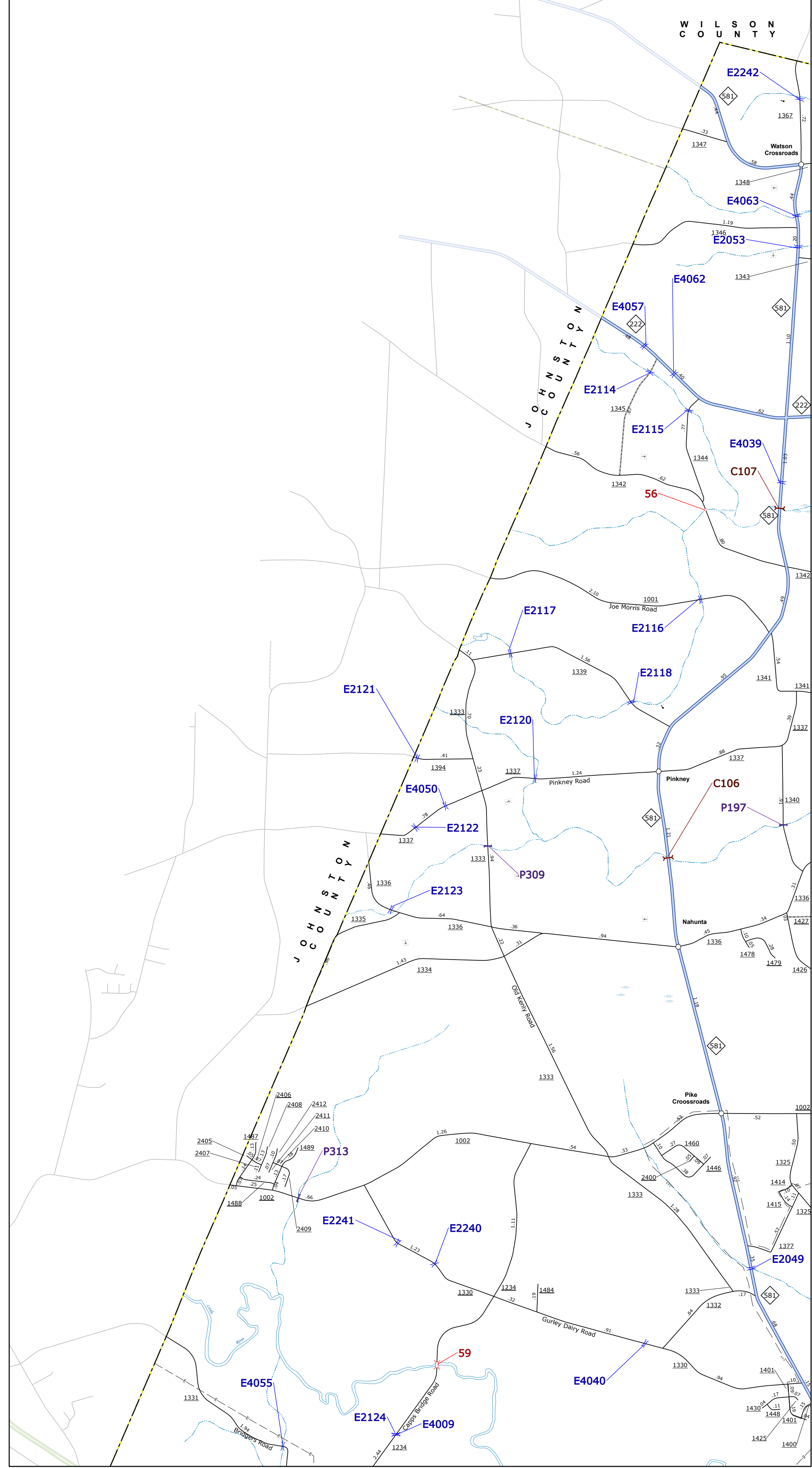
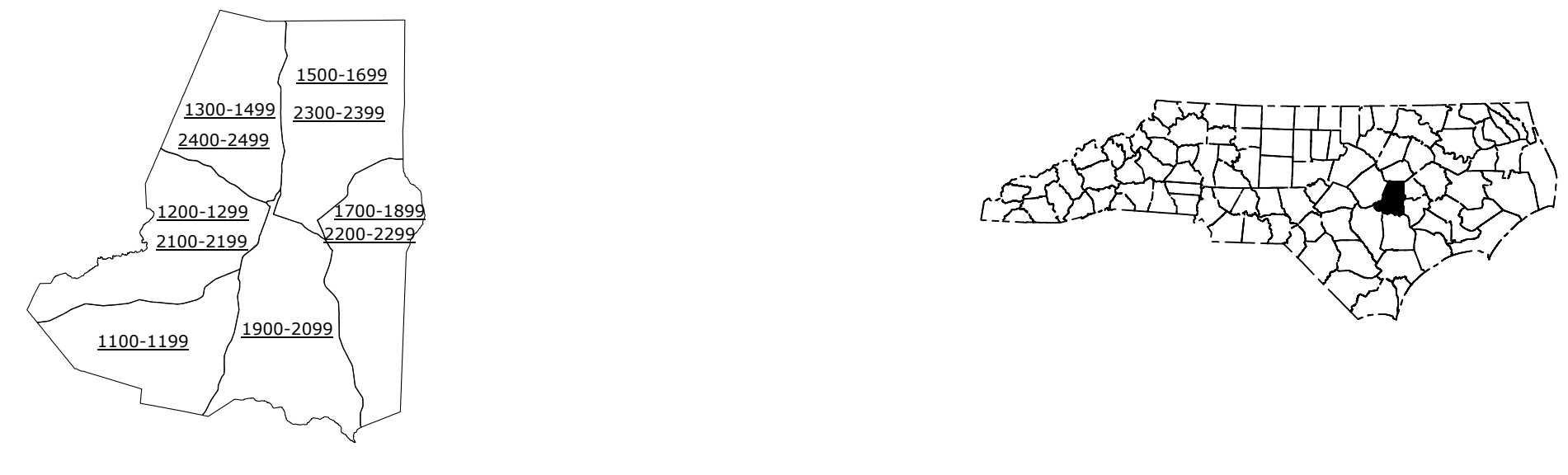

**WAYNE COUNTY  
NORTH CAROLINA  
BRIDGE LOCATION MAP**

PREPARED BY THE  
NORTH CAROLINA DEPARTMENT OF TRANSPORTATION  
OPERATIONS PROGRAM MANAGEMENT UNIT - MAPPING SECTION  
IN COOPERATION WITH THE  
U.S. DEPARTMENT OF TRANSPORTATION  
FEDERAL HIGHWAY ADMINISTRATION

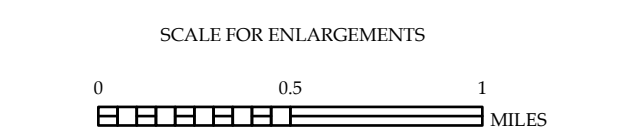
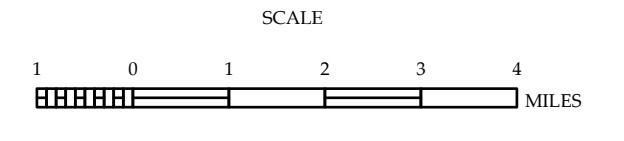

NORTH CAROLINA PLANE COORDINATE SYSTEM  
LAMBERT CONFORMAL CONIC PROJECTION

COPIES OF THIS MAP ARE AVAILABLE TO THE  
PUBLIC AT NOMINAL COST. CONTACT US TO ORDER:  
[maporders@ncdot.gov](mailto:maporders@ncdot.gov)  
<https://connect.ncdot.gov/resources/State-Mapping/Pages/Ordering-Maps.aspx>  
(919) 834-8480

TERMS OF USE: The Mapping Section's goal is to provide the most accurate and current information possible. Map data is compiled from numerous sources with varying dates of publication and map accuracy standards. As a result, the accuracy, currency, and completeness of the data provided will vary. The North Carolina Department of Transportation shall not be held liable for any errors in the map data. This map cannot be construed to be a legal document. The information shown on this map was last updated in June 2024.  
For digital copies of this map or additional map products, visit <https://connect.ncdot.gov/resources/State-Mapping>.

10 11 12 13 14 15 16 17 18 19