

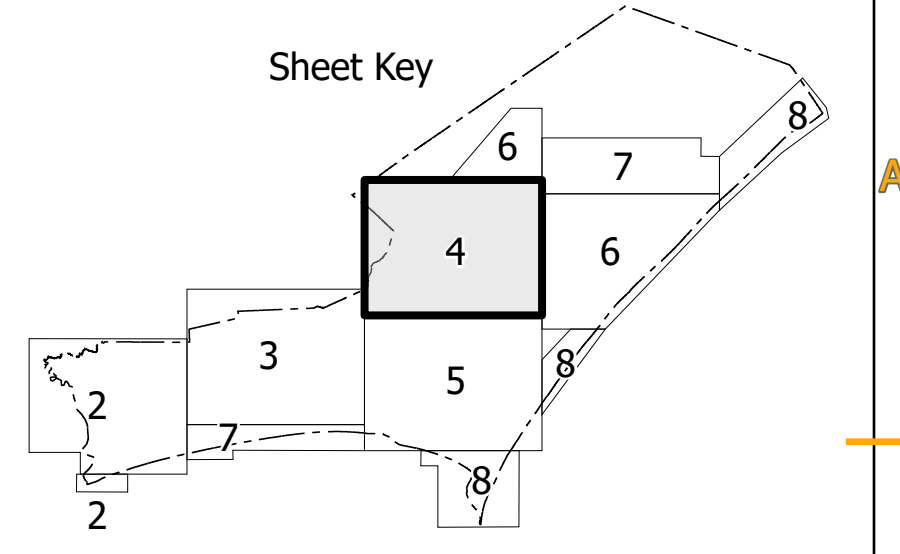

THIS IS A PRELIMINARY MAP. THE INFORMATION ON THIS MAP IS FOR INFORMATIONAL PURPOSES ONLY. THE INFORMATION ON THIS MAP IS NOT GUARANTEED. THE INFORMATION ON THIS MAP IS NOT TO BE USED FOR ANY OTHER PURPOSE. THE INFORMATION ON THIS MAP IS NOT TO BE USED FOR ANY OTHER PURPOSE. THE INFORMATION ON THIS MAP IS NOT TO BE USED FOR ANY OTHER PURPOSE.

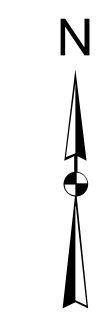

- ### LEGEND
- | | | | |
|-----------------------------------|-----------------------------------|-----------------------------------|-----------------------------------|
| INTERSTATE US | NC | Discolored Hwy | UNPAVED SURFACE ROAD |
| BLUE RIDGE PARKWAY | UNPAVED SURFACE ROAD | UNPAVED SURFACE ROAD | UNPAVED SURFACE ROAD |
| ROADS BEHIND ROAD | ROADS BEHIND ROAD | ROADS BEHIND ROAD | ROADS BEHIND ROAD |
| NON-SYSTEM ROAD | NON-SYSTEM ROAD | NON-SYSTEM ROAD | NON-SYSTEM ROAD |
| PROFESSIONALLY DRAWN ROAD | PROFESSIONALLY DRAWN ROAD | PROFESSIONALLY DRAWN ROAD | PROFESSIONALLY DRAWN ROAD |
| PREDICTED LOCATION | PREDICTED LOCATION | PREDICTED LOCATION | PREDICTED LOCATION |
| INTERSECTION DISTANCE | INTERSECTION DISTANCE | INTERSECTION DISTANCE | INTERSECTION DISTANCE |
| INTERSTATE HIGHWAY | INTERSTATE HIGHWAY | INTERSTATE HIGHWAY | INTERSTATE HIGHWAY |
| US NUMBERED HIGHWAY | US NUMBERED HIGHWAY | US NUMBERED HIGHWAY | US NUMBERED HIGHWAY |
| NC NUMBERED HIGHWAY | NC NUMBERED HIGHWAY | NC NUMBERED HIGHWAY | NC NUMBERED HIGHWAY |
| U.S. NUMBERED BICYCLE ROUTE | U.S. NUMBERED BICYCLE ROUTE | U.S. NUMBERED BICYCLE ROUTE | U.S. NUMBERED BICYCLE ROUTE |
| NC NUMBERED BICYCLE ROUTE | NC NUMBERED BICYCLE ROUTE | NC NUMBERED BICYCLE ROUTE | NC NUMBERED BICYCLE ROUTE |
| INTERSTATE INTERCHANGE NUMBER | INTERSTATE INTERCHANGE NUMBER | INTERSTATE INTERCHANGE NUMBER | INTERSTATE INTERCHANGE NUMBER |
| SECONDARY ROAD NUMBER | SECONDARY ROAD NUMBER | SECONDARY ROAD NUMBER | SECONDARY ROAD NUMBER |
| UTILITY LINES | UTILITY LINES | UTILITY LINES | UTILITY LINES |
| RAILROAD LINE | RAILROAD LINE | RAILROAD LINE | RAILROAD LINE |
| RAILROAD STATION | RAILROAD STATION | RAILROAD STATION | RAILROAD STATION |
| INSET AREA | INSET AREA | INSET AREA | INSET AREA |
| STATE LINE | STATE LINE | STATE LINE | STATE LINE |
| COUNTY LINE | COUNTY LINE | COUNTY LINE | COUNTY LINE |
| SMOOTHED URBAN BOUNDARIES | SMOOTHED URBAN BOUNDARIES | SMOOTHED URBAN BOUNDARIES | SMOOTHED URBAN BOUNDARIES |
| CITY LIMITS | CITY LIMITS | CITY LIMITS | CITY LIMITS |
| FERRY ROUTE AND RAMP | FERRY ROUTE AND RAMP | FERRY ROUTE AND RAMP | FERRY ROUTE AND RAMP |
| NARROW CREEK OR STREAM | NARROW CREEK OR STREAM | NARROW CREEK OR STREAM | NARROW CREEK OR STREAM |
| WIDE RIVER OR CREEK | WIDE RIVER OR CREEK | WIDE RIVER OR CREEK | WIDE RIVER OR CREEK |
| RESERVOIR, POND OR LAKE W/ ISLAND | RESERVOIR, POND OR LAKE W/ ISLAND | RESERVOIR, POND OR LAKE W/ ISLAND | RESERVOIR, POND OR LAKE W/ ISLAND |
| DAM OR DAM WITH LOCK | DAM OR DAM WITH LOCK | DAM OR DAM WITH LOCK | DAM OR DAM WITH LOCK |
| WATERFALL | WATERFALL | WATERFALL | WATERFALL |
| SWAMP | SWAMP | SWAMP | SWAMP |
| COMMUNITY | COMMUNITY | COMMUNITY | COMMUNITY |
| CITY LIMITS | CITY LIMITS | CITY LIMITS | CITY LIMITS |
| SCHOOL | SCHOOL | SCHOOL | SCHOOL |
| COLLEGE OR UNIVERSITY | COLLEGE OR UNIVERSITY | COLLEGE OR UNIVERSITY | COLLEGE OR UNIVERSITY |
| HOSPITAL | HOSPITAL | HOSPITAL | HOSPITAL |
| COAST GUARD STATION | COAST GUARD STATION | COAST GUARD STATION | COAST GUARD STATION |
| CHURCH | CHURCH | CHURCH | CHURCH |
| CHURCH WITH CEMETERY | CHURCH WITH CEMETERY | CHURCH WITH CEMETERY | CHURCH WITH CEMETERY |
| CEMETERY | CEMETERY | CEMETERY | CEMETERY |
| POST OFFICE | POST OFFICE | POST OFFICE | POST OFFICE |
| CORRECTION OR PENAL INSTITUTION | CORRECTION OR PENAL INSTITUTION | CORRECTION OR PENAL INSTITUTION | CORRECTION OR PENAL INSTITUTION |
| QUARRY | QUARRY | QUARRY | QUARRY |
| MINE OR PIT | MINE OR PIT | MINE OR PIT | MINE OR PIT |
| HIGHWAY GARAGE OR MAINT. YARD | HIGHWAY GARAGE OR MAINT. YARD | HIGHWAY GARAGE OR MAINT. YARD | HIGHWAY GARAGE OR MAINT. YARD |
| HIGHWAY DIV. OR DIST. OFFICE | HIGHWAY DIV. OR DIST. OFFICE | HIGHWAY DIV. OR DIST. OFFICE | HIGHWAY DIV. OR DIST. OFFICE |
| MILITARY POST | MILITARY POST | MILITARY POST | MILITARY POST |
| WEIGH STATION | WEIGH STATION | WEIGH STATION | WEIGH STATION |
| FABRICATIONS | FABRICATIONS | FABRICATIONS | FABRICATIONS |
| HISTORICAL SITE | HISTORICAL SITE | HISTORICAL SITE | HISTORICAL SITE |
| POINTS OF INTEREST | POINTS OF INTEREST | POINTS OF INTEREST | POINTS OF INTEREST |
| POST OFFICE | POST OFFICE | POST OFFICE | POST OFFICE |
| STATE FOREST | STATE FOREST | STATE FOREST | STATE FOREST |
| LIGHTHOUSE | LIGHTHOUSE | LIGHTHOUSE | LIGHTHOUSE |
| MOUNTAIN SUMMIT | MOUNTAIN SUMMIT | MOUNTAIN SUMMIT | MOUNTAIN SUMMIT |
| MOUNTAIN GAP | MOUNTAIN GAP | MOUNTAIN GAP | MOUNTAIN GAP |
| OVERLOOK | OVERLOOK | OVERLOOK | OVERLOOK |
| REST AREA | REST AREA | REST AREA | REST AREA |
| VISITOR CENTER REST AREA | VISITOR CENTER REST AREA | VISITOR CENTER REST AREA | VISITOR CENTER REST AREA |
| WELCOME CENTER REST AREA | WELCOME CENTER REST AREA | WELCOME CENTER REST AREA | WELCOME CENTER REST AREA |
| AIRPORT | AIRPORT | AIRPORT | AIRPORT |
| MILITARY AIRPORT | MILITARY AIRPORT | MILITARY AIRPORT | MILITARY AIRPORT |
| NATIONAL / STATE FOREST BOUNDARY | NATIONAL / STATE FOREST BOUNDARY | NATIONAL / STATE FOREST BOUNDARY | NATIONAL / STATE FOREST BOUNDARY |
| WILDLIFE REFUGE | WILDLIFE REFUGE | WILDLIFE REFUGE | WILDLIFE REFUGE |
| NATIONAL / STATE PARK BOUNDARY | NATIONAL / STATE PARK BOUNDARY | NATIONAL / STATE PARK BOUNDARY | NATIONAL / STATE PARK BOUNDARY |
| GAME LANDS BOUNDARY | GAME LANDS BOUNDARY | GAME LANDS BOUNDARY | GAME LANDS BOUNDARY |
| MILITARY RESERVATION BOUNDARY | MILITARY RESERVATION BOUNDARY | MILITARY RESERVATION BOUNDARY | MILITARY RESERVATION BOUNDARY |
| INDIAN RESERVATION BOUNDARY | INDIAN RESERVATION BOUNDARY | INDIAN RESERVATION BOUNDARY | INDIAN RESERVATION BOUNDARY |

CARTERET COUNTY NORTH CAROLINA BRIDGE LOCATION MAP

PREPARED BY THE
 NORTH CAROLINA DEPARTMENT OF TRANSPORTATION
 OPERATIONS PROGRAM MANAGEMENT UNIT - MAPPING SECTION
 IN COOPERATION WITH THE
 U.S. DEPARTMENT OF TRANSPORTATION
 FEDERAL HIGHWAY ADMINISTRATION

SCALE



NORTH CAROLINA PLANE COORDINATE SYSTEM
LAMBERT CONFORMAL CONIC PROJECTION

SHEET 4 of 8
DIVISION 2 DISTRICT 2 CARTERET COUNTY NORTH CAROLINA FIPS 031