

THIS IS A PRELIMINARY MAP. THE INFORMATION ON THIS MAP IS FOR INFORMATIONAL PURPOSES ONLY. THE INFORMATION ON THIS MAP IS NOT TO BE USED FOR ANY OTHER PURPOSE. THE INFORMATION ON THIS MAP IS NOT TO BE USED FOR ANY OTHER PURPOSE. THE INFORMATION ON THIS MAP IS NOT TO BE USED FOR ANY OTHER PURPOSE.

COPYRIGHT © 2015 BY THE NORTH CAROLINA DEPARTMENT OF TRANSPORTATION OPERATIONS PROGRAM MANAGEMENT UNIT - MAPPING SECTION. ALL RIGHTS RESERVED. THE INFORMATION ON THIS MAP IS NOT TO BE USED FOR ANY OTHER PURPOSE.

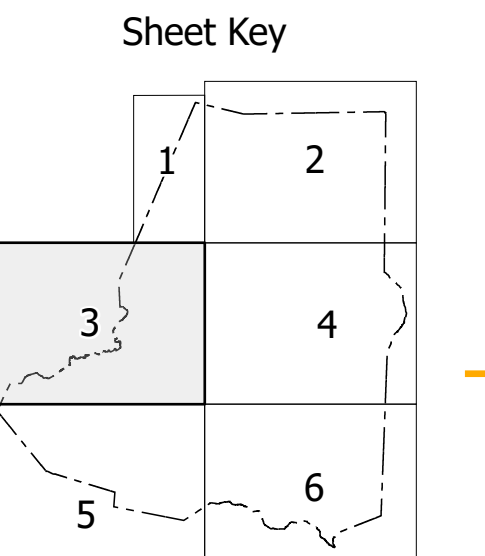
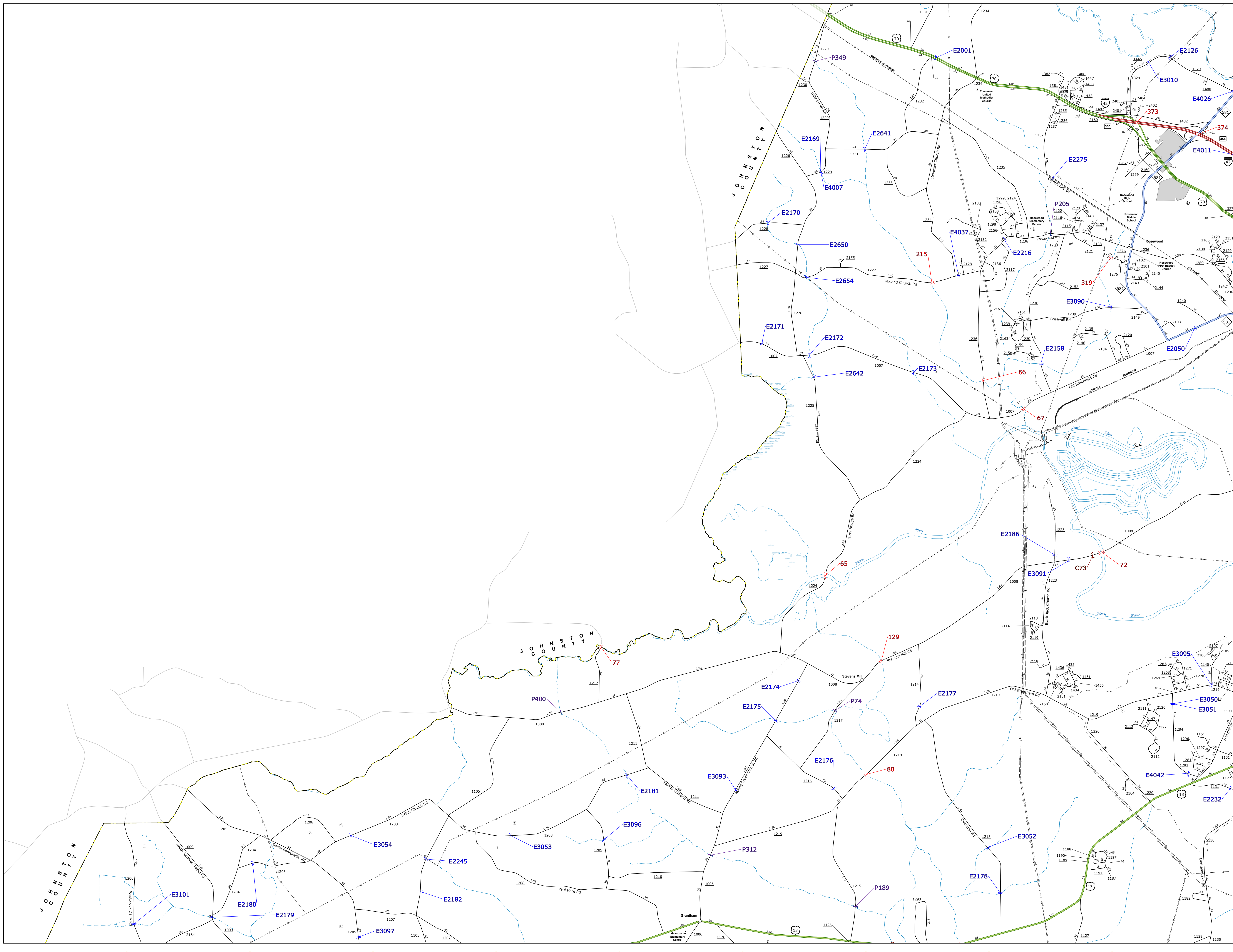

- LEGEND**
- INTERSTATE US NC Divided Hwy
 - US Divided Hwy
 - BLUE RIDGE PARKWAY
 - UNDIVIDED HWY
 - HARD SURFACED ROAD
 - UNPAVED SURFACED ROAD
 - NON-SYSTEM ROAD
 - PROVISIONALLY DRAIN ROAD
 - PROPOSED LOCATION
 - INTERSECTION DISTANCE
 - INTERSTATE HIGHWAY
 - U.S. NUMBERED HIGHWAY
 - U.S. NUMBERED HIGHWAY
 - U.S. NUMBERED BICYCLE ROUTE
 - N.C. NUMBERED BICYCLE ROUTE
 - INTERSTATE INTERCHANGE NUMBER
 - SECONDARY ROAD NUMBER
 - UTILITY LINES
 - RAILROAD LINE
 - RAILROAD STATION
 - INSET AREA
 - STATE LINE
 - COUNTY LINE
 - SMOOTHED URBAN BOUNDARIES
 - CITY LIMITS
 - FERRY ROUTE AND RAMP
 - NARROW CREEK OR STREAM
 - WIDE RIVER OR CREEK
 - RESERVOIR, POND OR LAKE W/ ISLAND
 - DAM OR DAM WITH LOCK
 - WATERFALL
 - SWAMP
 - COMMUNITY
 - COUNTY SEAT
 - SCHOOL
 - COLLEGE OR UNIVERSITY
 - HOSPITAL
 - COAST GUARD STATION
 - CHURCH
 - CHURCH WITH CEMETERY
 - CEMETERY
 - PATROL STATION
 - CORRECTION OR PENAL INSTITUTION
 - MINE OR PIT
 - HIWAY GARAGE OR MAINT. YARD
 - HIWAY DIV. OR DIST. OFFICE
 - MILITARY POST
 - WEIGH STATION
 - FABRICATIONS
 - HISTORICAL SITE
 - POINTS OF INTEREST
 - POST OFFICE
 - STATE FOREST
 - LIGHTHOUSE
 - MOUNTAIN SUMMIT
 - MOUNTAIN GAP
 - OVERLOOK
 - REST AREA
 - VISITOR CTR/REST AREA
 - WELCOME CTR/REST AREA
 - AIRPORT
 - MILITARY AIRPORT
 - NATIONAL / STATE FOREST BOUNDARY
 - WILDLIFE REFUGE
 - NATIONAL / STATE PARK BOUNDARY
 - GAME LANDS BOUNDARY
 - MILITARY RESERVATION BOUNDARY
 - INDIAN RESERVATION BOUNDARY

**WAYNE COUNTY
NORTH CAROLINA
BRIDGE LOCATION MAP**

PREPARED BY THE
NORTH CAROLINA DEPARTMENT OF TRANSPORTATION
OPERATIONS PROGRAM MANAGEMENT UNIT - MAPPING SECTION
IN COOPERATION WITH THE
U.S. DEPARTMENT OF TRANSPORTATION
FEDERAL HIGHWAY ADMINISTRATION

SCALE

0 1 MILES

NORTH CAROLINA PLANE COORDINATE SYSTEM
LAMBERT CONFORMAL CONIC PROJECTION

DIVISION 4 DISTRICT 3 WAYNE COUNTY NORTH CAROLINA FIPS 191

SHEET 3 of 6

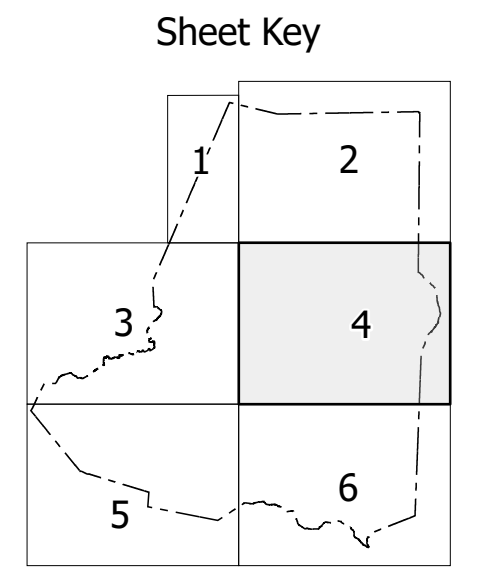
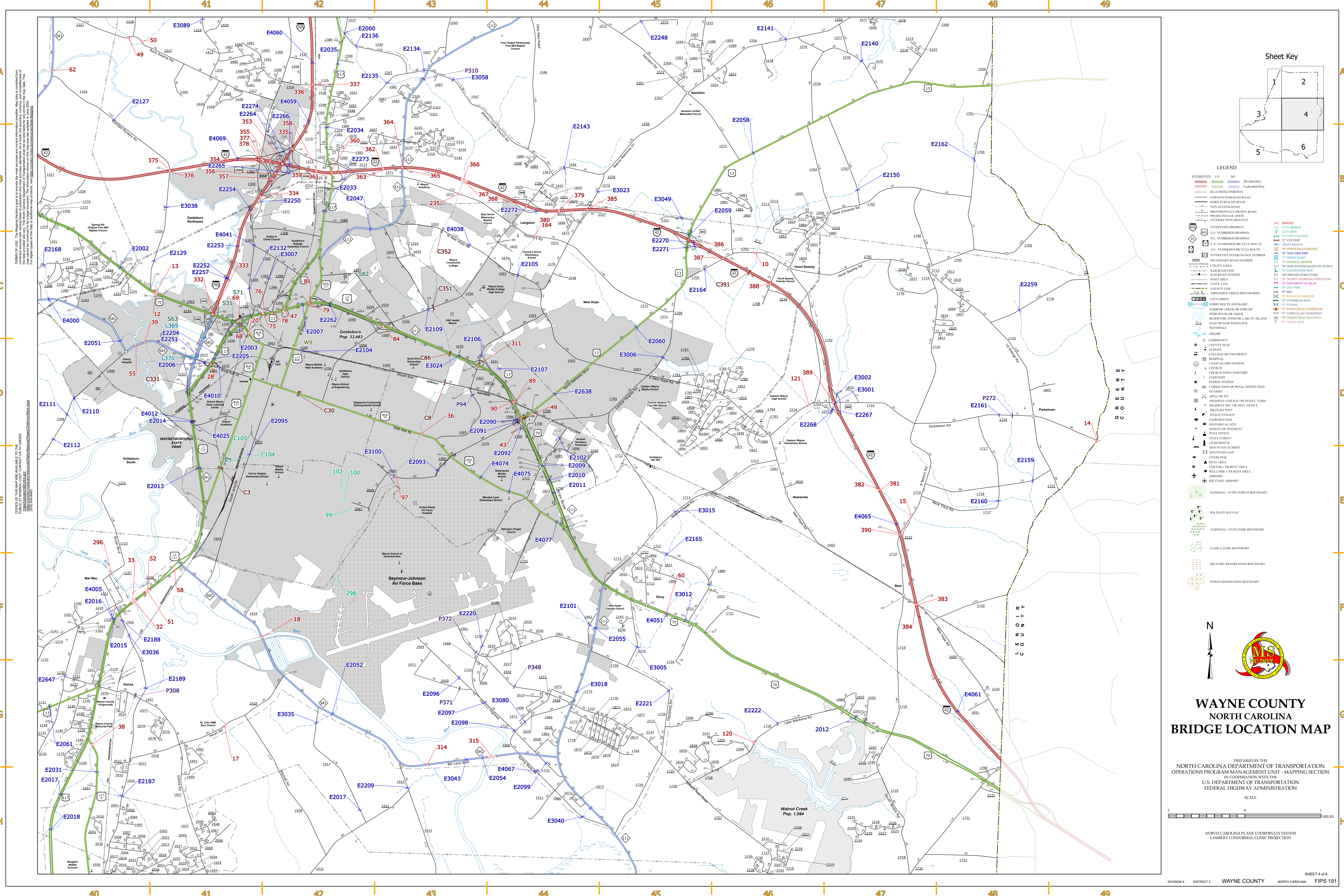

- LEGEND**
- INTERSTATE HIGHWAY
 - U.S. NUMBERED HIGHWAY
 - N.C. NUMBERED HIGHWAY
 - U.S. NUMBERED BI-CYCLE ROUTE
 - N.C. NUMBERED BI-CYCLE ROUTE
 - INTERSTATE INTERCHANGE NUMBER
 - SECONDARY ROAD NUMBER
 - UTILITY LINES
 - RAILROAD LINE
 - RAILROAD STATION
 - INSET AREA
 - STATE LINE
 - COUNTY LINE
 - SMOOTHED URBAN BOUNDARIES
 - CITY LIMITS
 - FERRY ROUTE AND RAMP
 - NARROW CREEK OR STREAM
 - WIDE RIVER OR CREEK
 - RESERVOIR, POND OR LAKE W/ ISLAND
 - DAM OR DAM WITH LOCK
 - WATERFALL
 - SWAMP
 - COMMUNITY
 - COUNTY SEAT
 - SCHOOL
 - COLLEGE OR UNIVERSITY
 - HOSPITAL
 - COAST GUARD STATION
 - CHURCH
 - CHURCH WITH CEMETERY
 - CEMETERY
 - PATROL STATION
 - CORRECTION OR PENAL INSTITUTION
 - QUARRY
 - MINE OR PIT
 - HIGHWAY GARAGE OR MAINT. YARD
 - HIGHWAY DIV. OR DIST. OFFICE
 - MILITARY POST
 - WEIGH STATION
 - FABRICATION
 - HISTORICAL SITE
 - POINTS OF INTEREST
 - POST OFFICE
 - STATE FOREST
 - LIGHTHOUSE
 - MOUNTAIN SUMMIT
 - MOUNTAIN GAP
 - OVERLOOK
 - REST AREA
 - VISITOR CENTER AREA
 - WELCOME CENTER AREA
 - AIRPORT
 - MILITARY AIRPORT
 - NATIONAL/STATE FOREST BOUNDARY
 - WILDLIFE REFUGE
 - NATIONAL/STATE PARK BOUNDARY
 - GAME LANDS BOUNDARY
 - MILITARY RESERVATION BOUNDARY
 - INDIAN RESERVATION BOUNDARY
 - BRIDGE
 - CITY BRIDGE
 - CITY CULVERT
 - CULVERT
 - FEEDBACK BRIDGE
 - NON-SYSTEM PIPE
 - FEDERAL BRIDGE
 - NON-SYSTEM MAINT BY NCDOT
 - CASTLE/ICE DAM
 - PRIVATE STRUCTURE
 - NCDOT OVERPASS STRUCTURE
 - OVERPASS OR PIERS
 - CITY PIPE
 - PIPE
 - RAILROAD BRIDGE
 - OVERHEAD SKIN
 - TUNNEL
 - PEDESTRIAN UNDERPASS
 - VEHICULAR UNDERPASS
 - PEDESTRIAN WALKWAY
 - TRIPLE SKIN

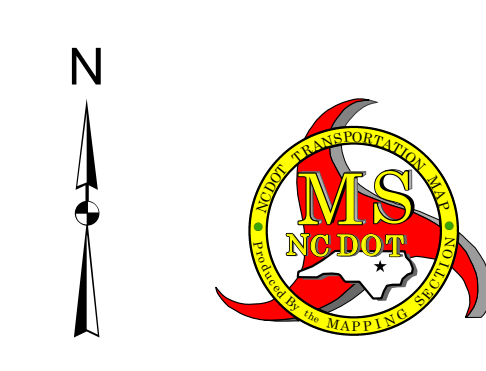

WAYNE COUNTY NORTH CAROLINA BRIDGE LOCATION MAP

PREPARED BY THE
NORTH CAROLINA DEPARTMENT OF TRANSPORTATION
OPERATIONS PROGRAM MANAGEMENT UNIT - MAPPING SECTION
IN COOPERATION WITH THE
U.S. DEPARTMENT OF TRANSPORTATION
FEDERAL HIGHWAY ADMINISTRATION

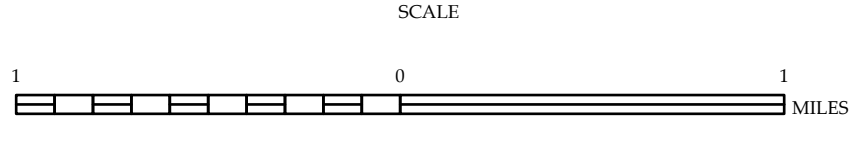

NORTH CAROLINA PLANE COORDINATE SYSTEM
LAMBERT CONFORMAL CONIC PROJECTION

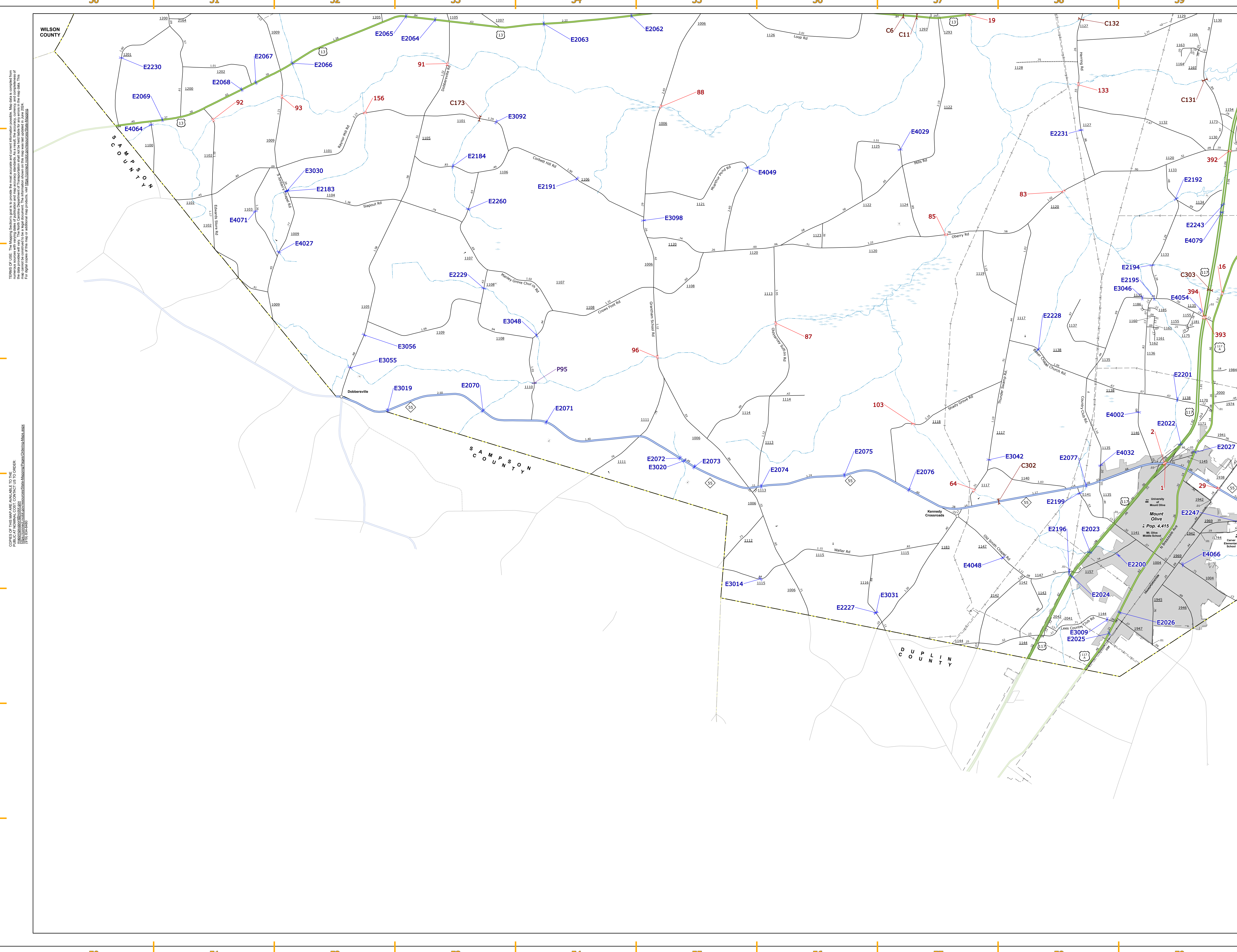

THIS IS A PRELIMINARY MAP. THE INFORMATION ON THIS MAP IS FOR INFORMATIONAL PURPOSES ONLY. THE INFORMATION ON THIS MAP IS NOT GUARANTEED TO BE ACCURATE. THE INFORMATION ON THIS MAP IS NOT TO BE USED FOR ANY OTHER PURPOSE. THE INFORMATION ON THIS MAP IS NOT TO BE USED FOR ANY OTHER PURPOSE. THE INFORMATION ON THIS MAP IS NOT TO BE USED FOR ANY OTHER PURPOSE.

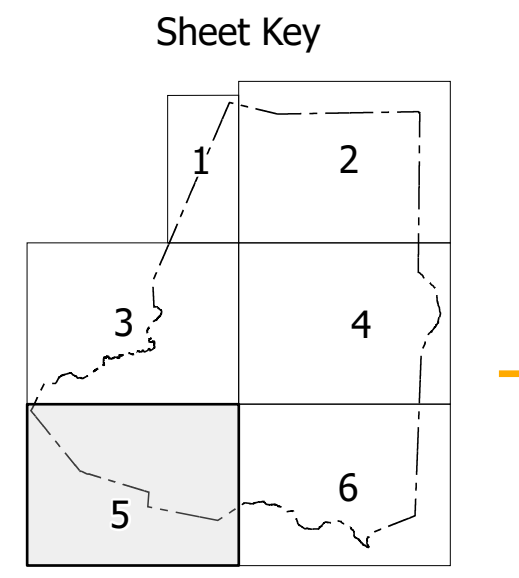

- ### LEGEND
- | | | | |
|--|-----------------------------------|--|---------------------------|
| | INTERSTATE HIGHWAY | | CITY BRIDGE |
| | U.S. NUMBERED HIGHWAY | | CITY CULVERT |
| | N.C. NUMBERED HIGHWAY | | PEDESTRIAN BRIDGE |
| | Divided Hwy | | CULVERT |
| | Undivided Hwy | | DRAW BRIDGE |
| | BLUE RIDGE PARKWAY | | CASTELLATED SIGN |
| | UNPAVED SURFACED ROAD | | NON-SPANS PIPE |
| | HARD SURFACED ROAD | | FERRY RAMP |
| | NON-SYSTEM ROAD | | FEDERAL BRIDGE |
| | PROPRIETARY DRAIN ROAD | | NON-SYSTEM MAINT BY NCDOT |
| | PROJECTED LOCATION | | NCDOT OVERPASS STRUCTURE |
| | INTERSECTION DISTANCE | | OVERPASS OR PILE |
| | INTERSTATE HIGHWAY | | CITY PIPE |
| | U.S. NUMBERED HIGHWAY | | PIPE |
| | N.C. NUMBERED HIGHWAY | | RAILROAD BRIDGE |
| | U.S. NUMBERED BICYCLE ROUTE | | OVERHEAD SIGN |
| | N.C. NUMBERED BICYCLE ROUTE | | TUNNEL |
| | INTERSTATE INTERCHANGE NUMBER | | PEDESTRIAN UNDERPASS |
| | SECONDARY ROAD NUMBER | | VEHICLE UNDERPASS |
| | UTILITY LINES | | PEDESTRIAN WALKWAY |
| | RAILROAD STATION | | TRAPEZOID SIGN |
| | INSET AREA | | |
| | STATE LINE | | |
| | COUNTY LINE | | |
| | SMOOTHED URBAN BOUNDARIES | | |
| | CITY LIMITS | | |
| | FERRY ROUTE AND RAMP | | |
| | NARROW CREEK OR STREAM | | |
| | WIDE RIVER OR CREEK | | |
| | RESERVOIR, POND OR LAKE W/ ISLAND | | |
| | DAM OR DAM WITH LOCK | | |
| | WATERFALL | | |
| | WETLAND | | |
| | COMMUNITY | | |
| | COUNTY SEAT | | |
| | SCHOOL | | |
| | COLLEGE OR UNIVERSITY | | |
| | HOSPITAL | | |
| | COAST GUARD STATION | | |
| | CHURCH | | |
| | CHURCH WITH CEMETERY | | |
| | CEMETERY | | |
| | PATROL STATION | | |
| | CORRECTION OR PENAL INSTITUTION | | |
| | QUARRY | | |
| | MINE OR PIT | | |
| | HIGHWAY GARAGE OR MAINT. YARD | | |
| | HIGHWAY DRY OR DIST. OFFICE | | |
| | MILITARY POST | | |
| | WEIGH STATION | | |
| | FARE GROUNDS | | |
| | HISTORICAL SITE | | |
| | POINT OF INTEREST | | |
| | POST OFFICE | | |
| | STATE FOREST | | |
| | LIGHTHOUSE | | |
| | MOUNTAIN SUMMIT | | |
| | MOUNTAIN GAP | | |
| | OVERLOOK | | |
| | REST AREA | | |
| | VISITOR CTR/REST AREA | | |
| | WELCOME CTR/REST AREA | | |
| | AIRPORT | | |
| | MILITARY AIRPORT | | |
| | NATIONAL/STATE FOREST BOUNDARY | | |
| | WILDLIFE REFUGE | | |
| | NATIONAL/STATE PARK BOUNDARY | | |
| | GAME LANDS BOUNDARY | | |
| | MILITARY RESERVATION BOUNDARY | | |
| | INDIAN RESERVATION BOUNDARY | | |

WAYNE COUNTY NORTH CAROLINA BRIDGE LOCATION MAP

PREPARED BY THE
 NORTH CAROLINA DEPARTMENT OF TRANSPORTATION
 OPERATIONS PROGRAM MANAGEMENT UNIT - MAPPING SECTION
 IN COOPERATION WITH THE
 U.S. DEPARTMENT OF TRANSPORTATION
 FEDERAL HIGHWAY ADMINISTRATION

SCALE

NORTH CAROLINA PLANE COORDINATE SYSTEM
 LAMBERT CONFORMAL CONIC PROJECTION

