

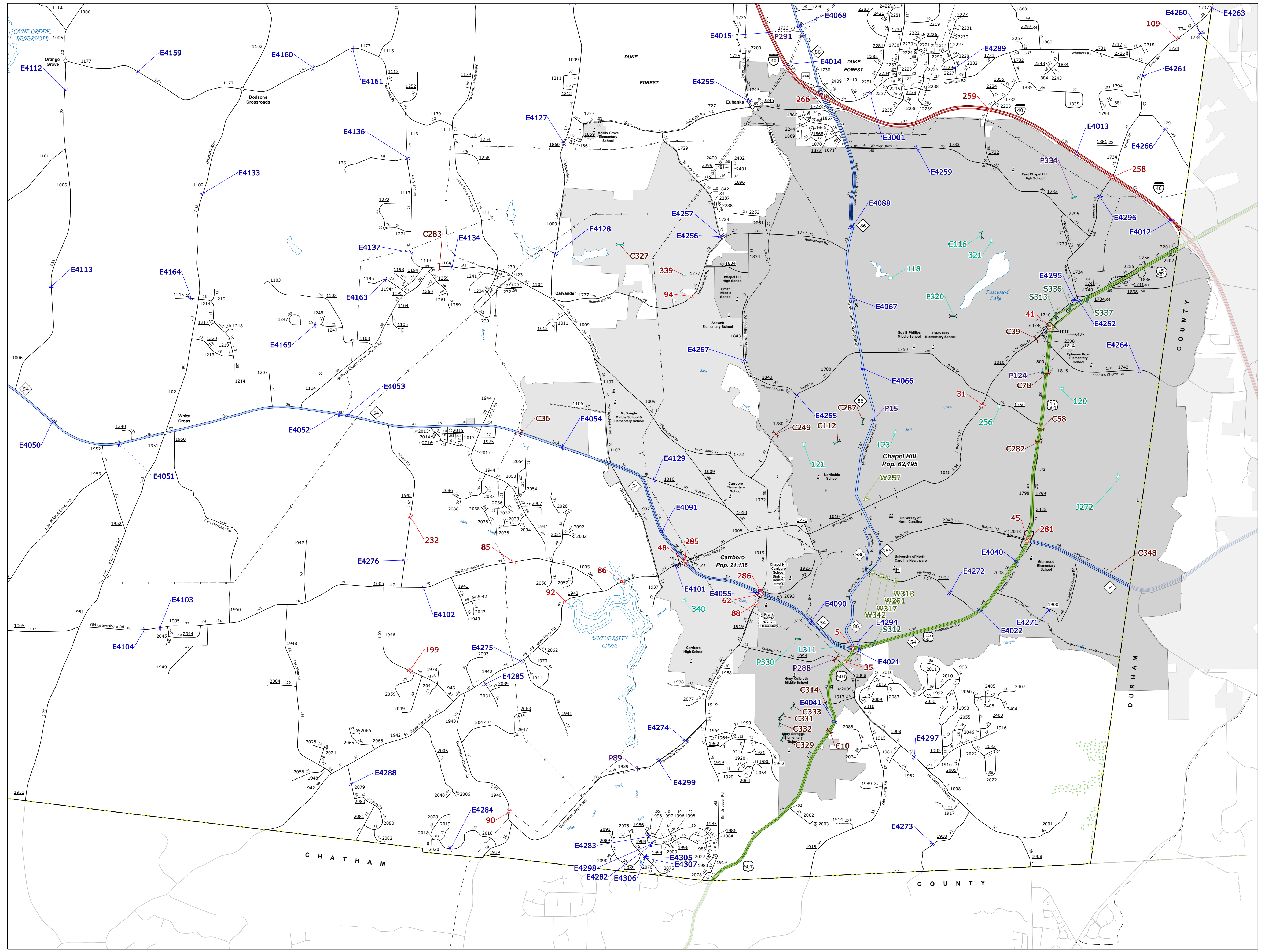

Sheet Key

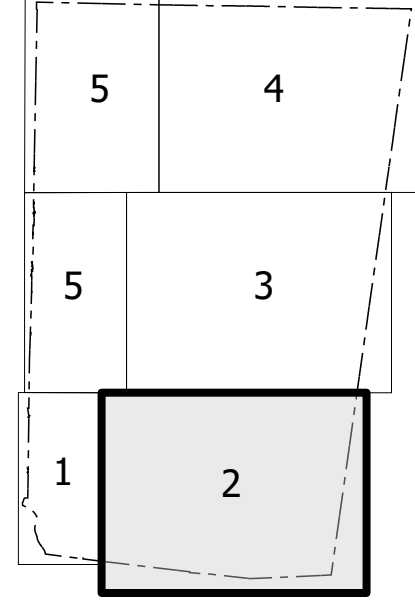

- LEGEND**
- INTERSTATE US NC Divided Hwy Undivided Hwy
  - BLUE RIDGE PARKWAY
  - UNPAVED SURFACED ROAD
  - ROAD W/WEAR SURF ROAD
  - NON-SYSTEM ROAD
  - PROVISIONALLY DRAWN ROAD
  - PROJECT LOCATION
  - INTERSECTION DISTANCE
  - INTERSTATE HIGHWAY
  - U.S. NUMBERED HIGHWAY
  - U.S. NUMBERED BI-CYCLE ROUTE
  - N.C. NUMBERED BI-CYCLE ROUTE
  - INTERSTATE INTERCHANGE NUMBER
  - SECONDARY ROAD NUMBER
  - UTILITY LINES
  - RAILROAD LINE
  - RAILROAD STATION
  - ENSET AREA
  - STATE LINE
  - COUNTY LINE
  - SMOOTHED URBAN BOUNDARIES
  - CITY LIMITS
  - FERRY ROUTE AND RAMP
  - NARROW CREEK OR STREAM
  - WIDE RIVER OR CREEK
  - RESERVOIR, POND OR LAKE W/ ISLAND
  - DAM OR DAM WITH LOCK
  - WATERFALL
  - SWAMP
  - COMMUNITY
  - COUNTY SEAT
  - SCHOOL
  - COLLEGE OR UNIVERSITY
  - HOSPITAL
  - COAST GUARD STATION
  - CHURCH
  - CHURCH WITH CEMETERY
  - CEMETERY
  - RAILROAD STATION
  - CORRECTION OR PENAL INSTITUTION
  - QUARRY
  - MINE OR PIT
  - HIGHWAY GARAGE OR MAINT. YARD
  - WEIGH STATION
  - FAIRGROUNDS
  - HISTORICAL SITE
  - POINTS OF INTEREST
  - POST OFFICE
  - STATE FOREST
  - LIGHTHOUSE
  - MOUNTAIN SUMMIT
  - VIEWING PLATFORM
  - OVERLOOK
  - REST AREA
  - VIEWING PLATFORM
  - WELCOME CENTER AREA
  - AIRPORT
  - MILITARY AIRPORT
  - NATIONAL STATE FOREST BOUNDARY
  - WILDLIFE REFUGE
  - NATIONAL STATE PARK BOUNDARY
  - GAME LANDS BOUNDARY
  - MILITARY RESERVATION BOUNDARY
  - INDIAN RESERVATION BOUNDARY

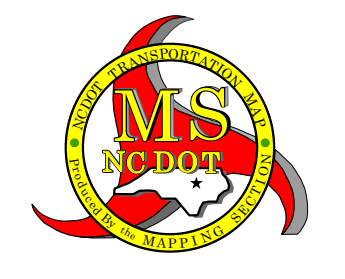
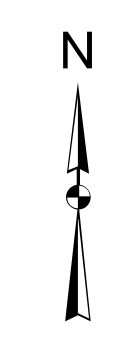

# ORANGE COUNTY NORTH CAROLINA BRIDGE LOCATION MAP

PREPARED BY THE  
NORTH CAROLINA DEPARTMENT OF TRANSPORTATION  
OPERATIONS PROGRAM MANAGEMENT UNIT - MAPPING SECTION  
IN COOPERATION WITH THE  
U.S. DEPARTMENT OF TRANSPORTATION  
FEDERAL HIGHWAY ADMINISTRATION

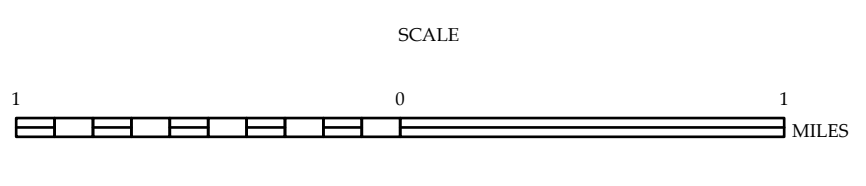

NORTH CAROLINA PLANE COORDINATE SYSTEM  
LAMBERT CONFORMAL CONIC PROJECTION

THIS MAP IS A PUBLIC WORKS PRODUCT OF THE NORTH CAROLINA DEPARTMENT OF TRANSPORTATION. IT IS THE PROPERTY OF THE NORTH CAROLINA DEPARTMENT OF TRANSPORTATION AND IS NOT TO BE REPRODUCED OR TRANSMITTED IN ANY FORM OR BY ANY MEANS, ELECTRONIC OR MECHANICAL, INCLUDING PHOTOCOPYING, RECORDING, OR BY ANY INFORMATION STORAGE AND RETRIEVAL SYSTEM, WITHOUT THE WRITTEN PERMISSION OF THE NORTH CAROLINA DEPARTMENT OF TRANSPORTATION. THE NORTH CAROLINA DEPARTMENT OF TRANSPORTATION IS NOT RESPONSIBLE FOR ANY ERRORS OR OMISSIONS THAT MAY APPEAR IN THIS MAP. THE USER ASSUMES ALL LIABILITY FOR ANY DAMAGE, INCLUDING PERSONAL INJURY OR PROPERTY DAMAGE, ARISING FROM THE USE OF THIS MAP. THE NORTH CAROLINA DEPARTMENT OF TRANSPORTATION IS NOT RESPONSIBLE FOR ANY DAMAGE, INCLUDING PERSONAL INJURY OR PROPERTY DAMAGE, ARISING FROM THE USE OF THIS MAP.

ORANGE COUNTY, NORTH CAROLINA  
BRIDGE LOCATION MAP  
DATE: 08/2014  
BY: [unreadable]



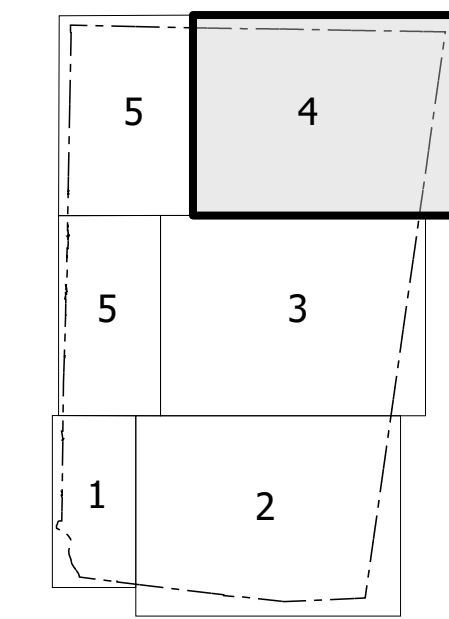

LEGEND

- |                                   |                                   |
|-----------------------------------|-----------------------------------|
| Interstate US NC                  | Divided Hwy                       |
| Blue Ridge Parkway                | Undivided Hwy                     |
| Unpaved Surface Road              | Hard Surface Road                 |
| Non-System Road                   | Professionally Drawn Road         |
| Project Tree Location             | Intersection Distance             |
| Interstate Highway                | U.S. Numbered Highway             |
| U.S. Numbered Bicycle Route       | U.S. Numbered Bicycle Route       |
| N.C. Numbered Bicycle Route       | N.C. Numbered Bicycle Route       |
| Interstate Interchange Number     | Interstate Interchange Number     |
| Secondary Road Number             | Secondary Road Number             |
| Utility Lines                     | Utility Lines                     |
| Railroad Line                     | Railroad Station                  |
| Inset Area                        | Inset Area                        |
| State Line                        | State Line                        |
| County Line                       | County Line                       |
| Smoothed Urban Boundaries         | Smoothed Urban Boundaries         |
| City Limits                       | City Limits                       |
| Ferry Route and Ramp              | Ferry Route and Ramp              |
| Narrow Creek or Stream            | Narrow Creek or Stream            |
| Wide River or Creek               | Wide River or Creek               |
| Reservoir, Pond or Lake w/ Island | Reservoir, Pond or Lake w/ Island |
| Dam or Dam with Lock              | Dam or Dam with Lock              |
| Waterfall                         | Waterfall                         |
| Swamp                             | Swamp                             |
| Community                         | Community                         |
| County Seat                       | County Seat                       |
| School                            | School                            |
| College or University             | College or University             |
| Hospital                          | Hospital                          |
| Coast Guard Station               | Coast Guard Station               |
| Church                            | Church                            |
| Church with Cemetery              | Church with Cemetery              |
| Cemetery                          | Cemetery                          |
| Public Station                    | Public Station                    |
| Correction or Penal Institution   | Correction or Penal Institution   |
| Quarry                            | Quarry                            |
| Mine or Pit                       | Mine or Pit                       |
| Highway Garage or Maint. Yard     | Highway Garage or Maint. Yard     |
| Highway Div. or Dist. Office      | Highway Div. or Dist. Office      |
| Military Post                     | Military Post                     |
| Weigh Station                     | Weigh Station                     |
| Fairgrounds                       | Fairgrounds                       |
| Historical Site                   | Historical Site                   |
| Points of Interest                | Points of Interest                |
| Post Office                       | Post Office                       |
| State Forest                      | State Forest                      |
| Light House                       | Light House                       |
| Mountain Summit                   | Mountain Summit                   |
| Mountain Gap                      | Mountain Gap                      |
| Overlook                          | Overlook                          |
| Rest Area                         | Rest Area                         |
| Visitor Center                    | Visitor Center                    |
| Welcome Center                    | Welcome Center                    |
| Airport                           | Airport                           |
| Military Airport                  | Military Airport                  |
| National State Forest Boundary    | National State Forest Boundary    |
| Wildlife Refuge                   | Wildlife Refuge                   |
| National State Park Boundary      | National State Park Boundary      |
| Game Lands Boundary               | Game Lands Boundary               |
| Military Reservation Boundary     | Military Reservation Boundary     |
| Indian Reservation Boundary       | Indian Reservation Boundary       |

ORANGE COUNTY  
NORTH CAROLINA  
BRIDGE LOCATION MAP

PREPARED BY THE  
NORTH CAROLINA DEPARTMENT OF TRANSPORTATION  
OPERATIONS PROGRAM MANAGEMENT UNIT - MAPPING SECTION  
IN COOPERATION WITH THE  
U.S. DEPARTMENT OF TRANSPORTATION  
FEDERAL HIGHWAY ADMINISTRATION

SCALE  
0 1 MILES

NORTH CAROLINA PLANE COORDINATE SYSTEM  
LAMBERT CONFORMAL CONIC PROJECTION

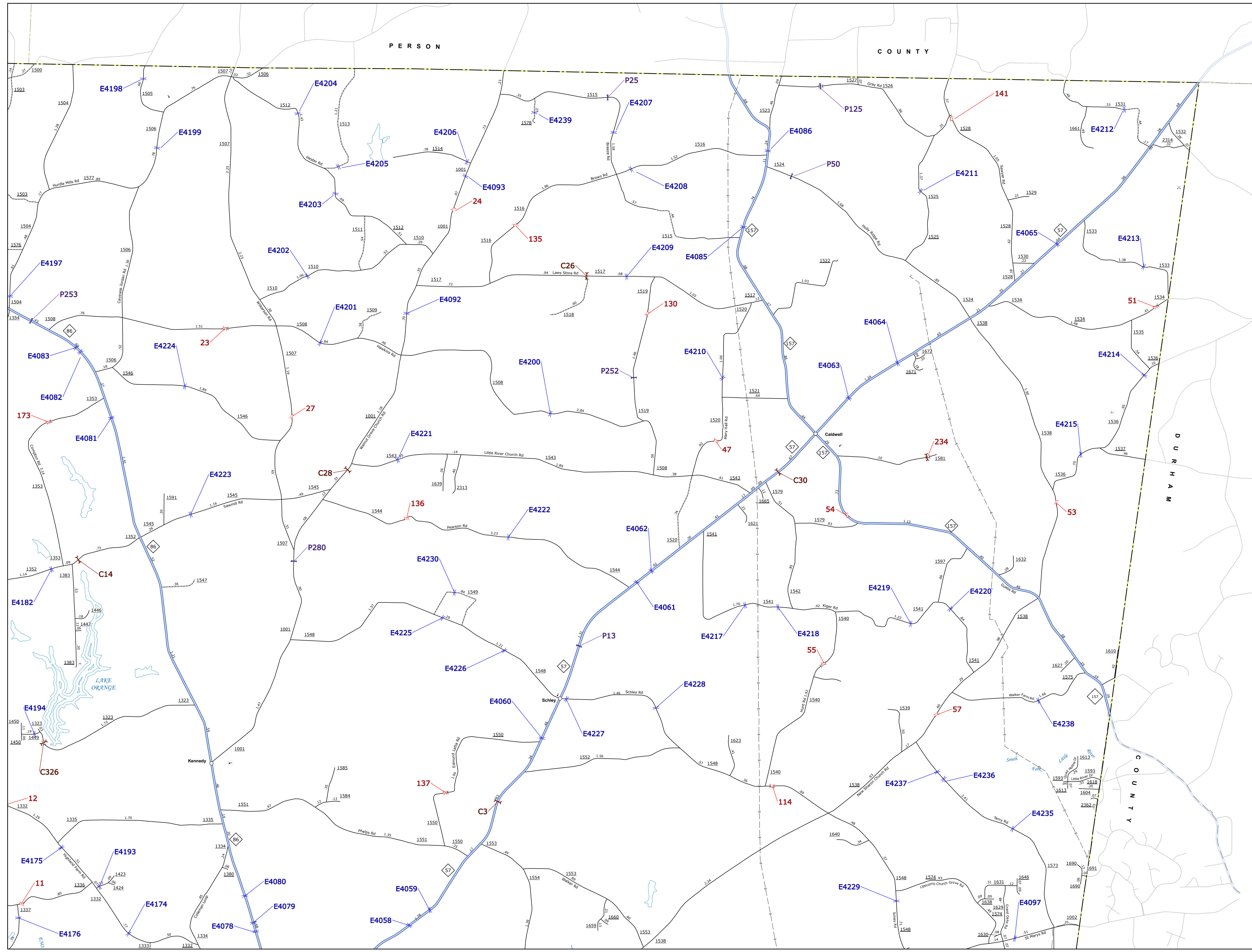

THESE MAPS ARE PROVIDED AS A SERVICE TO THE PUBLIC AND ARE NOT INTENDED TO BE USED FOR LEGAL OR ENGINEERING PURPOSES. THE STATE OF NORTH CAROLINA AND THE NORTH CAROLINA DEPARTMENT OF TRANSPORTATION MAKE NO REPRESENTATION OR WARRANTY AS TO THE ACCURACY OR COMPLETENESS OF THE DATA PROVIDED HEREON. THE USER ASSUMES ALL LIABILITY FOR ANY INACCURACIES OR OMISSIONS. THE DATA IS PROVIDED "AS IS" WITHOUT WARRANTY OF ANY KIND, INCLUDING WARRANTIES OF MERCHANTABILITY AND FITNESS FOR A PARTICULAR PURPOSE. THE USER AGREES TO HOLD THE STATE OF NORTH CAROLINA AND THE NORTH CAROLINA DEPARTMENT OF TRANSPORTATION HARMLESS FROM AND AGAINST ALL SUCH LIABILITY.

