

LEGEND

- INTERSTATE US NC Divided Hwy Undivided Hwy
- BLUE RIDGE PARKWAY UNPAVED SURFACED ROAD
- HARD SURFACED ROAD NON-SYSTEM ROAD
- PROVISIONALLY DRAWN ROAD PROJECTED LOCATION INTERSECTION DISTANCE
- INTERSTATE HIGHWAY U.S. NUMBERED HIGHWAY N.C. NUMBERED HIGHWAY U.S. NUMBERED BICYCLE ROUTE N.C. NUMBERED BICYCLE ROUTE INTERSTATE INTERCHANGE NUMBER SECONDARY ROAD NUMBER
- UTILITY LINES RAILROAD LINE RAILROAD STATION INSET AREA STATE LINE COUNTY LINE SMOOTHED URBAN BOUNDARIES CITY LIMITS FERRY ROUTE AND RAMP NARROW CREEK OR STREAM WIDE RIVER OR CREEK RESERVOIR, POND OR LAKE W/ ISLAND DAM OR DAM WITH LOCK WATERFALL SWAMP
- COMMUNITY COUNTY SEAT SCHOOL COLLEGE OR UNIVERSITY HOSPITAL COAST GUARD STATION CHURCH CHURCH WITH CEMETERY CEMETERY PATROL STATION CORRECTION OR PENAL INSTITUTION QUARRY MINE OR PIT HIGHWAY GARAGE OR MAINT. YARD HIGHWAY DIV. OR DIST. OFFICE MILITARY POST WEIGH STATION FAIRGROUNDS HISTORICAL SITE POINTS OF INTEREST POST OFFICE STATE FOREST LIGHTHOUSE MOUNTAIN SUMMIT MOUNTAIN GAP OVERLOOK REST AREA VISITOR CTR./REST AREA WELCOME CTR./REST AREA AIRPORT MILITARY AIRPORT
- NATIONAL / STATE FOREST BOUNDARY WILDLIFE REFUGE NATIONAL / STATE PARK BOUNDARY GAME LANDS BOUNDARY MILITARY RESERVATION BOUNDARY INDIAN RESERVATION BOUNDARY

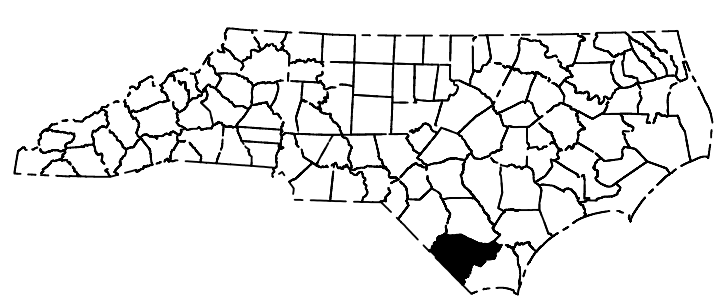
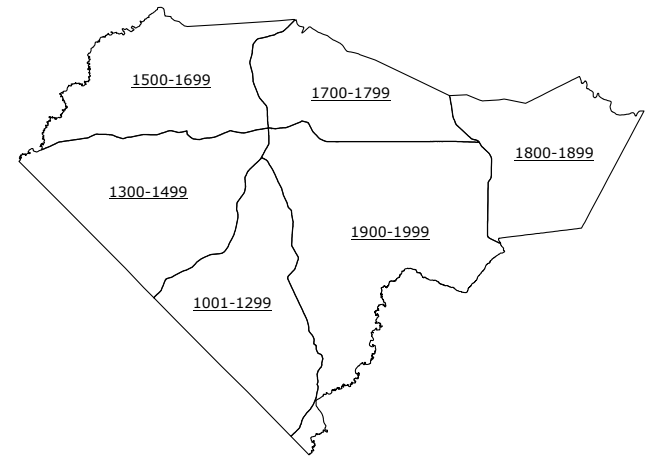
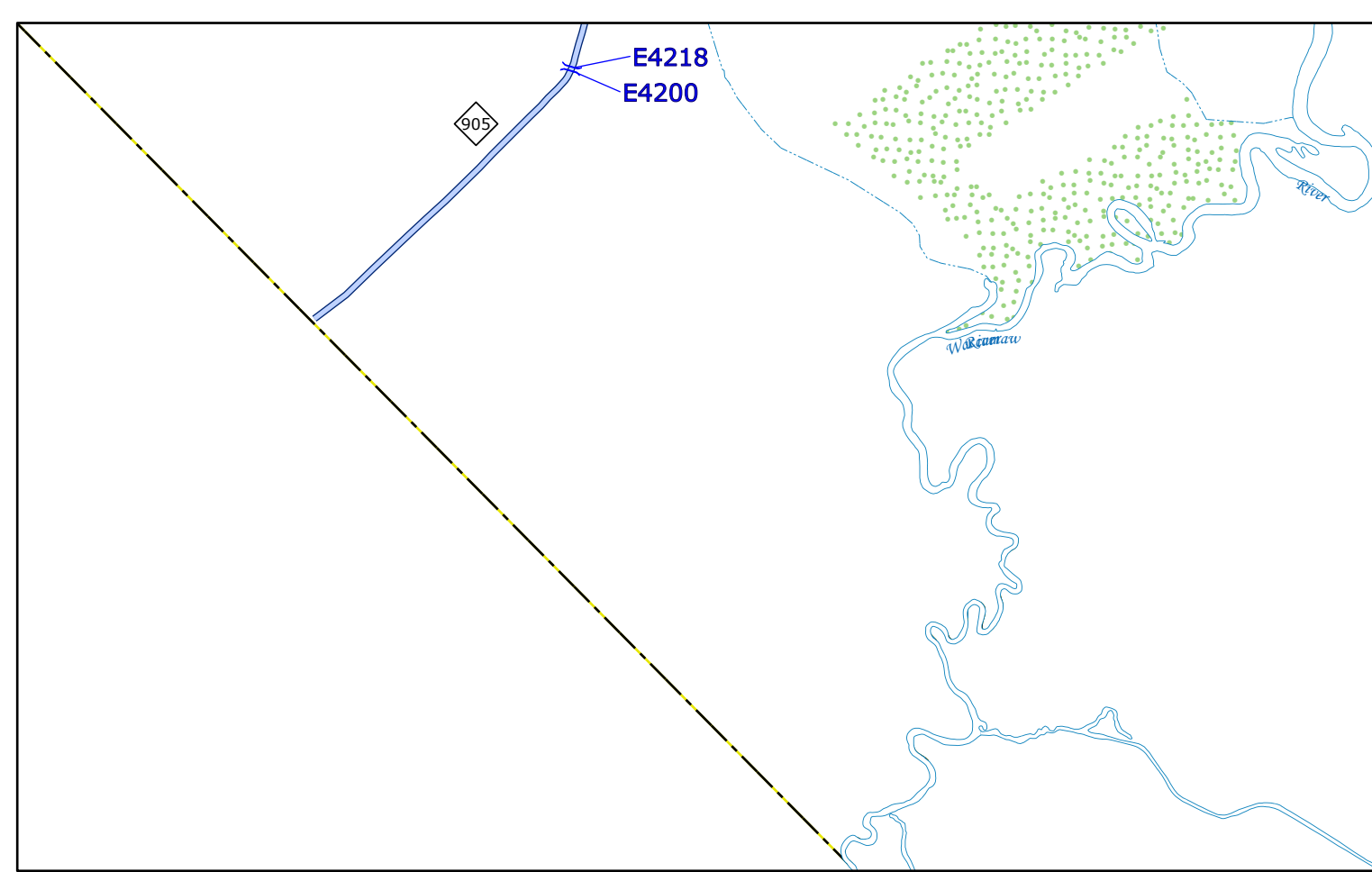
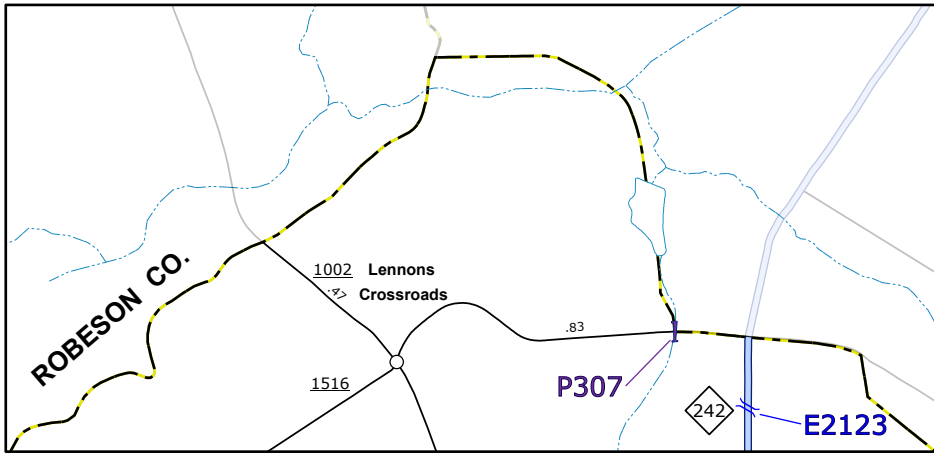

COLUMBUS COUNTY
NORTH CAROLINA
BRIDGE LOCATION MAP

PREPARED BY THE
NORTH CAROLINA DEPARTMENT OF TRANSPORTATION
OPERATIONS PROGRAM MANAGEMENT UNIT - MAPPING SECTION
IN COOPERATION WITH THE
U.S. DEPARTMENT OF TRANSPORTATION
FEDERAL HIGHWAY ADMINISTRATION

SCALE
1 0 1 2 3 4
MILES

SCALE FOR ENLARGEMENTS
1 0 1 2 3 4
MILES

NORTH CAROLINA PLANE COORDINATE SYSTEM
LAMBERT CONFORMAL CONIC PROJECTION

SHEET 1 OF 9

COPIES OF THIS MAP ARE AVAILABLE TO THE
PUBLIC AT MINIMAL COST. CONTACT US TO ORDER:
mapsupport@ncdot.gov
<https://www.ncdot.gov/resources/State-Mapping/Pages/Ordering-Maps.aspx>
(919) 634-5480

TERMS OF USE: The Mapping Section's goal is to provide the most accurate and current information possible. Map data is compiled from numerous sources with varying dates of publication and map accuracy standards. As a result, the accuracy, currency and completeness of the data provided will vary. The North Carolina Department of Transportation shall not be held liable for any errors in the map data. This map cannot be construed to be a legal document. The information shown on this map was last updated in June 2025. For digital copies of this map or additional map products, visit <https://www.ncdot.gov/resources/State-Mapping>.

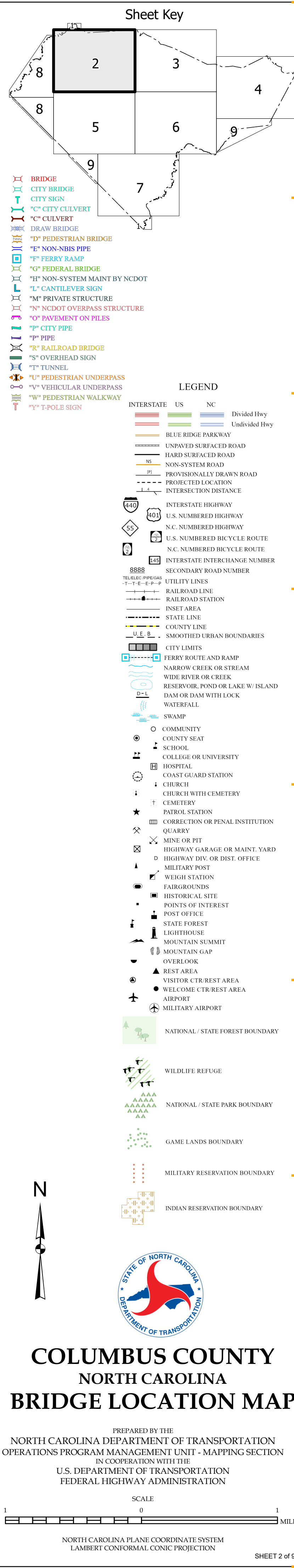

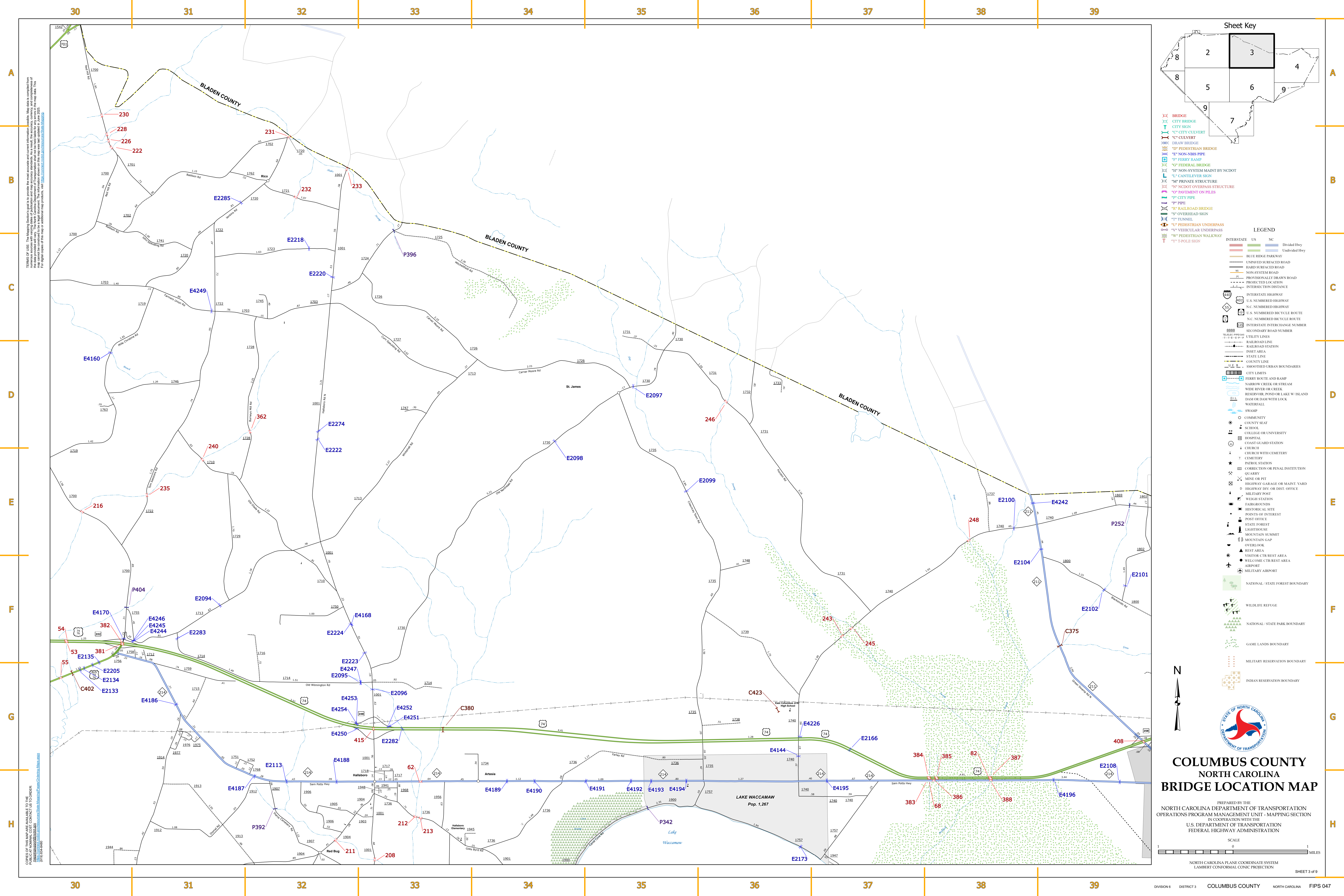

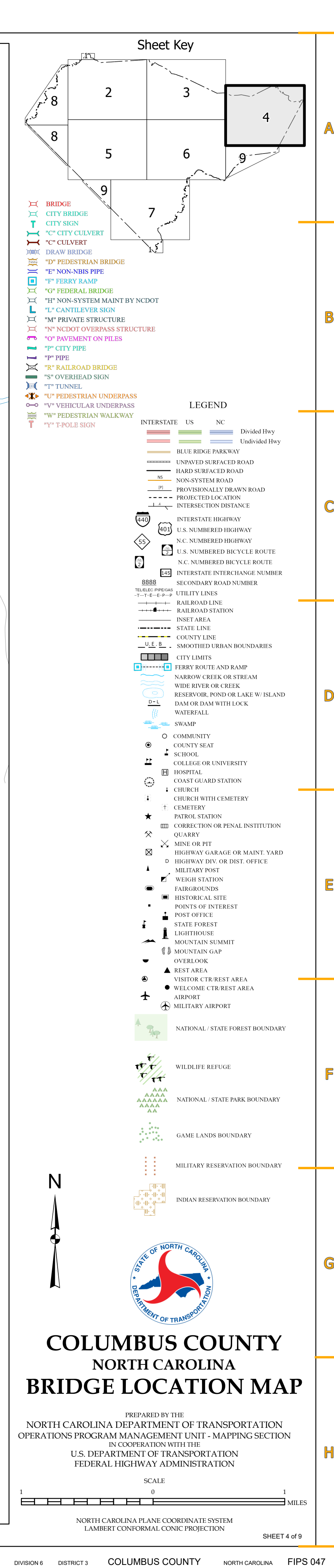
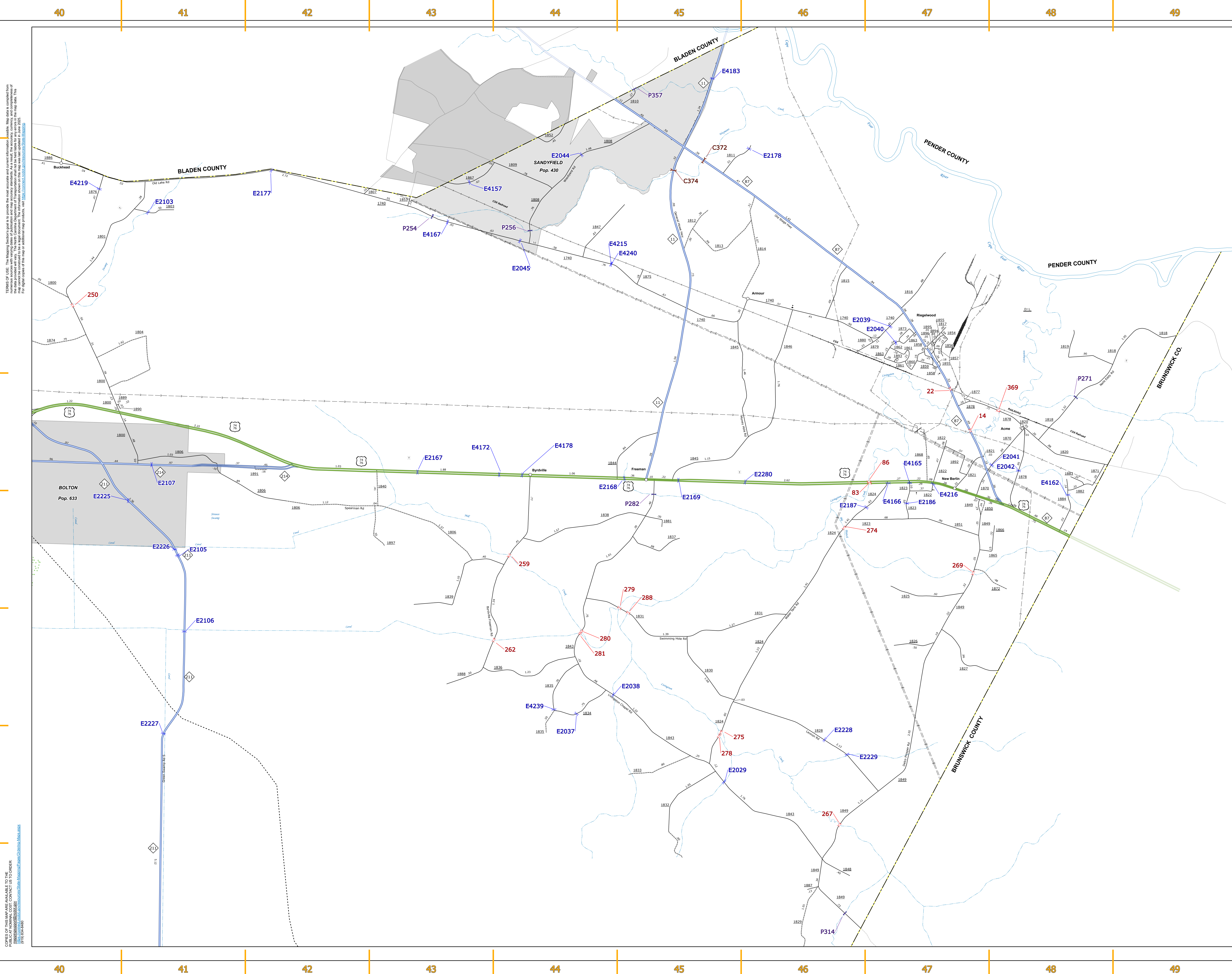

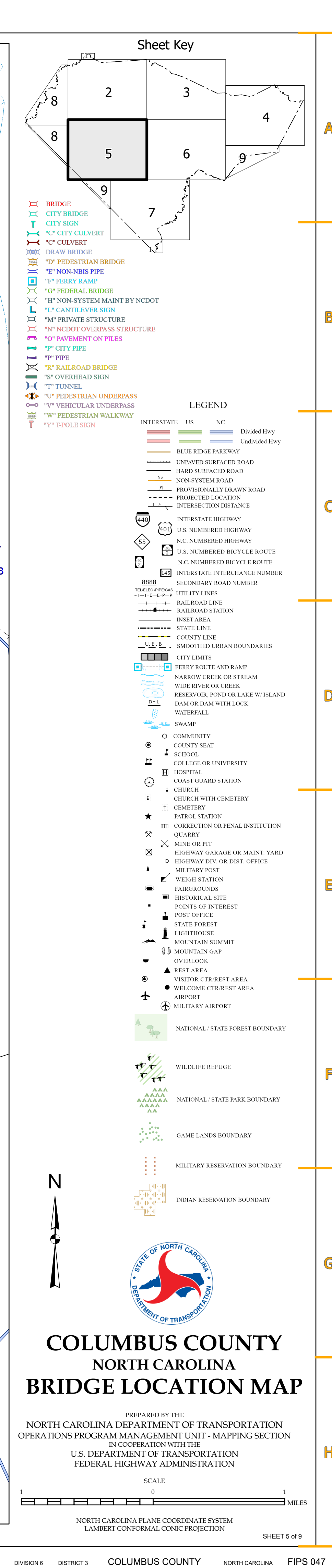
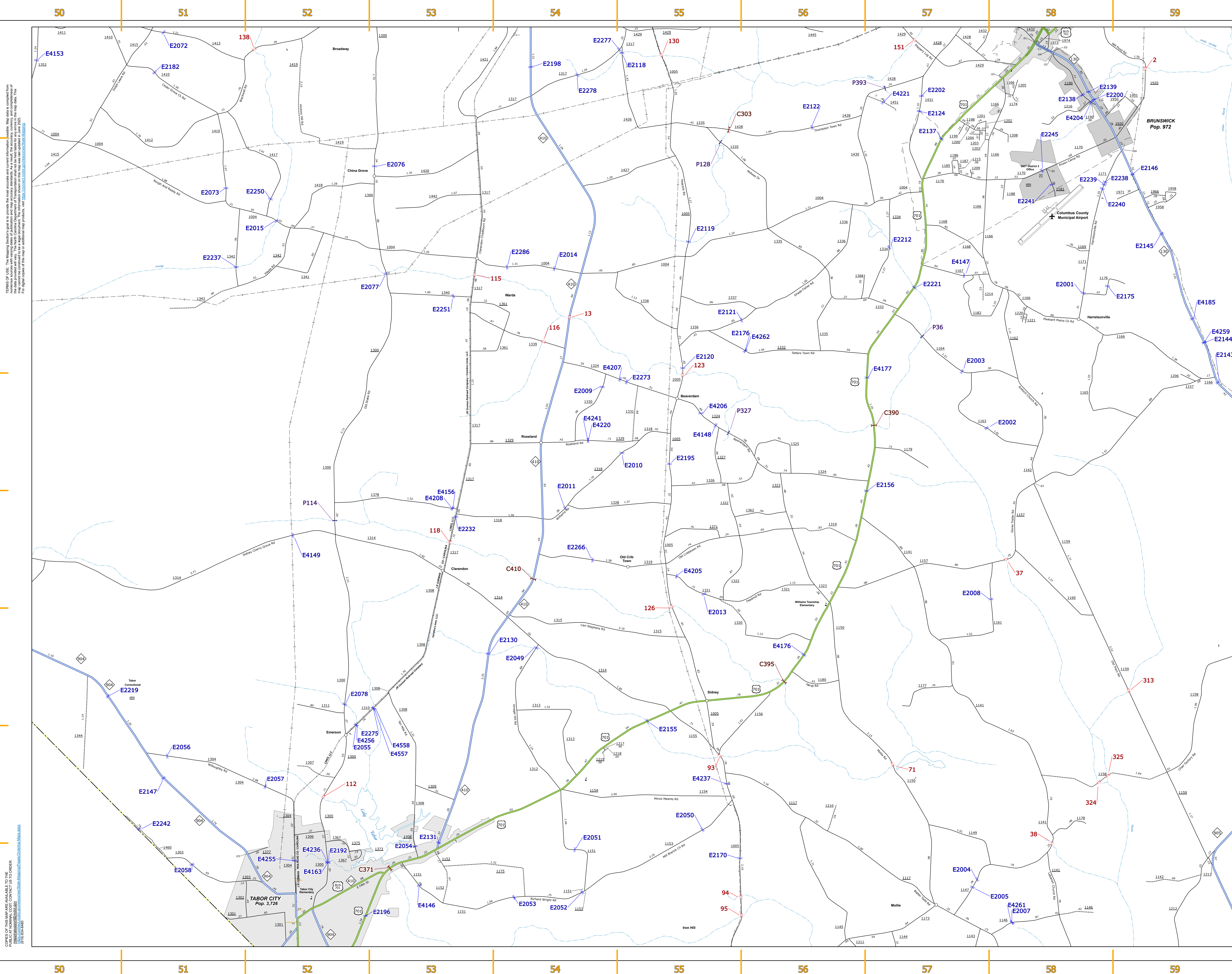

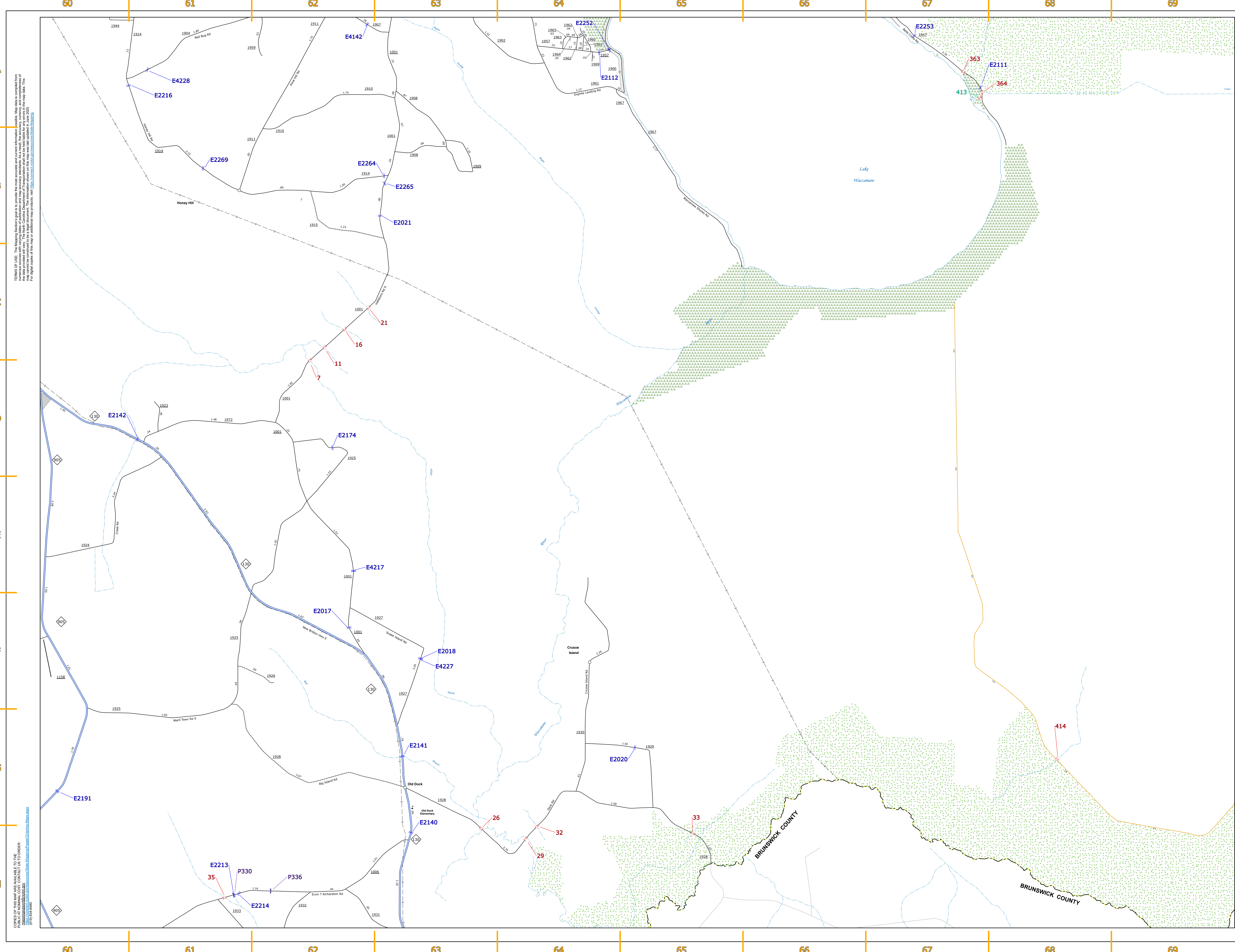

Sheet Key

BRIDGE

CITY BRIDGE

CITY SIGN

CITY CULVERT

CULVERT

DRAW BRIDGE

FEDERAL BRIDGE

NON-SYSTEM BRIDGE

NON-SYSTEM MAINT BY NCDOT

CANTILEVER SIGN

PRIVATE STRUCTURE

NCDOT OVERPASS STRUCTURE

PAVEMENT ON PILES

CITY PIPE

PIPE

RAILROAD BRIDGE

OVERHEAD SIGN

TUNNEL

PEDESTRIAN UNDERPASS

VEHICULAR UNDERPASS

PEDESTRIAN WALKWAY

T-POLE SIGN

LEGEND

INTERSTATE US NC

Divided Hwy

Undivided Hwy

BLUE RIDGE PARKWAY

UNPAVED SURFACED ROAD

HARD SURFACED ROAD

NON-SYSTEM ROAD

PROVISIONALLY DRAWN ROAD

PROTECTED LOCATION

INTERSECTION DISTANCE

INTERSTATE HIGHWAY

U.S. NUMBERED HIGHWAY

N.C. NUMBERED HIGHWAY

U.S. NUMBERED BICYCLE ROUTE

N.C. NUMBERED BICYCLE ROUTE

INTERSTATE INTERCHANGE NUMBER

SECONDARY ROAD NUMBER

UTILITY LINES

RAILROAD LINE

RAILROAD STATION

INSET AREA

STATE LINE

COUNTY LINE

SMOOTHED URBAN BOUNDARIES

CITY LIMITS

FERRY WHARF AND RAMP

NARROW CREEK OR STREAM

WIDE RIVER OR CREEK

RESERVOIR, POND OR LAKE W/ ISLAND

DAM OR DAM WITH LOCK

WATERFALL

SWAMP

COMMUNITY

COUNTY SEAT

SCHOOL

COLLEGE OR UNIVERSITY

HOSPITAL

COAST GUARD STATION

CHURCH

CHURCH WITH CEMETERY

CEMETERY

PATROL STATION

CORRECTION OR PENAL INSTITUTION

QUARRY

MINE OR PIT

HIGHWAY GARAGE OR MAINT. YARD

HIGHWAY DIV. OR DIST. OFFICE

MILITARY POST

WEIGH STATION

FAIRGROUNDS

HISTORICAL SITE

POINTS OF INTEREST

POST OFFICE

STATE FOREST

LIGHTHOUSE

MOUNTAIN SUMMIT

MOUNTAIN GAP

OVERLOOK

REST AREA

VISITOR CTR./REST AREA

WELCOME CTR./REST AREA

AIRPORT

MILITARY AIRPORT

NATIONAL / STATE FOREST BOUNDARY

WILDLIFE REFUGE

NATIONAL / STATE PARK BOUNDARY

GAME LANDS BOUNDARY

MILITARY RESERVATION BOUNDARY

INDIAN RESERVATION BOUNDARY

N

COLUMBUS COUNTY
NORTH CAROLINA
BRIDGE LOCATION MAP

PREPARED BY THE
NORTH CAROLINA DEPARTMENT OF TRANSPORTATION
OPERATIONS PROGRAM MANAGEMENT UNIT - MAPPING SECTION
IN COOPERATION WITH THE
U.S. DEPARTMENT OF TRANSPORTATION
FEDERAL HIGHWAY ADMINISTRATION

SCALE
1 0 1
MILES

NORTH CAROLINA PLANE COORDINATE SYSTEM
LAMBERT CONFORMAL CONIC PROJECTION

SHEET 6 of 9

DIVISION 6 DISTRICT 3 COLUMBUS COUNTY NORTH CAROLINA FIPS 047

TERMS OF USE: The Mapping Section's goal is to provide the most accurate and current information available. Map data is compiled from numerous sources with varying degrees of publication and map accuracy. Periodically, data is updated, the accuracy, currency, and completeness of map content is reviewed, and the map is updated. The information shown on the map was last updated in June 2025.

COPIES OF THIS MAP ARE AVAILABLE TO THE PUBLIC AT NO CHARGE. CONTACT US TO ORDER: 919.847.4460

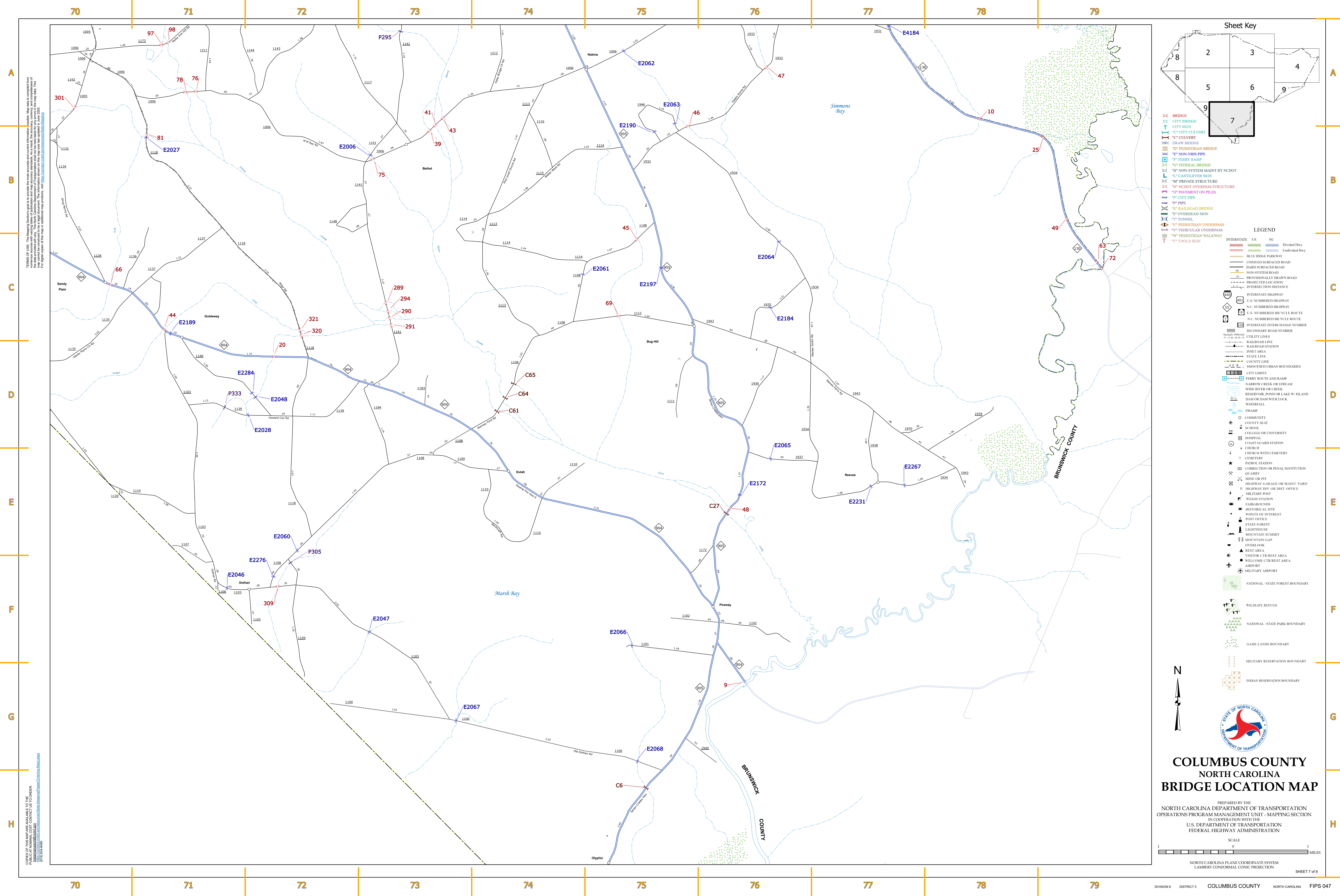

TERMS OF USE: The Mapping Services Unit is to provide the most accurate and current information possible. Map data is compiled from numerous sources with varying degrees of publication and map accuracy statements. As a result, the accuracy, currency, and completeness of the information shown on this map cannot be guaranteed. The information shown on this map was last updated in June 2025. For digital copies of this map or additional map products, visit <https://www.ncdot.gov/transportation/mapping-services>.

COPIES OF THIS MAP ARE AVAILABLE TO THE PUBLIC AT NO ADDITIONAL COST. CONTACT US TO ORDER: maps@ncdot.gov or [1-800-344-4444](tel:1800344444).

- BRIDGE
- CITY BRIDGE
- CITY SIGN
- "C" CITY CULVERT
- "C" CULVERT
- DRAW BRIDGE
- "D" PEDESTRIAN BRIDGE
- "E" NON-NBIS PIPE
- "F" FERRY RAMP
- "G" FEDERAL BRIDGE
- "H" NON-SYSTEM MAINT BY NCDOT
- "L" CANTILEVER SIGN
- "M" PRIVATE STRUCTURE
- "N" NCDOT OVERPASS STRUCTURE
- "O" PAVEMENT ON PILES
- "P" CITY PIPE
- "P" PIPE
- "R" RAILROAD BRIDGE
- "S" OVERHEAD SIGN
- "T" TUNNEL
- "U" PEDESTRIAN UNDERPASS
- "V" VEHICULAR UNDERPASS
- "W" PEDESTRIAN WALKWAY
- "Y" T-POLE SIGN

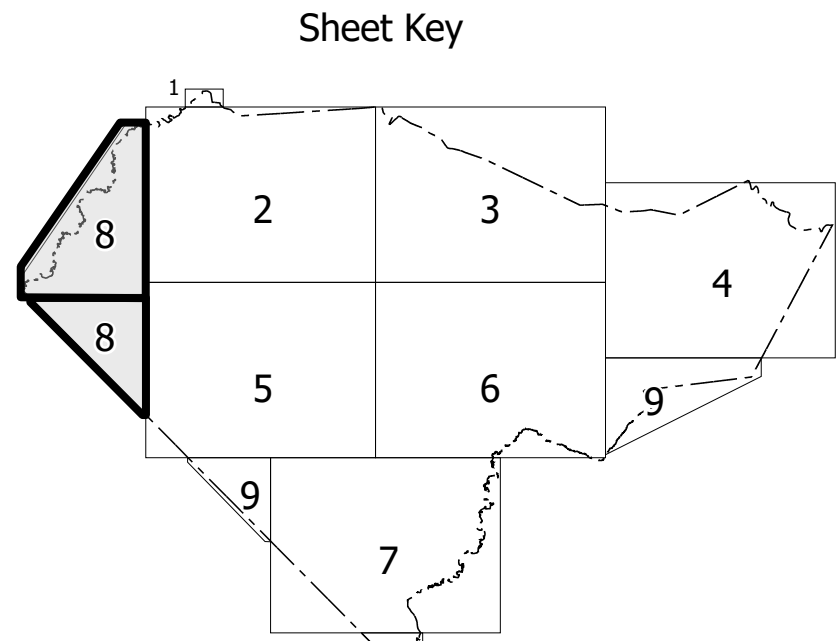

- LEGEND
- INTERSTATE
 - US
 - NC
 - Divided Hwy
 - Undivided Hwy
 - BLUE RIDGE PARKWAY
 - UNPAVED SURFACED ROAD
 - HARD SURFACED ROAD
 - NON-SYSTEM ROAD
 - PROVISIONALLY DRAWN ROAD
 - PROTECTED LOCATION
 - INTERSECTION DISTANCE
 - INTERSTATE HIGHWAY
 - U.S. NUMBERED HIGHWAY
 - N.C. NUMBERED HIGHWAY
 - U.S. NUMBERED BICYCLE ROUTE
 - N.C. NUMBERED BICYCLE ROUTE
 - INTERSTATE INTERCHANGE NUMBER
 - SECONDARY ROAD NUMBER
 - UTILITY LINES
 - RAILROAD LINE
 - RAILROAD STATION
 - STATE LINE
 - COUNTY LINE
 - SMOOTHED URBAN BOUNDARIES
 - CITY LIMITS
 - FERRY ROUTE AND RAMP
 - NARROW CREEK OR STREAM
 - WIDE RIVER OR CREEK
 - RESERVOIR, POND OR LAKE W/ ISLAND
 - DAM OR DAM WITH LOCK
 - WATERFALL
 - SWAMP
 - COMMUNITY
 - COUNTY SEAT
 - SCHOOL
 - COLLEGE OR UNIVERSITY
 - HOSPITAL
 - COAST GUARD STATION
 - CHURCH
 - CHURCH WITH CEMETERY
 - CEMETERY
 - PATROL STATION
 - CORRECTION OR PENAL INSTITUTION
 - QUARRY
 - MINE OR PIT
 - HIGHWAY GARAGE OR MAINT. YARD
 - HIGHWAY DIV. OR DIST. OFFICE
 - MILITARY POST
 - WEIGH STATION
 - FAIRGROUNDS
 - HISTORICAL SITE
 - POINTS OF INTEREST
 - POST OFFICE
 - STATE FOREST
 - LIGHTHOUSE
 - MOUNTAIN SUMMIT
 - MOUNTAIN GAP
 - OVERLOOK
 - REST AREA
 - VISITOR CTR/REST AREA
 - WELCOME CTR/REST AREA
 - AIRPORT
 - MILITARY AIRPORT
 - NATIONAL / STATE FOREST BOUNDARY
 - WILDLIFE REFUGE
 - NATIONAL / STATE PARK BOUNDARY
 - GAME LANDS BOUNDARY
 - MILITARY RESERVATION BOUNDARY
 - INDIAN RESERVATION BOUNDARY



COLUMBUS COUNTY NORTH CAROLINA BRIDGE LOCATION MAP

PREPARED BY THE
NORTH CAROLINA DEPARTMENT OF TRANSPORTATION
OPERATIONS PROGRAM MANAGEMENT UNIT - MAPPING SECTION
IN COOPERATION WITH THE
U.S. DEPARTMENT OF TRANSPORTATION
FEDERAL HIGHWAY ADMINISTRATION

SCALE
0 1 MILES

NORTH CAROLINA PLANE COORDINATE SYSTEM
LAMBERT CONFORMAL CONIC PROJECTION

SHEET 8 of 9

TERMS OF USE: The Mapping Services' goal is to provide the most accurate and current information possible. Map data is compiled from numerous sources with varying dates of publication and map accuracy standards. As a result, the accuracy, currency and completeness of the information shown on this map cannot be guaranteed. The information shown on this map was last updated in June 2025. For additional information or to request a different map product, visit <https://www.ncdot.gov/transportation/mapping-services>.

COPIES OF THIS MAP ARE AVAILABLE TO THE PUBLIC AT NO CHARGE. CONTACT US TO ORDER: MappingServices@ncdot.gov OR 1-800-662-4440

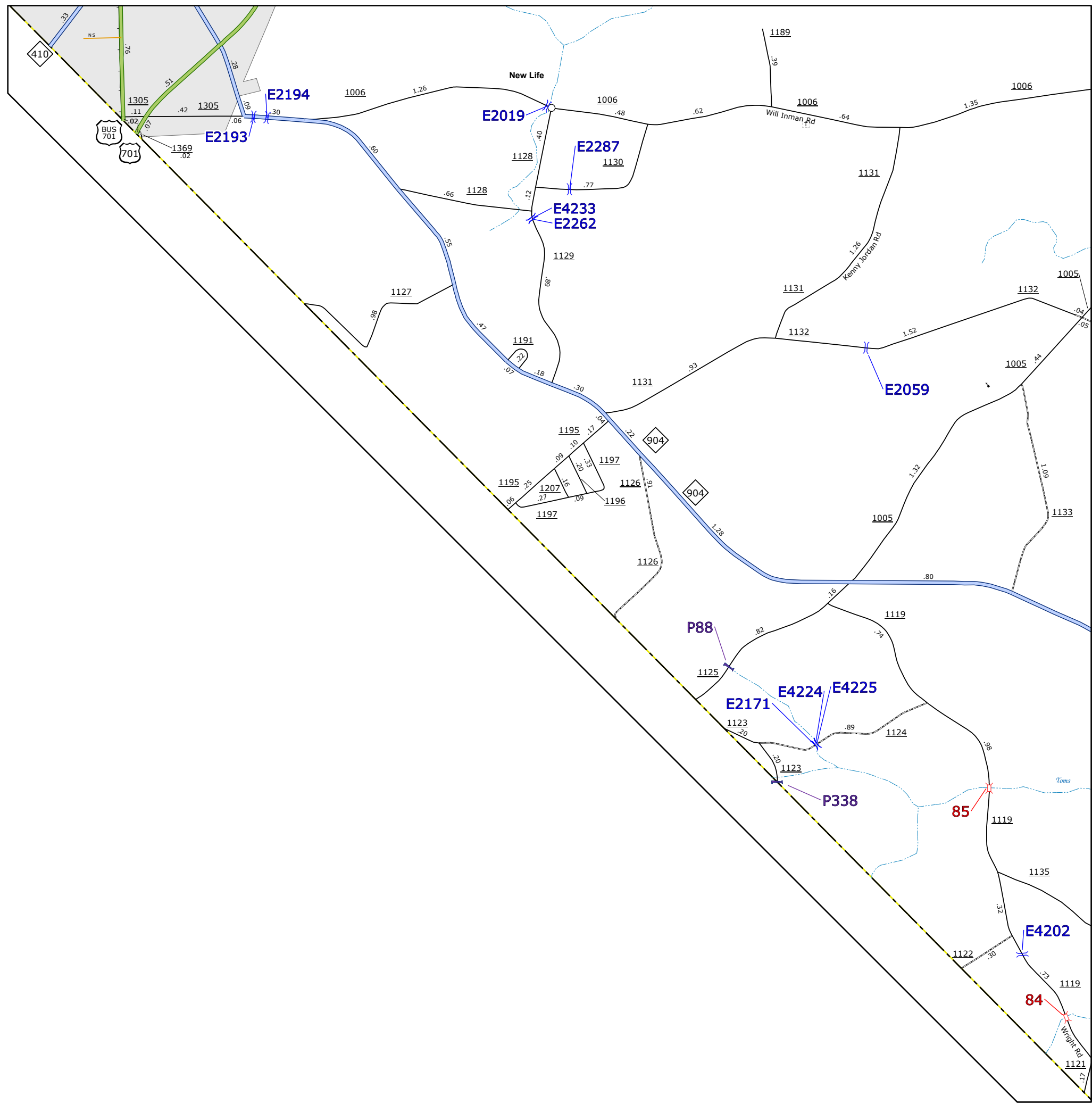
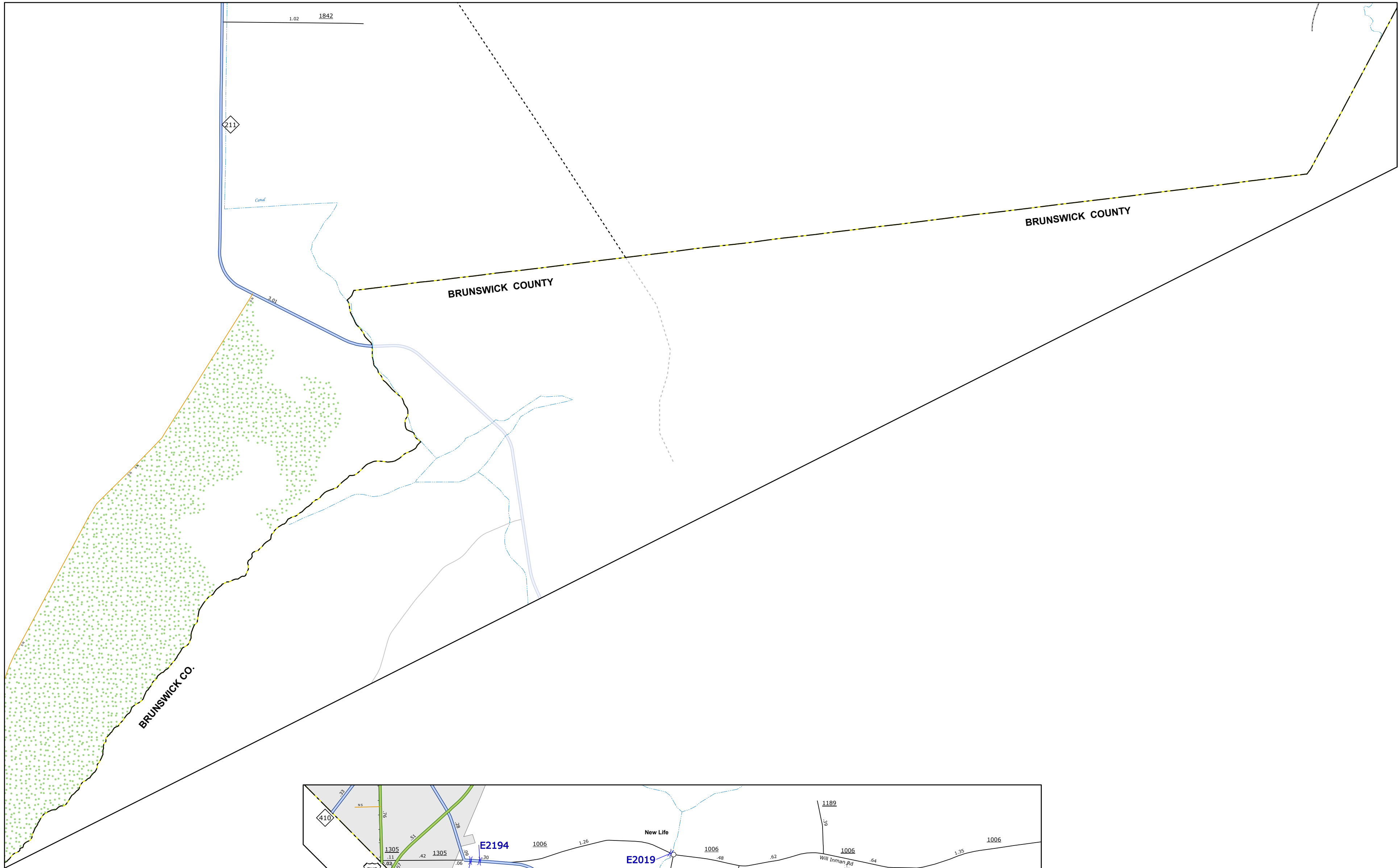

- BRIDGE
- CITY BRIDGE
- CITY SIGN
- "C" CITY CULVERT
- "C" CULVERT
- DRAW BRIDGE
- "D" PEDESTRIAN BRIDGE
- "E" NON-NBIS PIPE
- "F" FERRY RAMP
- "G" FEDERAL BRIDGE
- "H" NON-SYSTEM MAINT BY NCDOT
- "L" CANTILEVER SIGN
- "M" PRIVATE STRUCTURE
- "N" NCDOT OVERPASS STRUCTURE
- "O" PAVEMENT ON PILES
- "P" CITY PIPE
- "P" PIPE
- "R" RAILROAD BRIDGE
- "S" OVERHEAD SIGN
- "T" TUNNEL
- "U" PEDESTRIAN UNDERPASS
- "V" VEHICULAR UNDERPASS
- "W" PEDESTRIAN WALKWAY
- "Y" T-POLE SIGN

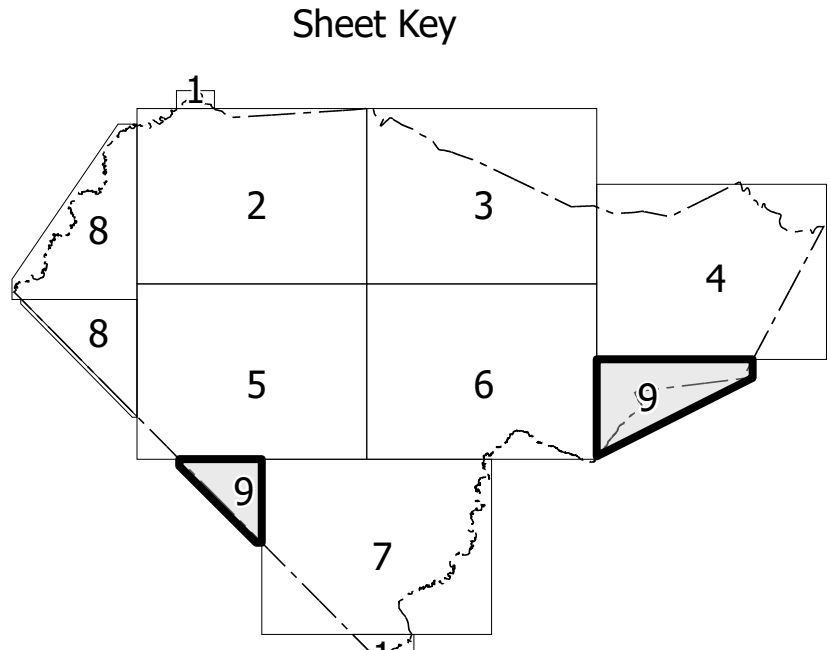

- LEGEND
- INTERSTATE
 - US
 - NC
 - Divided Hwy
 - Undivided Hwy
 - BLUE RIDGE PARKWAY
 - UNPAVED SURFACED ROAD
 - HARD SURFACED ROAD
 - NON-SYSTEM ROAD
 - PROVISIONALLY DRAWN ROAD
 - PROJECTED LOCATION
 - INTERSECTION DISTANCE
 - INTERSTATE HIGHWAY
 - U.S. NUMBERED HIGHWAY
 - N.C. NUMBERED HIGHWAY
 - U.S. NUMBERED BICYCLE ROUTE
 - N.C. NUMBERED BICYCLE ROUTE
 - INTERSTATE INTERCHANGE NUMBER
 - SECONDARY ROAD NUMBER
 - UTILITY LINES
 - RAILROAD LINE
 - RAILROAD STATION
 - INSET AREA
 - STATE LINE
 - COUNTY LINE
 - SMOOTHED URBAN BOUNDARIES
 - CITY LIMITS
 - FERRY ROUTE AND RAMP
 - NARROW CREEK OR STREAM
 - WIDE RIVER OR CREEK
 - RESERVOIR, POND OR LAKE W/ ISLAND
 - DAM OR DAM WITH LOCK
 - WATERFALL
 - SWAMP
 - COMMUNITY
 - COUNTY SEAT
 - SCHOOL
 - COLLEGE OR UNIVERSITY
 - HOSPITAL
 - COAST GUARD STATION
 - CHURCH
 - CHURCH WITH CEMETERY
 - CEMETERY
 - PATROL STATION
 - CORRECTION OR PENAL INSTITUTION
 - QUARRY
 - MINE OR PIT
 - HIGHWAY GARAGE OR MAINT. YARD
 - HIGHWAY DIV. OR DIST. OFFICE
 - MILITARY POST
 - WEIGH STATION
 - FAIRGROUNDS
 - HISTORICAL SITE
 - POINTS OF INTEREST
 - POST OFFICE
 - STATE FOREST
 - LIGHTHOUSE
 - MOUNTAIN SUMMIT
 - MOUNTAIN GAP
 - OVERLOOK
 - REST AREA
 - VISITOR CTR/REST AREA
 - WELCOME CTR/REST AREA
 - AIRPORT
 - MILITARY AIRPORT
 - NATIONAL / STATE FOREST BOUNDARY
 - WILDLIFE REFUGE
 - NATIONAL / STATE PARK BOUNDARY
 - GAME LANDS BOUNDARY
 - MILITARY RESERVATION BOUNDARY
 - INDIAN RESERVATION BOUNDARY



COLUMBUS COUNTY NORTH CAROLINA BRIDGE LOCATION MAP

PREPARED BY THE
NORTH CAROLINA DEPARTMENT OF TRANSPORTATION
OPERATIONS PROGRAM MANAGEMENT UNIT - MAPPING SECTION
IN COOPERATION WITH THE
U.S. DEPARTMENT OF TRANSPORTATION
FEDERAL HIGHWAY ADMINISTRATION

