

COPIES OF THIS MAP ARE AVAILABLE
TO THE PUBLIC AT A NOMINAL COST
ADDRESS:
N.C. DEPARTMENT OF TRANSPORTATION
GIS/CARTOGRAPHIC INFORMATION SYSTEMS
3000 CAMDEN DRIVE, SUITE 100
RALEIGH, N.C. 27610

REVISED
10/1001 MEIN
1/28/02 RLN
3/28/03 RLN
7/20/04 RLN

WARREN

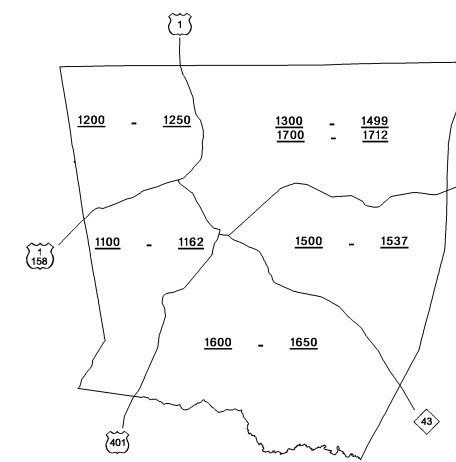
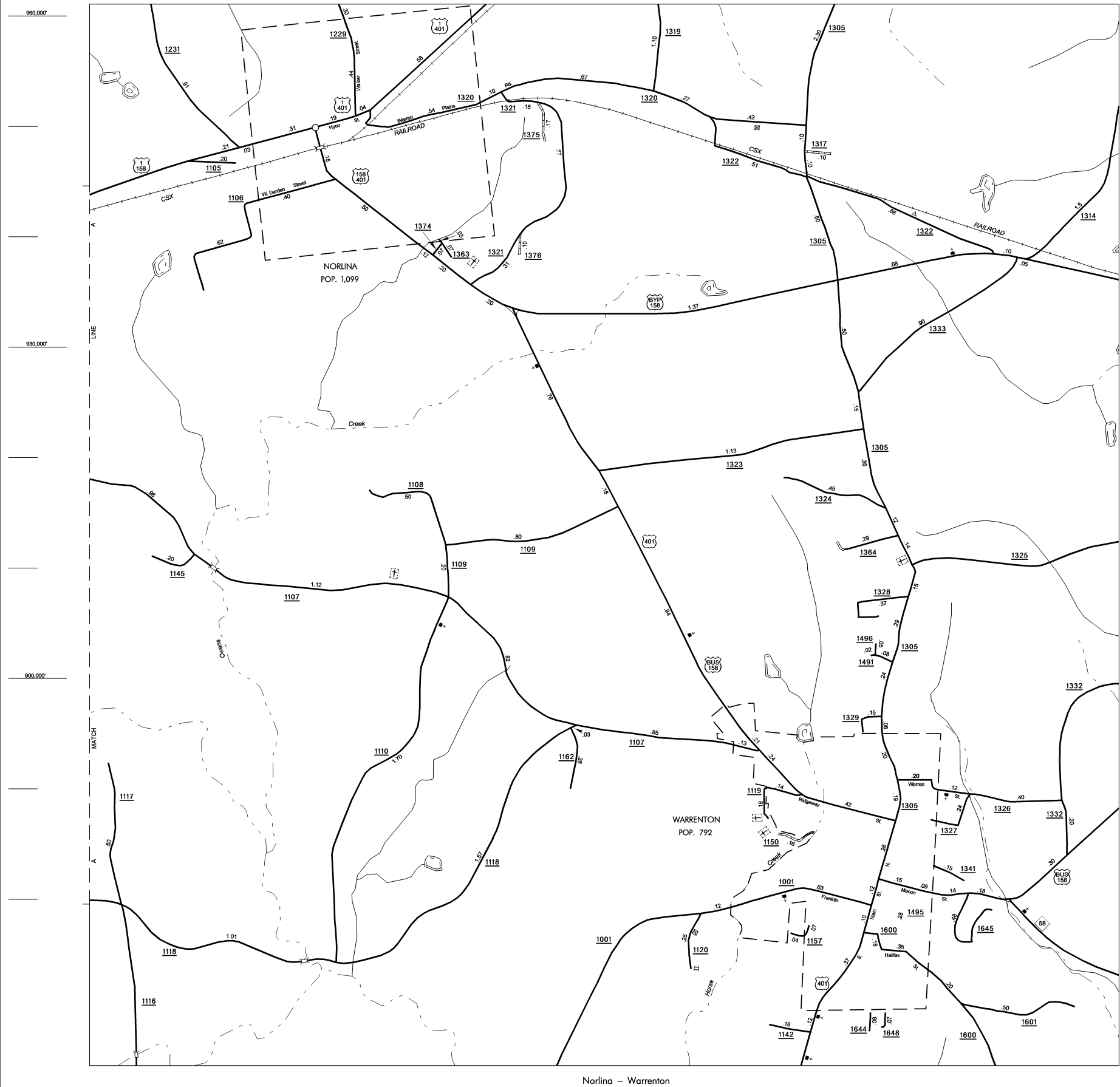
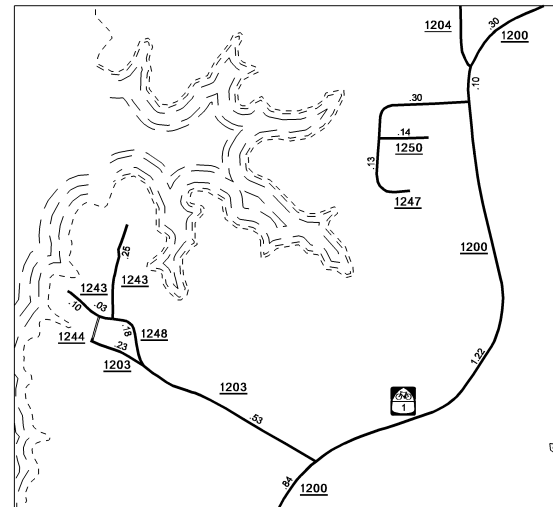
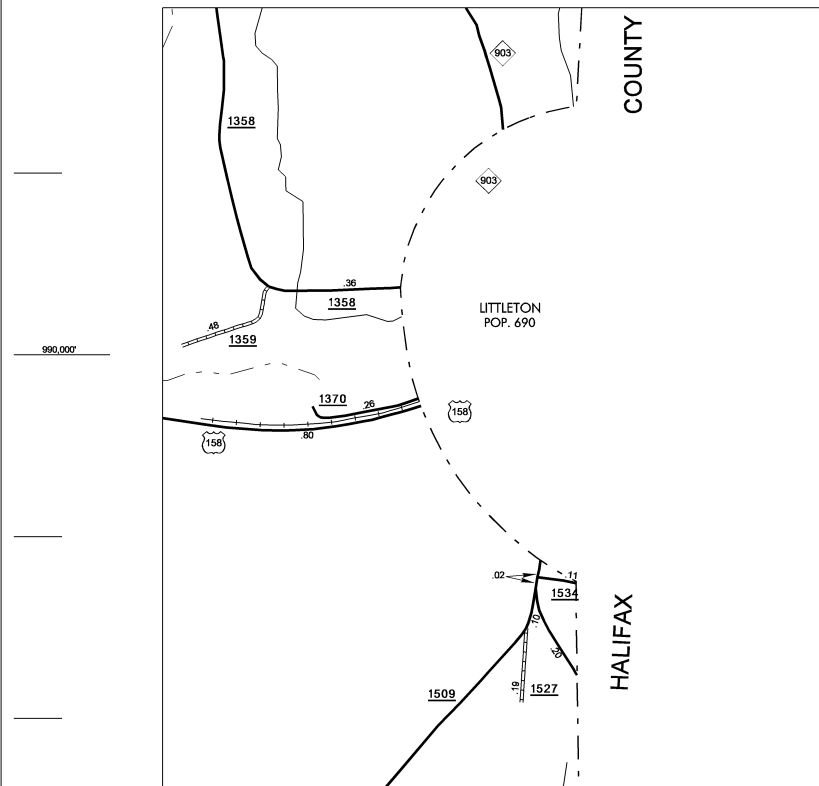
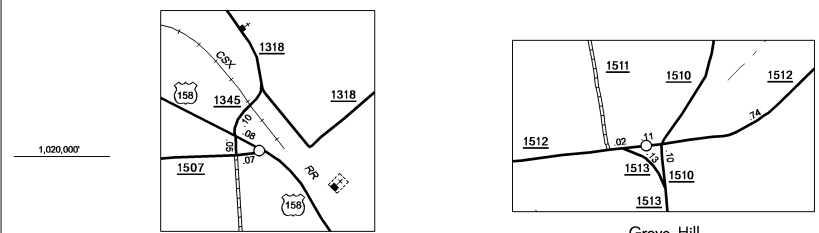

KEY TO COUNTY ROAD NUMBERS
ALSO NUMBER 1001

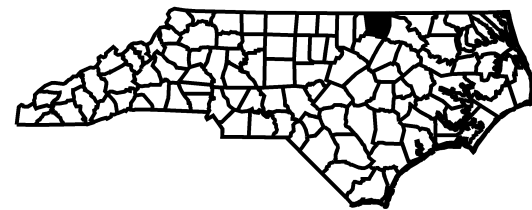

NOTE : MAP INCLUDES ONLY STATE MAINTAINED ROADS
OR IMPORTANT NON-SYSTEM ROADS.
MILEAGE NOT SHOWN ON FRONTAGE ROADS.
ROADS SHOWN AS OF MAR. 28, 2003



WARREN COUNTY

NORTH CAROLINA

PREPARED BY THE
NORTH CAROLINA DEPARTMENT OF TRANSPORTATION
DIVISION OF HIGHWAYS - GIS UNIT

IN COOPERATION WITH THE
U.S. DEPARTMENT OF TRANSPORTATION
FEDERAL HIGHWAY ADMINISTRATION

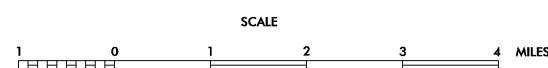

10,000 FOOT GRID BASED ON NORTH CAROLINA PLANE COORDINATE SYSTEM
POLYCONIC PROJECTION