

COPIES OF THIS MAP ARE AVAILABLE
TO THE PUBLIC AT A NOMINAL COST.
ADDRESS: DIVISION OF HIGHWAYS
RALEIGH, NORTH CAROLINA 27611

REVISED
1 - 1-62
2 - 1-64
3 - 1-66
4 - 1-68
5 - 1-70
6 - 1-72
7 - 1-74
8 - 1-76
9 - 1-78
10 - 1-80
11 - 1-82

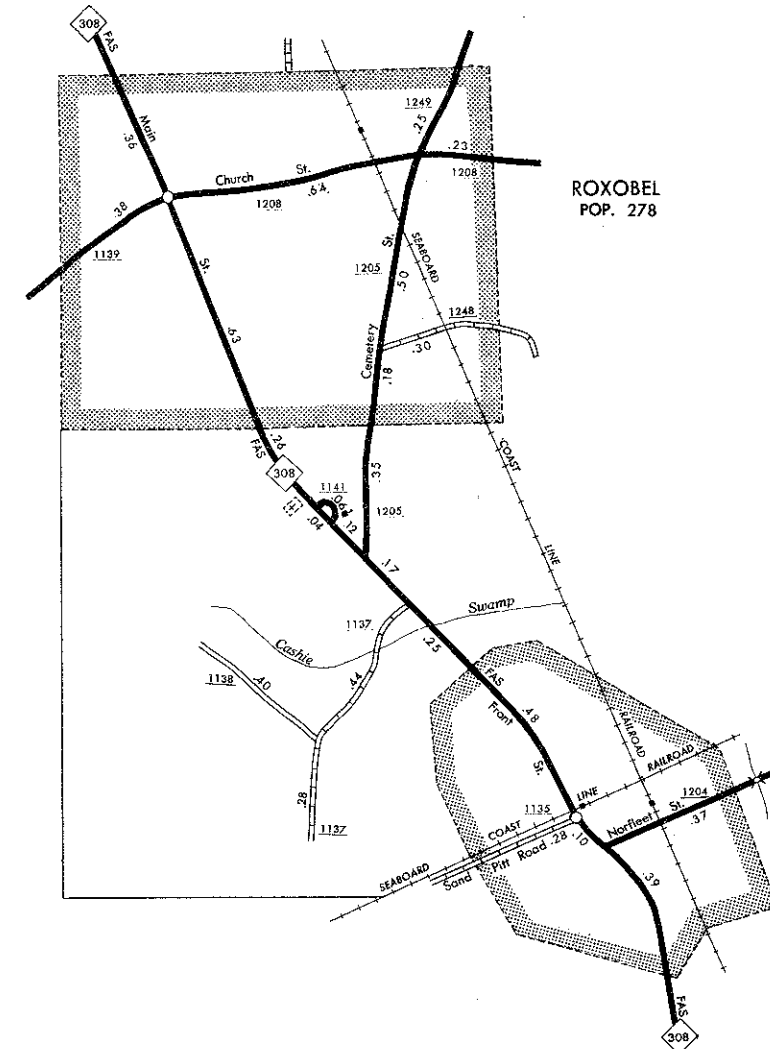

KELFORD
POP. 254

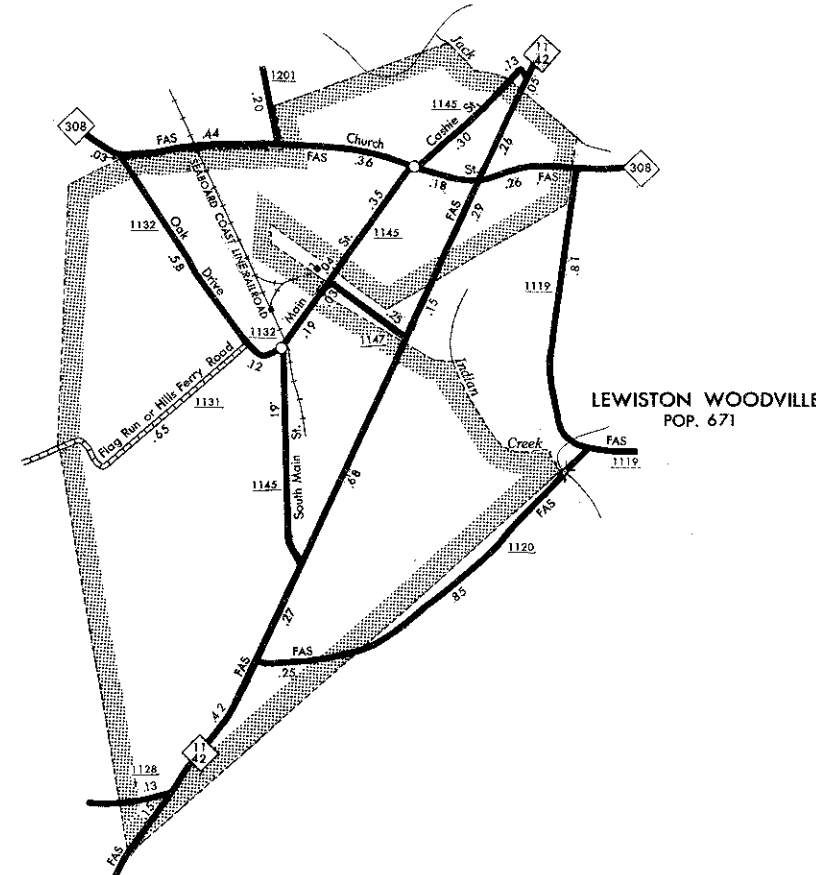

LEWISTON WOODVILLE
POP. 671

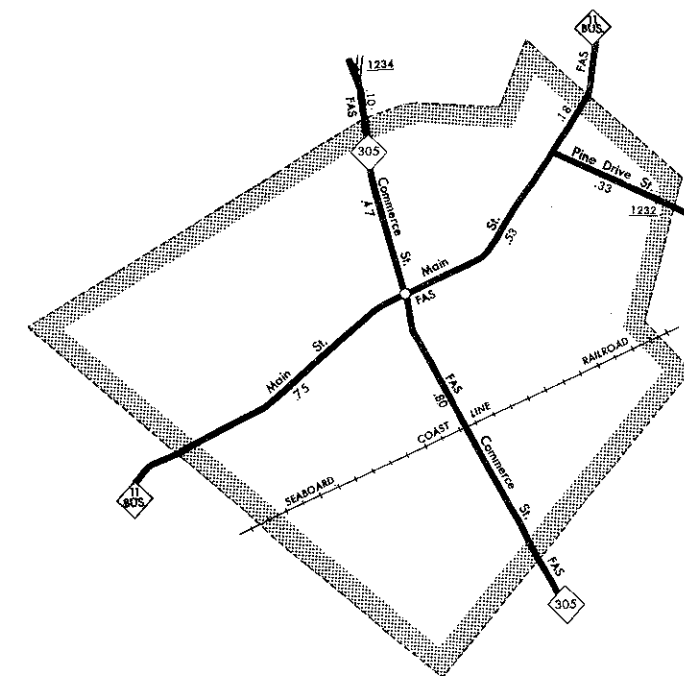

AULANDER
POP. 1,214

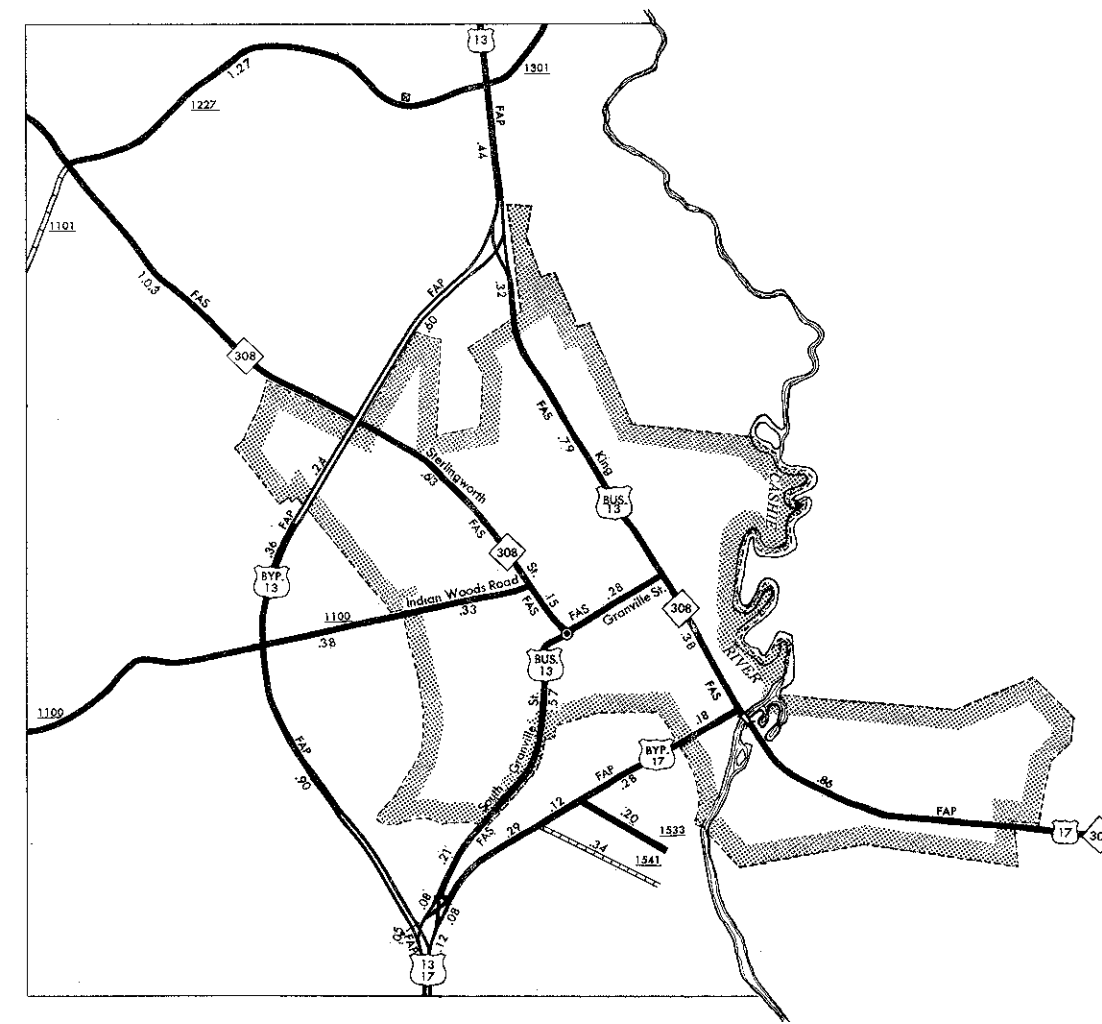

WINDSOR
POP. 2,126

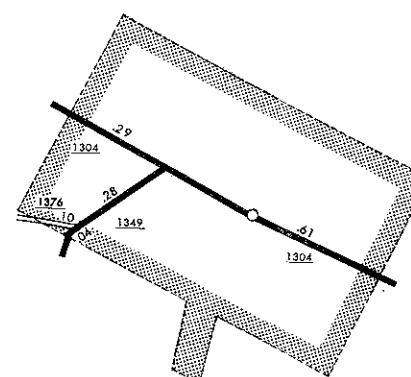

ASKEVILLE
POP. 227

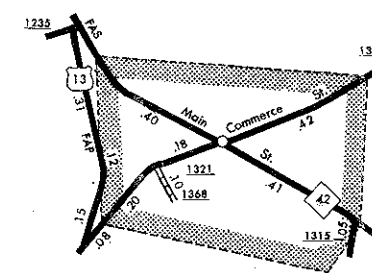

POWELLSVILLE
POP. 320

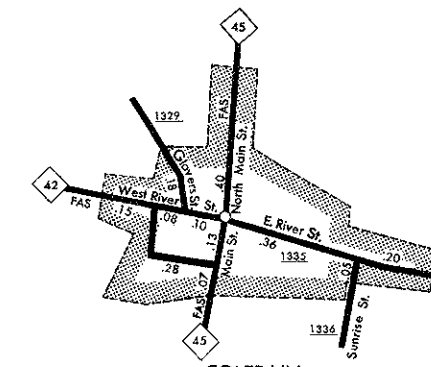

COLERAIN
POP. 284

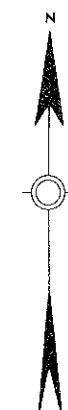

ENLARGED MUNICIPAL AND SUBURBAN AREAS

BERTIE COUNTY NORTH CAROLINA

PREPARED BY THE
NORTH CAROLINA DEPARTMENT OF TRANSPORTATION
DIVISION OF HIGHWAYS—PLANNING AND RESEARCH BRANCH
IN COOPERATION WITH THE
U.S. DEPARTMENT OF TRANSPORTATION
FEDERAL HIGHWAY ADMINISTRATION

SCALE

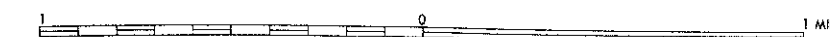

POLYCONIC PROJECTION

SHEET 2 OF 2