

Badin Lake

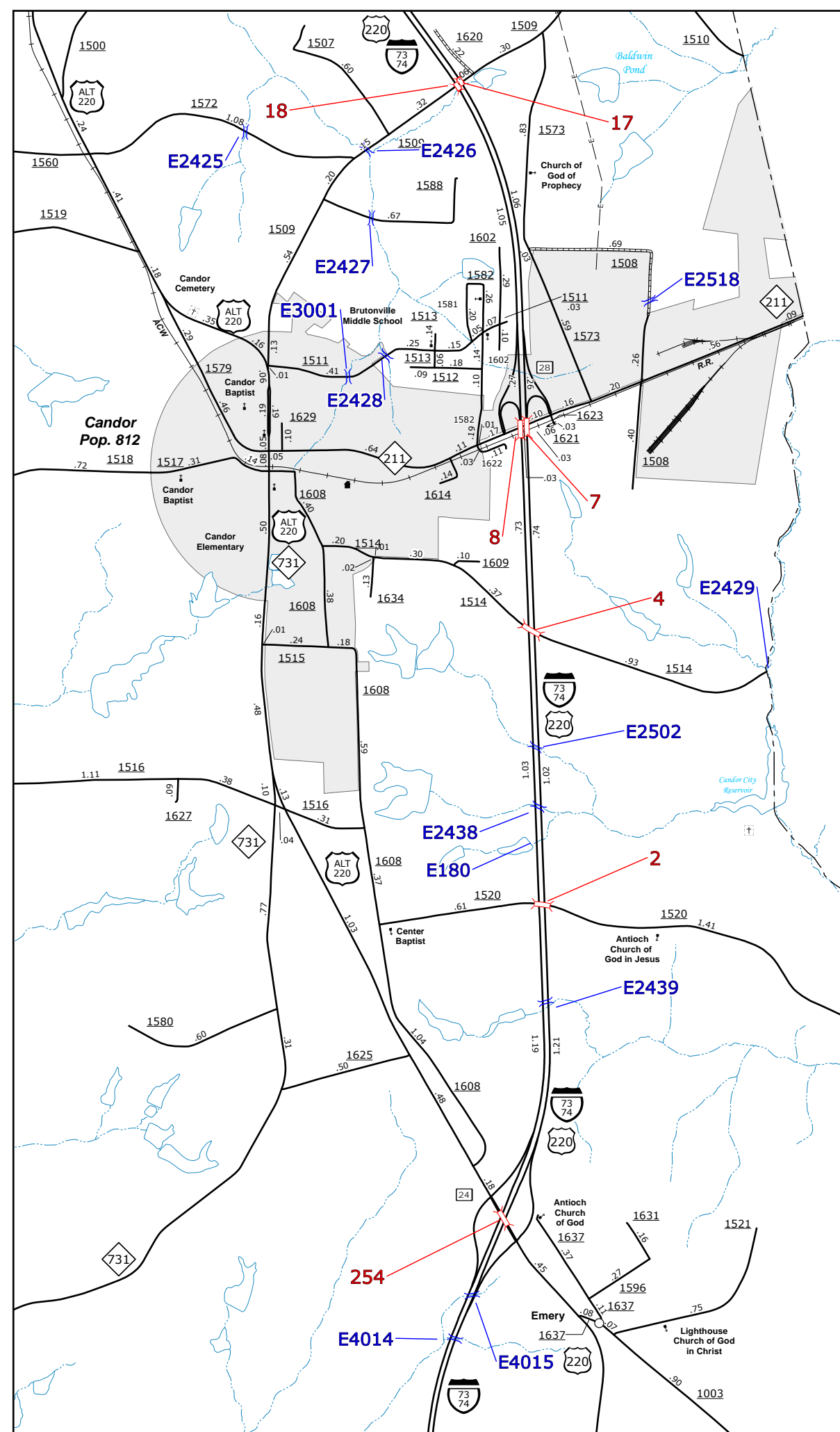

Candor

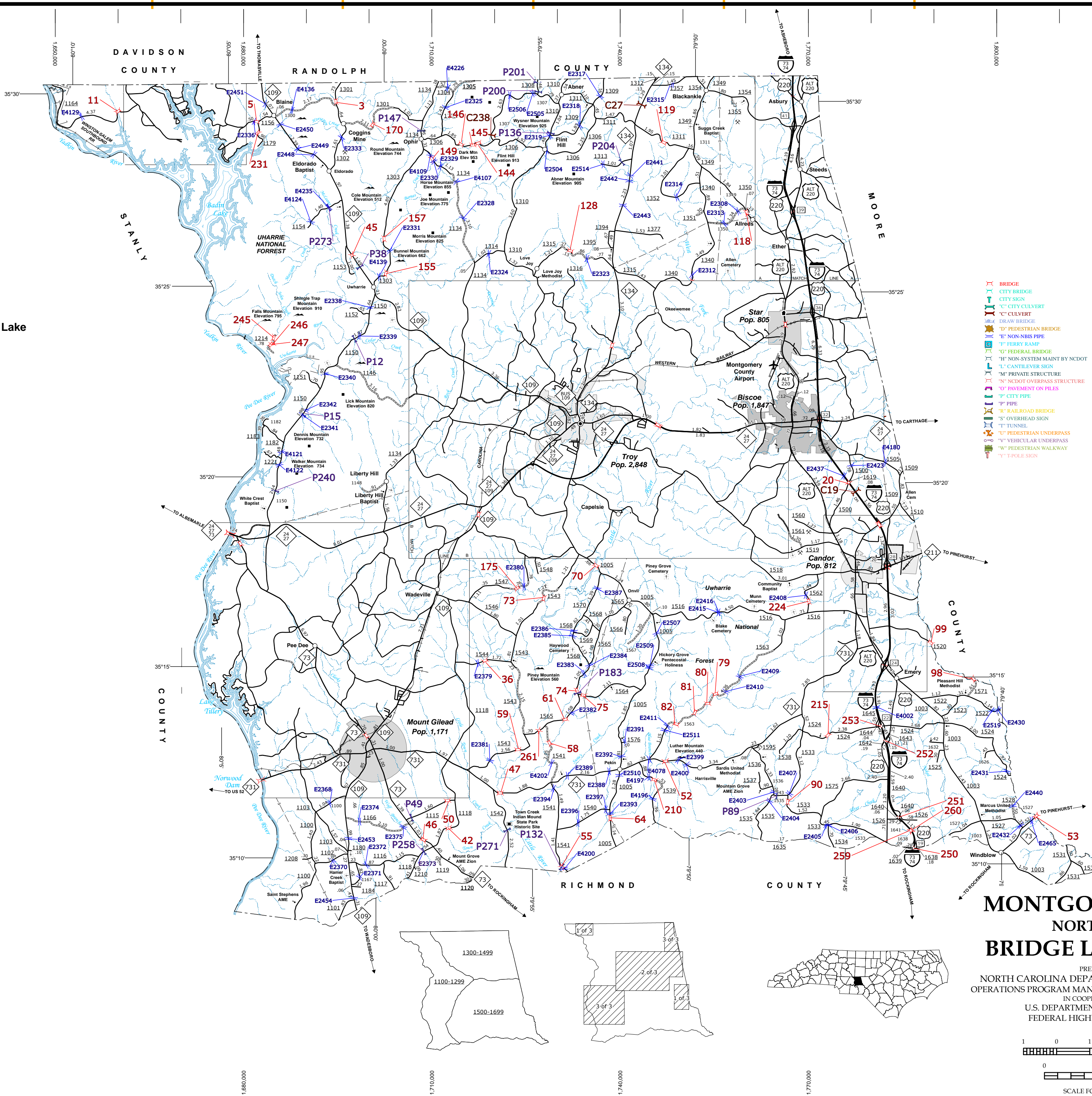

LEGEND

- UNPAVED SURFACE ROAD
- HARD SURFACE ROAD
- NON-SYSTEM ROAD
- DIVIDED HIGHWAY FRONTAGE ROADS
- PROJECTED LOCATION
- BEAR BECK PATHWAY
- INTERSECTION DISTANCE
- TRAFFIC CIRCLE
- DETAILED HIGHWAY INTERCHANGE
- FOOD
- INTERSTATE HIGHWAY
- U.S. NUMBERED HIGHWAY
- N.C. NUMBERED HIGHWAY
- U.S. NUMBERED BI-CYCLE ROUTE
- N.C. NUMBERED BI-CYCLE ROUTE
- INTERSTATE INTERCHANGE NUMBER
- SECONDARY INTERCHANGE NUMBER
- UTILITY LINES
- RAILROAD
- RAILROAD STATION
- RAILROAD INSET AREA
- URBAN EXTENSION LINE
- NATIONAL FOREST BOUNDARY
- RESERVATION OR PARK BOUNDARY
- STATE FOREST BOUNDARY
- STATE GAMBELAND BOUNDARY
- FEDERAL GAMBELAND BOUNDARY
- MILITARY RESERVATION BOUNDARY
- STATE LINE
- COUNTY LINE
- CITY LIMIT
- FERRY ROUTE
- NARROW CREEK OR STREAM
- WIDE RIVER OR CREEK
- RESERVOIR, POND OR LAKE W/ ISLAND
- DAM OR DAM WITH LOCK
- WATERFALL
- SWAMP
- COMMUNITY, TOWN OR CITY CENTER
- COUNTY SEAT
- STATE CAPITAL
- SCHOOL
- COLLEGE OR UNIVERSITY
- HOSPITAL
- COAST GUARD STATION
- CHURCH
- CHURCH WITH CEMETERY
- CEMETERY
- PUBLIC STATION
- CORRECTION OR PENAL INSTITUTION
- QUARRY
- MOBILE PTT
- HIGHWAY GARAGE OR MAINT. YARD
- POST OFFICE
- MILITARY POST
- WILDLIFE REFUGE
- WEIGH STATION
- FARGROUNDS
- HISTORICAL SITE
- POINTS OF INTEREST
- LIGHTHOUSE
- MOUNTAIN SUMMIT
- OVERLOOK
- STATE FOREST
- STATE FOREST
- GEODETIC MARKER
- REST AREA
- VISITOR CTR REST AREA
- WELCOME CTR REST AREA
- AIRPORT
- MILITARY AIRPORT
- HELIPORT

- BRIDGE**
- CITY BRIDGE
- CITY SIGN
- CITY CULVERT
- CITY CULVERT
- DRAW BRIDGE
- PEDESTRIAN BRIDGE
- NON-NBS PIPE
- FEDERAL BRIDGE
- NON-SYSTEM MAINT BY NCDOT
- CANTILEVER SIGN
- PRIVATE STRUCTURE
- NCDOT OVERPASS STRUCTURE
- PAVEMENT ON PILES
- CITY PIPE
- RAILROAD BRIDGE
- OVERHEAD SIGN
- TUNNEL
- PEDESTRIAN UNDERPASS
- VEHICULAR UNDERPASS
- PEDESTRIAN WALKWAY
- TRIPLE SIGN

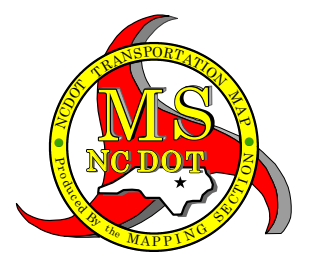

MONTGOMERY COUNTY NORTH CAROLINA BRIDGE LOCATION MAP

PREPARED BY THE
 NORTH CAROLINA DEPARTMENT OF TRANSPORTATION
 OPERATIONS PROGRAM MANAGEMENT UNIT - MAPPING SECTION
 IN COOPERATION WITH THE
 U.S. DEPARTMENT OF TRANSPORTATION
 FEDERAL HIGHWAY ADMINISTRATION

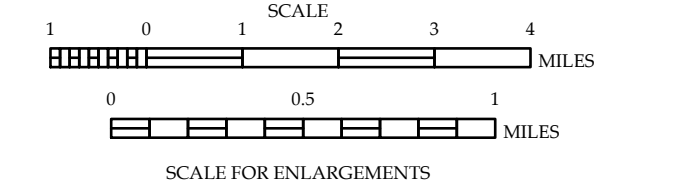

COPIES OF THIS MAP ARE AVAILABLE
 FROM THE PUBLIC INFORMATION COORDINATOR
 ADDRESS: MONTGOMERY COUNTY
 N.C. DEPARTMENT OF TRANSPORTATION
 MS/MAPPING SECTION
 4809 BERTHOLD AVENUE
 MONTGOMERY, NC 27059