

Faison

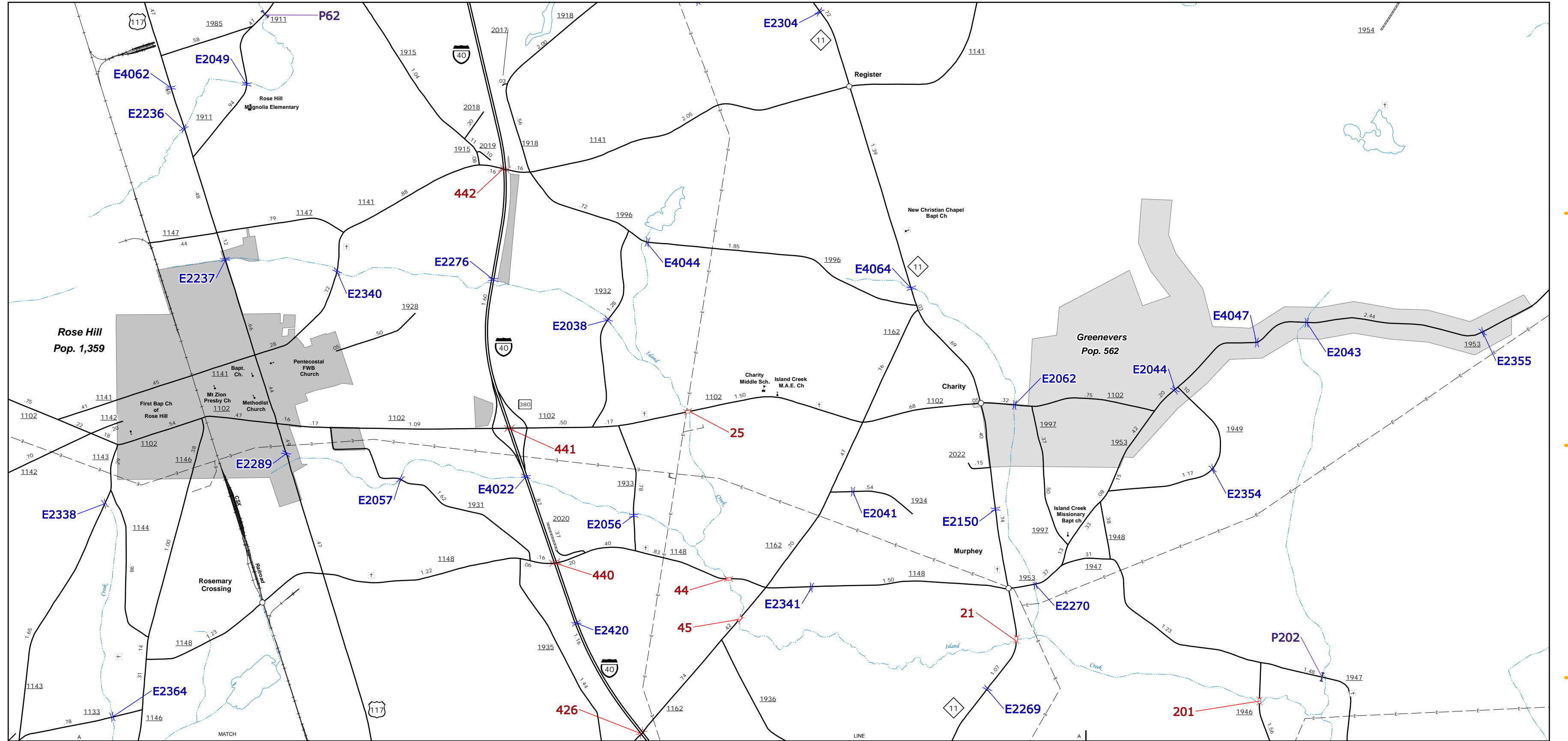

Rose Hill

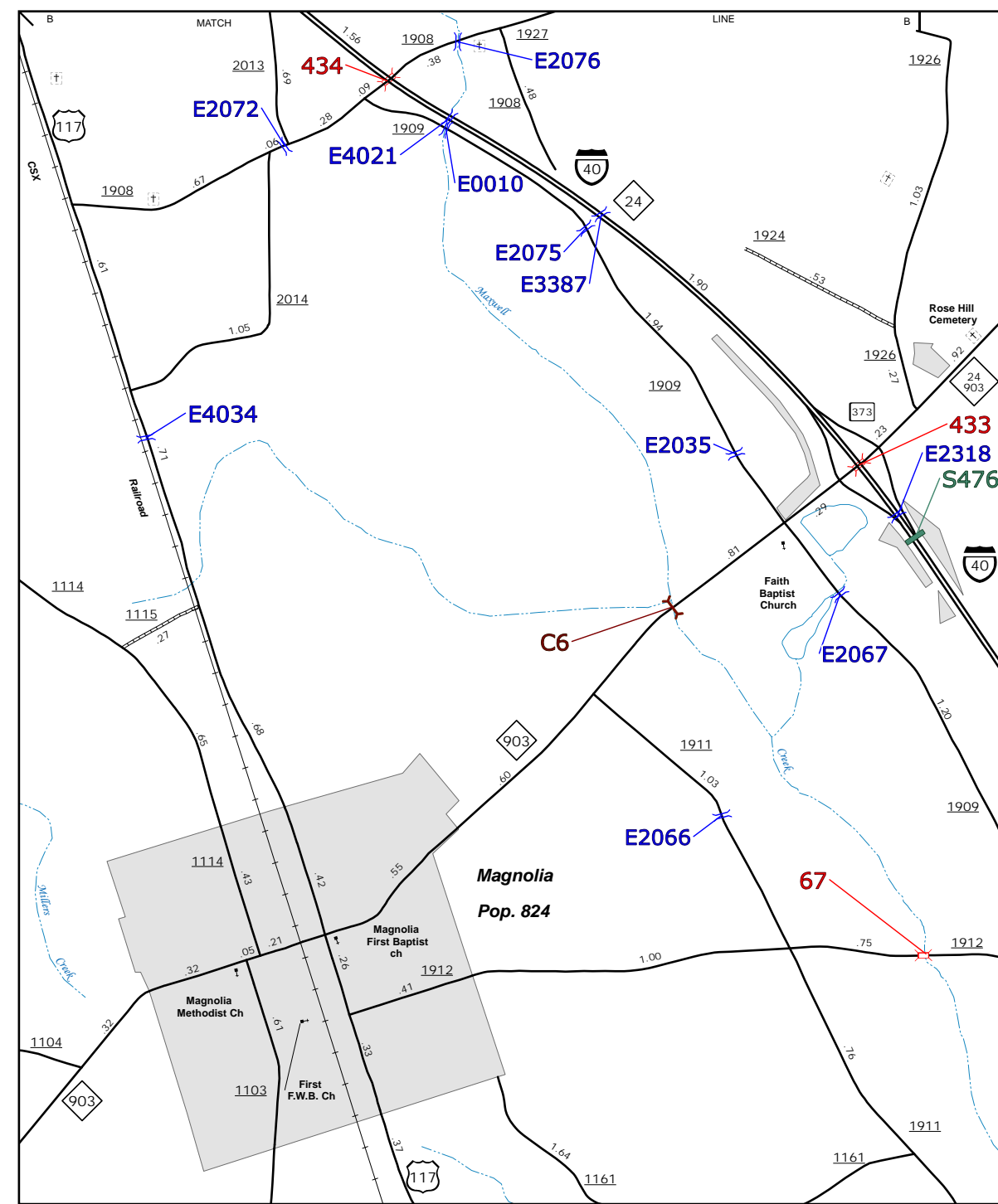

Magnolia

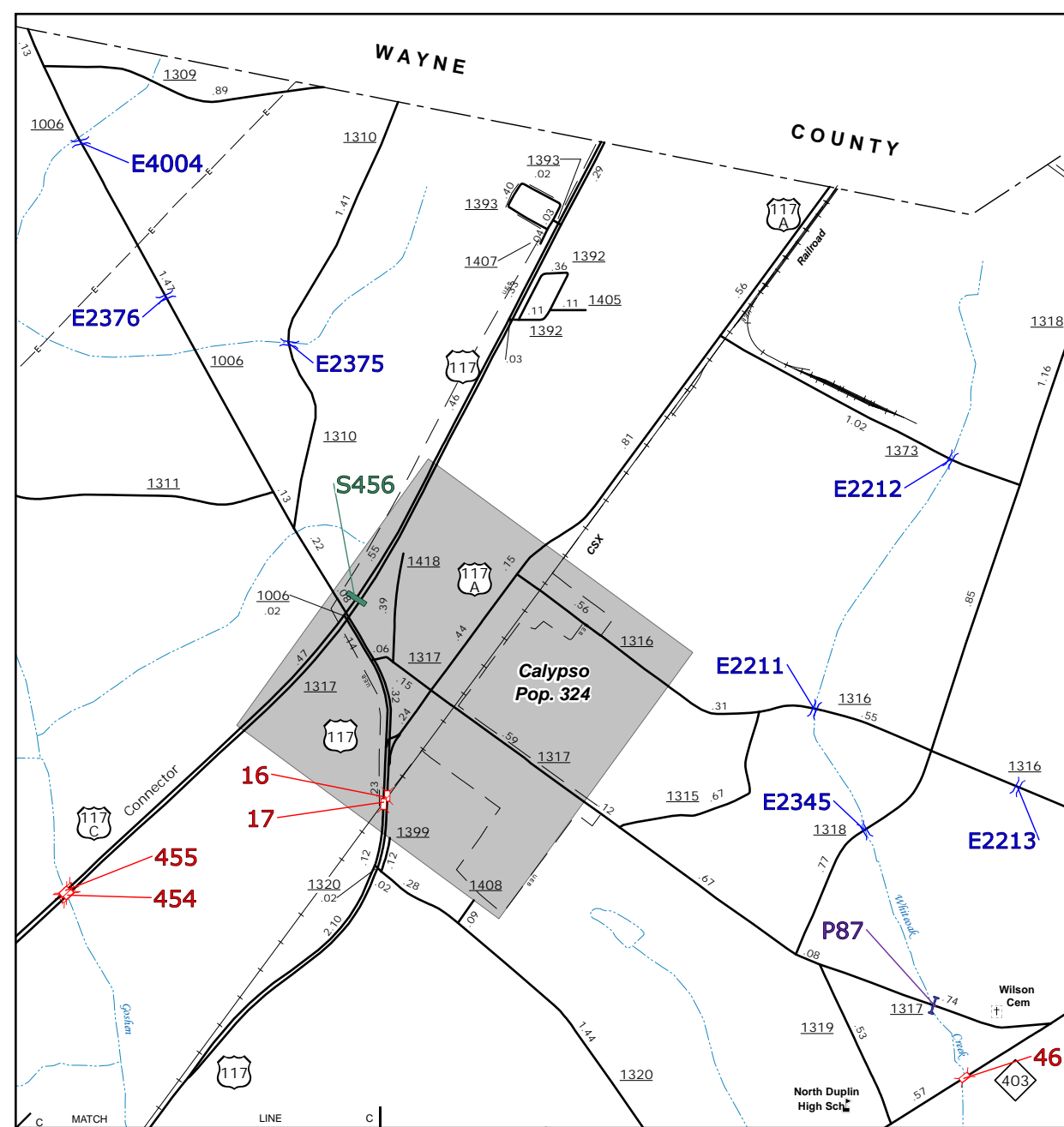

Calypso

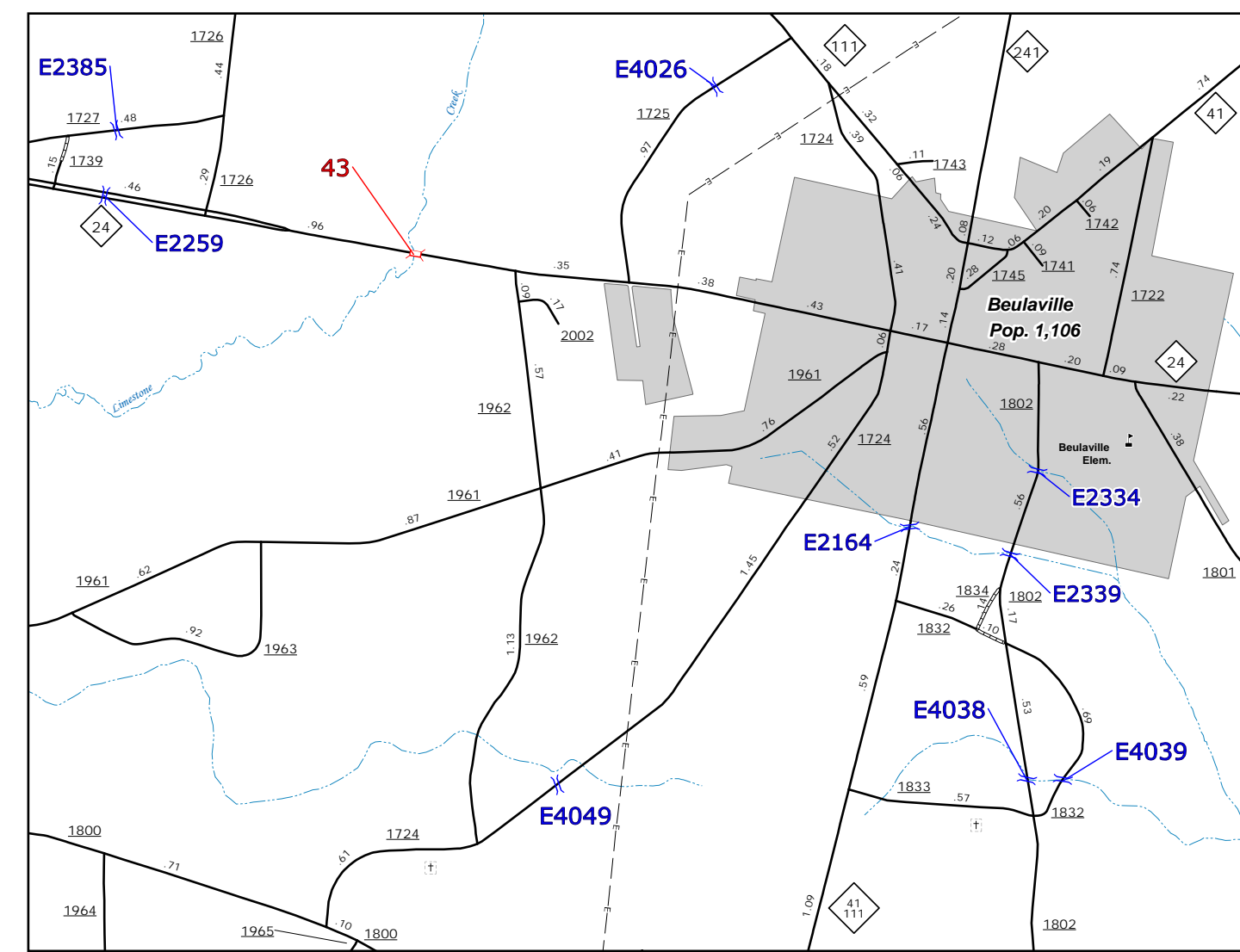

Beulaville

- BRIDGE
- CITY BRIDGE
- CITY SIGN
- CITY CULVERT
- CULVERT
- DRAW BRIDGE
- NON-NBS PIPE
- FERRY RAMP
- FEDERAL BRIDGE
- NON-SYSTEM MAINT BY NCDOT
- CASTLEVER SIGN
- PRIVATE STRUCTURE
- NCDOT OVERPASS STRUCTURE
- PAVEMENT ON PILES
- CITY PIPE
- PIPE
- RAILROAD BRIDGE
- OVERHEAD SIGN
- TUNNEL
- PEDESTRIAN UNDERPASS
- VEHICULAR UNDERPASS
- PEDESTRIAN WALKWAY
- TRIPLE SIGN



ENLARGED MUNICIPAL AND SUBURBAN AREAS
DUPLIN COUNTY
 NORTH CAROLINA
BRIDGE LOCATION MAP

PREPARED BY THE
 NORTH CAROLINA DEPARTMENT OF TRANSPORTATION
 OPERATIONS PROGRAM MANAGEMENT UNIT - MAPPING SECTION
 IN COOPERATION WITH THE
 U.S. DEPARTMENT OF TRANSPORTATION
 FEDERAL HIGHWAY ADMINISTRATION



10,000 FOOT GRID BASED ON NORTH CAROLINA PLANE COORDINATE SYSTEM
 LAMBERT CONFORMAL CONIC PROJECTION

COPIES OF THIS MAP ARE AVAILABLE
 AT THE N.C. DEPARTMENT OF TRANSPORTATION
 ADDRESS:
 4801 BERNLIE RD.
 RALEIGH, NC 27635

The Mapping Section's goal is to provide the most accurate and current information possible. Map data is compiled
 from various sources and is subject to change. The information is provided for informational purposes only. The
 information is not intended to be used for legal purposes. For additional information, visit
 the website at www.ncdot.gov and click on Data Providers or contact us by phone at (919) 855-8480.