

Colrain

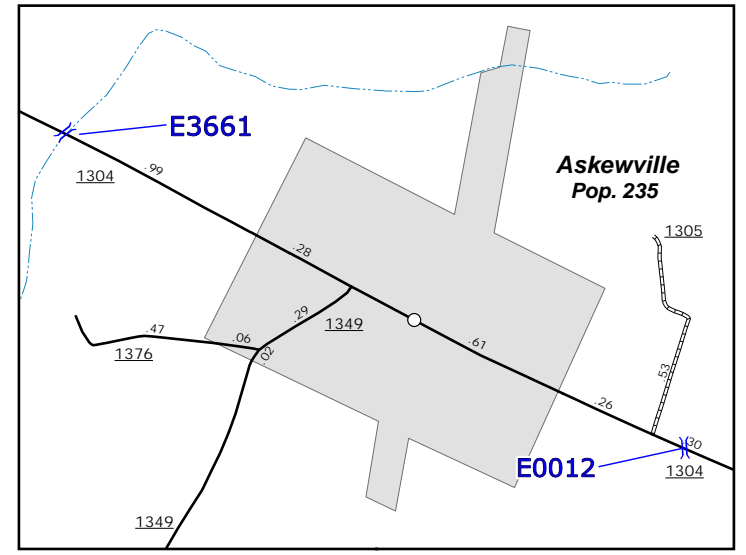

Askeville

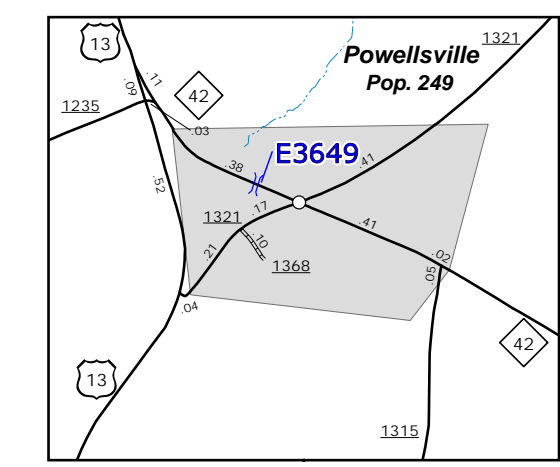

Powellsville

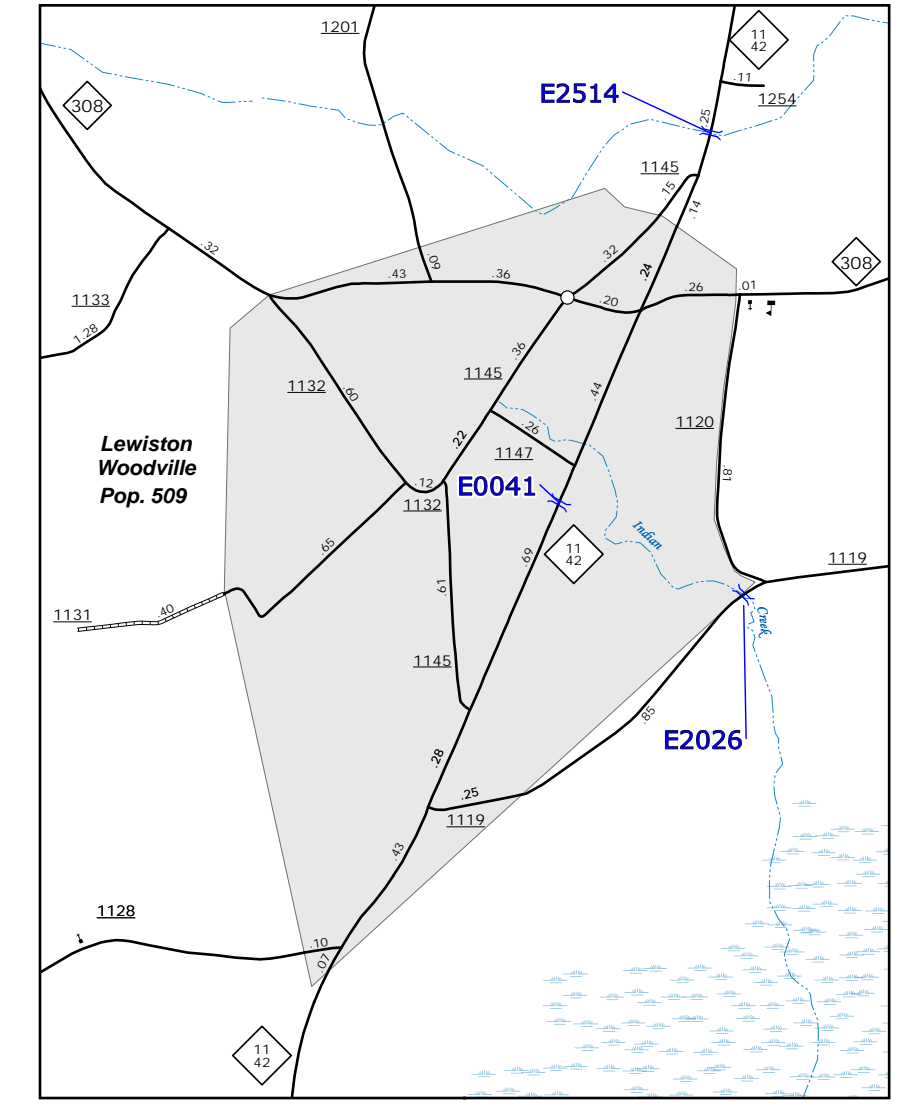

Lewiston Woodville

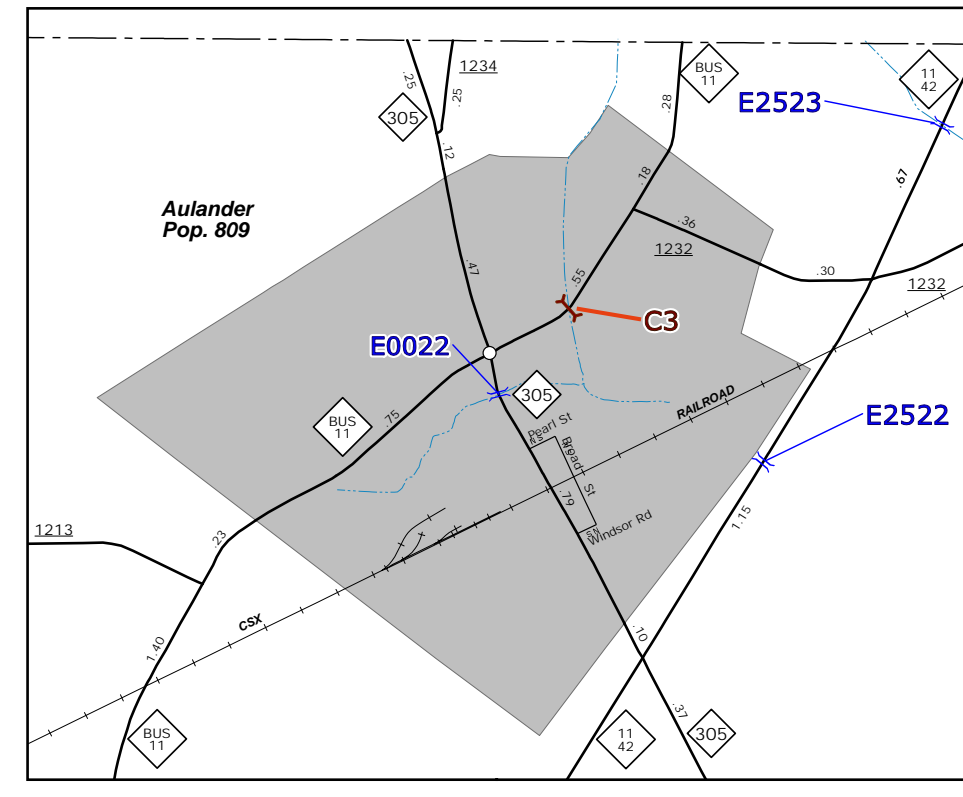

Aulander

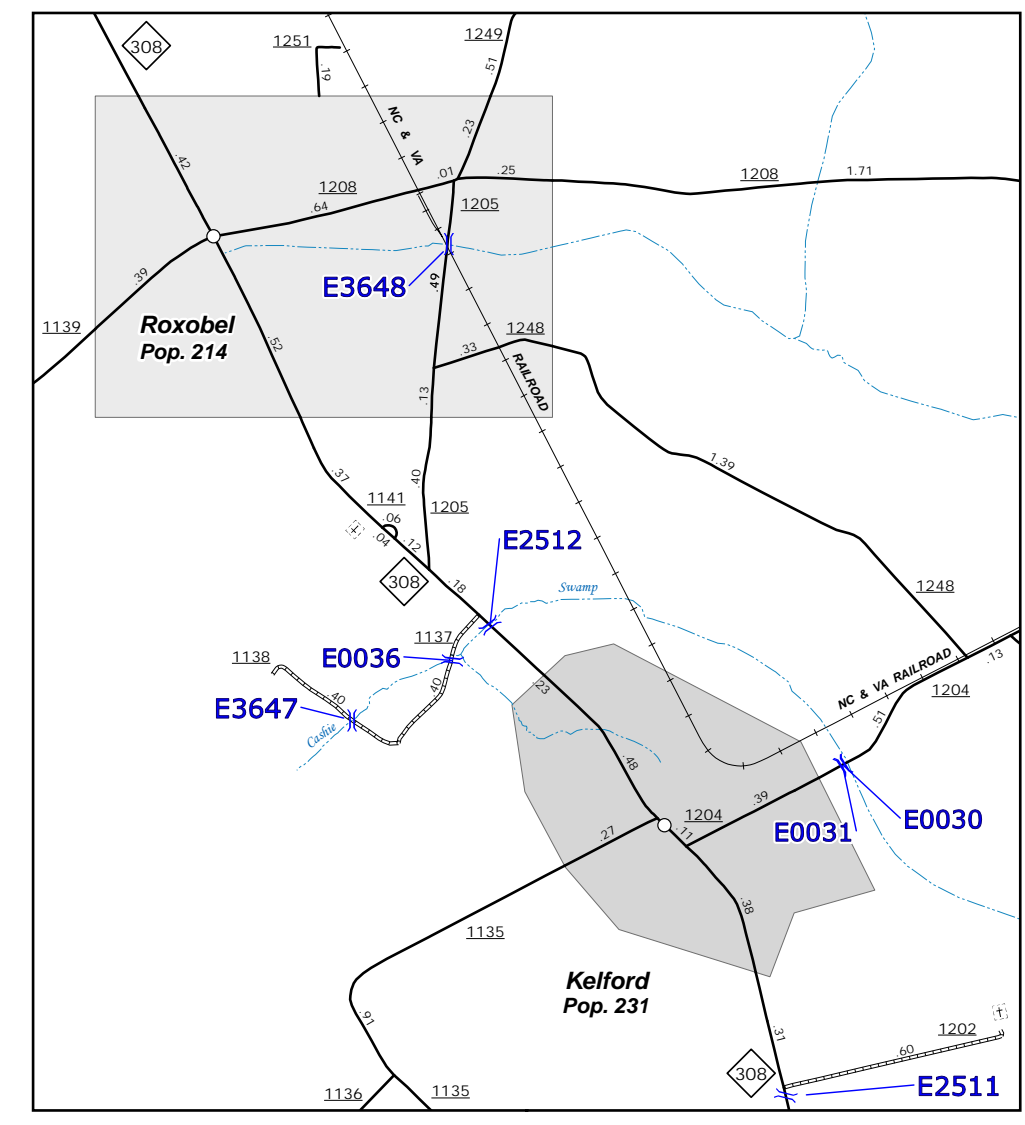

Roxobel and Kelford

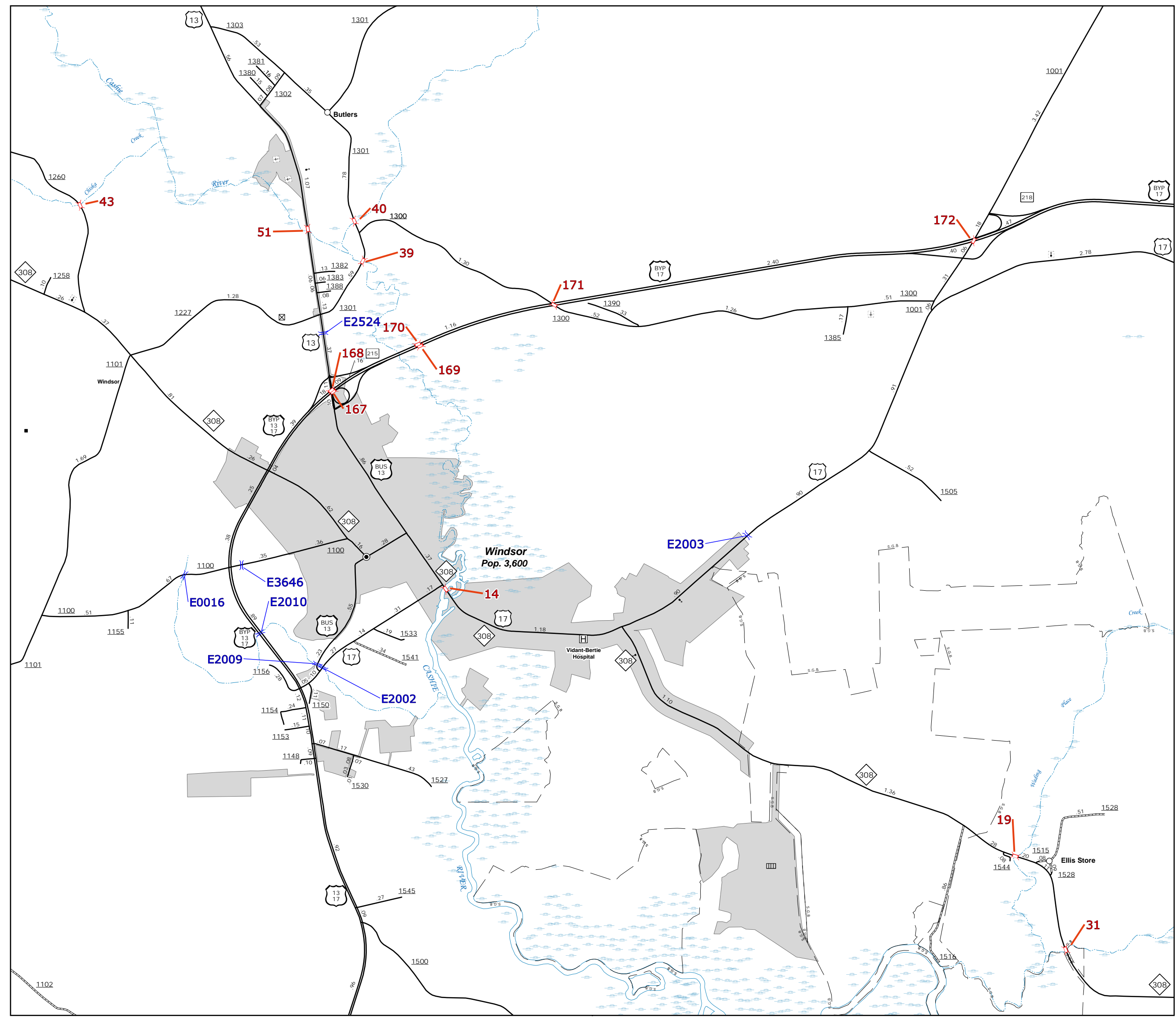

WINDSOR

- BRIDGE
- CITY BRIDGE
- CITY SKIN
- CITY CULVERT
- CULVERT
- DRAW BRIDGE
- PEDESTRIAN BRIDGE
- NON-NBIS PIPE
- FERRY RAMP
- FEDERAL BRIDGE
- NON-SYSTEM MAINT BY NCDOT
- CANTILEVER SKIN
- PRIVATE STRUCTURE
- SCOT OVERPASS STRUCTURE
- PAVEMENT ON FILES
- CITY PIPE
- PIPE
- RAILROAD BRIDGE
- OVERHEAD SKIN
- TUNNEL
- PEDESTRIAN UNDERPASS
- VEHICULAR UNDERPASS
- PEDESTRIAN WALKWAY
- POLE SKIN



ENLARGED MUNICIPAL AND SUBURBAN AREAS

# BERTIE COUNTY

## NORTH CAROLINA

### BRIDGE MAP LOCATION

PREPARED BY THE  
NORTH CAROLINA DEPARTMENT OF TRANSPORTATION  
OPERATIONS PROGRAM MANAGEMENT UNIT - MAPPING SECTION  
IN COOPERATION WITH THE  
U.S. DEPARTMENT OF TRANSPORTATION  
FEDERAL HIGHWAY ADMINISTRATION

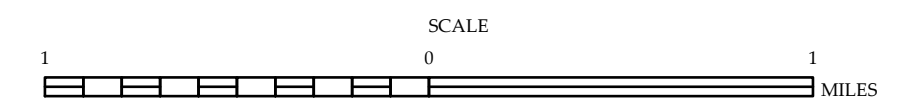

10,000 FOOT GRID BASED ON NORTH CAROLINA PLANE COORDINATE SYSTEM  
LAMBERT CONFORMAL CONIC PROJECTION

COPIES OF THIS MAP ARE AVAILABLE  
 FROM THE NORTH CAROLINA DEPARTMENT OF TRANSPORTATION  
 ADDRESS: 4609 BERTIE RD.  
 WASHINGTON, NC 27886