



STATE OF NORTH CAROLINA  
DEPARTMENT OF TRANSPORTATION

JOSH STEIN  
GOVERNOR

DANIEL H. JOHNSON  
SECRETARY

**DATE:** June 8, 2026  
**TO:** John P. Rhyne, PE  
Division Engineer  
Division 9  
**FROM:** Erin Lesh, GISP  
Supervisor, Spatial Data Operations Group  
Geographic Information Systems Unit  
**SUBJECT:** 2026 District 1 Road System Changes

The GIS Unit's Spatial Data Operations Group has been authorized to make the changes indicated below to the state road system. We request that you update the related maps and files in your offices and install appropriate road number signs, if necessary. If our system changes do not conform to the actual conditions in the field, please return this memorandum with recommendations.

Document Number	County	Approval Date
Davidson_2026_06_53386	DAVIDSON	06/04/2026

Questions or comments about changes should be referred to the GIS Help Desk at GISHelp@ncdot.gov.

Thank you for your assistance.

EAL

cc: BSIP  
Bridge Maintenance  
Division Right of Way  
IMG  
Pavement Management  
Permit Unit  
Rail Coordination & Safety  
State Road Maintenance  
Traffic Engineering  
Traffic Surveys

**MAILING ADDRESS:**

NC DEPARTMENT OF TRANSPORTATION  
GEOGRAPHIC INFORMATION SYSTEMS UNIT  
1521 MAIL SERVICE CENTER  
RALEIGH, NC 27699-1521

Telephone: (919) 707-2165  
FAX: 919-707-2210  
Customer Service: 1-877-368-4968  
Website: www.ncdot.gov

**LOCATION:**

1020 BIRCH RIDGE DR  
RALEIGH, NC 27610

# 2026 Road System Changes

---

**Petition Name:** Davidson\_2026\_06\_53386

**Date:** 06/04/2026

**County:** DAVIDSON

## Additions

<b>Route</b>	<b>Street Name</b>	<b>Mileage</b>	<b>Map</b>
SR 3800	KESWICK LN (SECTION 2)	0.33	
SR 3801	GREENBRIER LN	0.06	
SR 3802	DEERCROFT LN	0.08	
SR 3499	KESWICK LN (SECTION 1)	0.2	

## Deletions

**Route**

---

None

---

## Reassignments

**Route**

---

None

---

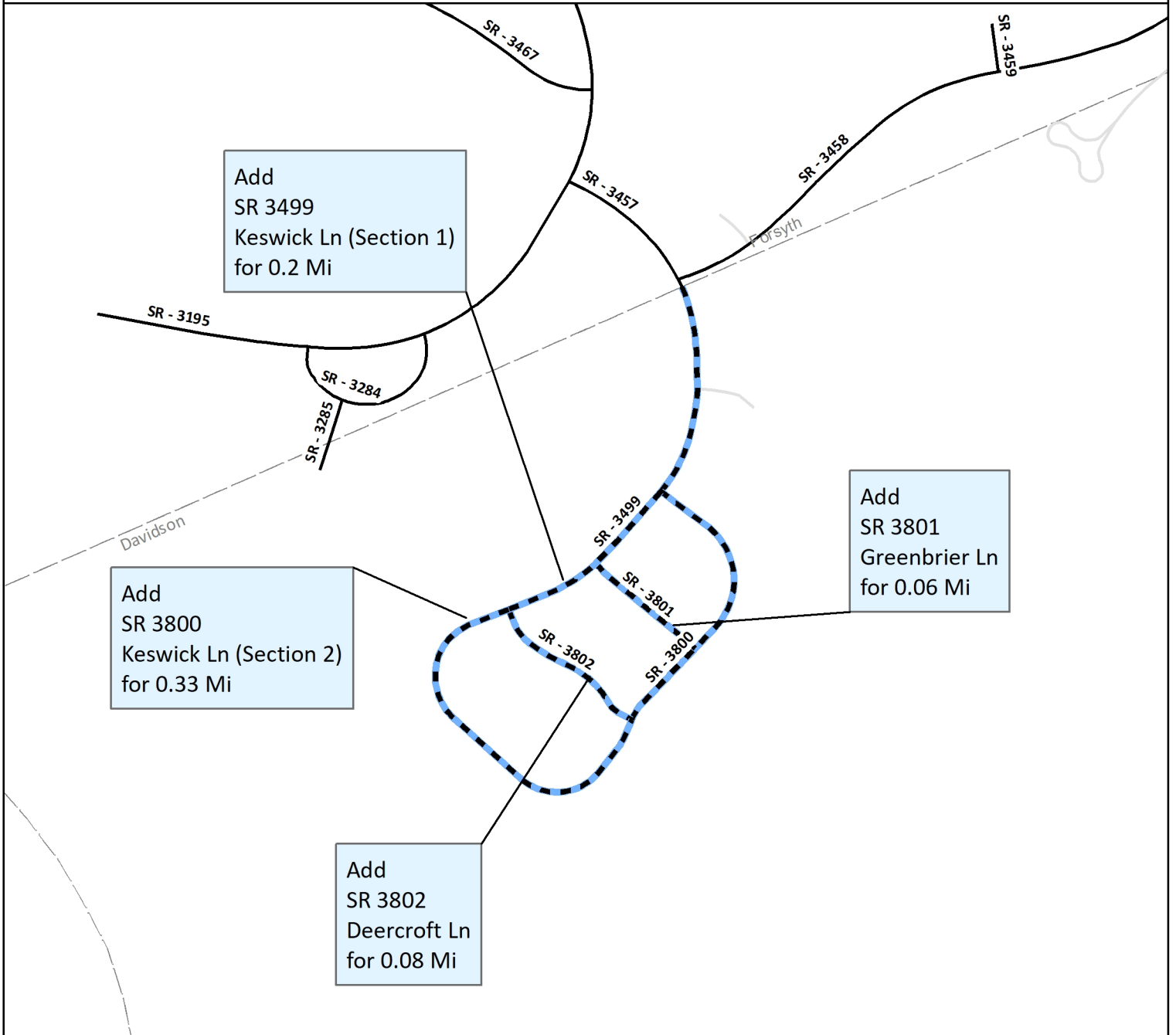

**Legend**

- Addition
- Deletion
- Reassignment
- Primary Routes
- Secondary Routes
- Non-System and Other Agency Routes
- Obliterated
- County Boundary

N  
↑

