



STATE OF NORTH CAROLINA  
DEPARTMENT OF TRANSPORTATION

JOSH STEIN  
GOVERNOR

DANIEL H. JOHNSON  
SECRETARY

**DATE:** April 16, 2026  
**TO:** Matt Clarke, PE  
Division Engineer  
Division 4  
**FROM:** Erin Lesh, GISP  
Supervisor, Spatial Data Operations Group  
Geographic Information Systems Unit  
**SUBJECT:** 2026 District 3 Road System Changes

The GIS Unit's Spatial Data Operations Group has been authorized to make the changes indicated below to the state road system. We request that you update the related maps and files in your offices and install appropriate road number signs, if necessary. If our system changes do not conform to the actual conditions in the field, please return this memorandum with recommendations.

Document Number	County	Approval Date
Johnston_2026_04_53342	JOHNSTON	04/02/2026

Questions or comments about changes should be referred to the GIS Help Desk at GISHelp@ncdot.gov.

Thank you for your assistance.

EAL

- BSIP
- cc: Bridge Maintenance
- Division Right of Way
- IMG
- Pavement Management
- Permit Unit
- Rail Coordination & Safety
- State Road Maintenance
- Traffic Engineering
- Traffic Surveys

**MAILING ADDRESS:**

NC DEPARTMENT OF TRANSPORTATION  
GEOGRAPHIC INFORMATION SYSTEMS UNIT  
1521 MAIL SERVICE CENTER  
RALEIGH, NC 27699-1521

Telephone: (919) 707-2165  
FAX: 919-707-2210  
Customer Service: 1-877-368-4968  
Website: www.ncdot.gov

**LOCATION:**

1020 BIRCH RIDGE DR  
RALEIGH, NC 27610

# 2026 Road System Changes

---

**Petition Name:** Johnston\_2026\_04\_53342  
**Date:** 04/02/2026  
**County:** JOHNSTON

## Additions

<b>Route</b>	<b>Street Name</b>	<b>Mileage</b>	<b>Map</b>
SR 3979	MISTY MORNING DR	0.15	
SR 3775 EXT	BRODIE ROSE LANDING WAY	0.32	

## Deletions

### Route

---

None

---

## Reassignments

### Route





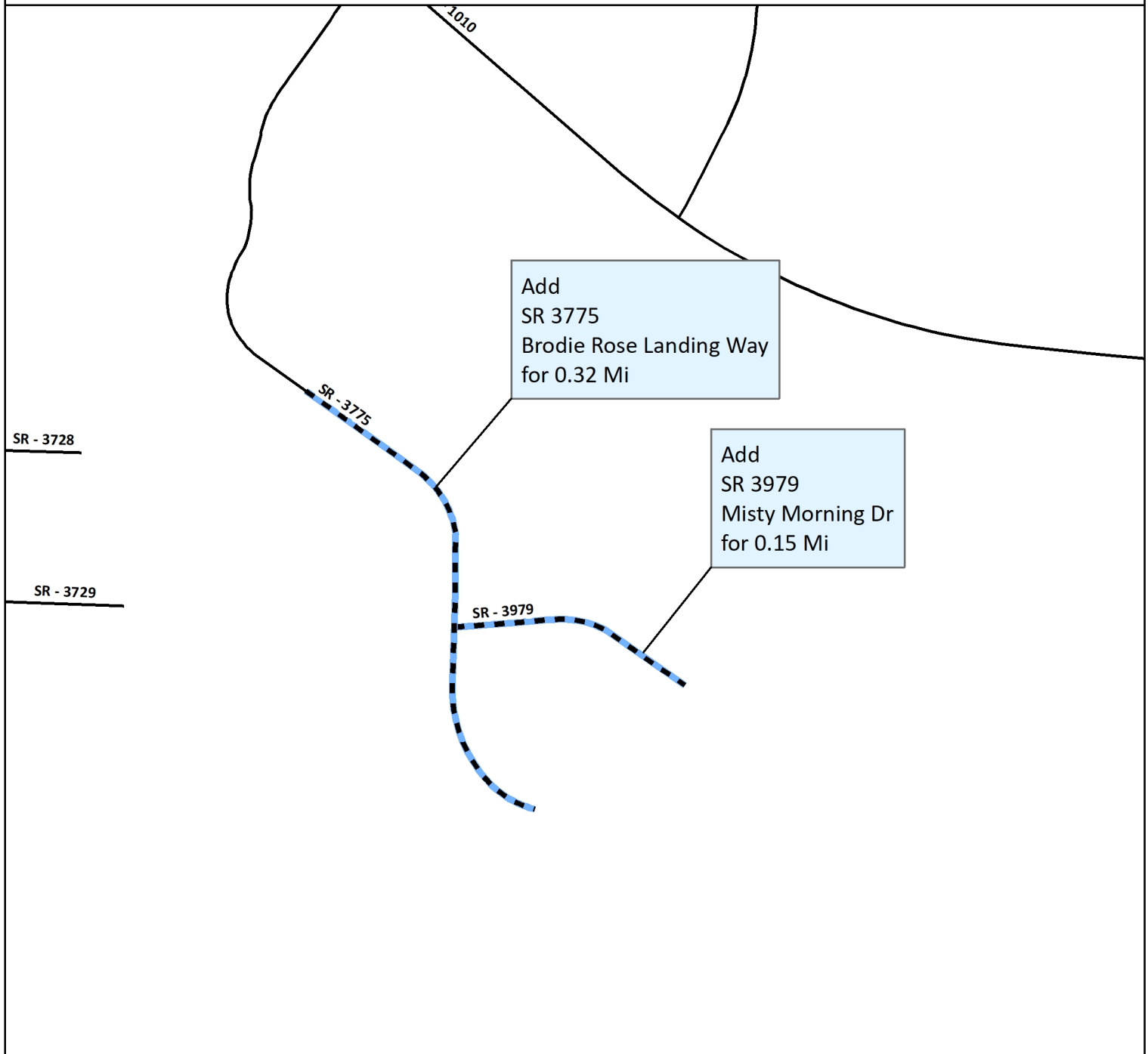

---

None

---



**Legend**

-  Addition
-  Deletion
-  Reassignment
-  Primary Routes
-  Secondary Routes
-  Non-System and Other Agency Routes
-  Obliterated

