



STATE OF NORTH CAROLINA  
DEPARTMENT OF TRANSPORTATION

JOSH STEIN  
GOVERNOR

DANIEL H. JOHNSON  
SECRETARY

**DATE:** April 23, 2026  
**TO:** Michael L. Poe, PE  
 Division Engineer  
 Division 11  
**FROM:** Erin Lesh, GISP  
 Supervisor, Spatial Data Operations Group  
 Geographic Information Systems Unit  
**SUBJECT:** 2026 District 3 Road System Changes

The GIS Unit's Spatial Data Operations Group has been authorized to make the changes indicated below to the state road system. We request that you update the related maps and files in your offices and install appropriate road number signs, if necessary. If our system changes do not conform to the actual conditions in the field, please return this memorandum with recommendations.

Document Number	County	Approval Date
BR-0002	ASHE	11/19/2025

Questions or comments about changes should be referred to the GIS Help Desk at GISHelp@ncdot.gov.

Thank you for your assistance.

EAL

- cc: BSIP  
 Bridge Maintenance  
 Division Right of Way  
 IMG  
 Pavement Management  
 Permit Unit  
 Rail Coordination & Safety  
 State Road Maintenance  
 Traffic Engineering  
 Traffic Surveys

**MAILING ADDRESS:**

NC DEPARTMENT OF TRANSPORTATION  
 GEOGRAPHIC INFORMATION SYSTEMS UNIT  
 1521 MAIL SERVICE CENTER  
 RALEIGH, NC 27699-1521

Telephone: (919) 707-2165  
 FAX: 919-707-2210  
 Customer Service: 1-877-368-4968  
 Website: www.ncdot.gov

**LOCATION:**

1020 BIRCH RIDGE DR  
 RALEIGH, NC 27610

# 2026 Road System Changes

---

**TIP Name:** BR-0002  
**Date:** 11/19/2025  
**County:** ASHE

## Additions

<b>Route</b>	<b>Street Name</b>	<b>Mileage</b>	<b>Map</b>
SR 1351		0.08	

## Deletions

<b>Route</b>	<b>Street Name</b>	<b>Mileage</b>	<b>Map</b>
SR 1351		0.03	

## Reassignments

<b>Route</b>
None

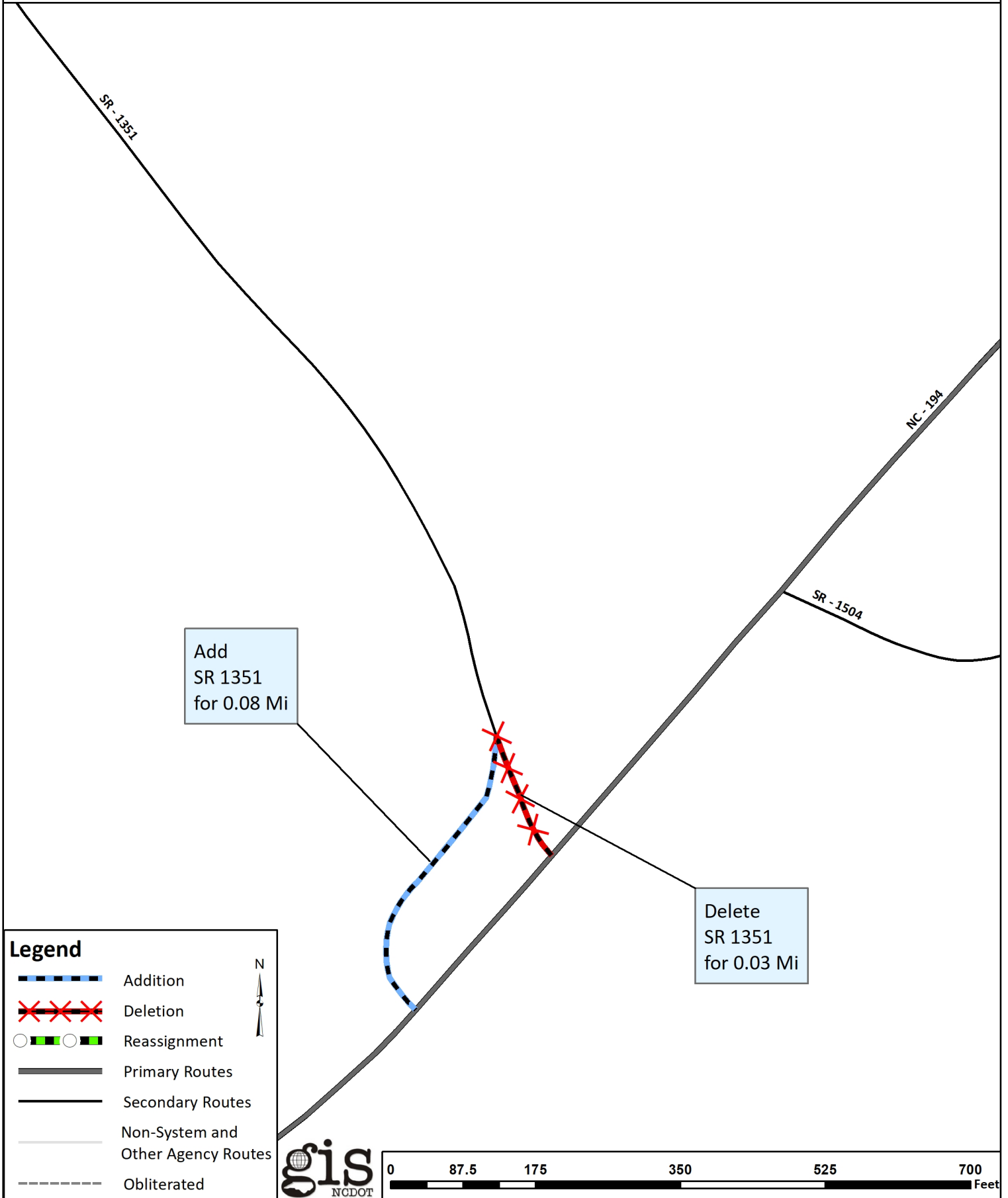

SR - 1351

NC - 194

SR - 1504

Add  
SR 1351  
for 0.08 Mi

Delete  
SR 1351  
for 0.03 Mi

**Legend**

- Addition
- Deletion
- Reassignment
- Primary Routes
- Secondary Routes
- Non-System and Other Agency Routes
- Obliterated

