



STATE OF NORTH CAROLINA
DEPARTMENT OF TRANSPORTATION

JOSH STEIN
GOVERNOR

J.R. "JOEY" HOPKINS
SECRETARY

DATE: January 14, 2025
TO: Rebecca J Gallas, PE
Division Engineer
Division 5
FROM: Erin Lesh, GISP
Supervisor, Spatial Data Operations Group
Geographic Information Systems Unit
SUBJECT: 2025 District 3 Road System Changes

The GIS Unit's Spatial Data Operations Group has been authorized to make the changes indicated below to the state road system. We request that you update the related maps and files in your offices and install appropriate road number signs, if necessary. If our system changes do not conform to the actual conditions in the field, please return this memorandum with recommendations.

Document Number	County	Approval Date
Franklin_2025_01_53094	FRANKLIN	01/08/2025

Questions or comments about changes should be referred to the GIS Help Desk at GISHelp@ncdot.gov.

Thank you for your assistance.

EAL

cc: BSIP
Bridge Maintenance
Division Right of Way
IMG
Pavement Management
Permit Unit
State Road Maintenance
Traffic Engineering
Traffic Surveys

MAILING ADDRESS:
NC DEPARTMENT OF TRANSPORTATION
GEOGRAPHIC INFORMATION SYSTEMS UNIT
1521 MAIL SERVICE CENTER
RALEIGH, NC 27699-1521

Telephone: (919) 707-2165
FAX: 919-707-2210
Customer Service: 1-877-368-4968
Website: www.ncdot.gov

LOCATION:
1020 BIRCH RIDGE DR
RALEIGH, NC 27610

2025 Road System Changes

Petition Name: Franklin_2025_01_53094
Date: 01/08/2025
County: FRANKLIN

Additions

Route	Street Name	Mileage	Map
SR 2113 EXT	GILL FARM WAY	0.53	
SR 2156	FOREST MEADOW LN	0.55	
SR 2159	NEW SPRING WAY	0.04	
SR 2157	SPRING BLOSSOM DR	0.07	
SR 2158	OLD BARN TRL	0.08	

Deletions

Route	Street Name	Mileage	Map
None			

Reassignments

Existing Route	New Route	Street Name	Mileage	Map
None				

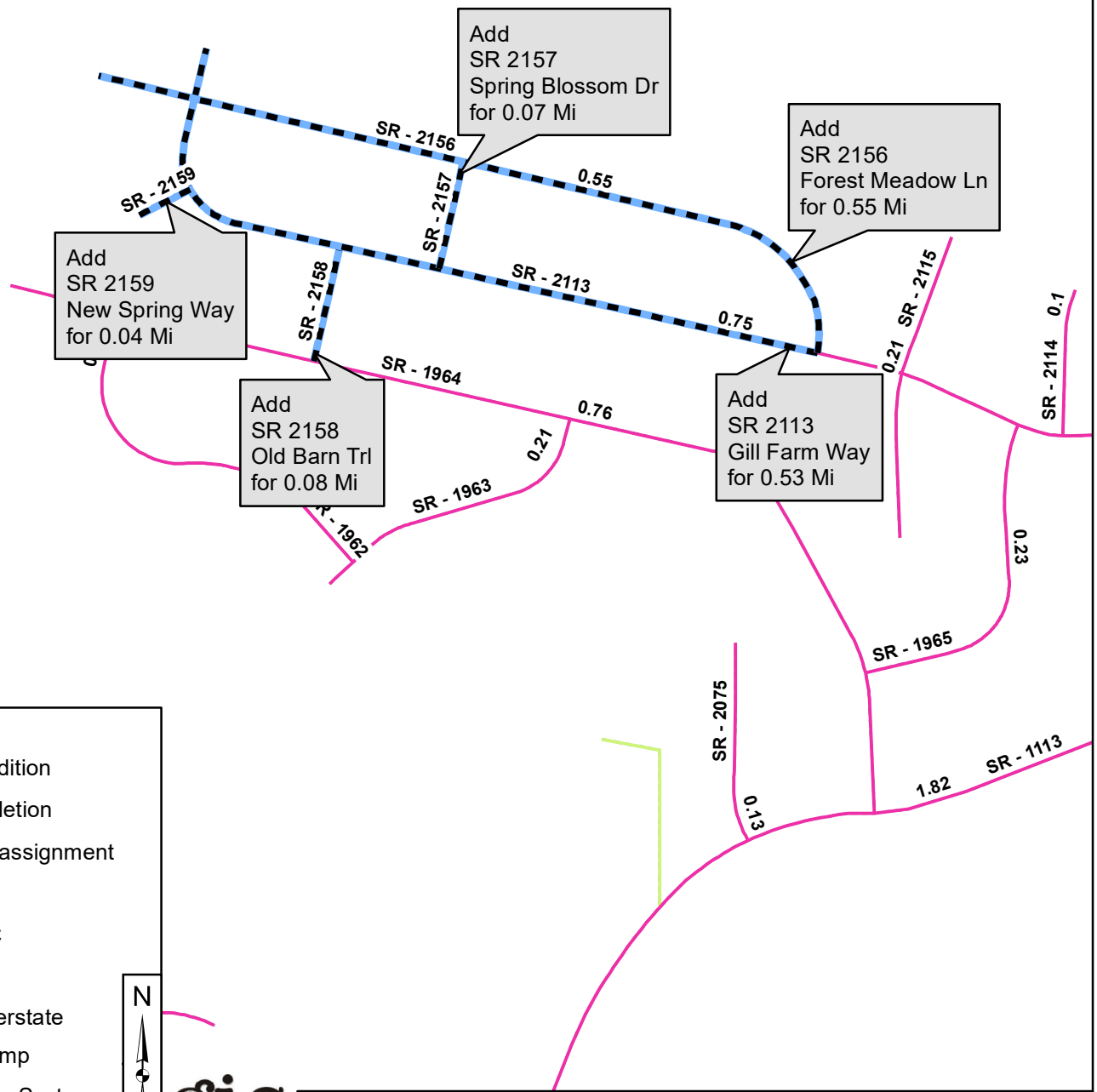

Legend

-  Addition
-  Deletion
-  Reassignment
-  SR
-  NC
-  US
-  Interstate
-  Ramp
-  Non-System
-  Obliterated

