



STATE OF NORTH CAROLINA
DEPARTMENT OF TRANSPORTATION

ROY COOPER
GOVERNOR

J.R. "JOEY" HOPKINS
SECRETARY

DATE: August 12, 2024
TO: Wallace "Lee" Jernigan, Jr., PE
Division Engineer
Division 6
FROM: Erin Lesh, GISP
Supervisor, Spatial Data Operations Group
Geographic Information Systems Unit
SUBJECT: 2024 District 2 Road System Changes

The GIS Unit's Spatial Data Operations Group has been authorized to make the changes indicated below to the state road system. We request that you update the related maps and files in your offices and install appropriate road number signs, if necessary. If our system changes do not conform to the actual conditions in the field, please return this memorandum with recommendations.

| Document Number | County | Approval Date |
|-----------------------|---------|---------------|
| Harnett 2024 08 53017 | HARNETT | 08/07/2024 |

Questions or comments about changes should be referred to the GIS Help Desk at GISHelp@ncdot.gov.

Thank you for your assistance.

EAL

cc: BSIP
Bridge Maintenance
Division Right of Way
IMG
Pavement Management
Permit Unit
State Road Maintenance
Traffic Engineering
Traffic Surveys

MAILING ADDRESS:
NC DEPARTMENT OF TRANSPORTATION
GEOGRAPHIC INFORMATION SYSTEMS UNIT
1521 MAIL SERVICE CENTER
RALEIGH, NC 27699-1521

Telephone: (919) 707-2165
FAX: 919-707-2210
Customer Service: 1-877-368-4968
Website: www.ncdot.gov

LOCATION:
1020 BIRCH RIDGE DR
RALEIGH, NC 27610

2024 Road System Changes

Petition Name: Harnett_2024_08_53017
Date: 08/07/2024
County: HARNETT

Additions

| Route | Street Name | Mileage | Map |
|---------|-------------|---------|-----|
| SR 3409 | WIDGEON WAY | 0.31 | |
| SR 3410 | PINTAIL DR | 0.08 | |
| SR 3411 | RINGNECK CT | 0.06 | |

Deletions

| Route | Street Name | Mileage | Map |
|-------|-------------|---------|-----|
| None | | | |

Reassignments

| Existing Route | New Route | Street Name | Mileage | Map |
|----------------|-----------|-------------|---------|-----|
| None | | | | |

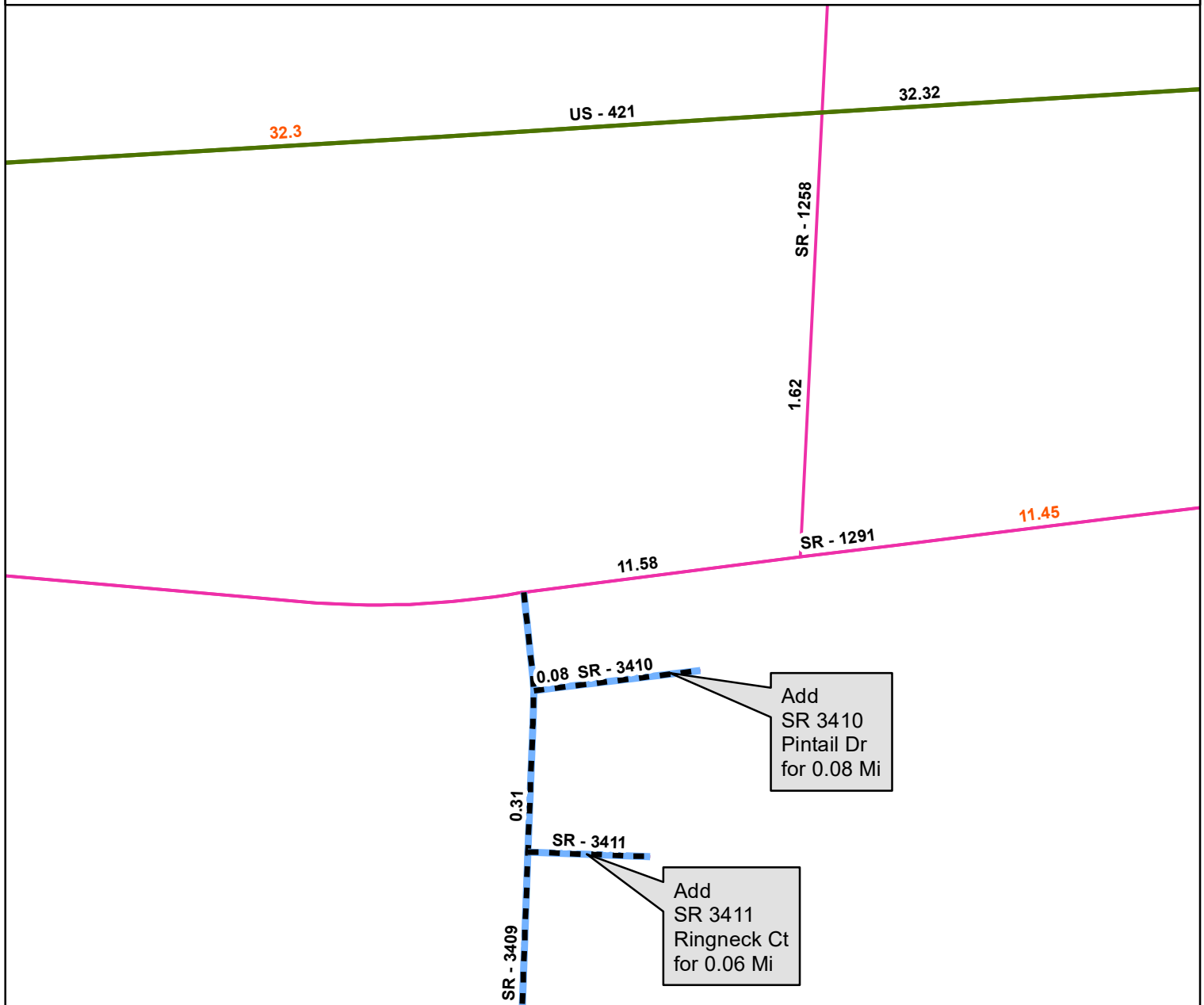

Legend

- Addition
- Deletion
- Reassignment
- SR
- NC
- US
- Interstate
- Ramp
- Non-System
- Obliterated

N

