



STATE OF NORTH CAROLINA  
DEPARTMENT OF TRANSPORTATION

ROY COOPER  
GOVERNOR

J.R. "JOEY" HOPKINS  
SECRETARY

**DATE:** January 17, 2024  
**TO:** Reuben Blakley, PE  
Division Engineer  
Division 1  
**FROM:** Erin Lesh, GISP  
Supervisor, Spatial Data Operations Group  
Geographic Information Systems Unit  
**SUBJECT:** 2024 District 3 Road System Changes

The GIS Unit's Spatial Data Operations Group has been authorized to make the changes indicated below to the state road system. We request that you update the related maps and files in your offices and install appropriate road number signs, if necessary. If our system changes do not conform to the actual conditions in the field, please return this memorandum with recommendations.

Document Number	County	Approval Date
Martin 2024 01 52903	MARTIN	01/04/2024

Questions or comments about changes should be referred to the GIS Help Desk at [GISHelp@ncdot.gov](mailto:GISHelp@ncdot.gov).

Thank you for your assistance.

EAL

cc: BSIP  
Bridge Maintenance  
Division Right of Way  
IMG  
Pavement Management  
Permit Unit  
State Road Maintenance  
Traffic Engineering  
Traffic Surveys

**MAILING ADDRESS:**  
NC DEPARTMENT OF TRANSPORTATION  
GEOGRAPHIC INFORMATION SYSTEMS UNIT  
1521 MAIL SERVICE CENTER  
RALEIGH, NC 27699-1521

Telephone: (919) 707-2165  
FAX: 919-707-2210  
Customer Service: 1-877-368-4968  
Website: [www.ncdot.gov](http://www.ncdot.gov)

**LOCATION:**  
1020 BIRCH RIDGE DR  
RALEIGH, NC 27610

# 2024 Road System Changes

---

**Petition Name:** Martin\_2024\_01\_52903  
**Date:** 01/04/2024  
**County:** MARTIN

## Additions

Route	Street Name	Mileage	Map
None			

---

## Deletions

Route	Street Name	Mileage	Map
SR 1172	LEE RD EXT	0.01	

---





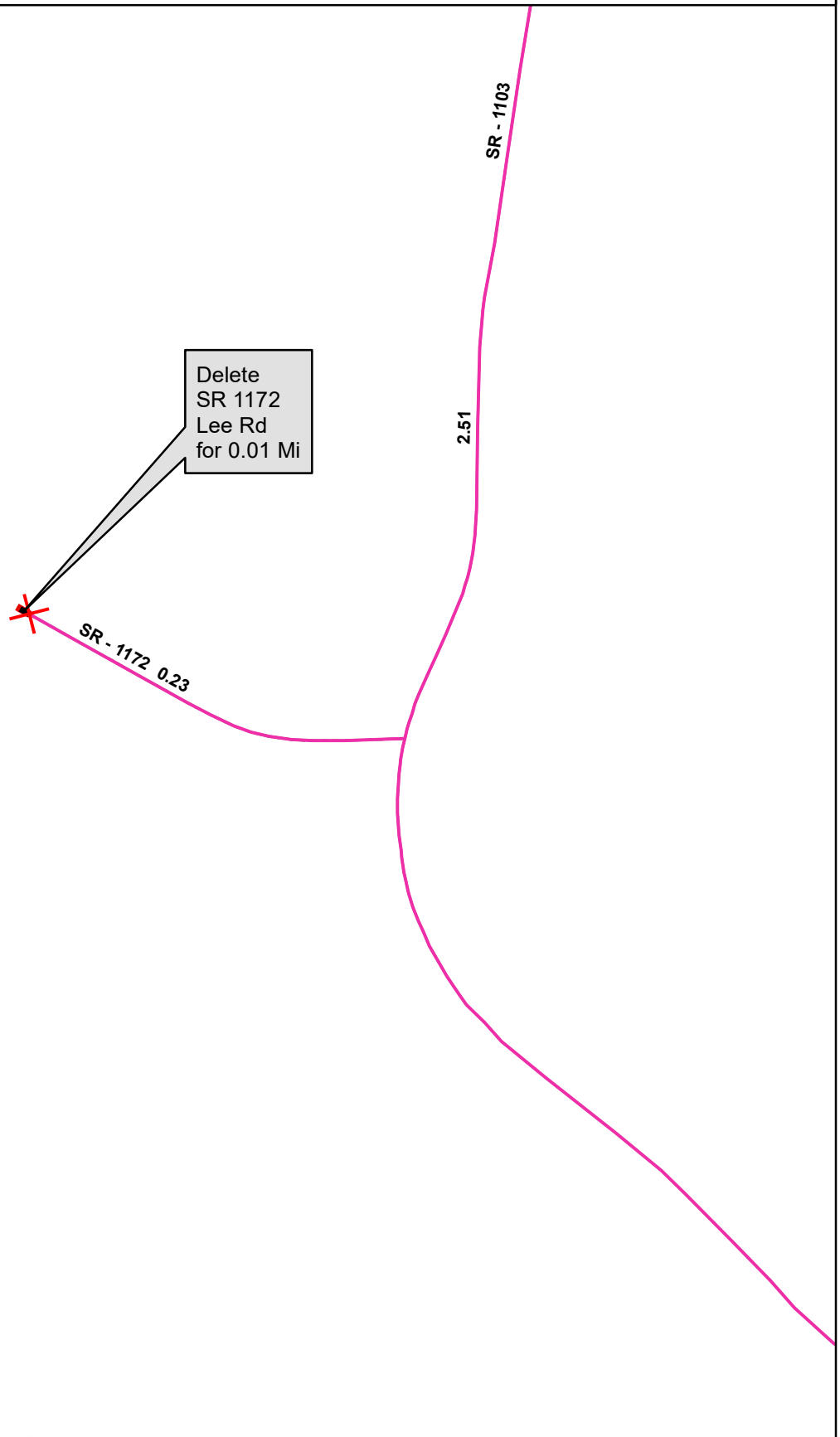

## Reassignments

Existing Route	New Route	Street Name	Mileage	Map
None				

---



**Legend**

-  Addition
-  Deletion
-  Reassignment
-  SR
-  NC
-  US
-  Interstate
-  Ramp
-  Non-System
-  Obliterated

