



STATE OF NORTH CAROLINA
DEPARTMENT OF TRANSPORTATION

ROY COOPER
GOVERNOR

J.R. "JOEY" HOPKINS
SECRETARY

DATE: October 23, 2023
TO: Brandon H. Jones, PE
Division Engineer
Division 5
FROM: Erin Lesh, GISP
Supervisor, Spatial Data Operations Group
Geographic Information Systems Unit
SUBJECT: 2023 District 3 Road System Changes

The GIS Unit's Spatial Data Operations Group has been authorized to make the changes indicated below to the state road system. We request that you update the related maps and files in your offices and install appropriate road number signs, if necessary. If our system changes do not conform to the actual conditions in the field, please return this memorandum with recommendations.

Document Number	County	Approval Date
Franklin_2023_10_52828	FRANKLIN	10/04/2023

Questions or comments about changes should be referred to the GIS Help Desk at GISHelp@ncdot.gov.

Thank you for your assistance.

EAL

- cc: BSIP
- Bridge Maintenance
- Division Right of Way
- IMG
- Pavement Management
- Permit Unit
- State Road Maintenance
- Traffic Engineering
- Traffic Surveys

MAILING ADDRESS:
NC DEPARTMENT OF TRANSPORTATION
GEOGRAPHIC INFORMATION SYSTEMS UNIT
1521 MAIL SERVICE CENTER
RALEIGH, NC 27699-1521

Telephone: (919) 707-2165
FAX: 919-707-2210
Customer Service: 1-877-368-4968
Website: www.ncdot.gov

LOCATION:
4101 CAPITAL BLVD.
RALEIGH, NC 27604

2023 Road System Changes

Petition Name: Franklin_2023_10_52828
Date: 10/04/2023
County: FRANKLIN

Additions

Route	Street Name	Mileage	Map
SR 2135	HARMONY RANCH LN	0.23	
SR 2100 EXT	SILENT BROOK TRL	0.18	
SR 2099 EXT	GROUSE BLUFF LN	0.06	
SR 2136	MISTY GROVE TRL	0.22	

Deletions

Route	Street Name	Mileage	Map
None			

Reassignments

Existing Route	New Route	Street Name	Mileage	Map
None				

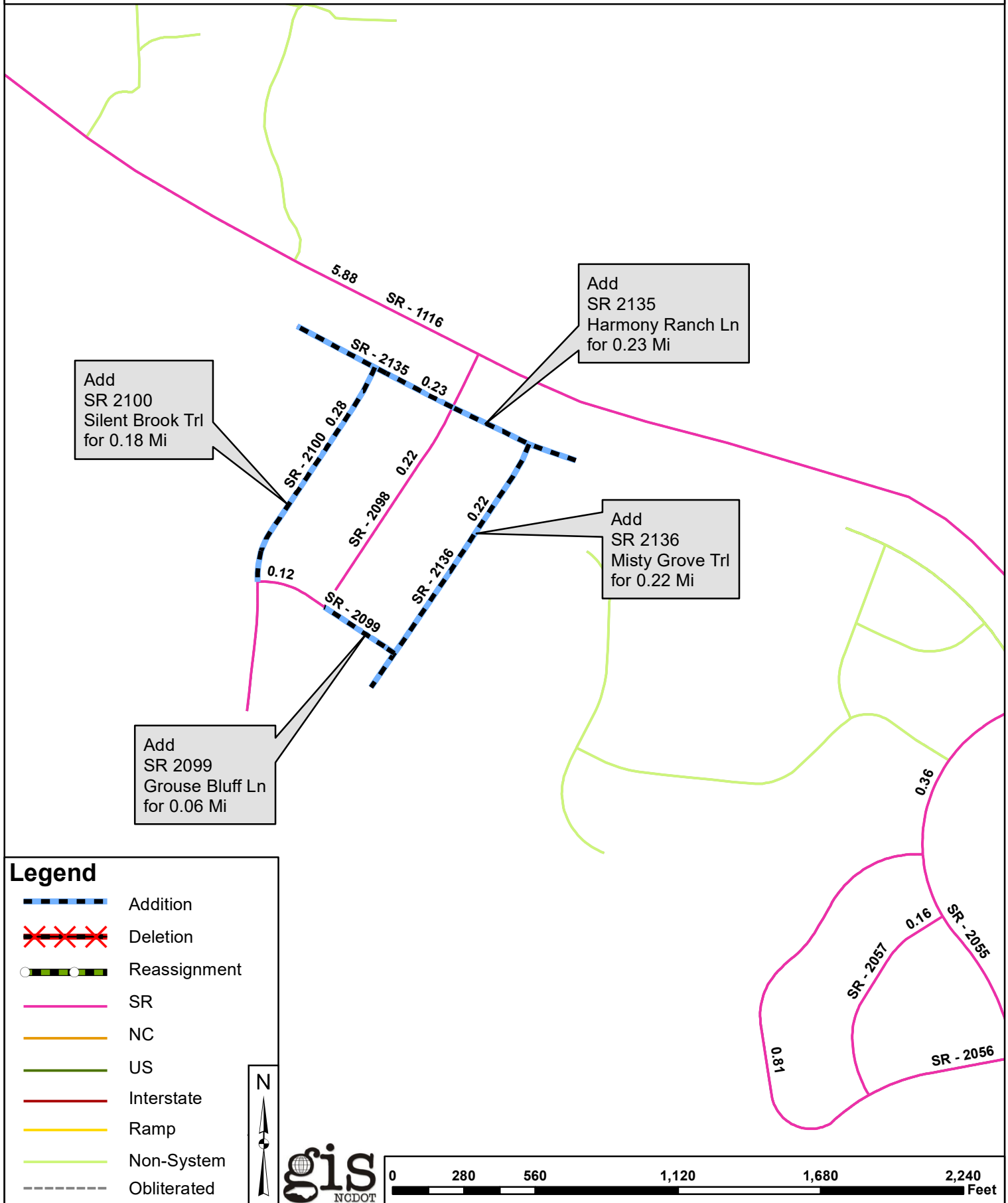

Add
SR 2100
Silent Brook Trl
for 0.18 Mi

Add
SR 2135
Harmony Ranch Ln
for 0.23 Mi

Add
SR 2136
Misty Grove Trl
for 0.22 Mi

Add
SR 2099
Grouse Bluff Ln
for 0.06 Mi

Legend

- Addition
- Deletion
- Reassignment
- SR
- NC
- US
- Interstate
- Ramp
- Non-System
- Obliterated

N

gis
NCDOT

