



STATE OF NORTH CAROLINA  
DEPARTMENT OF TRANSPORTATION

ROY COOPER  
GOVERNOR

J. ERIC BOYETTE  
SECRETARY

**DATE:** July 11, 2022  
**TO:** Wright R. Archer, III, PE  
 Division Engineer  
 Division 7  
**FROM:** Erin Lesh, GISP  
 Supervisor, Spatial Data Operations Group  
 Geographic Information Systems Unit  
**SUBJECT:** 2022 District 2 Road System Changes

The GIS Unit's Spatial Data Operations Group has been authorized to make the changes indicated below to the state road system. We request that you update the related maps and files in your offices and install appropriate road number signs, if necessary. If our system changes do not conform to the actual conditions in the field, please return this memorandum with recommendations.

Document Number	County	Approval Date
Guilford_2022_07_52540	GUILFORD	07/07/2022

Questions or comments about changes should be referred to the GIS Help Desk at GISHelp@ncdot.gov.

Thank you for your assistance.

EAL

cc: BSIP  
 Bridge Maintenance  
 Division Right of Way  
 IMG  
 Pavement Management  
 Permit Unit  
 State Road Maintenance  
 Traffic Engineering  
 Traffic Surveys

**MAILING ADDRESS:**  
 NC DEPARTMENT OF TRANSPORTATION  
 GEOGRAPHIC INFORMATION SYSTEMS UNIT  
 1521 MAIL SERVICE CENTER  
 RALEIGH, NC 27699-1521

Telephone: (919) 707-2165  
 FAX: 919-707-2210  
 Customer Service: 1-877-368-4968  
 Website: www.ncdot.gov

**LOCATION:**  
 4101 CAPITAL BLVD.  
 RALEIGH, NC 27604

# 2022 Road System Changes

---

**Petition Name:** Guilford\_2022\_07\_52540  
**Date:** 07/07/2022  
**County:** GUILFORD

## Additions

<b>Route</b>	<b>Street Name</b>	<b>Mileage</b>	<b>Map</b>
SR 5515	WILLIAM ERIE PL	0.05	
SR 5516	JOSEPH WESTON CT	0.08	

## Deletions

<b>Route</b>	<b>Street Name</b>	<b>Mileage</b>	<b>Map</b>
None			

## Reassignments

<b>Existing Route</b>	<b>New Route</b>	<b>Street Name</b>	<b>Mileage</b>	<b>Map</b>
None				

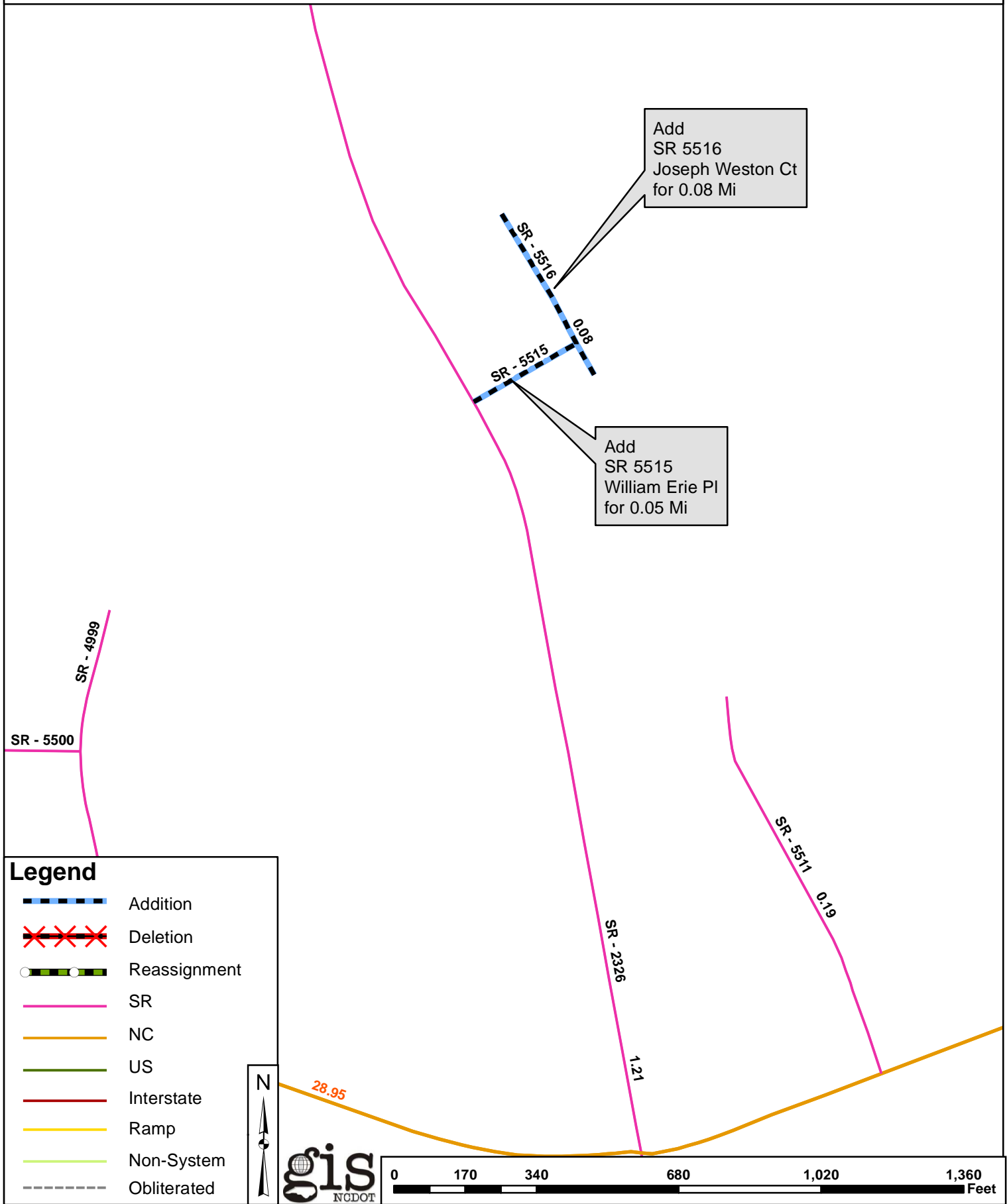

**Legend**

-  Addition
-  Deletion
-  Reassignment
-  SR
-  NC
-  US
-  Interstate
-  Ramp
-  Non-System
-  Obliterated

