



STATE OF NORTH CAROLINA
DEPARTMENT OF TRANSPORTATION

ROY COOPER
GOVERNOR

J. ERIC BOYETTE
SECRETARY

DATE: July 11, 2022
TO: Tim Anderson, PE
Division Engineer
Division 13
FROM: Erin Lesh, GISP
Supervisor, Spatial Data Operations Group
Geographic Information Systems Unit
SUBJECT: 2022 District 1 Road System Changes

The GIS Unit's Spatial Data Operations Group has been authorized to make the changes indicated below to the state road system. We request that you update the related maps and files in your offices and install appropriate road number signs, if necessary. If our system changes do not conform to the actual conditions in the field, please return this memorandum with recommendations.

Document Number	County	Approval Date
COR_012_06-22_1	BURKE	06/08/2022

Questions or comments about changes should be referred to the GIS Help Desk at GISHelp@ncdot.gov.

Thank you for your assistance.

EAL

cc: BSIP
Bridge Maintenance
Division Right of Way
IMG
Pavement Management
Permit Unit
State Road Maintenance
Traffic Engineering
Traffic Surveys

MAILING ADDRESS:
NC DEPARTMENT OF TRANSPORTATION
GEOGRAPHIC INFORMATION SYSTEMS UNIT
1521 MAIL SERVICE CENTER
RALEIGH, NC 27699-1521

Telephone: (919) 707-2165
FAX: 919-707-2210
Customer Service: 1-877-368-4968
Website: www.ncdot.gov

LOCATION:
4101 CAPITAL BLVD.
RALEIGH, NC 27604

2022 Road System Changes

Project Name: COR_012_06-22_1
Date: 06/08/2022
County: BURKE

Additions

Route	Street Name	Mileage	Map
SR 1366	CAMDEN POINTE DR	0.11	

Deletions

Route	Street Name	Mileage	Map
None			

Reassignments

Existing Route	New Route	Street Name	Mileage	Map
None				

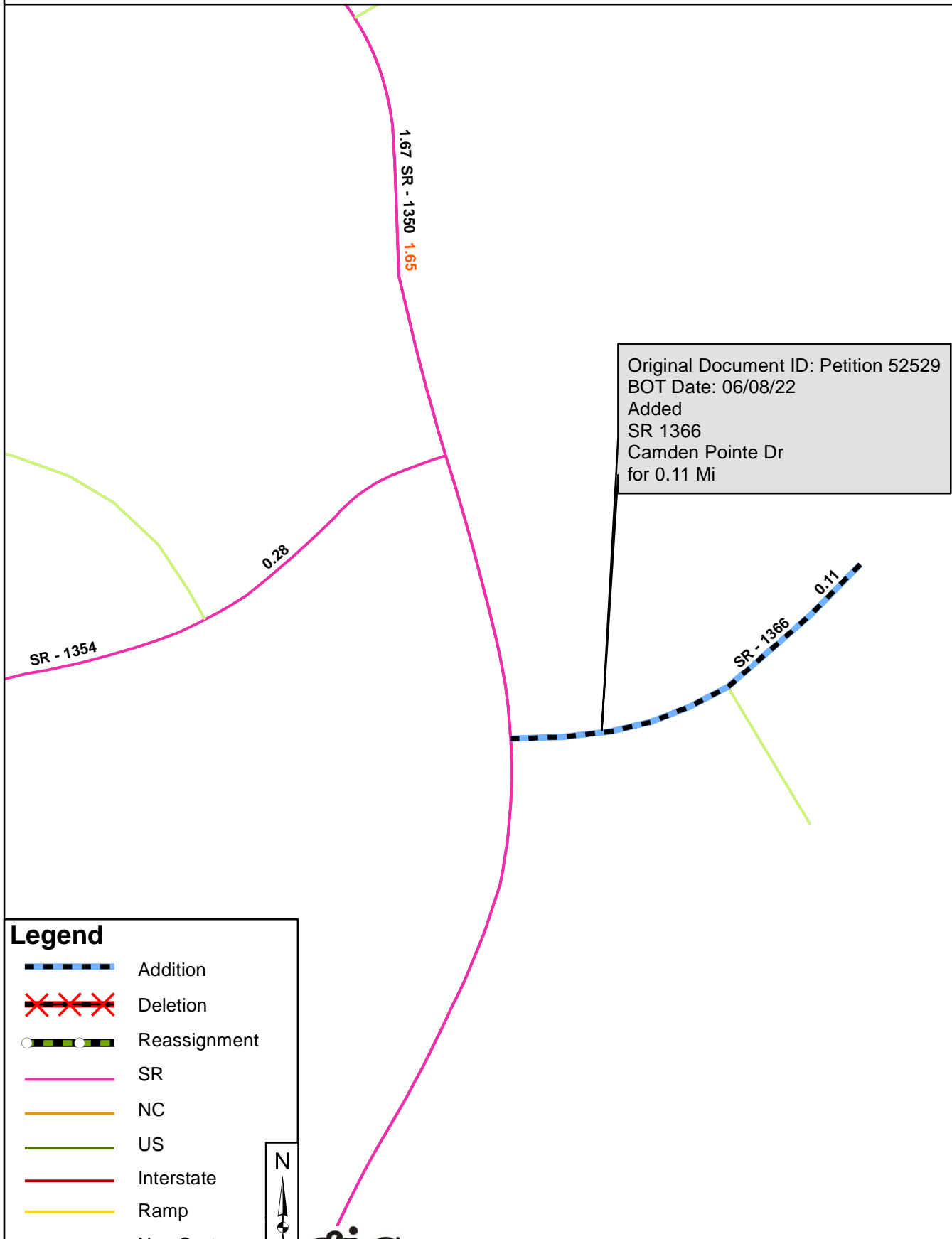

Legend

-  Addition
-  Deletion
-  Reassignment
-  SR
-  NC
-  US
-  Interstate
-  Ramp
-  Non-System
-  Obliterated

