



STATE OF NORTH CAROLINA  
DEPARTMENT OF TRANSPORTATION

ROY COOPER  
GOVERNOR

J. ERIC BOYETTE  
SECRETARY

**DATE:** June 14, 2022  
**TO:** Brandon H. Jones, PE  
Division Engineer  
Division 5  
**FROM:** Erin Lesh, GISP  
Supervisor, Spatial Data Operations Group  
Geographic Information Systems Unit  
**SUBJECT:** 2022 District 1 Road System Changes

The GIS Unit's Spatial Data Operations Group has been authorized to make the changes indicated below to the state road system. We request that you update the related maps and files in your offices and install appropriate road number signs, if necessary. If our system changes do not conform to the actual conditions in the field, please return this memorandum with recommendations.

Document Number	County	Approval Date
Wake_2022_06_52524	WAKE	06/08/2022

Questions or comments about changes should be referred to the GIS Help Desk at GISHelp@ncdot.gov.

Thank you for your assistance.

EAL

cc: BSIP  
Bridge Maintenance  
Division Right of Way  
IMG  
Pavement Management  
Permit Unit  
State Road Maintenance  
Traffic Engineering  
Traffic Surveys

**MAILING ADDRESS:**  
NC DEPARTMENT OF TRANSPORTATION  
GEOGRAPHIC INFORMATION SYSTEMS UNIT  
1521 MAIL SERVICE CENTER  
RALEIGH, NC 27699-1521

Telephone: (919) 707-2165  
FAX: 919-707-2210  
Customer Service: 1-877-368-4968  
Website: www.ncdot.gov

**LOCATION:**  
4101 CAPITAL BLVD.  
RALEIGH, NC 27604

# 2022 Road System Changes

---

**Petition Name:** Wake\_2022\_06\_52524  
**Date:** 06/08/2022  
**County:** WAKE

## Additions

<b>Route</b>	<b>Street Name</b>	<b>Mileage</b>	<b>Map</b>
SR 5919 EXT	OLDE WAVERLY WAY	0.14	
SR 5986	GALEGA DR	0.14	
SR 5987	BARBERRY LAKE CT	0.11	

---

## Deletions

<b>Route</b>	<b>Street Name</b>	<b>Mileage</b>	<b>Map</b>
None			

---

## Reassignments

<b>Existing Route</b>	<b>New Route</b>	<b>Street Name</b>	<b>Mileage</b>	<b>Map</b>
None				

---

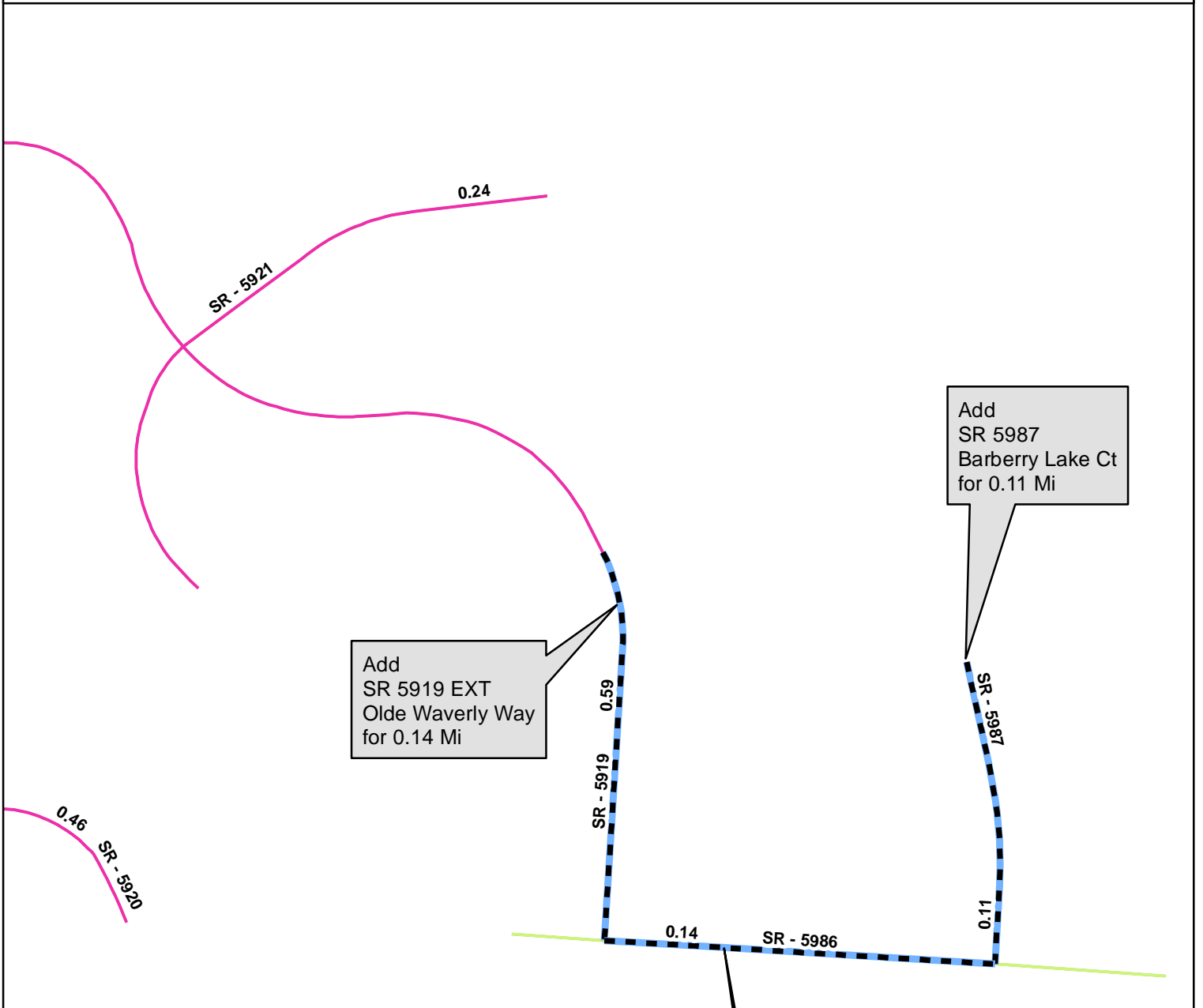

**Legend**

- Addition
- Deletion
- Reassignment
- SR
- NC
- US
- Interstate
- Ramp
- Non-System
- Obliterated

N

0 155 310 620 930 1,240 Feet