



STATE OF NORTH CAROLINA  
DEPARTMENT OF TRANSPORTATION

ROY COOPER  
GOVERNOR

J. ERIC BOYETTE  
SECRETARY

**DATE:** March 16, 2021  
**TO:** Mr. Chad D. Kimes, PE  
Division Engineer  
Division 3  
**FROM:** Vacant  
Manager  
Geographic Information Systems Unit  
**SUBJECT:** 2021 District 1 Road System Changes

The GIS Unit's Spatial Data Operations Group has been authorized to make the changes indicated below to the state road system. We request that you update the related maps and files in your offices and install appropriate road number signs, if necessary. If our system changes do not conform to the actual conditions in the field, please return this memorandum with recommendations.

Document Number	County	Approval Date
Pender 2021 03 52247	PENDER	03/04/2021

Questions or comments about changes should be referred to the GIS Help Desk at GISHelp@ncdot.gov.

Thank you for your assistance.

EAL

cc: BSIP  
Bridge Maintenance  
Division Right of Way  
IMG  
Pavement Management  
Permit Unit  
State Road Maintenance  
Traffic Engineering  
Traffic Surveys

**MAILING ADDRESS:**  
NC DEPARTMENT OF TRANSPORTATION  
GEOGRAPHIC INFORMATION SYSTEMS UNIT  
1521 MAIL SERVICE CENTER  
RALEIGH, NC 27699-1521

Telephone: (919) 707-2165  
FAX: 919-707-2210  
Customer Service: 1-877-368-4968  
Website: www.ncdot.gov

**LOCATION:**  
4101 CAPITAL BLVD.  
RALEIGH, NC 27604

# 2021 Road System Changes

---

**Petition Name:** Pender\_2021\_03\_52247  
**Date:** 03/04/2021  
**County:** PENDER

## Additions

<b>Route</b>	<b>Street Name</b>	<b>Mileage</b>	<b>Map</b>
SR 1796	WALDORF WAY	0.4	
SR 1797	BRAMBLE DR	0.03	
SR 1799	JULEP TRACE	0.03	
SR 1798	SHANDY WAY	0.03	
SR 1800	COLLINS WAY	0.2	
SR 1801	MILANO CT	0.04	
SR 1802	KENSINGTON CT	0.07	

---

## Deletions

<b>Route</b>	<b>Street Name</b>	<b>Mileage</b>	<b>Map</b>
None			

---

## Reassignments

<b>Existing Route</b>	<b>New Route</b>	<b>Street Name</b>	<b>Mileage</b>	<b>Map</b>
None				

---

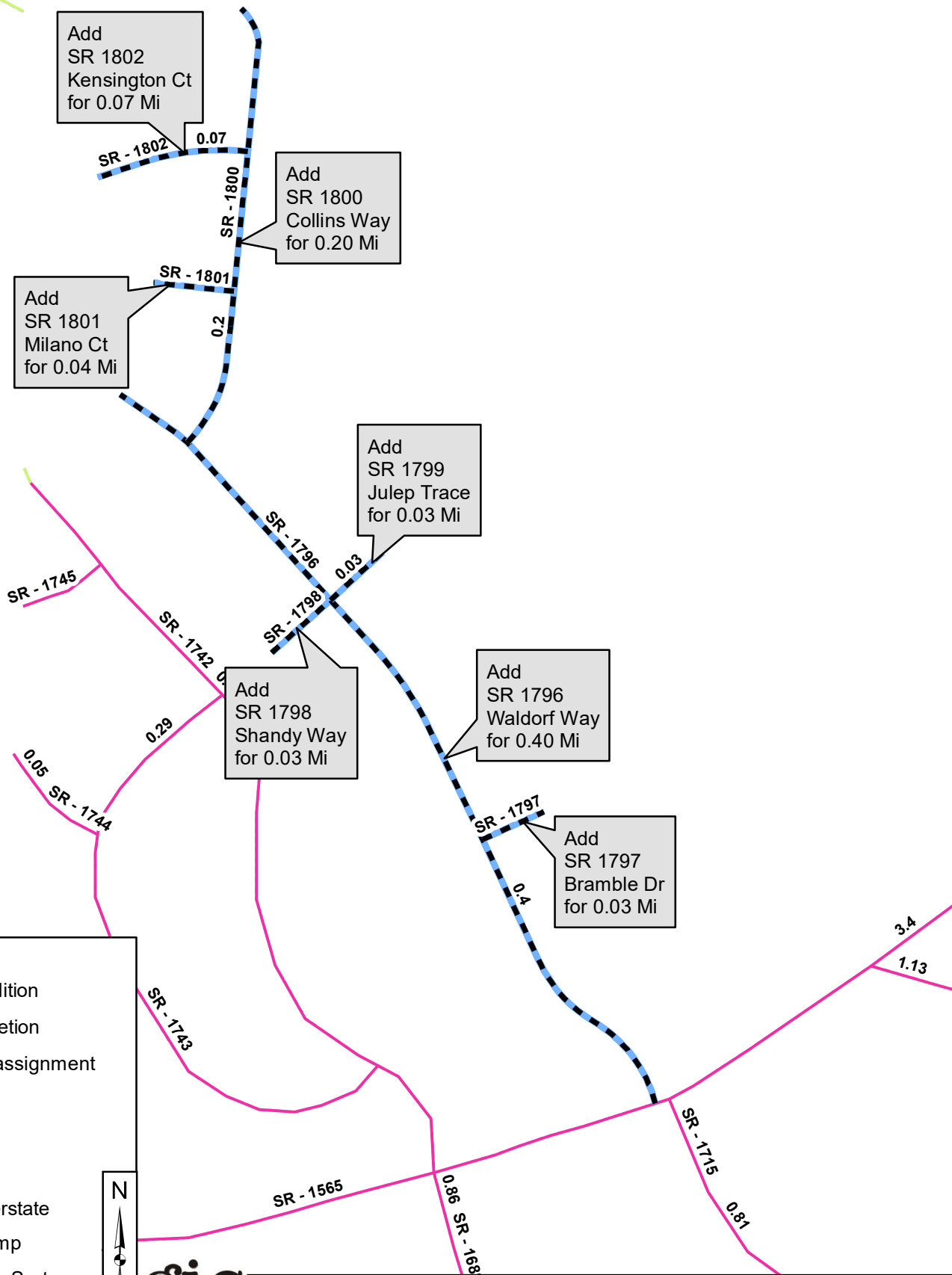

**Legend**

-  Addition
-  Deletion
-  Reassignment
-  SR
-  NC
-  US
-  Interstate
-  Ramp
-  Non-System
-  Obliterated

