



STATE OF NORTH CAROLINA
DEPARTMENT OF TRANSPORTATION

ROY COOPER
GOVERNOR

JAMES H. TROGDON, III
SECRETARY

DATE: December 17, 2018
TO: Mr. C.E. Lassiter, PE
Division Engineer
Division 2
FROM: John C. Farley
Manager
Geographic Information Systems Unit
SUBJECT: 2018 District 1 Road System Changes

The GIS Unit's Data Conversion Group has been authorized to make the changes indicated below to the state road system. We request that you update the related maps and files in your offices and install appropriate road number signs, if necessary. If our system changes do not conform to the actual conditions in the field, please return this memorandum with recommendations.

| Document Number | County | Approval Date |
|------------------------|----------|---------------|
| Beaufort 2018 12 51761 | BEAUFORT | 12/06/2018 |

Questions or comments about changes should be referred to the GIS Help Desk at GISHelp@ncdot.gov.

Thank you for your assistance.

JCF

cc: BSIP
Bridge Maintenance
Division Right of Way
IMG
Pavement Management
Permit Unit
State Road Maintenance
Traffic Engineering
Traffic Surveys

MAILING ADDRESS:
NC DEPARTMENT OF TRANSPORTATION
GEOGRAPHIC INFORMATION SYSTEMS UNIT
1521 MAIL SERVICE CENTER
RALEIGH, NC 27699-1521

Telephone: (919) 707-2165
FAX: 919-707-2210
Customer Service: 1-877-368-4968
Website: www.ncdot.gov

LOCATION:
4101 CAPITAL BLVD.
RALEIGH, NC 27604

2018 Road System Changes

Petition Name: Beaufort_2018_12_51761
Date: 12/06/2018
County: BEAUFORT

Additions

| Route | Street Name | Mileage | Map |
|--------------|--------------------|----------------|------------|
| None | | | |

Deletions

| Route | Street Name | Mileage | Map |
|--------------|--------------------|----------------|------------|
| SR 1169 | SAWYER RD | 0.5 | |

Reassignments

| Existing Route | New Route | Street Name | Mileage | Map |
|-----------------------|------------------|--------------------|----------------|------------|
| None | | | | |

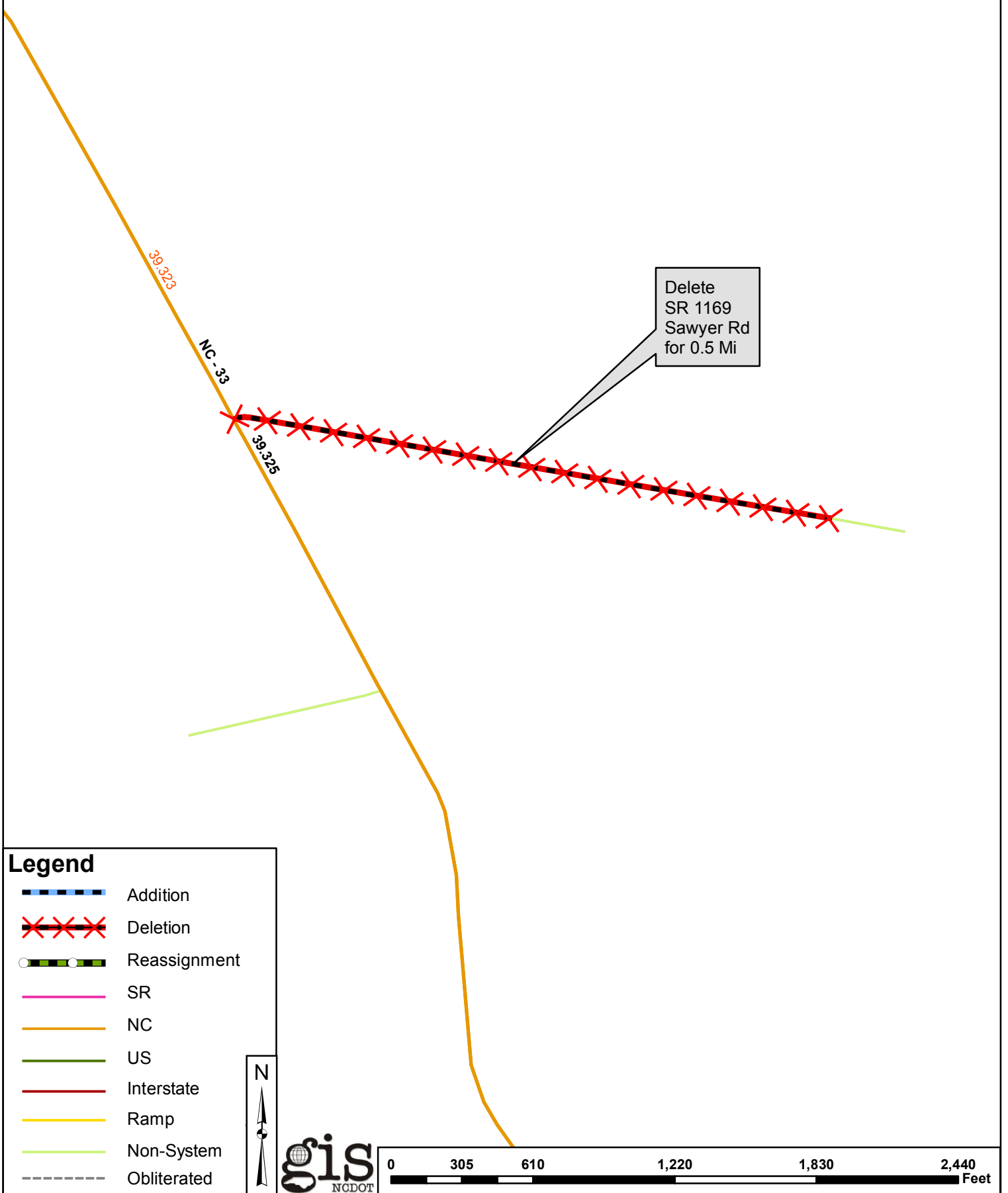

Delete
SR 1169
Sawyer Rd
for 0.5 Mi

Legend

- Addition
- Deletion
- Reassignment
- SR
- NC
- US
- Interstate
- Ramp
- Non-System
- Obliterated

N

gis
NCDOT

