



STATE OF NORTH CAROLINA  
DEPARTMENT OF TRANSPORTATION

ROY COOPER  
GOVERNOR

JAMES H. TROGDON, III  
SECRETARY

**DATE:** May 23, 2018  
**TO:** Mr. Joseph R. Hopkins, PE  
Division Engineer  
Division 5  
**FROM:** Mr. John C. Farley, GISP, CPM  
Manager  
Geographic Information Systems Unit  
**SUBJECT:** 2018 District 2 Road System Changes

The GIS Unit's Data Conversion Group has been authorized to make the changes indicated below to the state road system. We request that you update the related maps and files in your offices and install appropriate road number signs, if necessary. If our system changes do not conform to the actual conditions in the field, please return this memorandum with recommendations.

Petition	County	Approval Date
GRANVILLE_2018_05_51610	GRANVILLE	5/3/2018

Questions or comments about changes should be referred to the GIS Help Desk at GISHelp@ncdot.gov.

Thank you for your assistance.

JCF

- cc: BSIP
- Bridge Maintenance
- Division Right of Way
- IMG
- Pavement Management
- Permit Unit
- State Road Maintenance
- Traffic Engineering
- Traffic Surveys

# 2018 ROAD SYSTEM CHANGES

<b>PETITION</b>	<b>COUNTY</b>	<b>APPROVAL DATE</b>	<b>ROUTE NUMBER</b>	<b>PORTION REASSIGNED TO</b>	<b>STREET NAME</b>	<b>LENGTH (miles)</b>	<b>TYPE OF CHANGE</b>	<b>REMARKS (See Attached Map)</b>
GRANVILLE_2018_05_5161 0	GRANVILLE	5/3/2018	SR 1842		PIER POINTE DR	0.17	SYSTEM ADDITION VIA PETITION	
GRANVILLE_2018_05_5161 0	GRANVILLE	5/3/2018	SR 1841		SANDY CT	0.08	SYSTEM ADDITION VIA PETITION	
GRANVILLE_2018_05_5161 0	GRANVILLE	5/3/2018	SR 1840		LAKE RIDGE DR	0.46	SYSTEM ADDITION VIA PETITION	

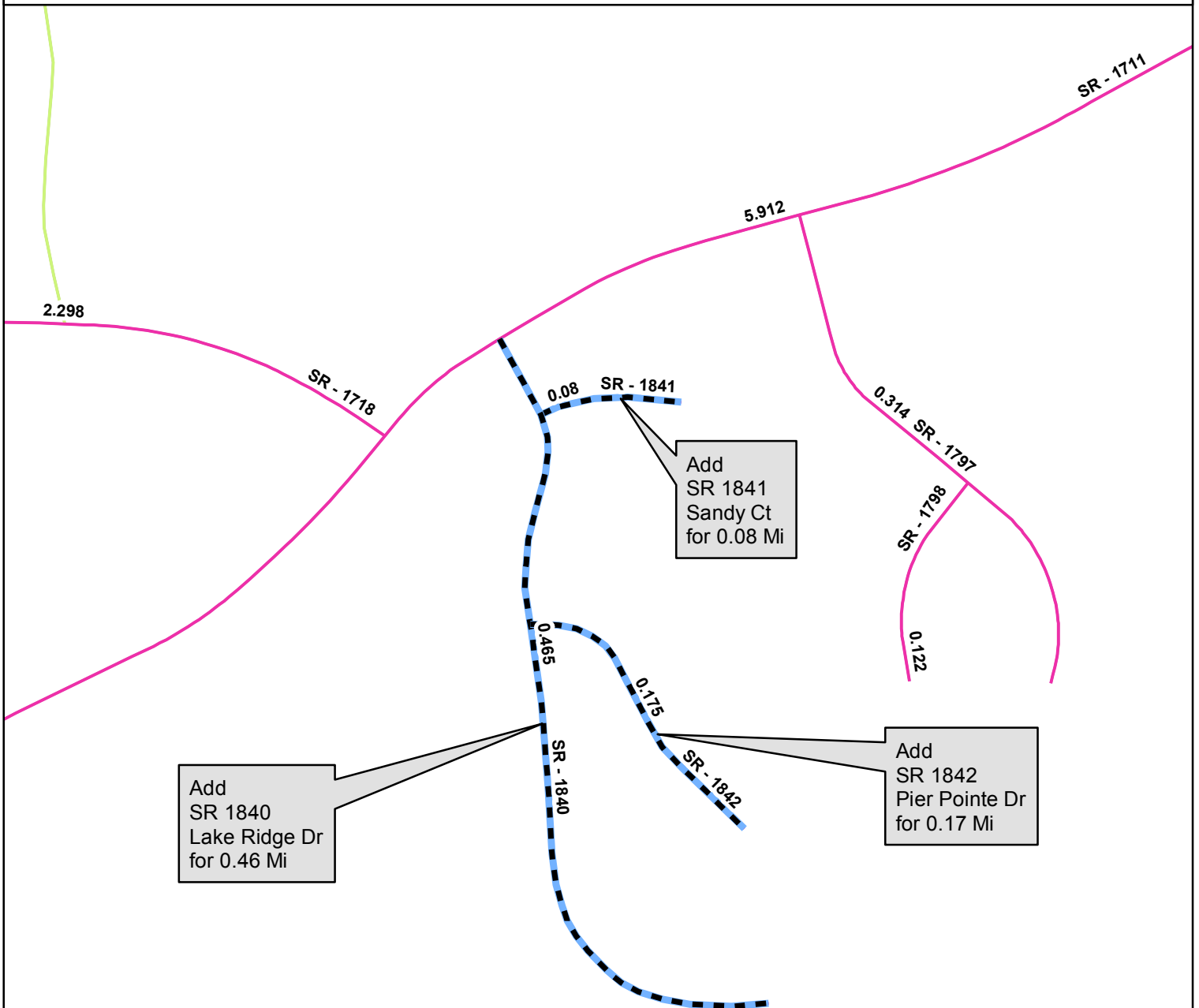









Add  
SR 1840  
Lake Ridge Dr  
for 0.46 Mi

Add  
SR 1841  
Sandy Ct  
for 0.08 Mi

Add  
SR 1842  
Pier Pointe Dr  
for 0.17 Mi

**Legend**

-  Addition
-  Deletion
-  Reassignment
-  SR
-  NC
-  US
-  Interstate
-  Ramp
-  Non-System
-  Obliterated

