



STATE OF NORTH CAROLINA
DEPARTMENT OF TRANSPORTATION

ROY COOPER
GOVERNOR

JAMES H. TROGDON, III
SECRETARY

DATE: March 25, 2019
TO: Mr. Timothy Johnson, PE
Division Engineer
Division 8
FROM: John C. Farley
Manager
Geographic Information Systems Unit
SUBJECT: 2019 District 3 Road System Changes

The GIS Unit's Data Conversion Group has been authorized to make the changes indicated below to the state road system. We request that you update the related maps and files in your offices and install appropriate road number signs, if necessary. If our system changes do not conform to the actual conditions in the field, please return this memorandum with recommendations.

Document Number	County	Approval Date
R-3421C	RICHMOND	03/30/2018

Questions or comments about changes should be referred to the GIS Help Desk at GISHelp@ncdot.gov.

Thank you for your assistance.

JCF

cc: BSIP
Bridge Maintenance
Division Right of Way
IMG
Pavement Management
Permit Unit
State Road Maintenance
Traffic Engineering
Traffic Surveys

MAILING ADDRESS:
NC DEPARTMENT OF TRANSPORTATION
GEOGRAPHIC INFORMATION SYSTEMS UNIT
1521 MAIL SERVICE CENTER
RALEIGH, NC 27699-1521

Telephone: (919) 707-2165
FAX: 919-707-2210
Customer Service: 1-877-368-4968
Website: www.ncdot.gov

LOCATION:
4101 CAPITAL BLVD.
RALEIGH, NC 27604

2019 Road System Changes

TIP Name: R-3421C
Date: 03/30/2018
County: RICHMOND

Additions

Route	Street Name	Mileage	Map
US 220		0.3	C
US 220		0.82	B
SR 1304		0.84	A
SR 1346		0.03	A
SR 1433		0.02	A
SR 1580		0.03	D
SR 1347		2.25	E
SR 1448		1.97	E
SR 1581		2.21	F
SR 1525		0.03	A

Deletions

Route	Street Name	Mileage	Map
US 220		0.74	B
US 220		0.31	C
SR 1302		0.06	A
SR 1433		0.06	A
SR 1304		0.41	A
SR 1525		0.07	A
SR 1305		0.12	B

Deletions

Route	Street Name	Mileage	Map
SR 1448		0.07	E

Reassignments

Existing Route	New Route	Street Name	Mileage	Map
SR 1448	SR 1580		0.26	D
SR 1304	SR 1346		0.14	A

Map A

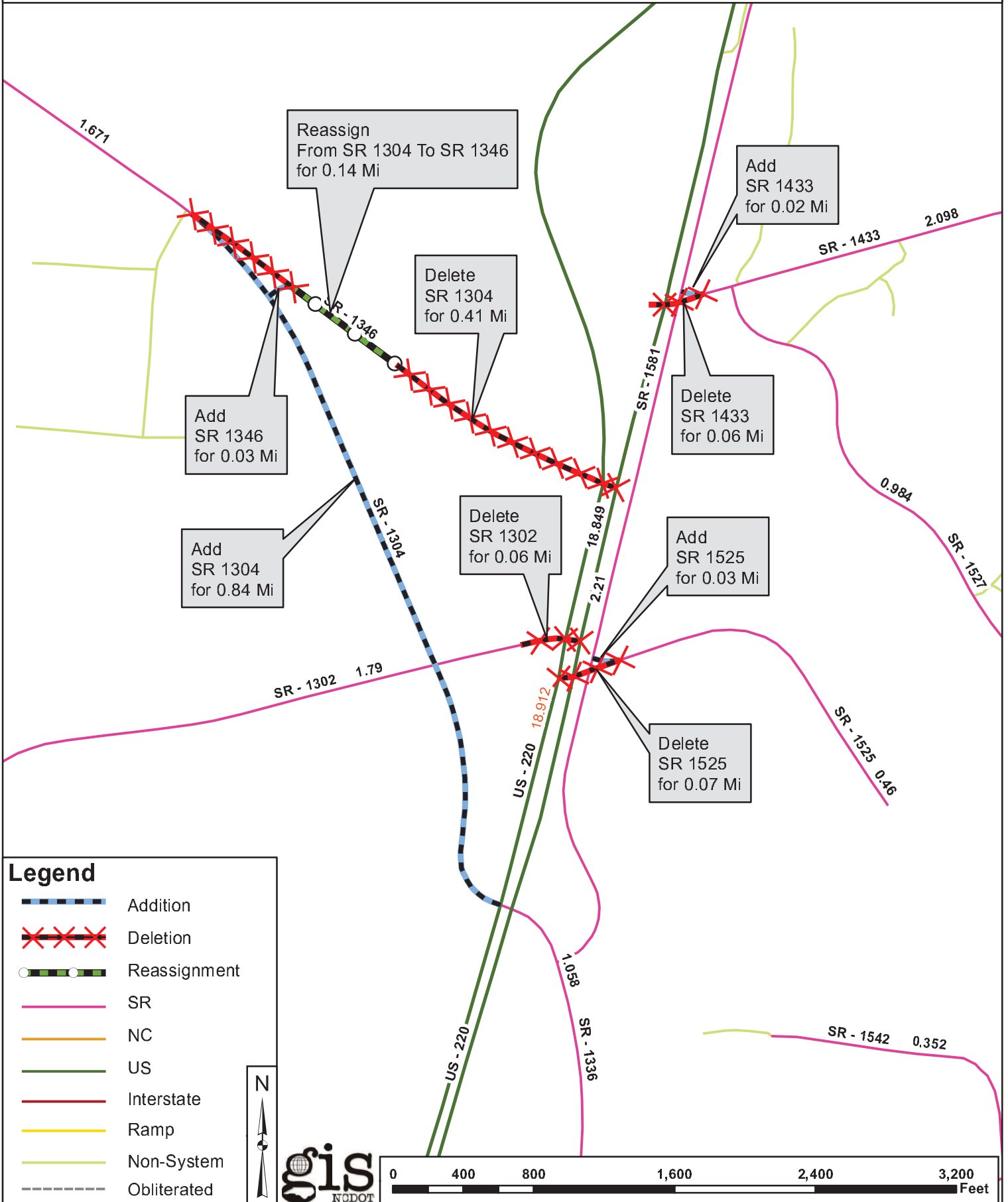

Map B

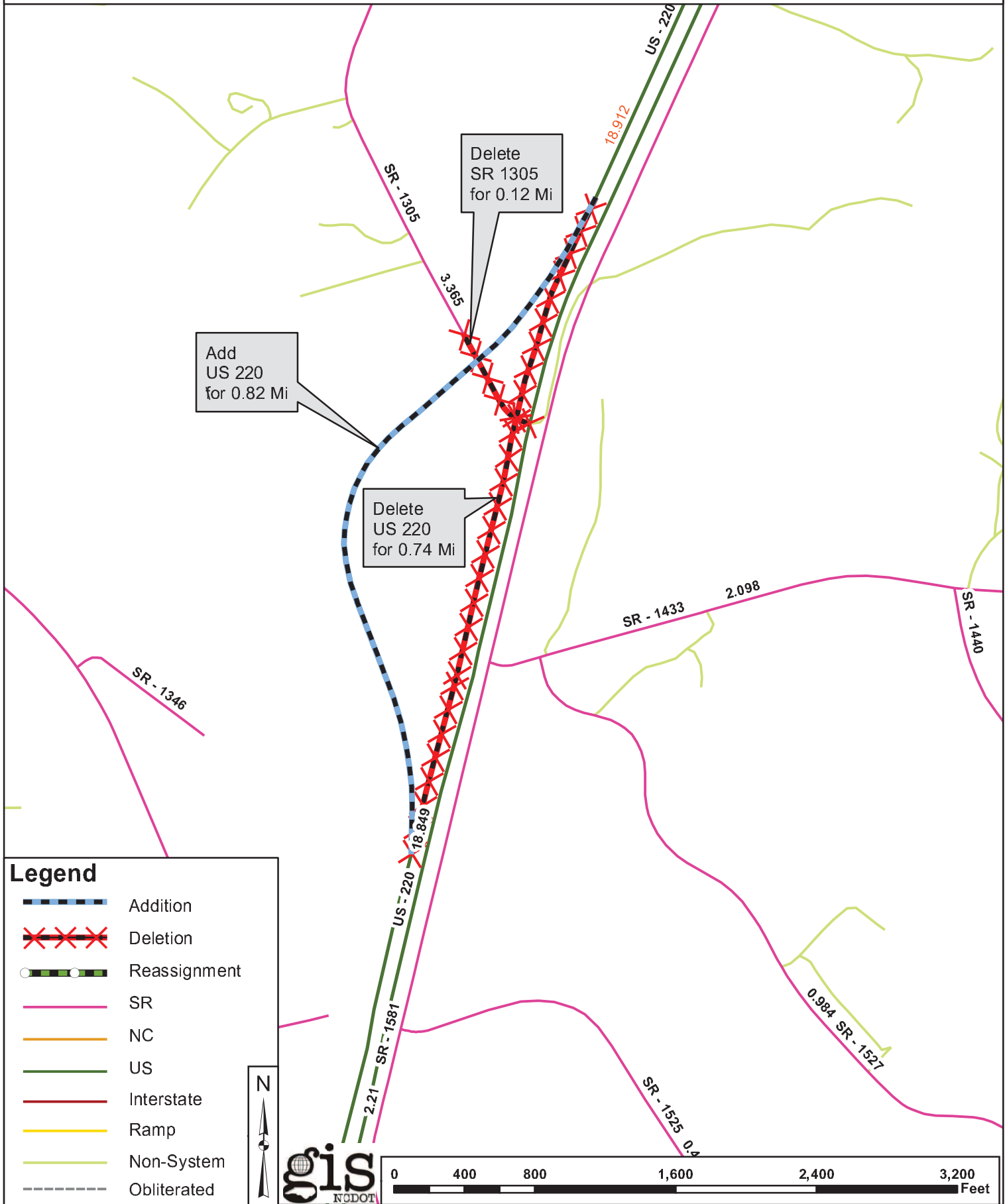

Add
US 220
for 0.82 Mi

Delete
SR 1305
for 0.12 Mi

Delete
US 220
for 0.74 Mi

Legend

-  Addition
-  Deletion
-  Reassignment
-  SR
-  NC
-  US
-  Interstate
-  Ramp
-  Non-System
-  Obliterated



Map C

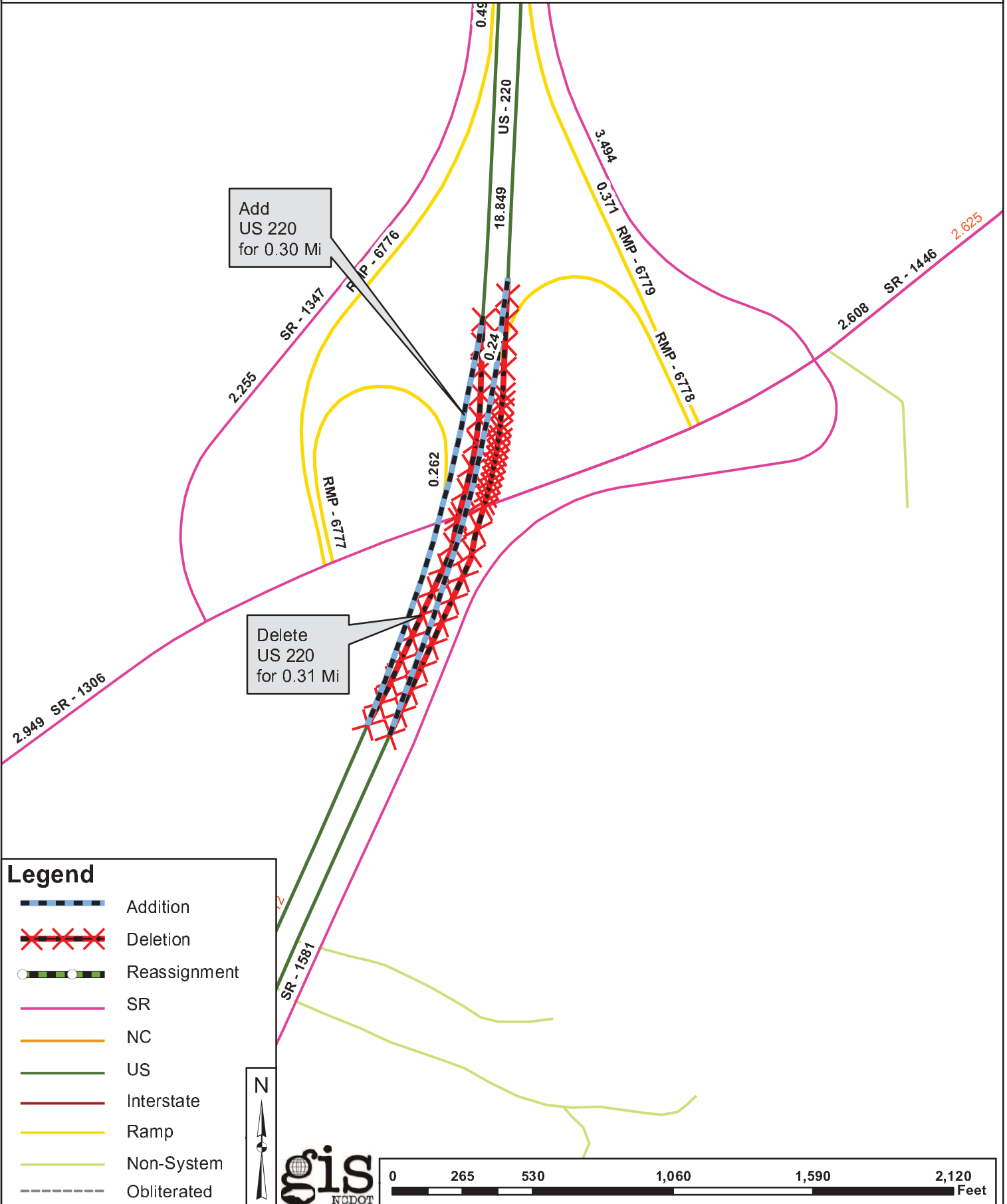

Add
US 220
for 0.30 Mi

Delete
US 220
for 0.31 Mi

Legend

-  Addition
-  Deletion
-  Reassignment
-  SR
-  NC
-  US
-  Interstate
-  Ramp
-  Non-System
-  Obliterated

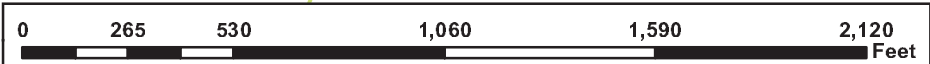

Map D

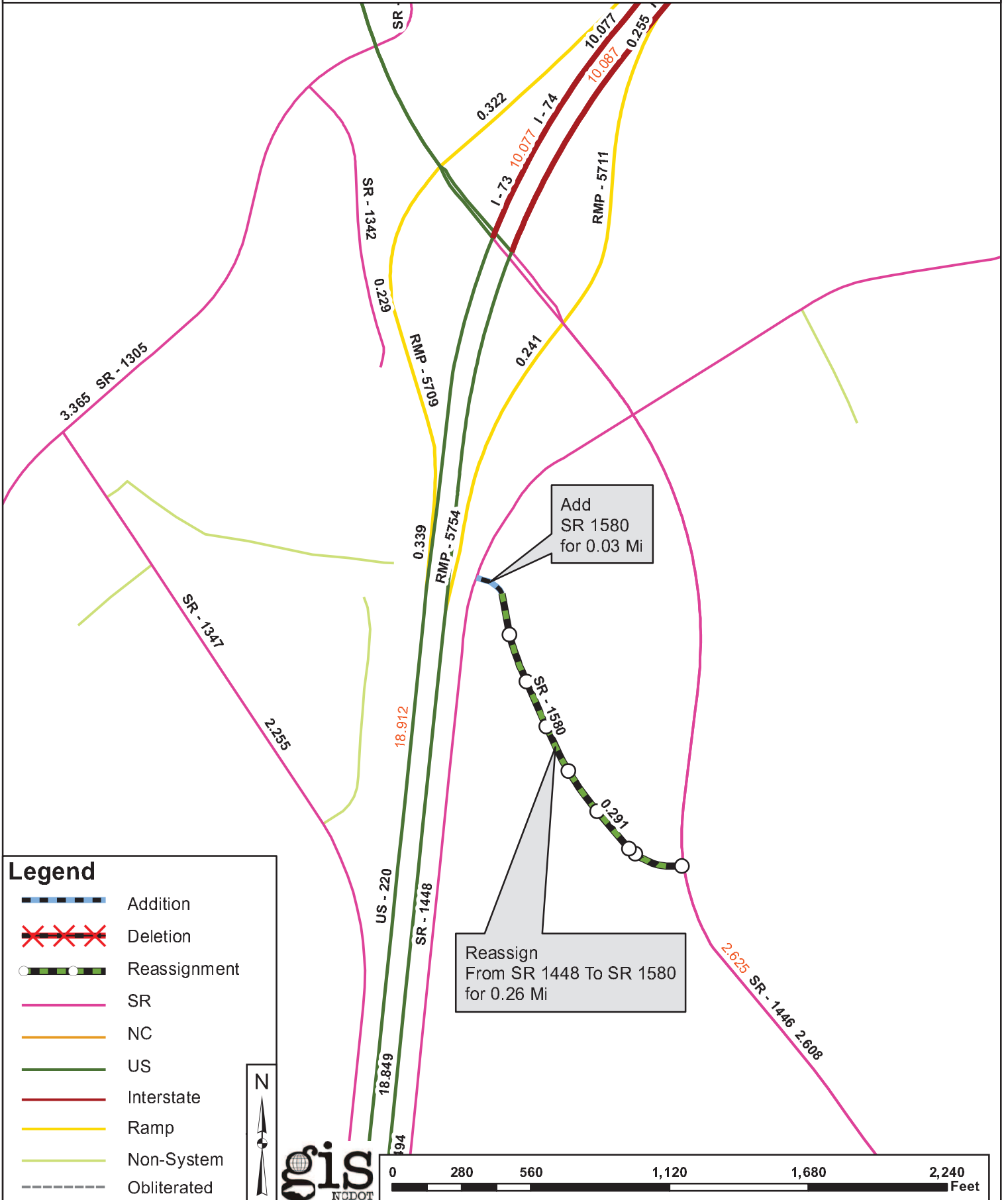

Map E

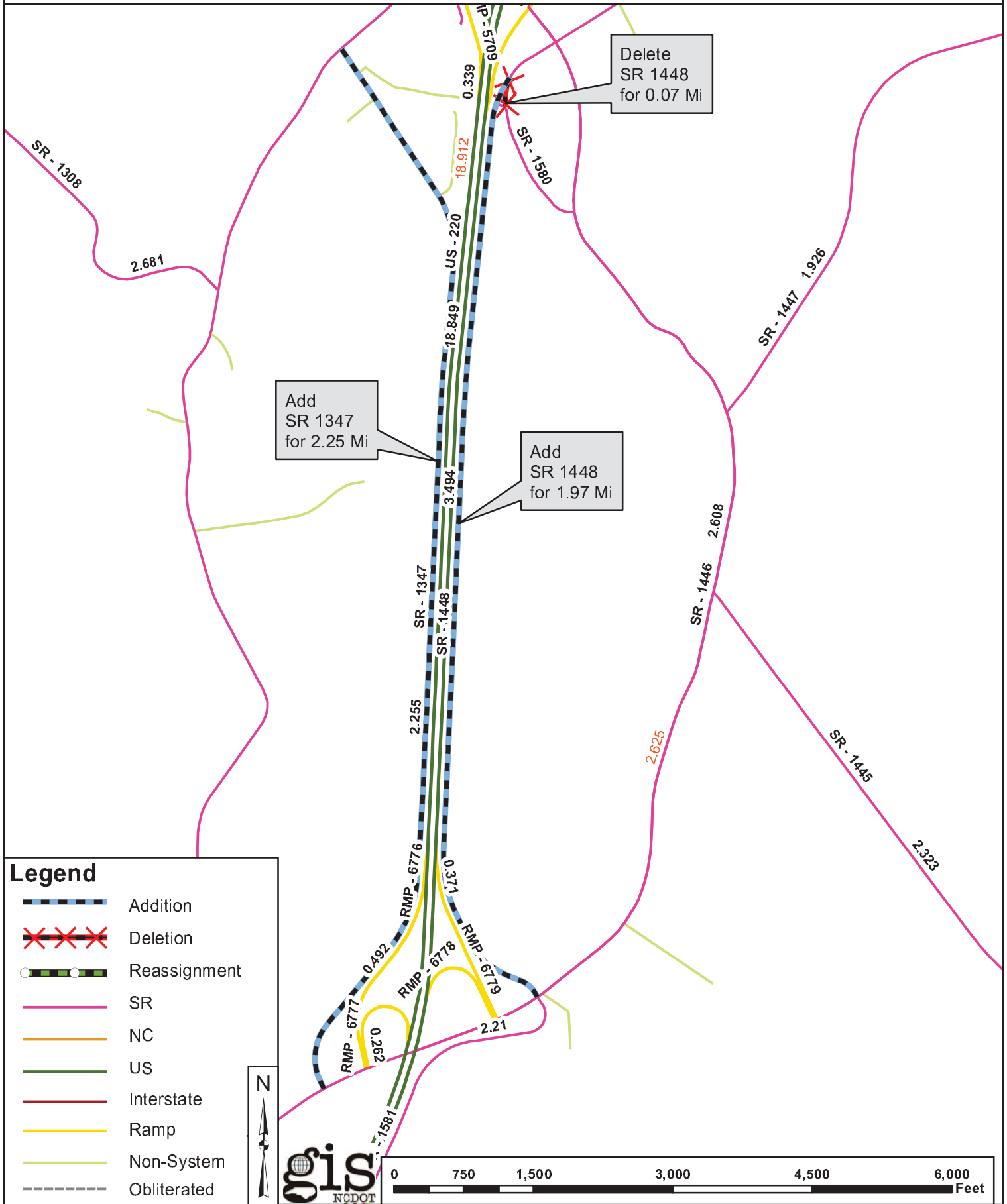

Legend

-  Addition
-  Deletion
-  Reassignment
-  SR
-  NC
-  US
-  Interstate
-  Ramp
-  Non-System
-  Obliterated



Map F

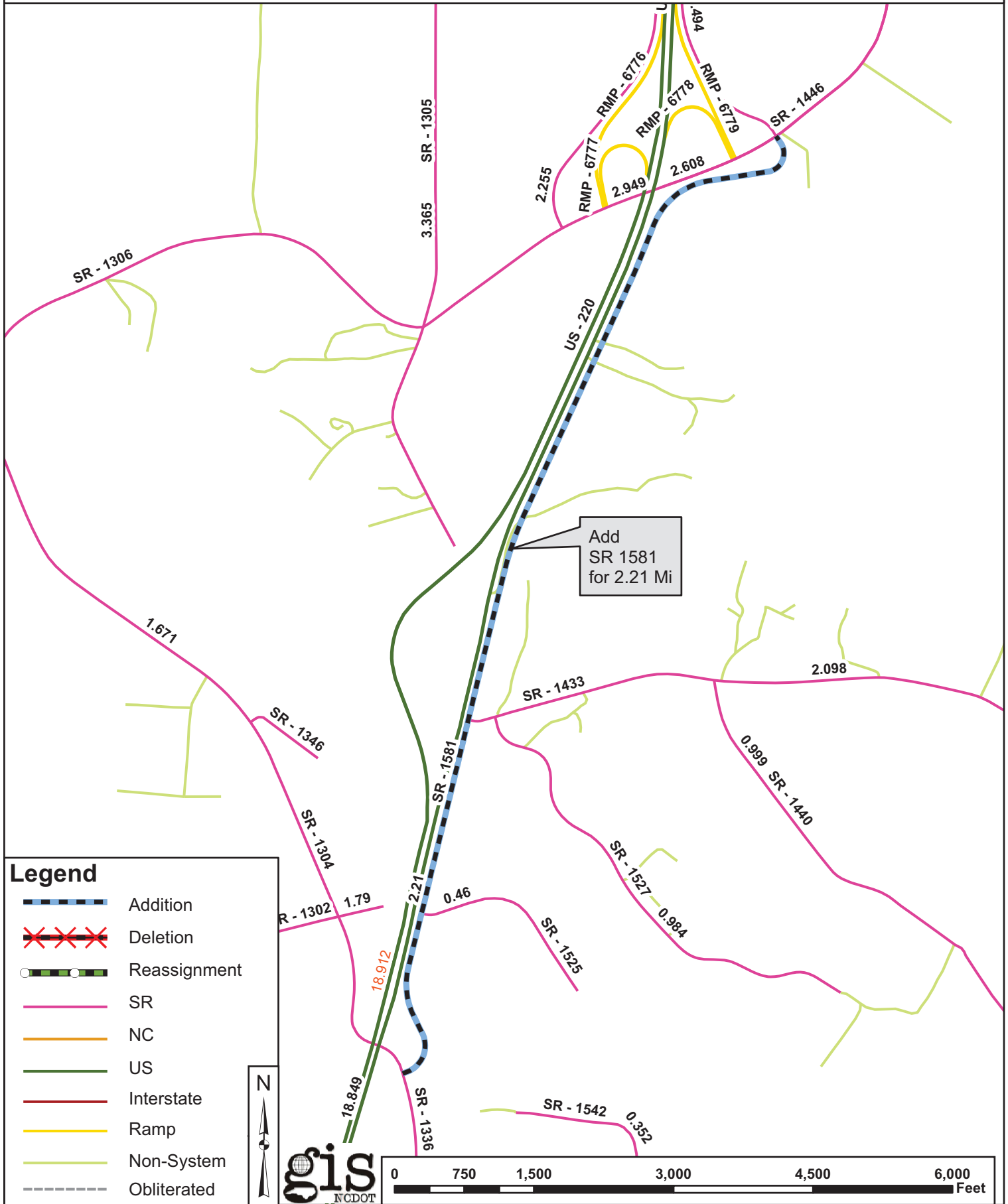

Add SR 1581 for 2.21 Mi

Legend

- Addition
- Deletion
- Reassignment
- SR
- NC
- US
- Interstate
- Ramp
- Non-System
- Obliterated

