



STATE OF NORTH CAROLINA  
DEPARTMENT OF TRANSPORTATION

ROY COOPER  
GOVERNOR

J.R. "JOEY" HOPKINS  
SECRETARY

**DATE:** June 13, 2024  
**TO:** Wright R. Archer, III, PE  
Division Engineer  
Division 7  
**FROM:** Erin Lesh, GISP  
Supervisor, Spatial Data Operations Group  
Geographic Information Systems Unit  
**SUBJECT:** 2024 District 2 Road System Changes - **REVISED**

The GIS Unit's Spatial Data Operations Group has been authorized to make the changes indicated below to the state road system. We request that you update the related maps and files in your offices and install appropriate road number signs, if necessary. If our system changes do not conform to the actual conditions in the field, please return this memorandum with recommendations.

Document Number	County	Approval Date
U-2525B	GUILFORD	12/06/2017

Questions or comments about changes should be referred to the GIS Help Desk at GISHelp@ncdot.gov.

Thank you for your assistance.

EAL

- cc: BSIP
- Bridge Maintenance
- Division Right of Way
- IMG
- Pavement Management
- Permit Unit
- State Road Maintenance
- Traffic Engineering
- Traffic Surveys

**MAILING ADDRESS:**  
NC DEPARTMENT OF TRANSPORTATION  
GEOGRAPHIC INFORMATION SYSTEMS UNIT  
1521 MAIL SERVICE CENTER  
RALEIGH, NC 27699-1521

Telephone: (919) 707-2165  
FAX: 919-707-2210  
Customer Service: 1-877-368-4968  
Website: www.ncdot.gov

**LOCATION:**  
1020 BIRCH RIDGE DR  
RALEIGH, NC 27610

# 2024 Road System Changes

---

**TIP Name:** U-2525B  
**Date:** 12/06/2017  
**County:** GUILFORD

## Additions

<b>Route</b>	<b>Street Name</b>	<b>Mileage</b>	<b>Map</b>
SR 5334		0.54	F
SR 9000		5.08	A
SR 2770		0.73	B
SR 5332		0.08	B
SR 2821		0.03	B
SR 2835		0.33	C
SR 5333		0.07	C
SR 5336		0.32	D
SR 5235		0.32	D
SR 5335		0.43	E
SR 2566		0.13	E
SR 2669		0.08	E
SR 2617		0.71	F

## Deletions

<b>Route</b>	<b>Street Name</b>	<b>Mileage</b>	<b>Map</b>
SR 2770		0.3	B
SR 2770		0.13	B
SR 2821		0.03	B
SR 2834		0.13	C

## Deletions

<b>Route</b>	<b>Street Name</b>	<b>Mileage</b>	<b>Map</b>
SR 2835		0.33	C
SR 2568		0.59	D
SR 2622		0.63	D
SR 2669		0.12	E
SR 2566		0.04	E
SR 2620		0.43	E
SR 2877		0.44	E
SR 2564		0.04	E
SR 2563		0.03	F
SR 2621		0.33	F
SR 2878		0.38	F
SR 2618		0.01	E

## Reassignments

<b>Existing Route</b>	<b>New Route</b>	<b>Street Name</b>	<b>Mileage</b>	<b>Map</b>
SR 2770	SR 5332		0.21	B
SR 2834	SR 5333		0.25	C
SR 2568	SR 5343		0.02	D
SR 2564	SR 5258		0.2	F

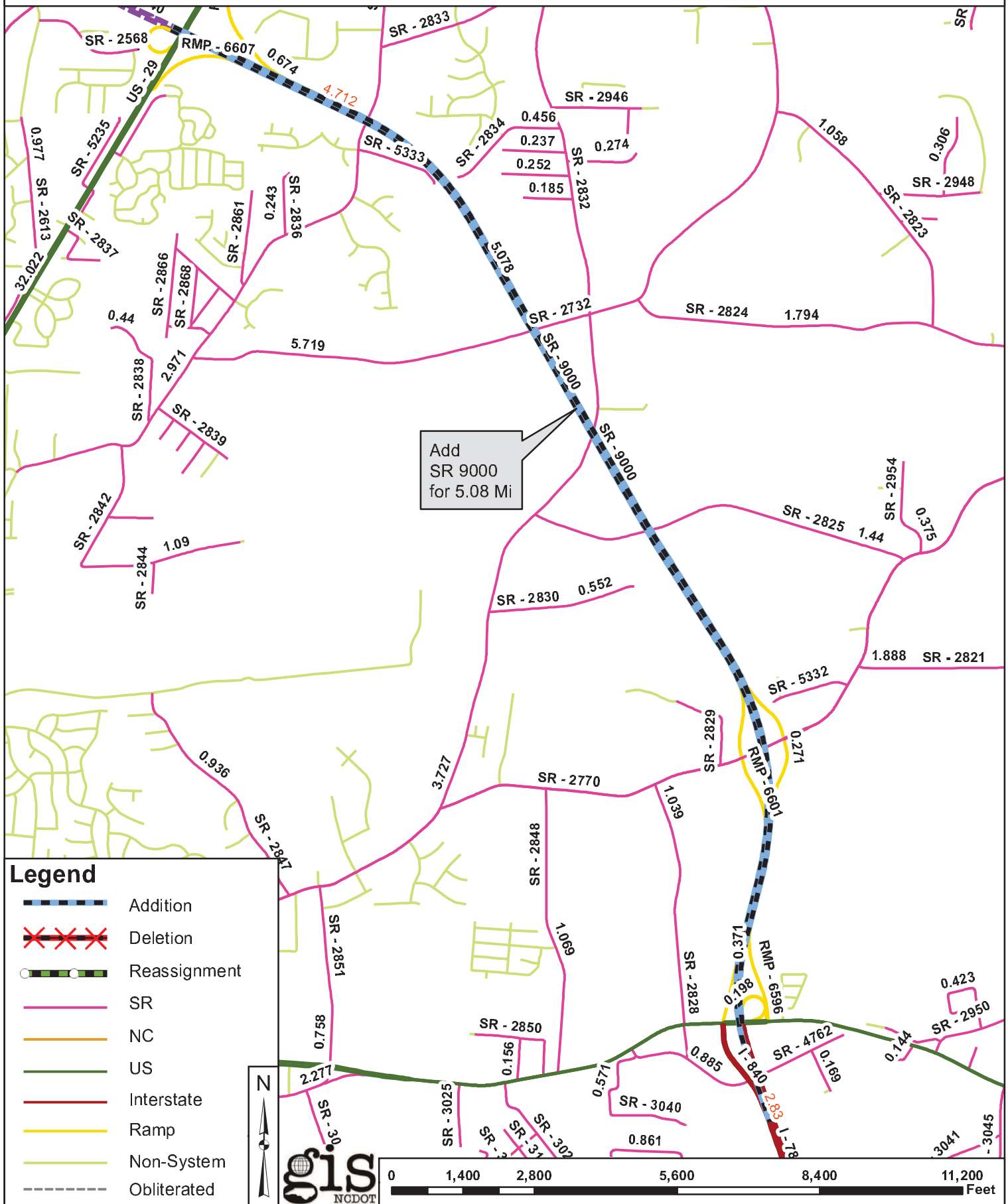

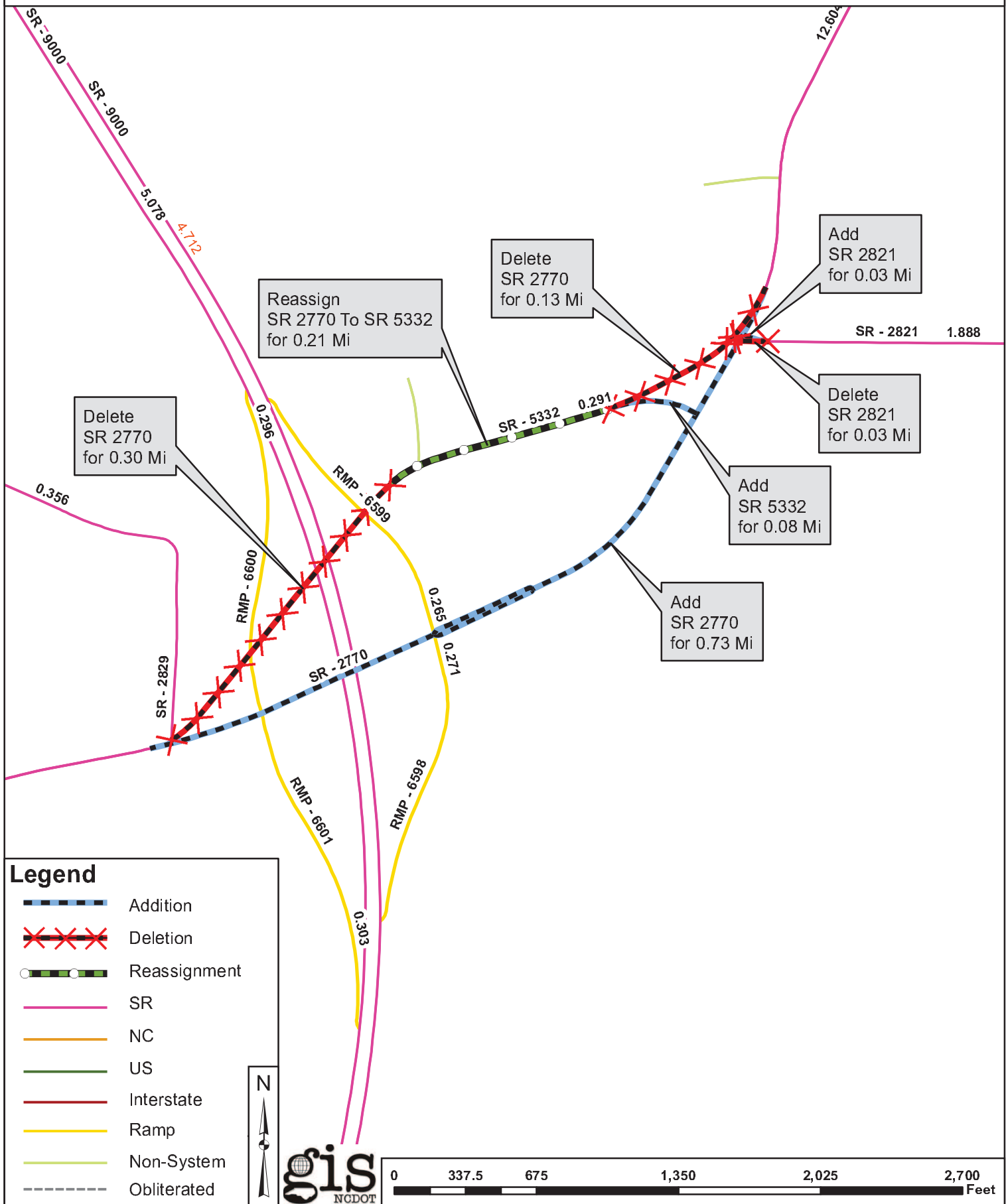

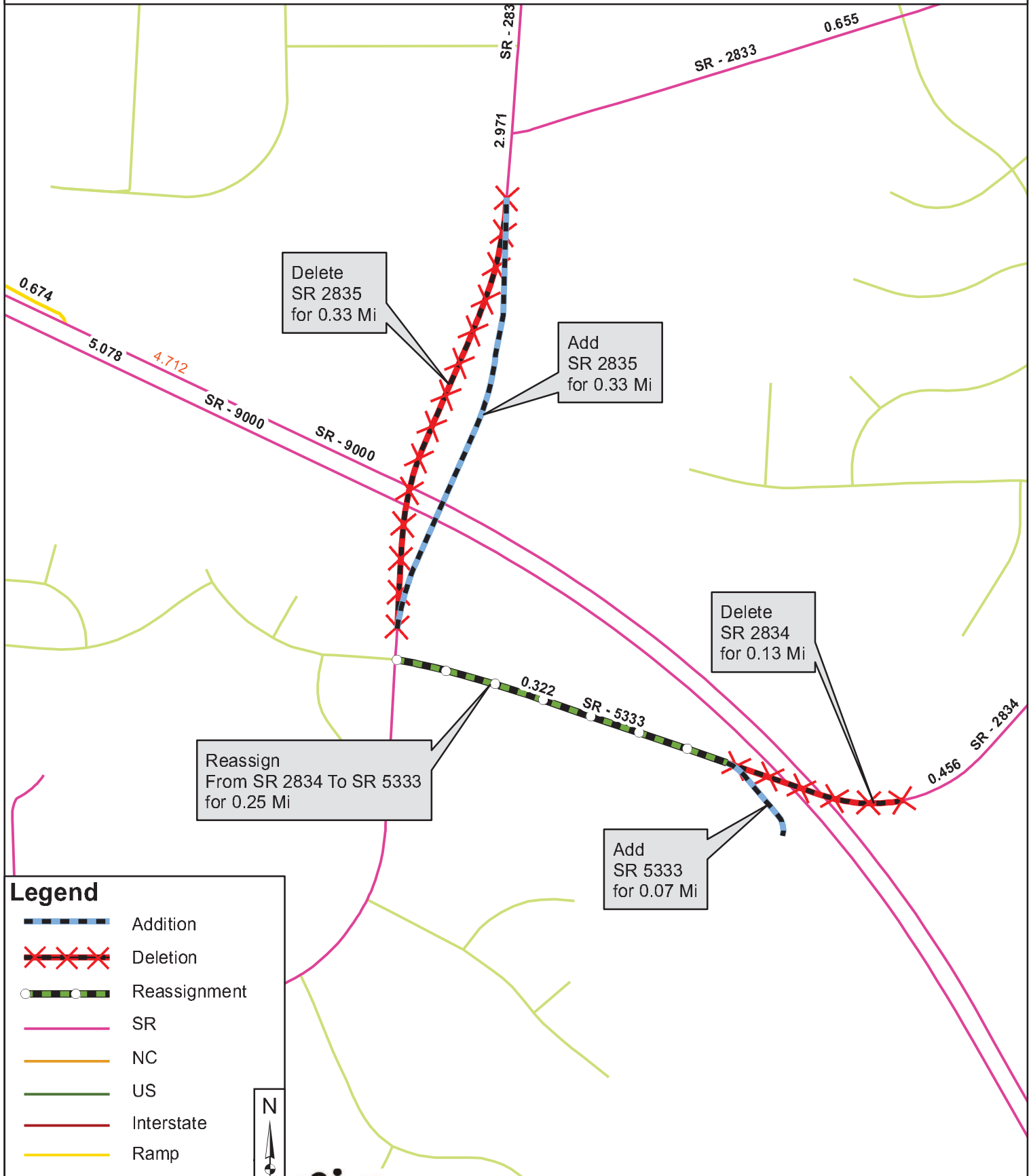

**Legend**

-  Addition
-  Deletion
-  Reassignment
-  SR
-  NC
-  US
-  Interstate
-  Ramp
-  Non-System
-  Obliterated

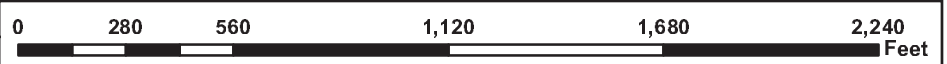

Document Number: U-2525B

Route Number(s):

Map Date: 09/03/19

County: Guilford

2622 2568 5235

5336 5343

Approval Date: 12/06/17

Map: D

