



ROY COOPER  
*Governor*  
MICHAEL L. HOLDER  
*Acting Secretary*

January 18, 2017

**MEMORANDUM TO:** Mr. Michael L. Holder, PE  
Division Engineer  
Division 12

**FROM:** Mr. John C. Farley, GISP, CPM  
Manager  
Geographic Information Systems Unit

**SUBJECT:** 2017 District 2 Road Sytem Changes

The GIS Unit's Data Conversion Group has been authorized to make the changes indicated below to the state road system. We request that you update the related maps and files in your offices and install appropriate road number signs, if necessary. If our system changes do not conform to the actual conditions in the field, please return this memorandum with recommendations.

Correction Number	County	Approval Date
COR_49_01-17_1	IREDELL	1/5/2017

Questions or comments about changes should be referred to the GIS Help Desk at [GISHelp@ncdot.gov](mailto:GISHelp@ncdot.gov). Thank you for your assistance.

JCF

cc: BSIP  
Bridge Maintenance  
Division Right of Way  
IMG  
Pavement Management  
Permit Unit  
State Road Maintenance  
Traffic Engineering  
Traffic Surveys

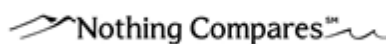

# 2017 ROAD SYSTEM CHANGES

<b>CORRECTION REQUEST</b>	<b>COUNTY</b>	<b>APPROVAL DATE</b>	<b>NEW ROUTE</b>	<b>EXISTING ROUTE</b>	<b>STREET NAME</b>	<b>LENGTH (miles)</b>	<b>TYPE OF CHANGE</b>	<b>REMARKS (See Attached Map)</b>
COR_49_01-17_1	IREDELL	1/5/2017		SR 2833	AUTUMN GROVE LANE	0.23	SYSTEM ADDITION - EXISTING VIA CORRECTION REQUEST	MAP , SEGMENT
COR_49_01-17_1	IREDELL	1/5/2017		SR 2832	EARLY FROST LANE	0.10	SYSTEM ADDITION - EXISTING VIA CORRECTION REQUEST	MAP , SEGMENT

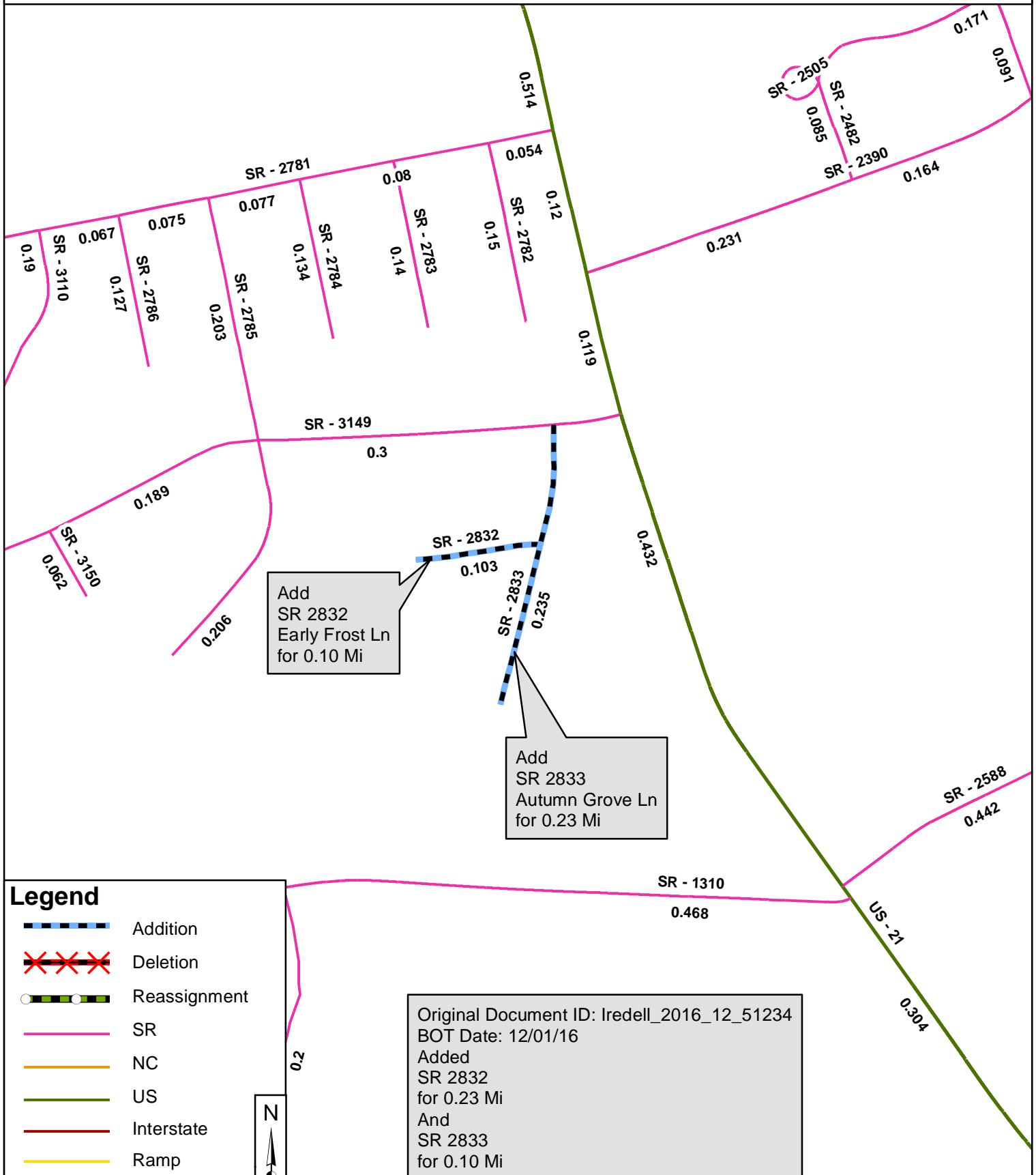

Add  
SR 2832  
Early Frost Ln  
for 0.10 Mi

Add  
SR 2833  
Autumn Grove Ln  
for 0.23 Mi

**Legend**

- Addition
- Deletion
- Reassignment
- SR
- NC
- US
- Interstate
- Ramp
- Non-System
- Obliterated



Original Document ID: Iredell\_2016\_12\_51234  
 BOT Date: 12/01/16  
 Added  
 SR 2832  
 for 0.23 Mi  
 And  
 SR 2833  
 for 0.10 Mi

