



ROY COOPER  
*Governor*  
MICHAEL L. HOLDER  
*Acting Secretary*

January 13, 2017

**MEMORANDUM TO:** Mrs. Karen E. Collette, PE  
Division Engineer  
Division 3

**FROM:** Mr. John C. Farley, GISP, CPM  
Manager  
Geographic Information Systems Unit

**SUBJECT:** 2017 District 1 Road System Changes

The GIS Unit's Data Conversion Group has been authorized to make the changes indicated below to the state road system. We request that you update the related maps and files in your offices and install appropriate road number signs, if necessary. If our system changes do not conform to the actual conditions in the field, please return this memorandum with recommendations.

Petition	County	Approval Date
ONSLow_2017_01_51247	ONSLow	1/5/2017

Questions or comments about changes should be referred to the GIS Help Desk at [GISHelp@ncdot.gov](mailto:GISHelp@ncdot.gov).

Thank you for your assistance.

JCF

cc: BSIP  
Bridge Maintenance  
Division Right of Way  
IMG  
Pavement Management  
Permit Unit  
State Road Maintenance  
Traffic Engineering  
Traffic Surveys

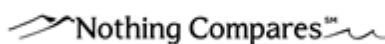

# 2017 ROAD SYSTEM CHANGES

<b>PETITION</b>	<b>COUNTY</b>	<b>APPROVAL DATE</b>	<b>ROUTE NUMBER</b>	<b>PORTION REASSIGNED</b>	<b>STREET NAME</b>	<b>LENGTH (miles)</b>	<b>TYPE OF CHANGE</b>	<b>REMARKS (See Attached Map)</b>
ONSLOW_2017_01_51247	ONSLOW	1/5/2017	SR 2277		CUDDY CT	0.05	SYSTEM ADDITION VIA PETITION	
ONSLOW_2017_01_51247	ONSLOW	1/5/2017	SR 2276		ROMPER RD	0.13	SYSTEM ADDITION VIA PETITION	
ONSLOW_2017_01_51247	ONSLOW	1/5/2017	SR 2275		DERRICK DR	0.25	SYSTEM ADDITION VIA PETITION	
ONSLOW_2017_01_51247	ONSLOW	1/5/2017	SR 2274		REGATTA WAY	0.27	SYSTEM ADDITION VIA PETITION	

Document Number: Onslow\_2017\_01\_51247

Map Date: 01/13/17

County: Onslow

Route Number(s):

2274 2275 2276

2277

Approval Date: 01/05/17

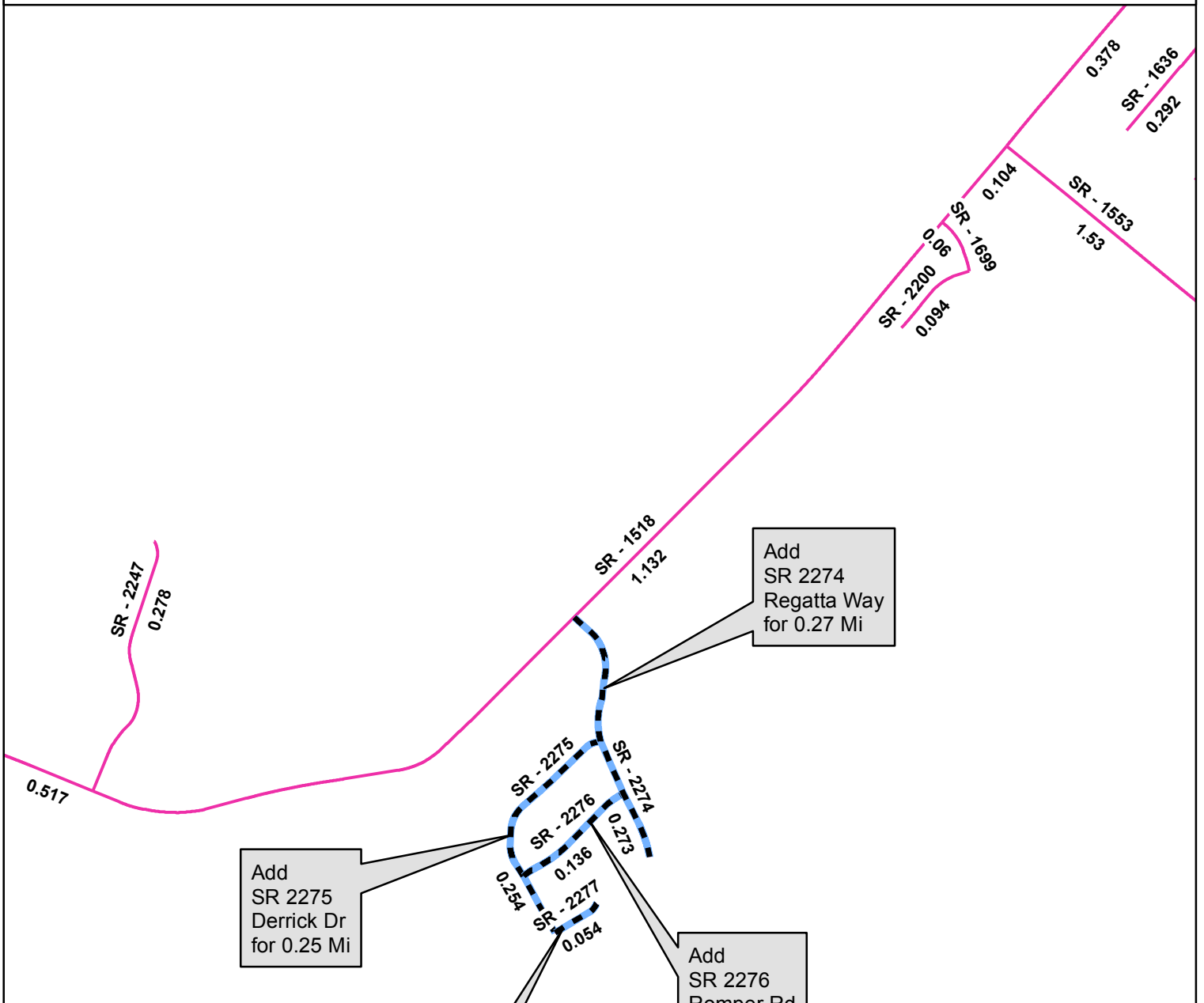

Add  
SR 2275  
Derrick Dr  
for 0.25 Mi

Add  
SR 2274  
Regatta Way  
for 0.27 Mi

Add  
SR 2276  
Romper Rd  
for 0.13 Mi

Add  
SR 2277  
Cuddy Ct  
for 0.05 Mi

**Legend**

-  Addition
-  Deletion
-  Reassignment
-  SR
-  NC
-  US
-  Interstate
-  Ramp
-  Non-System
-  Obliterated

