



STATE OF NORTH CAROLINA
DEPARTMENT OF TRANSPORTATION

PATRICK MCCRORY
GOVERNOR

December 13, 2016

NICHOLAS J. TENNYSON
SECRETARY

MEMORANDUM TO: Mr. Mike Mills, PE
Division Engineer
Division 7

FROM: Mr. John C. Farley, GISP, CPM
Manager
Geographic Information Systems Unit

SUBJECT: 2016 District 1 Road System Changes

The GIS Unit's Data Conversion Group has been authorized to make the changes indicated below to the state road system. We request that you update the related maps and files in your offices and install appropriate road number signs, if necessary. If our system changes do not conform to the actual conditions in the field, please return this memorandum with recommendations.

Petition	County	Approval Date
ALAMANCE_2016_12_51225	ALAMANCE	12/1/2016

Questions or comments about changes should be referred to the GIS Help Desk at GISHelp@ncdot.gov.
Thank you for your assistance.

JCF

- cc: BSIP
- Bridge Maintenance
- Division Right of Way
- IMG
- Pavement Management
- Permit Unit
- State Road Maintenance
- Traffic Engineering
- Traffic Surveys

MAILING ADDRESS:
NC DEPARTMENT OF TRANSPORTATION
GEOGRAPHIC INFORMATION SYSTEMS
1521 MAIL SERVICE CENTER
RALEIGH, NC 27699-1521



DELIVERY ADDRESS:
4101 CAPITAL BLVD.
RALEIGH, NC 27604
FAX: (919) 707-2214

2016 ROAD SYSTEM CHANGES

PETITION	COUNTY	APPROVAL DATE	ROUTE NUMBER	PORTION REASSIGNED	STREET NAME	LENGTH (miles)	TYPE OF CHANGE	REMARKS (See Attached Map)
ALAMANCE_2016_12_51225	ALAMANCE	12/1/2016	SR 2663		FALL LEAVES CT	0.12	SYSTEM ADDITION VIA PETITION	
ALAMANCE_2016_12_51225	ALAMANCE	12/1/2016	SR 2662		PEGGY'S WAY	0.11	SYSTEM ADDITION VIA PETITION	
ALAMANCE_2016_12_51225	ALAMANCE	12/1/2016	SR 2661		SOUTH SPRING FLOWERS DR	0.21	SYSTEM ADDITION VIA PETITION	
ALAMANCE_2016_12_51225	ALAMANCE	12/1/2016	SR 2660		NORTH SPRING FLOWERS DR	0.09	SYSTEM ADDITION VIA PETITION	
ALAMANCE_2016_12_51225	ALAMANCE	12/1/2016	SR 2659		ERVIN NEWLIN DR	0.10	SYSTEM ADDITION VIA PETITION	

Add
SR 2660
North Spring Flowers Dr
for 0.09 Mi

Add
SR 2662
Peggy's Way
for 0.11 Mi

Add
SR 2663
Fall Leaves Ct
for 0.12 Mi

Add
SR 2659
Ervin Newlin Dr
for 0.10 Mi

Add
SR 2661
South Spring Flowers Dr
for 0.21 Mi

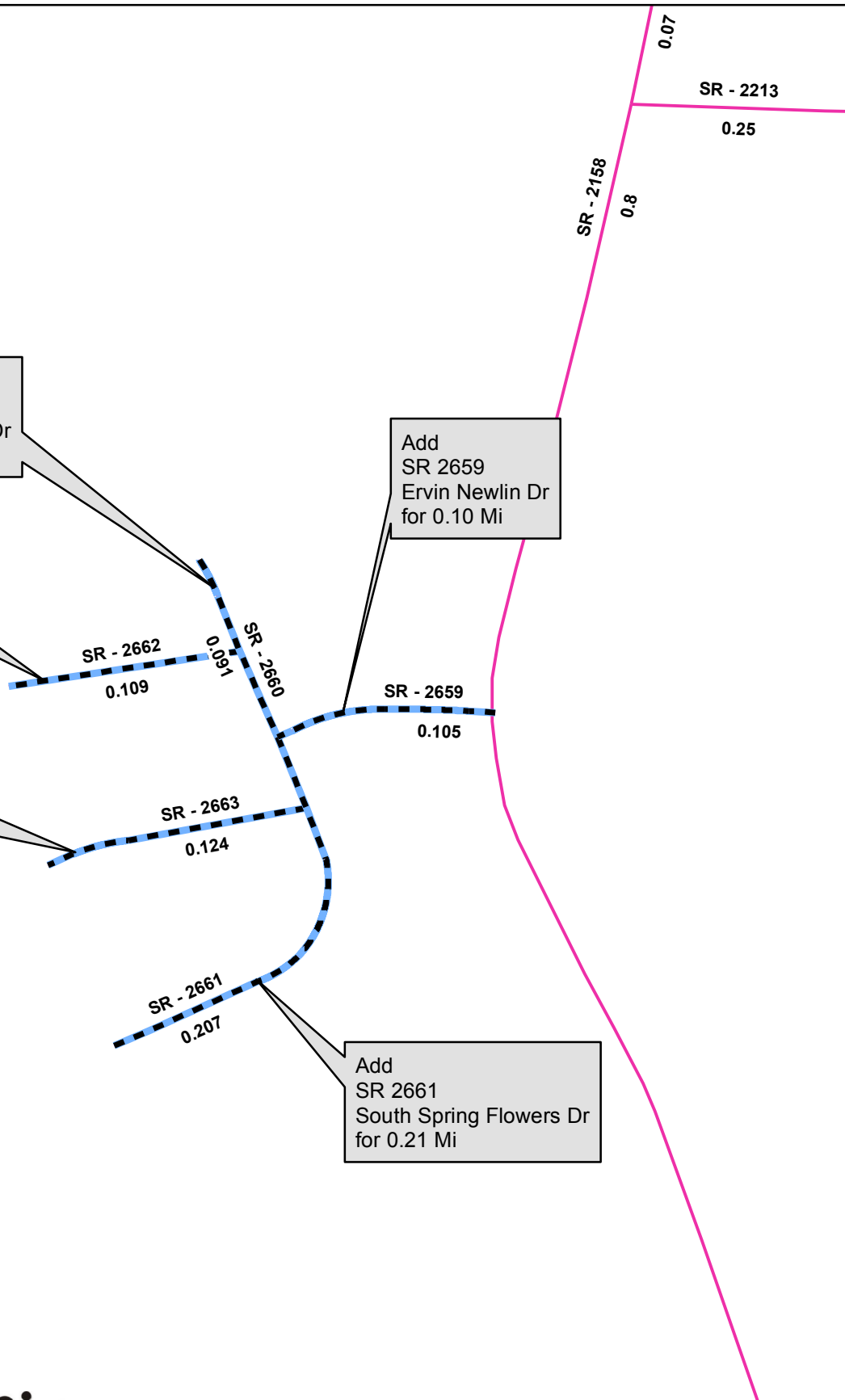

Legend

-  Addition
-  Deletion
-  Reassignment
-  SR
-  NC
-  US
-  Interstate
-  Ramp
-  Non-System
-  Obliterated

