



STATE OF NORTH CAROLINA
DEPARTMENT OF TRANSPORTATION

ROY COOPER
GOVERNOR

JAMES H. TROGDON, III
SECRETARY

DATE: February 01, 2018
TO: Mr. Michael A. Pettyjohn, PE
Division Engineer
Division 11
FROM: Mr. John C. Farley, GISP, CPM
Manager
Geographic Information Systems Unit
SUBJECT: 2018 District 1 Road System Changes

The GIS Unit's Data Conversion Group has been authorized to make the changes indicated below to the state road system. We request that you update the related maps and files in your offices and install appropriate road number signs, if necessary. If our system changes do not conform to the actual conditions in the field, please return this memorandum with recommendations.

Document Number	County	Approval Date
R-3101	ALLEGHANY	10/1/2016

Questions or comments about changes should be referred to the GIS Help Desk at GISHelp@ncdot.gov.
Thank you for your assistance.

JCF

cc: BSIP
Bridge Maintenance
Division Right of Way
IMG
Pavement Management
Permit Unit
State Road Maintenance
Traffic Engineering
Traffic Surveys

Mailing Address:
NC DEPARTMENT OF TRANSPORTATION
GEOGRAPHIC INFORMATION SYSTEMS
1521 MAIL SERVICE CENTER
RALEIGH, NC 27699-1521

Telephone: (919) 707-2165
Fax: (919) 707-2210
Customer Service: 1-877-368-4968
Website: www.ncdot.gov

Location:
4101 CAPITAL BLVD.
RALEIGH, NC 27604
FAX: (919) 707-2214

2018 ROAD SYSTEM CHANGES

TIP	COUNTY	APPROVAL DATE	NEW ROUTE	EXISTING ROUTE	STREET NAME	LENGTH (miles)	TYPE OF CHANGE	REMARKS (See Attached Map)
R-3101	ALLEGHANY	10/1/2016		SR 1178	GREEN HOUSE RD	0.03	SYSTEM ADDITION - EXISTING VIA TIP	MAP A, SEGMENT
R-3101	ALLEGHANY	10/1/2016		SR 1107	FOXFIRE RD	0.08	SYSTEM ADDITION - EXISTING VIA TIP	MAP B, SEGMENT
R-3101	ALLEGHANY	10/1/2016		SR 1430	SHERIFF RD	0.02	SYSTEM ADDITION - EXISTING VIA TIP	MAP C, SEGMENT
R-3101	ALLEGHANY	10/1/2016		SR 1422	SHERIFF RD	0.03	SYSTEM ADDITION - EXISTING VIA TIP	MAP C, SEGMENT
R-3101	ALLEGHANY	10/1/2016		SR 1118	MACEDONIA CHURCH RD	0.11	SYSTEM ADDITION - EXISTING VIA TIP	MAP C, SEGMENT
R-3101	ALLEGHANY	10/1/2016		SR 1178	GREEN HOUSE RD	0.05	SYSTEM DELETION VIA TIP	MAP A, SEGMENT
R-3101	ALLEGHANY	10/1/2016		SR 1107	FOXFIRE RD	0.10	SYSTEM DELETION VIA TIP	MAP B, SEGMENT
R-3101	ALLEGHANY	10/1/2016		SR 1430	SHERIFF RD	0.03	SYSTEM DELETION VIA TIP	MAP C, SEGMENT
R-3101	ALLEGHANY	10/1/2016		SR 1422	SHERIFF RD	0.04	SYSTEM DELETION VIA TIP	MAP C, SEGMENT
R-3101	ALLEGHANY	10/1/2016		SR 1118	MACEDONIA CHURCH RD	0.17	SYSTEM DELETION VIA TIP	MAP C, SEGMENT

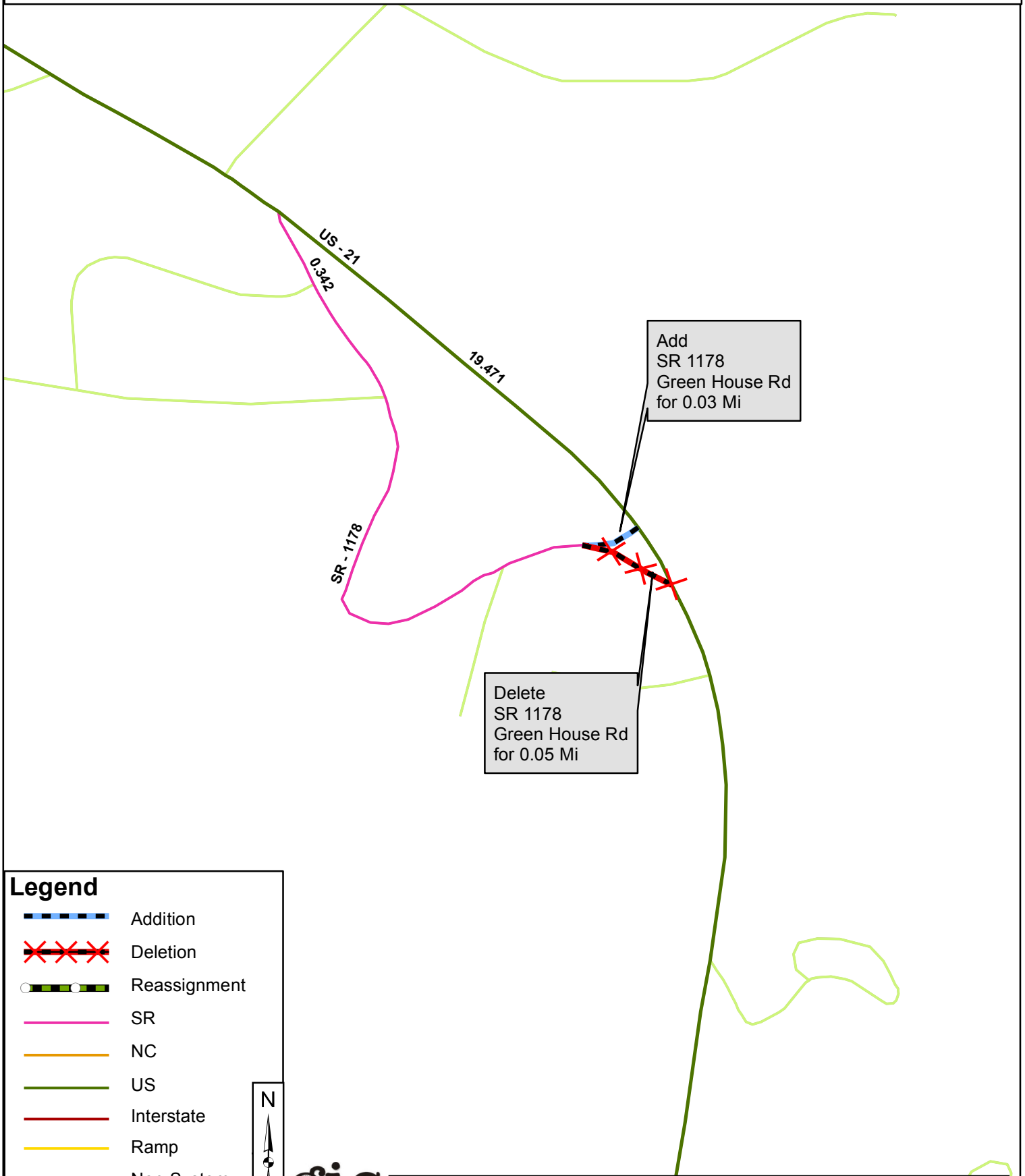

Legend

-  Addition
-  Deletion
-  Reassignment
-  SR
-  NC
-  US
-  Interstate
-  Ramp
-  Non-System
-  Obliterated

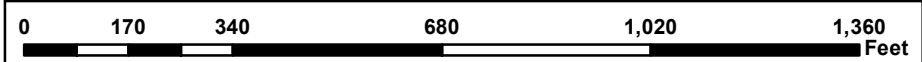

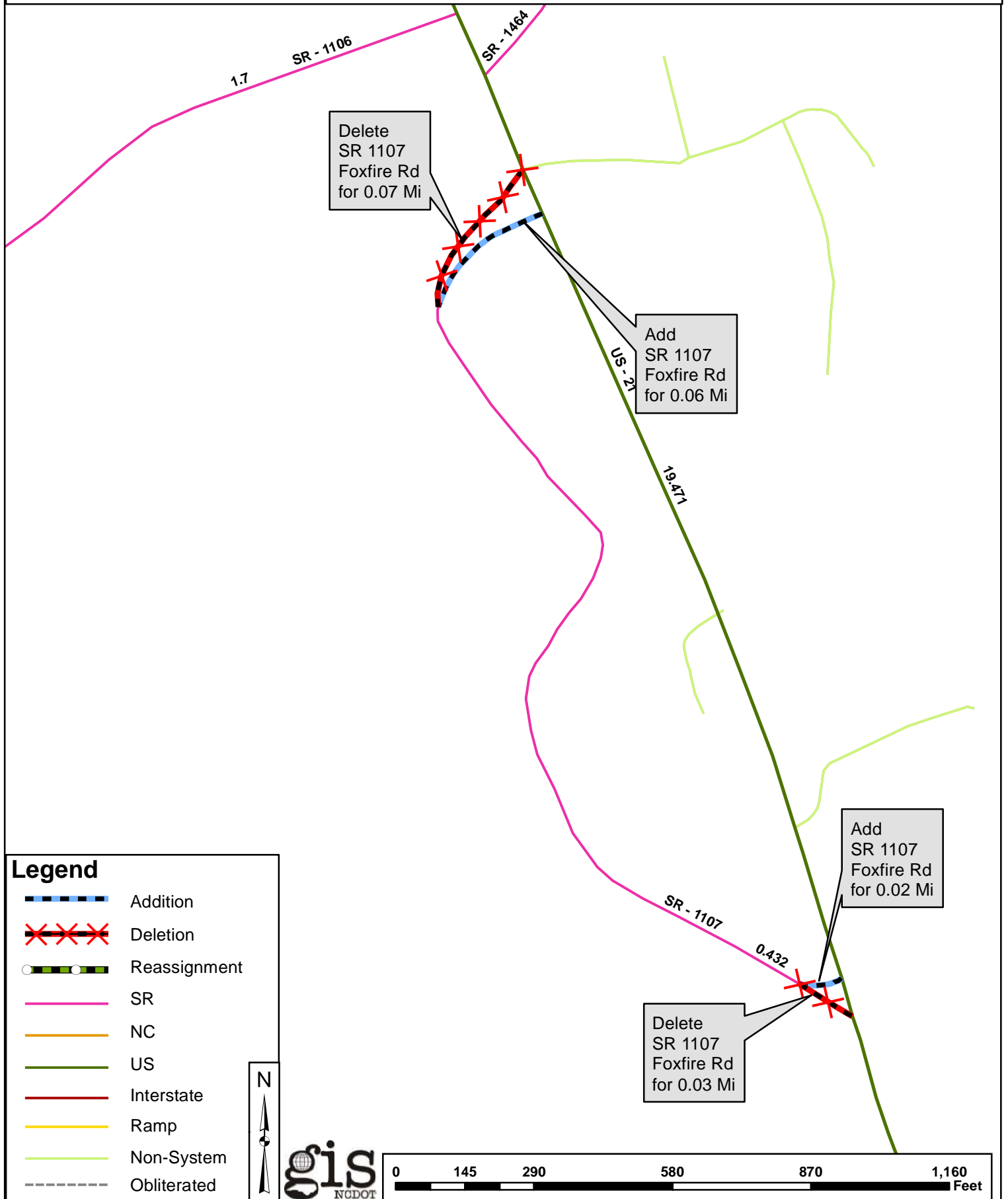

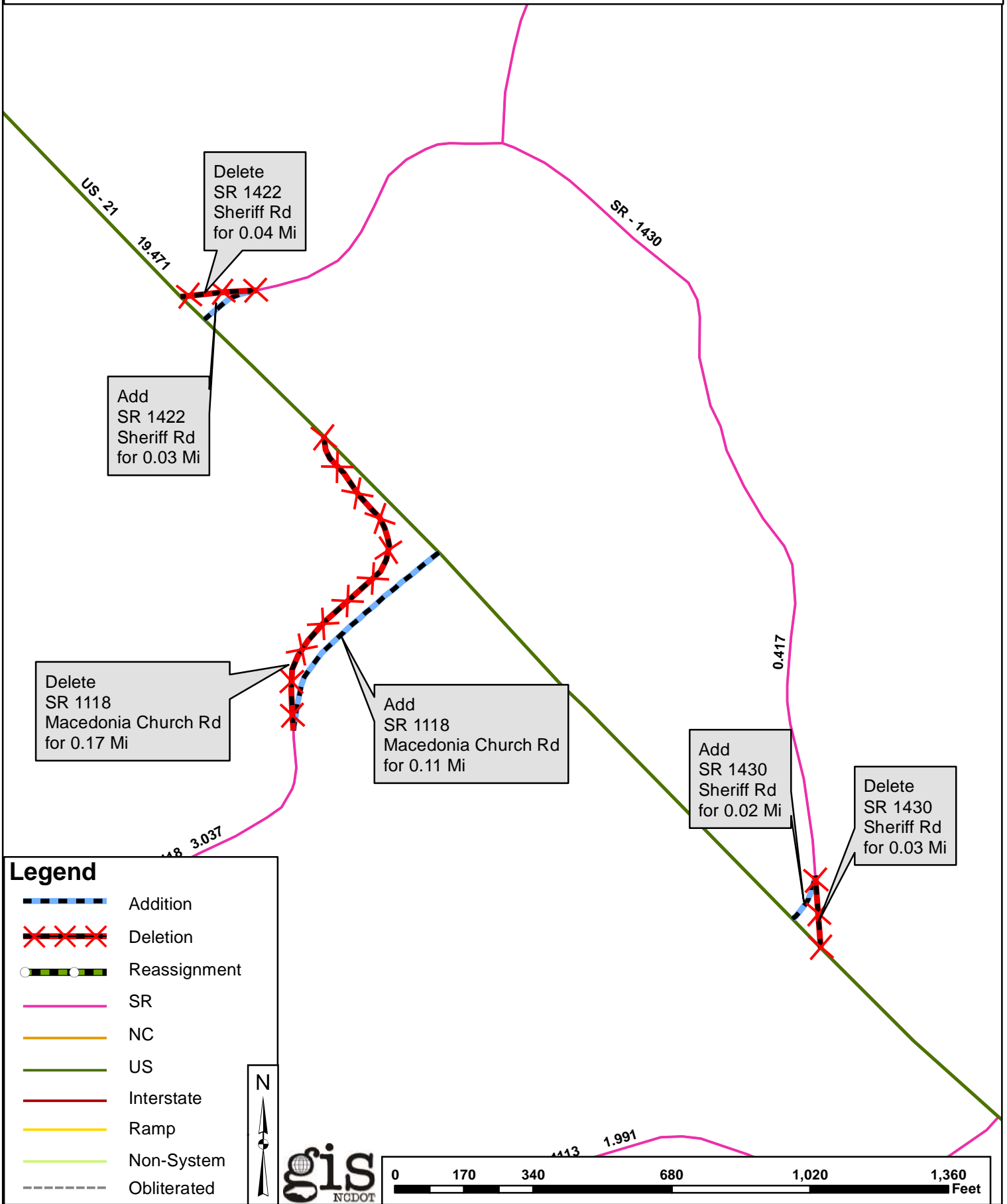

Legend

-  Addition
-  Deletion
-  Reassignment
-  SR
-  NC
-  US
-  Interstate
-  Ramp
-  Non-System
-  Obliterated

