



STATE OF NORTH CAROLINA
DEPARTMENT OF TRANSPORTATION

PATRICK MCCRORY
GOVERNOR

September 20, 2016

NICHOLAS J. TENNYSON
SECRETARY

MEMORANDUM TO: Mrs. Karen E.Collette, PE
Division Engineer
Division 3

FROM: Mr. John C. Farley, GISP, CPM
Manager
Geographic Information Systems Unit

SUBJECT: 2016 District 1 Road System Changes

The GIS Unit's Data Conversion Group has been authorized to make the changes indicated below to the state road system. We request that you update the related maps and files in your offices and install appropriate road number signs, if necessary. If our system changes do not conform to the actual conditions in the field, please return this memorandum with recommendations.

Petition	County	Approval Date
ONSLOW_2016_09_51161	ONSLOW	9/8/2016

Questions or comments about changes should be referred to the GIS Help Desk at GISHelp@ncdot.gov.
Thank you for your assistance.

JCF

- cc: BSIP
- Bridge Maintenance
- Division Right of Way
- IMG
- Pavement Management
- Permit Unit
- State Road Maintenance
- Traffic Engineering
- Traffic Surveys

MAILING ADDRESS:
NC DEPARTMENT OF TRANSPORTATION
GEOGRAPHIC INFORMATION SYSTEMS
1521 MAIL SERVICE CENTER
RALEIGH, NC 27699-1521



DELIVERY ADDRESS:
4101 CAPITAL BLVD.
RALEIGH, NC 27604
FAX: (919) 707-2214

2016 ROAD SYSTEM CHANGES

PETITION	COUNTY	APPROVAL DATE	ROUTE NUMBER	PORTION REASSIGNED	STREET NAME	LENGTH (miles)	TYPE OF CHANGE	REMARKS (See Attached Map)
ONSLOW_2016_09_51161	ONSLOW	9/8/2016	SR 2742		SOUTH BLUFF CIR	0.21	SYSTEM ADDITION VIA PETITION	
ONSLOW_2016_09_51161	ONSLOW	9/8/2016	SR 2741		CYPRESS MANOR CT	0.29	SYSTEM ADDITION VIA PETITION	
ONSLOW_2016_09_51161	ONSLOW	9/8/2016	SR 2740		SOUTH BRANDON WAY	0.20	SYSTEM ADDITION VIA PETITION	
ONSLOW_2016_09_51161	ONSLOW	9/8/2016	SR 2739		EAST HOWARD DR	0.19	SYSTEM ADDITION VIA PETITION	

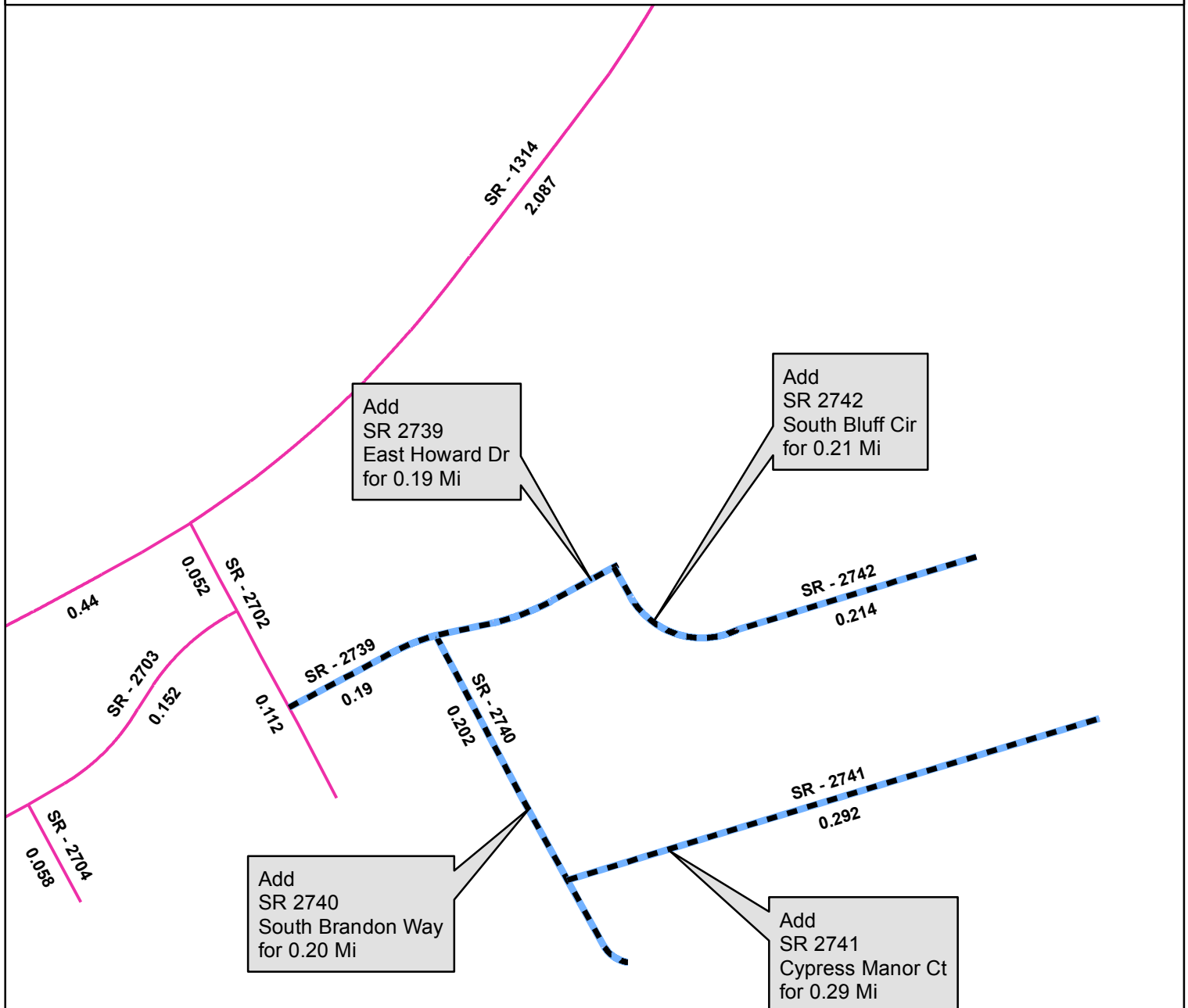

Legend

- Addition
- Deletion
- Reassignment
- SR
- NC
- US
- Interstate
- Ramp
- Non-System
- Obliterated

