



STATE OF NORTH CAROLINA
DEPARTMENT OF TRANSPORTATION

PATRICK MCCRORY
GOVERNOR

December 20, 2016

NICHOLAS J. TENNYSON
SECRETARY

MEMORANDUM TO: Mr. Tim Little, PE
Division Engineer
Division 4

FROM: Mr. John C. Farley, GISP, CPM
Manager
Geographic Information Systems Unit

SUBJECT: 2016 District 3 Road System Changes

The GIS Unit's Data Conversion Group has been authorized to make the changes indicated below to the state road system. We request that you update the related maps and files in your offices and install appropriate road number signs, if necessary. If our system changes do not conform to the actual conditions in the field, please return this memorandum with recommendations.

Document Number	County	Approval Date
R-2554C_096	WAYNE	5/27/2016

Questions or comments about changes should be referred to the GIS Help Desk at GISHelp@ncdot.gov.
Thank you for your assistance.

JCF

cc: BSIP
Bridge Maintenance
Division Right of Way
IMG
Pavement Management
Permit Unit
State Road Maintenance
Traffic Engineering
Traffic Surveys

TIP	COUNTY	APPROVAL DATE	NEW ROUTE	EXISTING ROUTE	STREET NAME	LENGTH (miles)	TYPE OF CHANGE	REMARKS (See Attached Maps)
R-2554C_096	WAYNE	5/27/2016		SR 1788		0.05	SYSTEM ADDITION - EXISTING VIA TIP	MAP A, SEGMENT
R-2554C_096	WAYNE	5/27/2016		SR 1731		0.20	SYSTEM ADDITION - EXISTING VIA TIP	MAP A, SEGMENT
R-2554C_096	WAYNE	5/27/2016		SR 1719		0.47	SYSTEM ADDITION - EXISTING VIA TIP	MAP B, SEGMENT
R-2554C_096	WAYNE	5/27/2016	SR 2231			0.27	SYSTEM ADDITION - NEW VIA TIP	MAP A, SEGMENT
R-2554C_096	WAYNE	5/27/2016	SR 9001			5.92	SYSTEM ADDITION - NEW VIA TIP	MAP B, SEGMENT
R-2554C_096	WAYNE	5/27/2016	SR 2233			0.25	SYSTEM ADDITION - NEW VIA TIP	MAP B, SEGMENT
R-2554C_096	WAYNE	5/27/2016	SR 2232			0.72	SYSTEM ADDITION - NEW VIA TIP	MAP B, SEGMENT
R-2554C_096	WAYNE	5/27/2016		SR 1788		0.09	SYSTEM DELETION VIA TIP	MAP A, SEGMENT
R-2554C_096	WAYNE	5/27/2016		SR 1731		0.19	SYSTEM DELETION VIA TIP	MAP A, SEGMENT
R-2554C_096	WAYNE	5/27/2016		SR 1719		0.45	SYSTEM DELETION VIA TIP	MAP B, SEGMENT

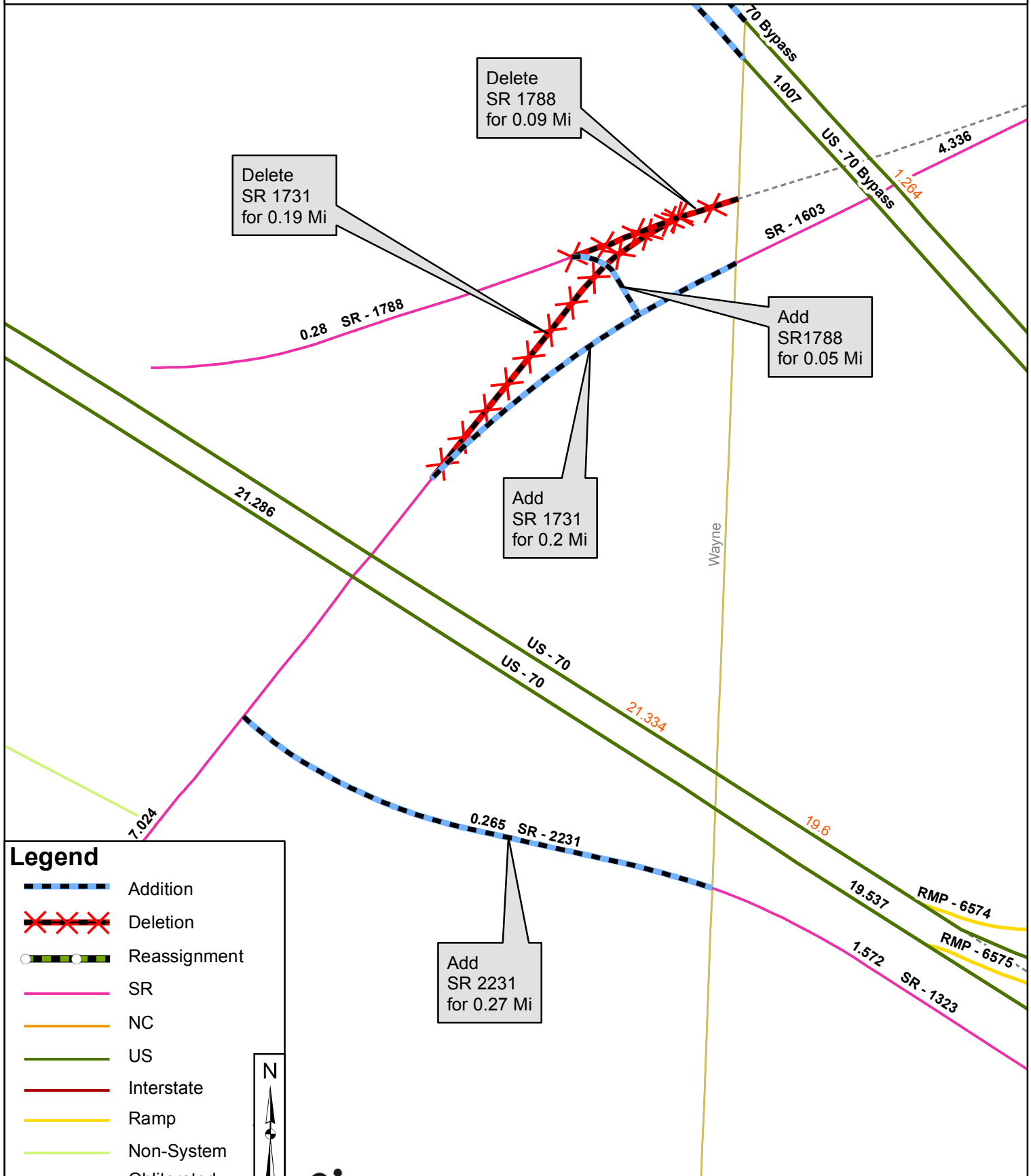

Legend

- Addition
- Deletion
- Reassignment
- SR
- NC
- US
- Interstate
- Ramp
- Non-System
- Obliterated
- County Boundary

